

PARK AVE	005481		1	
2 CHILDS STREET	AME	ADDRESS	APT. NO.	CARD NO.

5481

BUILDING PERMIT

Department of Building

BERNARD C. ADAMS, Director

CITY OF
GARDEN GROVE

ZONING AND BUILDING

Use Zone	Main Use	Acc. Use	Var. No.
St. Set Back	PL		PL
Side Yard			Projection
Side Yard			Projection
Rear Yard	Stor. 25		Parking Req.
Zoning Approved By			Date
Group	Type		Plan Ck.
Remarks:			

INSPECTION RECORD

APPROVAL	DATE	INSPECTOR
Foundation and Location	5-4-64	Hg
Reinforcing		
Roof Shtg.	6-22-64	Hg
Rough Frame	7-2-64	Hg
Lat. or Drywall	9-1-64	Hg
Plas. Brown Ct.	9-8-64	Hg
Other		
Land Use		
Final	9-12-64	Hg
Utility Release	SEP 18 1964	QC

FEES

Plan Check	\$ 21.00	Building Permit	\$ 42.00
Bond	\$	Expiration Date	

Permit Authorized By _____ Date _____

Routing: #1 Bldg. Inspector #2 Office File #3 Statistics #4 Owner

For Applicant to Fill in (USE INK) 1

Job Address 5481 Park Avenue Permit No. 26740

Lot No. 135 Tract No. 5283 Blk No. _____
Please Attach Meters & Bounds (2 Copies)

Owner Williamsville Corp.
Owner's Address 8857 W. Olympic Blvd. Beverly Hills, Calif.

Description of Work: New Add'n Remodel Relocate

Use of Building Single family dwelling, Plan # 3 DR

Area of Building 1760 sq. ft. Valuation \$ 12,840.00

Validation: MAY 12-64 11 033 M 42.00
MAY 12-64 11 032 M 21.00

Arch. or Engr. D. Freedman, 113 N. San Vincente, B.H.

Contractor S/E Const. Co. Phone OL 5-7390
Address 8857 W. Olympic, Beverly Hills

I hereby acknowledge that I have read this application and state that the above is correct and agree to comply with all ordinances and State laws regulating building construction. I hereby certify that I am properly registered with and/or licensed as required by the City of Garden Grove and/or State of California, or that I am the legal owner of the above described property, and I certify that in the performance of the work for which this permit is issued I shall not employ any person in violation of the workmen's compensation law of the State of California.

Signature of S & S Construction Co. Date _____
Permittee _____ Lic. No. _____

RELOCATION

PRESENT BLDG. ADDRESS _____
MOVING CONTRACTOR ADDRESS _____

PUBLIC WORKS

Street Address	By	REQUIRED	PROVIDED
Record of Survey			
R/W Dedication			
Bonds			
Encroachment Permit			

Remarks _____

1 ELECTRIC PERMIT

Department of Building
B. C. Adams
Director

CITY OF
GARDEN GROVE
JE 4270

Applicant Fill in (use ink)
Job Address

Electric Permit No.

5481 Park Ave

2-851

LOT NO. 13

TRACT NO. 5783

Owner
Owner's
Address

St & Cons Co

New Bldg. Old Bldg. Use—
Electrical Contr. **BAUM ELECTRIC CO.**

10552 STANFORD
JE. 7-4340 GARDEN GROVE, CALIF.

Address

State

License No.

127751

Phone

1-24-64

11 033 March 1964

Validation

I hereby acknowledge that I have read this application and state that the above is correct and agree to comply with all ordinances and State laws regulating electrical wiring.

I hereby certify that I am properly registered with and/or licensed as required by the City of Garden Grove and/or State of California, or that I am the legal owner of the above described property, and I certify that in the performance of the work for which this permit is issued I shall not employ any person in violation of the workmen's compensation laws of the State of California.

Signature
Permittee

W. H. Parnell

SIGNS

One Sign—1 Transformer	2.00
Additional Sign, Same Location	1.00
Additional Transf. or flashers, Time Clock	1.00
Lamp Holding Devices, 1st 20	.05
Lamp Holding Devices, Next 100	.03
Sign and 1 Transformer, Moved	
Altering or Changing Lettering	
For Connecting (Hook-up)	
Permit Fee	2.00

Total Fee

Date

Inspector

Conduit

Wiring

Fixtures

U. G.

Sign Footing

Final

Utility Notified

7-2-64
9-17-64
St & Cons Co

Service Size Amp.

Wire

Conduit

Building Permit No.

New Residence Sq. Ft.

Residential Garage Sq. Ft.

Services

Meters

Fixtures 1st 20

Fixtures, Additional

Fixtures, Mercury Vapor

Outlets 1st 20

Outlets, Additional

Any Pole

Dryer

Dishwasher

Furnace

Garbage Disposal

Fan

Heater Inc. 1/250 W

Domestic Range

Domestic Oven

Motors—Not Over 1 H.P.

Motors Over 1 Not Over 3 H.P.

Motors Over 3 Not Over 5

Motors Over 5 Not Over 15

If Not Listed Above See Code

NUMBER

EA.

FEE

1464

.01

1464

1708

.005

100

1.00

1.00

.20

.10

1.00

.20

.10

2.00

1.00

1.00

1.00

1.00

1.00

1.00

.50

1.00

1.00

1.00

1.50

2.00

2.50

Permit Fee

2.00

Total Fee

19.64

Authorized By

Date

6/24/64

PLUMBING PERMIT

Department of Building
Harry R. Pearce

Director 537-4300

CITY OF
GARDEN GROVE

For Applicant to Fill In (Use Ink)

Job Address 5491 Park Ave. Permit No. 33698

Lot No. 185 Tract No. 5103 Block No. _____

Owner S & S Construction Co.
8857 W. Olympic Blvd.

Owner's Address Beverly Hills, Calif.

Plumbing Contractor SANDERS PLUMBING CO.

Contractor's Address 5327 Mulford Ave., Lynwood, Calif.

Phone NE 4-7181 NE 4-7773

City Lic. No. 2160

Use of Bldg. Dwelling

New Bldg. Old Bldg.

Validation MAY 19-64 11 151 H 14.50

I hereby acknowledge that I have read this application and state that the above is correct and agree to comply with all ordinances and State laws regulating plumbing.

I hereby certify that I am properly registered with and/or licensed as required by the City of Garden Grove and/or State of California, or that I am the legal owner of the above described property, and I certify that in the performance of the work for which this permit is issued I shall not employ any person in violation of the workmen's compensation laws of the State of California.

Signature of Permittee [Signature] Date _____

Address _____

APPROVALS	DATE	INSPECTOR
SOIL PIPING	<u>5-13-64</u>	<u>[Signature]</u>
GROUND PLUMBING		
ROUGH PLUMBING	<u>6-13-64</u>	<u>[Signature]</u>
GAS PIPING		
GAS VENT		
SEPTIC TANK or Cesspool		
SEWER		
GAS TEST	<u>7-14-64</u>	<u>H9</u>
MAIN DRAIN AND VACUUM LINES		
WATER HEATER		
BACKWASH		
WATER LATERAL		
FINAL		
UTILITY CO. NOTIFIED	<u>SEP 14 1964</u>	<u>CC</u>

PERMIT FEES			
No.	TYPE OF FIXTURE OR ITEM	EACH	#
2	Water Closet (Toilet)	\$1.00	2
1	Bath Tub	1.00	1
1	Shower	1.00	1
2	Lavatory (Wash Basin)	1.00	2
1	Kitchen Sink	1.00	1
1	Garbage Disposal	1.00	1
1	Laundry Tub or Tray	1.00	1
1	Water Heater	1.50	1
	Slop Sink	1.00	
	Floor Sink	1.00	
	Floor Drain	1.00	
1	Dish Washer	1.00	1
	Drinking Fountain	1.00	
	Urinal	1.00	
1	Gas System - 2 Outlets	1.00	1
	House Sewer	1.00	
	Lawn Sprinklers	5.00	
	Swimming Pool Piping	1.00	
	Sand Traps	1.00	
1	Automatic Washing Mach.	1.00	1
	Water Softeners	1.50	
	Backwash -- Trap	1.50	
	Water Lateral	1.00	

Issuance of Permit _____

TOTAL FEE \$ 14.50

Permit Authorized By P. H. Date 5-18-64

Routing: #1 Plumbing Inspector #2 Office File #3 Owner Bldg. Permit # _____

PLUMBING PERMIT

Department of Building
H. R. Pearce

317-4203

CITY OF
GARDEN GROVE

For Applicant to Fill In (See Back)

PERMIT FEES

No.	TYPE OF FIXTURE OR ITEM	RATE	QTY	TOTAL
	Water Closet (Toilet)	\$1.00		
	Bath Tub	1.00		
	Shower	1.00		
	Lavatory (Wash Basin)	1.00		
	Kitchen Sink	1.00		
	Garbage Disposal	1.00		
	Laundry Tub or Tray	1.00		
	Water Heater	1.50		
	Stop Sink	1.00		
	Floor Sink	1.00		
	Floor Drain	1.00		
	Dish Washer	1.00		
	Drinking Fountain	1.00		
	Urinal	1.00		
	Gas Systems - Outlets	1.00		
	House Sewer	1.00	1	
	Lawn Sprinklers	2.00		
	Swimming Pool Piping	1.00		
	Sand Traps	1.00		
	Automatic Washing Mach.	1.00		
	Water Softeners	1.50		
	Backwash - Trap	1.50		
	Water Lateral	1.00		
	Issuance of Permit		2	00
	TOTAL FEE			\$ 3 -

Job _____
 Address 5481 Park Ave Permit No. _____
 Lot No. 135 Tract No. 5223 Blk. No. 000137
 Owner D. J. D.
 Owner's Address _____
 Plumbing Contractor B. J. Crume
 Contractor's Address 13000 Ocean Ave
 Phone 698-7935 City Lic. No. 002
 Use of Bldg. Res
 New Bldg. Old Bldg.
 Validation 7-22-64 11 117 14:22:30

I hereby acknowledge that I have read this application and state that the above is correct and agree to comply with all ordinances and State laws regulating plumbing.
 I hereby certify that I am properly registered with and/or licensed as required by the City of Garden Grove and/or State of California, or that I am the legal owner of the above described property, and I certify that in the performance of the work for which this permit is issued I shall not employ any person in violation of the workmen's compensation laws of the State of California.

Signature of Permittee B. J. Crume Date _____
 Address _____

APPROVALS	DATE	INSPECTOR
SOIL PIPING		
GROUND PLUMBING		
ROUGH PLUMBING		
GAS PIPING		
GAS VENT		
SEPTIC TANK or Cesspool		
SEWER		
GAS TEST		
MAIN DRAIN AND VACUUM LINES		
WATER HEATER		
BACKWASH		
WATER LATERAL		
FINAL		
UTILITY CO. NOTIFIED		

Permit Authorized By eps Date 7-22-64
 Routing: #1 Plumbing Inspector #2 Office File #3 Owner

Bldg. Permit # _____

HEATING, VENTILATING, REFRIGERATION & AIR CONDITIONING PERMIT

DEPARTMENT OF BUILDING
 RICHARD S. PRINCE - DIRECTOR
 437-4200

CITY OF
 GARDEN GROVE

FOR APPLICANT TO FILL IN (USE INK)

JOB ADDRESS

5481 PARK AVENUE

PERMIT NO.

4370

QUANTITY	TYPE OF FIXTURE OR ITEM	EACH	FEE
1	FURNACE - RESIDENTIAL	\$1.00	1 00
7	WARM AIR OUTLET	.25	1 75
1	FURNACE VENTS	1.00	1 00
	GAS PIPING OUTLETS	1.00	
	COMMERCIAL HEATING	2.00	
	COMMERCIAL WARM AIR OUTLETS	.50	
	COMMERCIAL FURNACE VENTS	2.00	
	EXHAUST OUTLETS	1.00	
	RE-AIR, ALTERATION OR ADDITION TO HEATING SYSTEM	1.00	
	RES. OR COMM.		
	VENTILATION SYSTEM	3.00	
	RESTAURANT KITCHEN HOOD	3.00	
	CONDENSING UNIT 20 H.P. OR LESS	2.00	
	CONDENSING UNIT TO 30 H.P.	5.00	
	CONDENSING UNIT OVER 30 H.P.	10.00	
	REPAIR OR ALTERATION TO REFRIGERATION SYSTEM	3.00	
	EVAPORATIVE COOLERS	1.00	
	ISSUANCE OF PERMIT		1 00
	TOTAL FEE		4 75

LOT NO. 135 TRACT NO. 5283

OWNER S & S CONSTRUCTION CO.

OWNER'S ADDRESS 8357 W. OLYMPIC BLVD.

CONTRACTOR STONE BROS. AIRCOND. INC.

CONTRACTOR ADDRESS 9052 ALPACA CITY EL MONTE

PHONE 614-8420 CITY LIC. NO. 4223

USE OF BUILDING RESIDENCE

NEW BUILDING OLD BUILDING

VALIDATION 11 039

I hereby acknowledge that I have read this application and state that the above is correct and agree to comply with all ordinances and State laws regulating plumbing. I hereby certify that I am properly registered with and/or licensed as required by the City of Garden Grove and/or State of California, or that I am the legal owner of the above described property, and I certify that in the performance of the work for which this permit is issued I will not employ any person in violation of the workmen's compensation laws of the State of California.

SIGNATURE OF PERMITTEE *Tom Jones* DATE

ADDRESS APPROVAL DATE INSPECTOR

APPROVAL	DATE	INSPECTOR
FURNACE		
REGISTER OUTLETS		
FURNACE VENTS		
GAS PIPING		
DUCTS		
EXHAUST OUTLETS		
RESTAURANT KITCHEN HOOD		
VENTILATION SYSTEM		
CONDENSING UNIT 20 H.P. OR LESS		
CONDENSING UNIT 30 H.P.		
CONDENSING UNIT OVER 30 H.P.		
FINAL		
UTILITY CO. NOTIFIED		

PERMIT AUTHORIZED BY _____ DATE _____

ROUTING: #1 INSPECTOR #2 OFFICE FILE #3 OWNER

BUILDING PERMIT NO. _____

9-12-64 HG

BUILDING PERMIT

Inspection Requests
638-6771

General Information
638-6661

INSPECTION RECORD

For Applicant to Fill in

OCCUPANCY F-1	TYPE V	OCC. LOAD		FIRE SPRINK.	
		FRONT	LEFT	RIGHT	REAR
USE ZONE F-1	Esy Proj.				
FIRE ZONE II	Setbacks	20'	5'	-	-
PLANNING ACTION		FILED			
LAND USE APPROVED BY		PLANS DATE			
REMARKS:					
G.G. SANT. DIS. FEE REQ'D.	O.C. SANT. DIS. FEE REQ'D.	DATE	INITIAL		
PARCEL MAP	REQ'D	PROVIDED			
H/W DEDICATION					
FEES AND BONDS					
	REV. CODE	AMOUNT			
ST. BOND					
WATER BOND					
WATER ASSMT. FEE (ACRG.)					
WATER ASSMT. FEE (FT.)					
PARKWAY TREE FEE					
PARK & REC. FEE (DIST.)					
DRAIN ASSMT. FEE (DIS)	581	27	40		
PLAN RETENTION FEE			137 AC X 200.00		
BLDG. PLAN CHECK	520	45	76		
BLDG. PERMIT FEE	226	71	28		
ISSUANCE	535	6	00		
VALUATION		TOTAL FEE	123	04	
AUTHORIZED BY JK		DATE 6-7-79			

APPROVAL	DATE	INSPECTOR
FOUNDATION & LOCATION	6/12/79	Stone
CONCRETE FLOOR		
REINFORCING		
ROOF SHTG	6/27/79	Arman
ROUGH FRAME	7/23/79	Stone
INSULATION, ENERGY		
LATH OR DRYWALL	8/7/79	
PLAS. BROWN CT.	8/29/79	
SOUND INSULATION		
SMOKE DETECTOR		
PARKING		
LANDSCAPING		
LAND USE FINAL		
FINAL	12/18/79	
UTILITY RELEASE		

WORKER'S COMPENSATION REQUIREMENTS

State Compensation Insurance Policy No. _____ Expiration Date _____

I certify that in the performance of the work for which this permit is issued, I shall not employ any person in any manner so as to become subject to the Worker's Compensation laws of California.

NOTE: If, after making such certificate, the applicant for the permit should become subject to the Worker's Compensation provisions of this code, he shall forthwith comply with the provisions of Section 3700 or his permit shall be deemed revoked.

I certify that I have read this application and state that the above information is correct. I agree to comply with all City ordinances and State laws relating to pending construction. I further agree to hold the City of Garden Grove free and harmless from any liability arising out of injury or bodily damage resulting from work performed pursuant to this permit.

PERMIT APPLICANT SIGNATURE DATE 5-7-79

BUSINESS TAX CERTIFICATE INFORMATION

I certify that the following Contractor's License No. 229210 and Classification B1 is in full force and effect.

ROY D. ASHLEY (PRINT) CONTRACTOR ROY D. ASHLEY (SIGNATURE) CONTRACTOR OR AUTHORIZED AGENT DATE 5-7-79

BUSINESS TAX CERTIFICATE NO. _____ EXPIRATION DATE _____

I certify that I am exempt from Section 7031.6 of the Business and Professional Code, Division 3, Chapter 9, Contractors' License Law, under the following Section:

Owner: Section 7044 Minor work under \$100: Section 7048
Employee working for wages only: Section 7053

Other: _____

(PRINT) PROPERTY OWNER (SIGNATURE) PROPERTY OWNER OR AUTHORIZED AGENT DATE

ADDRESS	5481 PARK
LOT NO.	135
BLK NO.	5783
TRACT NO.	1003211
OWNER	JUDSON
TEL. NO.	898-3206
MAILING ADDRESS	SAME
CITY	
ZIP	
TEL. NO.	
STATE LIC. NO. & TYPE	
VALIDATION	
CONTRACTOR	ROY D. ASHLEY CONST.
MAILING ADDRESS	12792 SPRING ST. G.G. 92645
CITY	
ZIP	
TEL. NO.	897-6827
STATE LIC. NO.	329210
PRESENT BLDG. USE	R-1 SINGLE-FAM.
PROPOSED BLDG. USE	SAME
DESCRIBE WORK TO BE DONE	CONVERT EXIST. GAR. TO FRMR. ADD GAR & FIREPLACE
NEW <input type="checkbox"/> ADD'N <input checked="" type="checkbox"/> ALTER <input type="checkbox"/> REPAIR <input type="checkbox"/> DEMOLISH <input type="checkbox"/>	
FLOOR AREA (SQ. FT.)	460.47
NO. OF DWELLING	1
STORIES	1
UNITS	1
If work is not started within 120 days from date of issue or if abandoned for more than 120 days, this permit will be null and void.	
A FEE MAY BE CHARGED FOR RE-INSPECTION DUE TO NEGLIGENCE, INCOMPLETE WORK, OR FAILURE TO MAKE CORRECTIONS.	
RELOCATION	
PRESENT BLDG. ADDRESS	
MOVING CONTRACTOR	
ADDRESS	

I, INSPECTOR

ELECTRICAL PERMIT

INSPECTION RECORD

FEES

For Applicant to Fill in

SINGLE PHASE SERVICE SIZE <input type="checkbox"/> UG <input type="checkbox"/> OH			IF NOT LISTED BELOW SEE CODE	NO.	EA.	FEE
AMPS	VOLTS	RIG. CONDUIT	Residential (R-1 & R-3) sq. ft.	460		9.20
THREE PHASE SERVICE SIZE <input type="checkbox"/> 3 Wire <input type="checkbox"/> 4 Wire <input type="checkbox"/> UG <input type="checkbox"/> OH			Garage, Reald. (M) sq. ft.	473	47	4.73
AMPS	VOLTS	RIG. CONDUIT	Service Meter, Single Phase			
APPROVAL	DATE	INSPECTOR	Service Meter, Three Phase			
Underground			Add'l. Meter, Three Phase			
Conduit			Temporary Power Pole			
Wiring - Rough			Pole, Power, Light, etc.			
Heater			Sub-Panels 1 ϕ			
Fixtures & Trim			Sub-Panels 3 ϕ			
Motors			Outlets			
			Fixtures			
			Fixtures, Merc. Quartz, etc.			
			Heater - Not Over 1650 W			
			Washer			
			Dryer	1		2.00
			Water Heaters			
			Dishwasher			
			Domestic Range or Oven			
			Disposal			
			Power Apparatus - H.P., K.W. or K.V.A. Motors, Transformers, etc.			
			Not Over 3 each			
			Over 1, Not Over 10 each			
			Over 10, Not Over 50 each			
			Indv. Circuits			
			Time Clock			
			Sign			
			Sign Hookup			
Ufer						
Service						
FINAL	12/18/79					
Utility Notified						
IDENTIFICATION CODE			ITEM	CODE		FEES
			Plan Retention Fee			
			Plan Check			
			Permit Issuance	227		15.93
				535		6
			TOTAL FEES			21.93

ADDRESS			
5481 PARK			
LOT NO.	BLK NO.	TRACT NO.	ELECTRIC PERMIT NO.
			108024A
OWNER		PHONE	
J. JOHNSON		898-3206	
OWNER'S ADDRESS			
SAME			
NEW BUILDING OR ADDITION - SQ. FT.	EXISTING BUILDING REMODEL AREA - SQ. FT.	OCCUPANCY GROUP	USE OF BUILDING AND OR NUMBER OF UNITS
		3-1	1
VALIDATION			
6/9/79		13/04	600
		1304	15-93
ELECTRICAL CONTRACTOR		STATE LIC. NO. & TYPE	
ROY L. ASALEY		329210	
ADDRESS		CITY	PHONE
12792 SPRING ST		G.G.	897-6820
WORKER'S COMPENSATION REQUIREMENTS			
State Compensation Insurance Policy No. _____ Expiration Date _____			
<input type="checkbox"/> I certify that in the performance of the work for which this permit is issued, I shall not employ any person in any manner so as to become subject to the Worker's Compensation laws of California.			
NOTE: If, after making such certificate, the applicant for the permit should become subject to the Worker's Compensation provisions of this code, he shall forthwith comply with the provisions of Section 3700 or his permit shall be deemed revoked.			
<input type="checkbox"/> I certify that I have read this application and state that the above information is correct. I agree to comply with all City ordinances and State laws relating to pending construction. I further agree to hold the City of Garden Grove free and harmless from any liability arising out of injury or bodily damage resulting from work performed relevant to this permit.			
ROY L. ASALEY		5-7-79	
PERMIT APPLICATION SIGNATURE DATE			
BUSINESS TAX CERTIFICATE INFORMATION			
I certify that the following Contractor's License No. 329210 and Classification 05 is in full force and effect.			
ROY L. ASALEY		5-7-79	
(PRINT) CONTRACTOR		DATE	
SIGNATURE OF CONTRACTOR OR AUTHORIZED AGENT			
BUSINESS TAX CERTIFICATE NO. _____ EXPIRATION DATE _____			
I certify that I am exempt from Section 7031.6 of the Business and Professional Code, Division 3, Chapter 9, Contractors' License Law, under the following Section:			
Owner: Section 7044 <input type="checkbox"/> Minor work under \$100: Section 7048 <input type="checkbox"/>			
Employee working for wages only: Section 7053 <input type="checkbox"/>			
Other: _____			
(PRINT) PROPERTY OWNER		(SIGNATURE) PROPERTY OWNER	DATE
A FEE MAY BE CHARGED FOR RE-INSPECTION DUE TO NEGLIGENCE, INCOMPLETE WORK, OR FAILURE TO MAKE CORRECTIONS.			

BUILDING PERMIT NO. 109321A
ELECTRICAL PERMIT NO. 109324A

VENT. HEAT. AIR COND. PERMIT NO.

LAND USE: _____ AUTHORIZED BY: _____ BUILDING: _____ DATE: 6-7-79

INSPECTOR: _____

BUILDING PERMIT

Inspection Requests
638-6771

General Information
638-6661

PG #

INSPECTION RECORD

For Applicant to Fill in

OCCUPANCY		APPROVAL				DATE	INSPECTOR
USE ZONE	TYPE	FRONT	LEFT	RIGHT	REAR		
		<i>No Change</i>					<i>5481 Park</i>
PLANNING ACTION							<i>Jackson</i>
LAND USE APPROVED BY							148862A
REMARKS							<i>5481 Park</i>
GG SANT DIS FEE REQ'D							<i>6602</i>
PARCEL MAP							
R/W DEDICATION							
FEES AND BONDS		REV. CODE	AMOUNT				
ST BOND							
WATER BOND							
WATER ASSESSMENT							
WATER ASSESSMENT							
PAY AWAY FEE							
PARK & RECREATION							
DRAINAGE FEE							
PLANNING FEE							
BLDG PERMIT <i>pre roof</i>					<i>15.00</i>		
BLDG PERMIT					<i>39.00</i>		
ISPLANCE					<i>10.00</i>		
VALUATION							
		TOTAL FEES				<i>64.00</i>	
APPROVED BY							
<i>[Signature]</i>							
						<i>7-18-86</i>	

WORKER'S COMPENSATION REQUIREMENTS	
I, the undersigned, as the contractor, hereby certify that I am licensed under the provisions of the Workmen's Compensation Act, Chapter 103, Statutes of the State of Florida, and that I shall not employ any person in any capacity whatsoever in connection with the performance of the work herein described unless such person is covered by a policy of workmen's compensation insurance.	
NOTE: The contractor is responsible for the payment of the workmen's compensation insurance premium for all employees.	
I have read the above and agree to comply with the provisions of the Workmen's Compensation Act, Chapter 103, Statutes of the State of Florida, and to pay the premium for the workmen's compensation insurance for all employees engaged in the performance of the work herein described.	
<i>[Signature]</i> <i>July 19 1986</i>	

BUSINESS TAX CERTIFICATE INFORMATION	
I hereby certify that the following is a true and correct copy of the Business Tax Certificate for the year ending on the date of this permit.	
PRINT CONTRACTOR	SIGNATURE CONTRACTOR
	<i>[Signature]</i>

RELOCATION	
I hereby certify that the following is a true and correct copy of the Relocation Certificate for the year ending on the date of this permit.	
I have read the above and agree to comply with the provisions of the Relocation Act, Chapter 103, Statutes of the State of Florida, and to pay the premium for the relocation insurance for all employees engaged in the performance of the work herein described.	

5481 Park
Jackson
5481 Park
6602
 ARCH
 ENGR
 MECHANICAL

Jim Zembke
Delet
Cycloclayes *Cyclo 9000*
898848 *436436 C3*

6111 intake air *2000*
steel shingle *22 ft*
waterproofing

2600

I. INSPECTOR

PLUMBING PERMIT

INSPECTION RECORD

FEES

For Applicant to Fill in

APPROVALS	DATE	INSPECTOR	TYPE OF FIXTURE OR ITEM	NO.	EACH	\$ FEE
Soil Piping			Water Closet (toilet)			
			Bath Tub			
Ground Plumbing	6/12/79	ATON	Shower			
			Lavatory (Wash Basin)			
Rough Plumbing	7/23/79	ATON	Kitchen Sink			
			Garbage Disposal			
Gas Piping	7/23/79	ATON	Laundry Tub or Tray			
			Water Heater	1		3.00
Gas Vent			Floor Sink			
			Floor Drain			
Sewer	6/8/79	ATON	Dish Washer			
			Drinking Fountain			
Main Drain and Vacuum Lines			Urinal			
			Gas System - Outlets			
Water Heater			Building Sewer (First 100 ft.)	1		6.00
			Building Sewer (Add'l 100 ft.)			
Backwash			Building Sewer (ea. add'l drain)			
			Rainwater Drain			
Water Lateral			Swimming Pool Piping			
			Sand Traps/Receptors			
			Automatic Washing Machine	1		3.00
			Water Softeners			
			Backwash - Trap			
			Water Lateral			
			Backflow Protective Devices			
			Water Piping (ea. 100 ft.)			
			Lawn Sprinklers (S.F.D. Only)			
			Lawn Sprinklers (other)			
FINAL	12/12/79					
UTILITY CO. NOTIFIED						
IDENTIFICATION CODE			ITEM	CODE	FEES	
			Plan Retention Fee			
			Plan Check			
			Permit	228		12.00
			Issuance	535		6.00
			TOTAL FEES			18.00
BUILDING PERMIT NO.	ELECTRICAL PERMIT NO.	AUTHORIZED BY				
109321A	109324A	LAND USE	BUILDINGS	DATE		
If work is not started within 120 days from date of issue or if abandoned for more than 120 days, this permit will be null and void.		MR 6-7-79				

ADDRESS
5481 PARK

LOT NO. BLDG NO. TRACT NO. PERMIT NO.
109322A

OWNER
JASON PHONE
898-3206

OWNER'S ADDRESS
SAME CITY

NEW BUILDING OR ADDITION - AREA SQ. FT. EXISTING BUILDING RENOVATED AREA SQ. FT. OCCUPANCY GROUP USE OF BUILDING OR NUMBER OF UNITS

VALIDATION
6/9/79 135M 6.00
137M 12.00

PLUMBING CONTRACTOR
ROY L. ASHLEY STATE LIC. NO. & TYPE
529210

ADDRESS CITY PHONE
12792 SPRING ST. GG. 897685

WORKER'S COMPENSATION REQUIREMENTS

State Compensation Insurance Policy No. _____ Expiration Date _____

I certify that in the performance of the work for which this permit is issued, I shall not employ any person in any manner so as to become subject to the Worker's Compensation laws of California.

NOTE: If, after making such certificate, the applicant for the permit should become subject to the Worker's Compensation provisions of this code, he shall forthwith comply with the provisions of Section 3700 or his permit shall be deemed revoked.

I certify that I have read this application and state that the above information is correct. I agree to comply with all City ordinances and State laws relating to pending construction. I further agree to hold the City of Garden Grove free and harmless from any liability arising out of injury or bodily damage resulting from work performed pursuant to this permit.

ROY L. ASHLEY 5-7-79
PERMIT APPLICANT SIGNATURE DATE

BUSINESS TAX CERTIFICATE INFORMATION

I certify that the following Contractor's License No. **529210** and Classification **Plumbing** is in full force and effect.

ROY L. ASHLEY **ROY L. ASHLEY** 5-7-79
(PRINT) CONTRACTOR (SIGNATURE) CONTRACTOR OR AUTHORIZED AGENT DATE

BUSINESS TAX CERTIFICATE NO. _____ **EXPIRATION DATE** _____

I certify that I am exempt from Section 7031.5 of the Business and Professional Code, Division 3, Chapter 9, Contractor's License Law, under the following Section:
Owner: Section 7044 Minor work under §100: Section 7045
Employee working for wages only: Section 7053

Other: _____

(PRINT) PROPERTY OWNER (SIGNATURE) PROPERTY OWNER OR AUTHORIZED AGENT DATE

A FEE MAY BE CHARGED FOR RE-INSPECTION DUE TO NEGLIGENCE, INCOMPLETE WORK, OR FAILURE TO MAKE CORRECTIONS.

CITY OF GARDEN GROVE
Public Works & Development

HEATING, VENTILATING, REFRIGERATION & AIR COND. PERMIT

Inspection Requests
638-6771

General Information
638-6661

For Applicant to Fill in

INSPECTION RECORD

FEEES

APPROVALS	DATE	INSPECTOR	TYPE OF FIXTURE OR ITEM	NO.	EA.	\$ FEE
FURNACE			Furnace to & Incl. 100M B.T.U.			
FURNACE VENTS			More than 100M & Incl. 500M B.T.U.			
GAS PIPING			More than 500M & Incl. 1MM B.T.U.			
DUCTS			Installation or Relocation of Susp. Heater			
SINGLE DUCT FAN VENT			Installation or Relocation of Wall Heater			
KITCHEN HOOD			Installation or Relocation of Unit Heater			
AIR HANDLING UNIT			Installation of Appliance Vent Only			
EVAPORATIVE COOLER			Repair, Alteration or Addition to any Heating or Cooling System	1		500
BOILER OR COMPRESSOR			Incidental Gas Piping			300
DECORATIVE APPLIANCE			Each Range Hood Incl. Duct and Fan			
			Each Vent Fan Connected to a Single Duct			
			Each Ventilating System not a Part of a Heating or Air Conditioning System Authorized by Permit			
			Boiler or Compressor to & Incl. 5 Hp.			
			Absorption System to & Incl. 100M B.T.U.			
			Boiler or Compressor to & Incl. 15 Hp.			
			Absorption System to & Incl. 500M B.T.U.			
			Boiler or Compressor to & Incl. 30 Hp.			
			Absorption System to & Incl. 1MM B.T.U.			
			Boiler or Compressor to & Incl. 50 Hp.			
			Absorption System to & Incl. 2MM B.T.U.			
			Boiler or Compressor over 50 Hp.			
			Each Evaporative Cooler			
			Air Handling Unit to & Incl. 2M C.F.M.			
			Air Handling Unit to & Incl. 10M C.F.M.			
			Air Handling Unit over 10M C.F.M.			
			OTHER:			
FINAL	12/12/79					
UTILITY CO. NOTIFIED						
IDENTIFICATION CODE			ITEM	CODE		FEEES
			Plan Retention Fee			
			Plan Check			
			Permit	229		800
			Issuance	535		600
			TOTAL FEES			1400
BUILDING PERMIT NO.			AUTHORIZED BY			
ELECTRIC PERMIT NO.			LAND USE	BUILDING	DATE	
109321A-109324A				AIR	6-2-79	
If work is not started within 120 days from date of issue or if abandoned for more than 120 days, this permit will be null and void.						

ADDRESS
5481 PARK

LOT NO. BLK NO. TRACT NO. PERMIT NO.
109323A

OWNER
JUDSON PHONE
898-3206

OWNER'S ADDRESS
SAME

NEW BUILDING OR ADDITION - AREA SQ. FT. EXISTING BUILDING REMODEL AREA SQ. FT. OCCUPANCY GROUP USE OF BUILDING OR NUMBER OF UNITS
12-1 1

VALIDATION
6/7/79 **133H 600**
132H 800

HEATING CONTRACTOR
Roy L. Ashley Const. STATE LIC. NO. & TYPE
329210

ADDRESS CITY PHONE
12792 SPRING ST. G.G. 897-6827

WORKER'S COMPENSATION REQUIREMENTS

State Compensation Insurance Policy No. _____ Expiration Date _____

I certify that in the performance of the work for which this permit is issued, I shall not employ any person in any manner so as to become subject to the Worker's Compensation laws of California.

NOTE: If, after making such certificate, the applicant for the permit should become subject to the Worker's Compensation provisions of this code, he shall forthwith comply with the provisions of Section 3700 or his permit shall be deemed revoked.

I certify that I have read this application and state that the above information is correct. I agree to comply with all City ordinances and State laws relating to pending construction. I further agree to hold the City of Garden Grove free and harmless from any liability arising out of injury or bodily damage resulting from work performed relevant to this permit.

Roy L. Ashley **5-7-79**

PERMIT APPLICANT SIGNATURE DATE

BUSINESS TAX CERTIFICATE INFORMATION

I certify that the following Contractor's License No. **329210** and Classification **B-1** is in full force and effect.

Roy L. Ashley **5-7-79**

(PRINT) CONTRACTOR (SIGNATURE) CONTRACTOR OR AUTHORIZED AGENT DATE

BUSINESS TAX CERTIFICATE NO. _____ **EXPIRATION DATE** _____

I certify that I am exempt from Section 7031.5 of the Business and Professional Code, Division 3, Chapter 9, Contractors' License Law, under the following Section:

Owner: Section 7044 Minor work under \$100: Section 7049

Employee working for wages only: Section 7053

Other: _____

(PRINT) PROPERTY OWNER (SIGNATURE) PROPERTY OWNER OR AUTHORIZED AGENT DATE

A FEE MAY BE CHARGED FOR RE-INSPECTION DUE TO NEGLIGENCE, INCOMPLETE WORK, OR FAILURE TO MAKE CORRECTIONS.

INSPECTOR

CITY OF GARDEN GROVE

PLOT PLAN

PUBLIC WORKS & DEVELOPMENT

OWNER

JUDSON

JOB ADDRESS

5481 PARK

PERMIT NO. 1099

NAME OF CONSTRUCTION LENDER & BRANCH

ASSESSORS PARCEL NO.

LOT

BLOCK

TRACT

135

5283

PLEASE CHECK ONE OR MORE

New Addition Alteration Repair Move Demolish

ADDRESS

CITY

DATE

5-7-79

JOB DESCRIPTION

CONVERT EXIST. GAR. TO FIRE

PERMIT VALUE

ADD ATTACHED BASE F.P. 12876

SHOW NORTH ARROW, PROPERTY LINES AND ADJACENT STREETS.

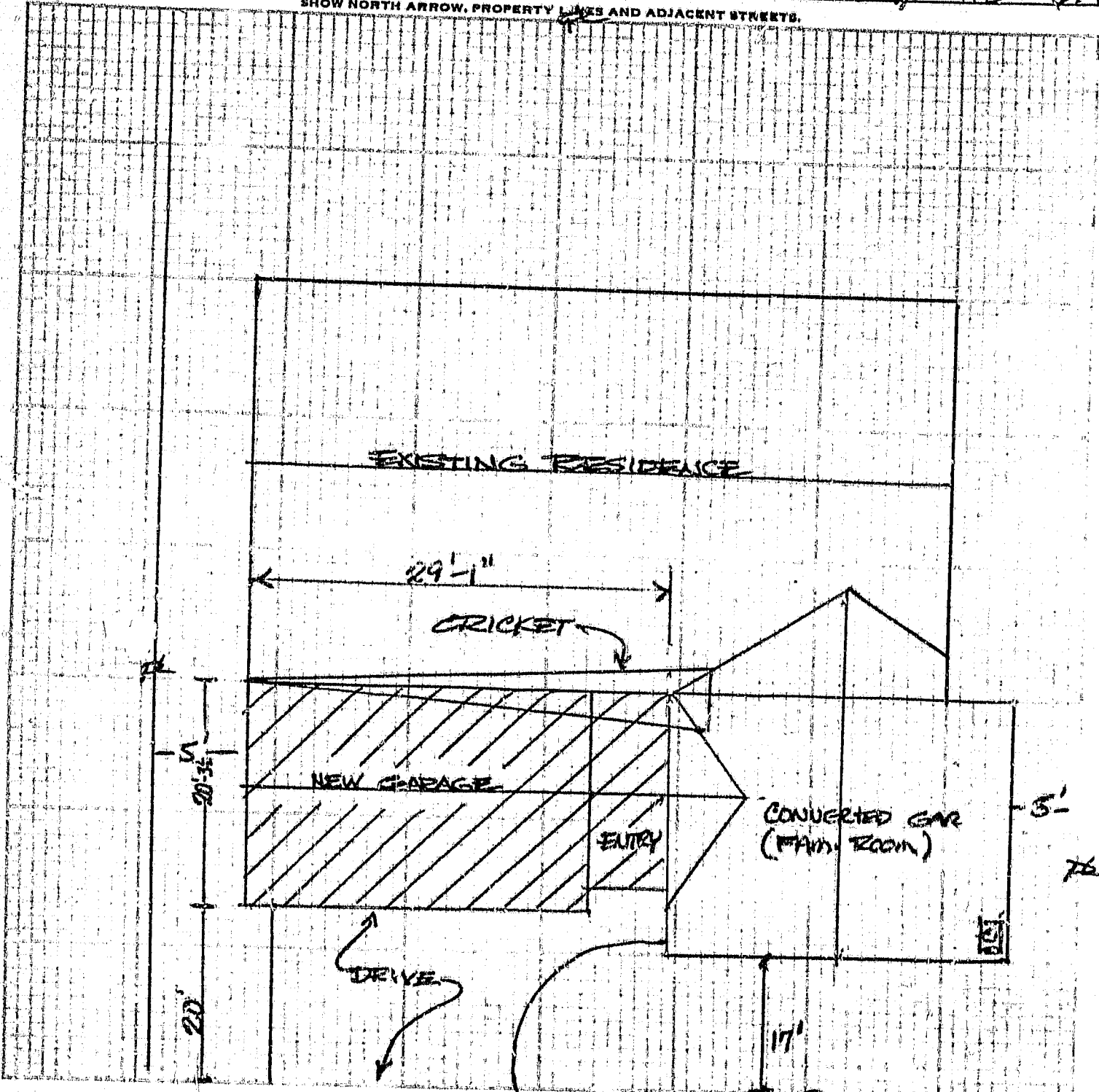

PLOT PLAN APPROVED BY _____

#1 Building Insp./#2 Assessor/#3 Permittee/#4 File I certify the information hereon is complete and correct.

Ray & Oakley

PARK AVE

5481

2

STREET NAME

ADDRESS

APT. NO.

CARD NO.

PERMIT NO. : 18747 Inspector area: D11
 Type : E
 Date Issued : 06/14/93
 Title :
 Desc :
 Location : 5481 PARK AVE
 Suite :
 Parcel number : 21730308 Owner: FLATEBO
 Occupancy :
 Applicant : ANAHEIM HEATING Phone Number : 714-772-9699
 1418 S. CENTRAL PARK
 ANAHEIM CA 92802

PWR APPLIC OPTD IHP KW KVA	1	3.00
DOUBLE PERMIT FEE	1	3.00
ISSUANCE	1	15.00
CULTURAL ARTS	1	1.00
GENERAL PLAN	1	2.00

E PER	3.00
E PER	3.00
ISS	15.00
MISC.	2.00
MISC.	1.00

OH4279A 6-14-93 CHECK 24.00

INSPECTION RECORD

APPROVAL	DATE	INSPECTOR
Underground		
Conduit		
Wiring - Rough		
Heater		
Fixtures & Trim		
Motors		
Ufer		
Service		

3200		3.00
3223 PERMITS/GENE		2.00
3224 PERMITS/CULT		1.00
3227 ELECTRICAL P		3.00
3517 ISSUANCE FEE		15.00

FILE

MV

24.00

741-5332

741-5307

If work is not started within 180 days from date of issue or if abandoned for more than 180 days, this permit will be null and void.

A FEE MAY BE CHARGED FOR RE-INSPECTION DUE TO NEGLIGENCE, INCOMPLETE WORK, OR FAILURE TO MAKE CORRECTIONS.

FINAL 12-7-93 
 Utility Notified



PERMIT NO. : 18746
 Type : H
 Date Issued : 06/14/93
 Title :
 Desc :
 Location : 5481 PARK AVE
 Suite :
 Parcel number : 21730308
 Occupancy :
 Applicant : ANAHEIM HEATING
 1418 S CENTRAL PARK
 ANAHEIM CA 92802

Inspector area: D11

Owner: PLATEBO

Phone Number : 714-772-9699

FURNACE TO 1000 BTU	1	9.00
BOILER/COMPRESSOR TO 3 HP	1	9.00
DOUBLE PERMIT FEE	1	18.00
CULTURAL ARTS	1	1.00
GENERAL PLAN	1	2.00
ISSUANCE	1	15.00

H PER	18.00
H PER	18.00
ISS	15.00
MISC.	2.00
MISC.	1.00

0H4278A 6-14-93 CHECK 54.00

INSPECTION RECORD

APPROVAL DATE INSPECTOR

Furnace _____
 Furnace Vents _____
 Gas Piping _____
 Ducts _____
 Duct Fan Vent _____
 Kitchen Hood _____
 Air Handl Unit _____
 Evap Cooler _____
 Boiler Comp _____
 Decor Appl _____

3200		18.00
3223	PERMITS/GENE	2.00
3224	PERMITS/CULT	1.00
3229	HEATING PERM	18.00
3517	ISSUANCE FEE	15.00

54.00

MK

741-5332
741-5307

If work is not started within
 180 days from date of issue or
 if abandoned for more than 180
 days, this permit will be null
 and void.
 A FEE MAY BE CHARGED FOR RE-
 INSPECTION DUE TO NEGLIGENCE,
 INCOMPLETE WORK, OR FAILURE TO
 MAKE CORRECTIONS.

FINAL 12: 7-9-93 [Signature]

Utility Notified _____

CITY OF GARDEN GROVE
11391 ACACIA PKWY.
GARDEN GROVE, CA 92640
714-741-5310

TEMP. DECLARATION PAGE

PERMIT # 18747
14748

TYPE OF PERMIT:

Mechanical / Electrical

OWNER-BUILDER DECLARATION

I hereby affirm that I am exempt from the Contractors License Law for the following reason (Sec. 7031.5, Business and Professions Code: Any city or county which requires a permit to construct, alter, improve, demolish, or repair any structure, prior to its issuance, also requires the applicant for such permit to file a signed statement that he or she is licensed pursuant to the provisions of the Contractors License Law (Chapter 9 (commencing with Section 7000) of Division 3 of the Business and Professions Code) or that he or she is exempt therefrom and the basis for the alleged exemption. Any violation of Section 7031.5 by any applicant for a permit subjects the applicant to a civil penalty of not more than five hundred dollars (\$500).):

I, as owner of the property, or my employees with wages as their sole compensation, will do the work, and the structure is not intended or offered for sale (Sec. 7044, Business and Professions Code: The Contractors License Law does not apply to an owner of property who builds or improves thereon, and who does such work himself or herself or through his or her own employees, provided that such improvements are not intended or offered for sale. If, however, the building or improvement is sold within one year of completion, the owner-builder will have the burden of proving that he or she did not build or improve for the purpose of sale.)

I, as owner of the property, am exclusively contracting with licensed contractors to construct the project (Sec. 7044, Business and Professions Code: The Contractors License Law does not apply to an owner of property who builds or improves thereon, and who contracts for such projects with a contractor(s) licensed pursuant to the Contractors License Law.)

I am exempt under Sec. _____ B.&P.C. for this reason _____
Date _____ Owner _____

CERTIFICATE OF EXEMPTION FROM WORKERS' COMPENSATION INSURANCE

(This section need not be completed if the permit is for one hundred dollars (\$100) or less.)

I certify that in the performance of the work for which this permit is issued, I shall not employ any person in any manner so as to become subject to the Workers' Compensation Laws of California.

Date _____ Applicant _____

NOTICE TO APPLICANT: If, after making this Certificate of Exemption, you should become subject to the Workers' Compensation provisions of the Labor Code, you must forthwith comply with such provisions or this permit shall be deemed revoked.

LICENSED CONTRACTORS DECLARATION

I hereby affirm that I am licensed under provisions of Chapter 9 (commencing with Section 7000) of Division 3 of the Business and Professions Code, and my license is in full force and effect.

License Class 6201 Lic. No. 594843
Date 6/14/93 Contractor Steve [Signature]

WORKERS' COMPENSATION DECLARATION

I hereby affirm that I have a certificate of consent to self-insure, or a certificate of Workers' Compensation Insurance, or a certified copy thereof (Sec. 3800, Lab.C.)

Policy No. WC 236647 Company PAC News and [Signature]

Certified copy is hereby furnished.
 Certified copy is filed with the county building inspection department or county department.

Date 6/14/93 Applicant [Signature]

HAZMAT/AQMD

1. Will the applicant or future building occupant handle a hazardous material or a mixture containing a hazardous material equal to or greater than the amounts specified in the hazardous materials information guide?

Yes No

2. Will the intended use of the Building by the applicant or future building occupant require a permit for construction or modification from the South Coast Air Quality Management District (SCAQMD)? See permitting checklist for guidelines.

Yes No

3. I have read the hazardous material information guide and the SCAQMD permitting checklist. I understand my requirements under the State of California Health and Safety Code, Sections 25505, 25533, and 25534 concerning hazardous material reporting.

Yes No

4. I declare under penalty of perjury that the information above is true and correct.

Applicant's Signature: _____ Date _____

DEMOL/ASBESTOS

Section 19827.5 of the State of California, Health and Safety Code states in part:

"A demolition permit shall not be issued by any city ... as to any building or other structure except upon receipt from the permit applicant of a copy of each written asbestos notification regarding the building that has been required to be submitted to the United States Environmental Protection Agency or to a designated state agency, or both, pursuant to Part 61 of Title 40 of the Code of Federal Regulations, or the successor to that part. The permit may be issued without the applicant submitting a copy of the written notification if the applicant declares that the notification is not applicable to the scheduled demolition project."

An applicant for a demolition permit in the City of Garden Grove, I certify that: I have read the excerpt from Section 19827.5 of the Health and Safety Code provided above; the information I have provided on this form is true and correct; and I further certify the following:

On the attached _____ pages are copies of all written asbestos notifications regarding the above referenced building that are required to be submitted to the United States Environmental Protection Agency or to a designated state agency, or both, pursuant to Part 61 of Title 40 of the Code of Federal Regulations, or successor to that part.

I declare that the written asbestos notification is not applicable to the scheduled demolition project.

Applicant's Signature: _____ Date _____

I certify that I have read this application and state that the above information is correct. I agree to comply with all city and county ordinances and state laws relating to building construction, and hereby authorize representatives of this county to enter upon the above mentioned property for inspection purposes.

Signature of Applicant or Agent _____ Date _____

Issued By: _____

MK

DATE: _____

6-14-93