

PLUMBING PERMIT

Public Works & Development - Garden Grove, Ca.

Inspection 638-6771

Information 638-6661

INSTRUCTION: USE TYPEWRITER OR BALL POINT PEN, PRESS FIRMLY. BE SURE ALL COPIES ARE LEGIBLE. NO ERASURES PERMITTED. A DOUBLE FEE WILL BE CHARGED IF WORK IS STARTED BEFORE PERMIT IS ISSUED.

For Applicant to Fill in (Please Print)

Address: **11311 Bowles** Permit No. **081613A**
 Lot No. Tract No.

Owner: **Greenlaw, S.**
 Owner's Address: **same**

Plumbing Contractor: **Pacific Installers**
 Contractor's Address: **7541 Anthony Pl**
 Phone: **831-4770** State License: **211898**

Occupancy: **Dwelling**
 New Bldg. VALIDATION
 Exist. Bldg.

NOV 25-75 11 008 N*****6.75
 I hereby acknowledge that I have read this application and state that the above is correct and agree to comply with all ordinances and State laws regulating plumbing.
 I hereby certify that I am properly registered with and/or licensed as required by the City of Garden Grove and/or State of California, or that I am the legal owner of the above described property, and I certify that in the performance of the work for which this permit is issued I shall not employ any person in violation of the workmen's compensation laws of the State of California.

Signature of Permittee: **A.E. Goss** Date: **11/21**

INSPECTION RECORD

APPROVALS	DATE	INSPECTOR
Soil Piping		
Ground Plumbing		
Rough Plumbing		
Gas Piping		
Gas Vent		
Sewer		
Main Drain and Vacuum Lines		
Water Heater		
Backwash		
Water Lateral		

Rep. for vent

11-23-75

PERMIT FEES		
NO.	TYPE OF FIXTURE OR ITEM	\$ FEE
	Water Closet (toilet)	\$1.75
	Bath Tub	1.75
	Shower	1.75
	Lavatory (Wash Basin)	1.75
	Kitchen Sink	1.75
1	Garbage Disposal	1.75
	Laundry Tub or Tray	1.75
	Water Heater	1.75
	Floor Sink	1.75
	Floor Drain	1.75
	Dish Washer	1.75
	Drinking Fountain	1.75
	Urinal	1.75
	Gas System - Outlets	1.75
	Building Sewer (First 100 ft.)	6.00
	Building Sewer (Add'l 100 ft.)	2.00
	Building Sewer (ea. add'l drain)	3.00
	Rainwater Drain	2.00
	Swimming Pool Piping	1.75
	Sand Traps/Receptors	1.75
	Automatic Washing Machine	1.75
	Water Softeners	1.75
	Backwash - Trap	1.75
	Water Lateral	1.75
	Backflow Protective Devices	2.00
	Water Piping (ea. 100 ft.)	2.00
	Lawn Sprinklers (Single Dwellings Only)	2.00
	Lawn Sprinklers (other)	10.00

FEES	
REC'D BY:	PLAN CHECKS
AUTHORIZED BY:	PERMIT \$
DATE 11-25-75	ISSUANCE \$ 5.00

FINAL UTILITY CO. NOTIFIED

I, INSPECTOR TOTAL \$ **6.75**

Bldg. Permit #

PLUMBING PERMIT

Public Works & Development - Garden Grove, Ca.
 Inspection 638-6771 Information 638-6661

INSTRUCTION: USE TYPEWRITER OR BALL POINT PEN. PRESS FIRMLY. BE SURE ALL COPIES ARE LEGIBLE. NO ERASURES PERMITTED. A DOUBLE FEE WILL BE CHARGED IF WORK IS STARTED BEFORE PERMIT IS ISSUED.

For Applicant to Fill in (Please Print)

Permit No.

Address

11311 Bowles Ave

089223 A

Lot No.

Tract No.

Owner

D.B. Greenlaw

Owner's Address

11311 Bowles Ave

Plumbing Contractor

Pacific Installers

Contractor's Address

3541 Anthony

Phone

839-4770

City

State License No.

211598

PERMIT FEES

NO.	TYPE OF FIXTURE OR ITEM	EACH	\$ FEE
	Water Closet (toilet)	\$1.75	
	Bath Tub	1.75	
	Shower	1.75	
	Lavatory (Wash Basin)	1.75	
	Kitchen Sink	1.75	
	Garbage Disposal	1.75	
	Laundry Tub or Tray	1.75	
✓	Water Heater	1.75	
	Floor Sink	1.75	
	Floor Drain	1.75	
	Dish Washer	1.75	
	Drinking Fountain	1.75	
	Urinal	1.75	
	Gas System - Or. Htr.	1.75	
	Building Sewer (First 100 ft.)	6.00	
	Building Sewer (Add'l 100 ft.)	2.00	
	Building Sewer (ea. add'l drain)	3.00	
	Rainwater Drain	2.00	
	Swimming Pool Piping	1.75	
	Sand Traps/Receptors	1.75	
	Automatic Washing Machine	1.75	
	Water Softeners	1.75	
	Backwash - Trap	1.75	
	Water Lateral	1.75	
	Backflow Protective Devices	2.00	
	Water Piping (ea. 100 ft.)	2.00	
	Lawn Sprinklers (Single Dwellings Only)	2.00	
	Lawn Sprinklers (other)	10.00	

~~300~~ 1200

New Bldg.

Exist. Bldg.

VALIDATION

I hereby acknowledge that I have read this application and state that the above is correct and agree to comply with all ordinances and State laws regulating plumbing.
 I hereby certify that I am properly registered with and/or licensed as required by the City of Garden Grove and/or State of California, and I certify that I am the legal owner of the above described property, and I certify that in the performance of the work for which this permit is issued I shall not employ any person in violation of the workmen's compensation laws of the State of California.

Signature of Permittee

A.E. Goss

Date

INSPECTION RECORD

APPROVALS	DATE	INSPECTOR
Soil Piping		
Ground Plumbing		
Rough Plumbing		
Gas Piping		
Gas Vent		
Sewer		
Main Drain and Vacuum Lines		
Water Heater	5-3-77	JMS
Backwash		
Water Lateral		

FEES

REC'D BY:

AUTHORIZED BY

DATE

12-29-76

PLAN CHECKS

PERMIT ^{min} \$

ISSUANCE \$

TOTAL \$

~~1000~~

11 00 FINAL

6 00

1700

UTILITY CO. NOTIFIED

Bldg. Permit #

05-0008 - 9/75

CITY OF GARDEN GROVE
Public Works & Development

BUILDING PERMIT

Inspection Request:
638-6771

General Information
638-6661

For Applicant to Fill in

INSPECTION RECORD

PC #	OCC. PANTRY	TYPE	OCC. LOAD	FIRE SPRINK.	APPROVAL	DATE	INSPECTOR
	I	V				1/22/79	M
USE ZONE	R-1				FOUNDATION & LOCATION		
FIRE ZONE		Eav Proj.	N/C	N/C	CONCRETE FLOOR		
		Setbacks			REINFORCING		
					ROOF SHTG		
PLANNING ACTION					ROUGH FRAME		
LAND USE APPROVED BY					INSULATION, ENERGY		
REMARKS:					LATH OR DRYWALL		
					PLAS. BROWN CT.		
					SOUND INSULATION		
					SMOKE DETECTOR		
					PARKING		
					LANDSCAPING		
G.G. SANT. DIS. FEE REQ'D.	O.C. SANT. DIS. FEE REQ'D.	DATE	INITIAL		LAND USE FINAL		
					FINAL	1-8-79	
PARCEL MAP					UTILITY RELEASE		
R/W DEDICATION							

ADDRESS
11311 Bowles Ave. Garden Grove

LOT NO. 63 BLK NO. 2091 TRACT NO. 108592A

OWNER: Mr. Walley Garden Grove 92640
MAILING ADDRESS: Garden Grove

ARCH
 ENGR.
MAILING ADDRESS: 11620 Anabel City 92640
TEL. NO. 292442

VALIDATION: 1/19/79
Ron Wilson 600 287 21.00

CONTRACTOR: 11620 Anabel, Garden Grove 92640
MAILING ADDRESS: Garden Grove
TEL. NO. (714) 577-6163 292442

PRESENT BLDG. USE: _____
PROPOSED BLDG. USE: _____

FEES AND BONDS		REV. CODE	AMOUNT
ST. BOND			
WATER BOND			
WATER ASSMT. FEE (ACRG.)			
WATER ASSMT. FEE (FT.)			
PARKWAY TREE FEE			
PARK & REC. FEE (DIST.)			
DRAIN ASSMT. FEE (DIST.)			
PLAN RETENTION FEE			
BLDG. PLAN CHECK	520	787	
BLDG. PERMIT FEE	524	2100	
ISSUANCE	535	600	
VALUATION \$ 1035.00	TOTAL FEES	34	87
AUTHORIZED BY: JS/CB	DATE: 1/19/79		

WORKER'S COMPENSATION REQUIREMENTS

State Compensation Insurance Policy No. 90003648 Expiration Date 9/30/79

I certify that in the performance of the work for which this permit is issued, I shall not employ any person in any manner so as to become subject to the Worker's Compensation laws of California.

NOTE: If, after making such certificate, the applicant for the permit should become sub. ct to the Worker's Compensation provisions of this code, he shall forthwith comply with the provisions of Section 3700 or his permit shall be deemed revoked.

I certify that I have read this application and state that the above information is correct. I agree to comply with all City ordinances and State laws relating to pending construction. I further agree to hold the City of Garden Grove free and harmless from any liability arising out of injury or bodily damage resulting from work performed relevant to this permit.

PERMIT APPLICANT SIGNATURE: _____ DATE: 1/19/79

BUSINESS TAX CERTIFICATE INFORMATION

I certify that the following Contractor's License No. and Classification _____ is in full force and effect.

(PRINT) CONTRACTOR _____ (SIGNATURE) CONTRACTOR OR AUTHORIZED AGENT _____ DATE _____

BUSINESS TAX CERTIFICATE NO. _____ EXPIRATION DATE _____

I certify that I am exempt from Section 7031.5 of the Business and Professional Code, Division 3, Chapter 9, Contractors Licen. Law, under the following Section:
Owner: Section 7044 Minor work under \$100: Section 7048
Employee working for wages only: Section 7053

Other: _____

(PRINT) PROPERTY OWNER _____ (SIGNATURE) PROPERTY OWNER OR AUTHORIZED AGENT _____ DATE _____

DESCRIBE WORK TO BE DONE: Reconstruct block fence. 6' x 4'. Blockwall 75' (wind damage)

NEW ADD'N ALTER. REPAIR DEMOLISH

FLOOR AREA: 75' length NO. OF STORIES: _____ NO. OF DWELLING UNITS: _____

If work is not started within 120 days from date of issue or if abandoned for more than 120 days, this permit will be null and void.

A FEE MAY BE CHARGED FOR RE-INSPECTION DUE TO NEGLIGENCE, INCOMPLETE WORK, OR FAILURE TO MAKE CORRECTIONS.

RELOCATION

PRESENT BLDG. ADDRESS: _____
MOVING CONTRACTOR: _____
ADDRESS: _____

I. INSPECTOR

BUILDING PERMIT PLOT PLAN
Public Works & Development Dept.
CITY OF GARDEN GROVE

PLEASE USE BALL-POINT PEN

1

JOB ADDRESS 11311 BOWLS AVE.		PERMIT NO. 106532A	
ASSESSOR'S PARCEL NO.	LOT 63	BLOCK	TRACT 2091
JOB DESCRIPTION (PLEASE CHECK) <input type="checkbox"/> New <input type="checkbox"/> Addition <input type="checkbox"/> Alteration <input checked="" type="checkbox"/> Repair <input type="checkbox"/> Move <input type="checkbox"/> Demolish			PERMIT VALUE 1035 ²²
DATE 1/19/79		USE 4" x 6" BRICK WALL	
PLOT PLAN APPROVED BY OWNER Walley			

DIMENSION PLOT PLAN COMPLETELY SHOWING ALL STRUCTURES ON THE LOT AND THEIR USE.

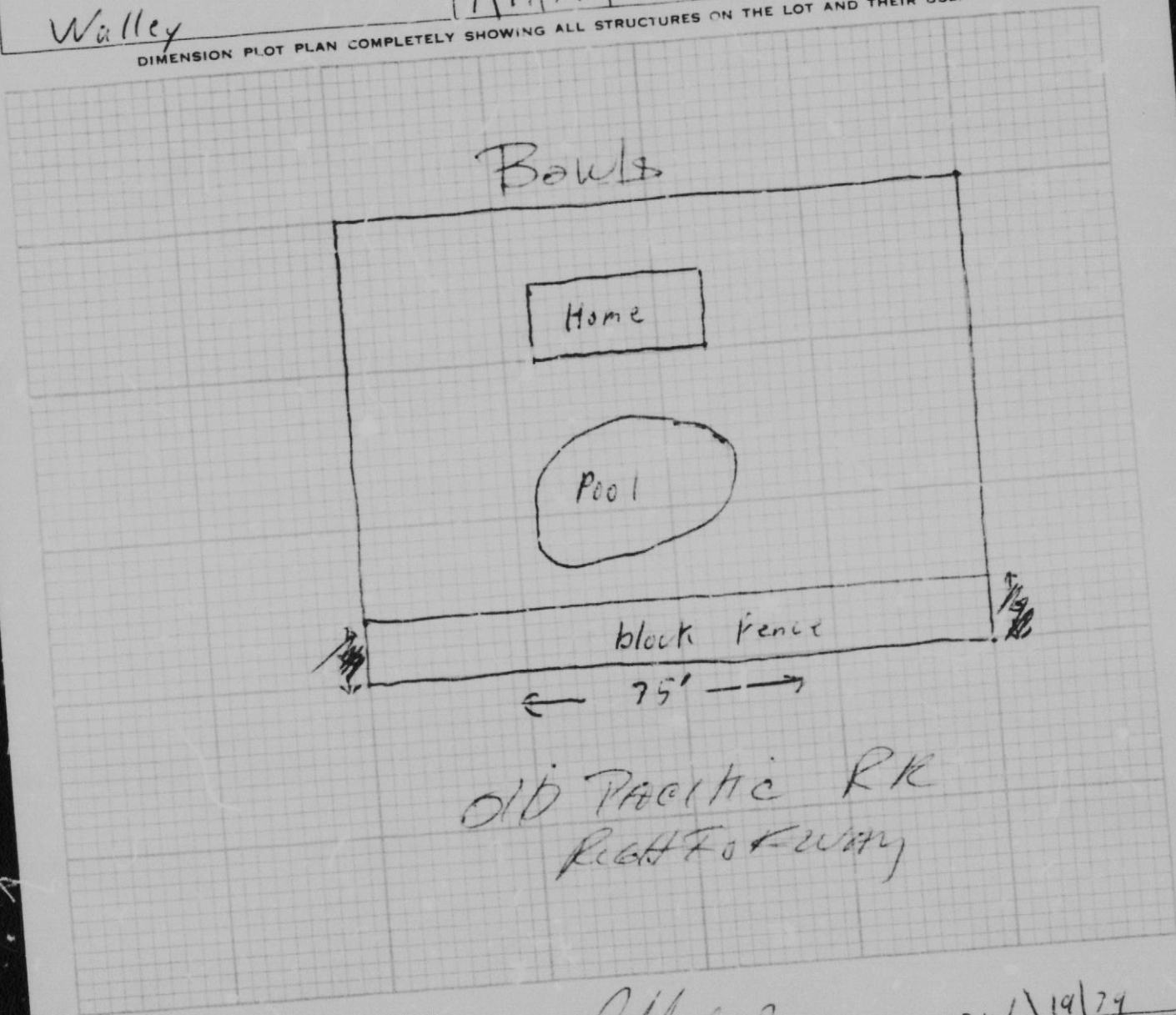

#1 Building Insp. / #2 Assessor / #3 File / #4 Permittee
I certify the information hereon is complete and correct. By

J. A. Murray

Date 1/19/79

DS-002 - 9/77

CITY OF GARDEN GROVE
Public Works & Development

PLUMBING PERMIT

Inspection Requests
638-6771

General Information
638-6661

For Applicant to Fill in

INSPECTION RECORD

APPROVALS	DATE	INSPECTOR	TYPE OF FIXTURE OR ITEM	NO.	EACH	\$ FEE
			Water Closet (toilet)			
			Bath Tub			
			Shower			
			Lavatory (Wash Basin)			
			Kitchen Sink			
			Garbage Disposal			
			Laundry Tub or Tray			
			Water Heater			
			Floor Sink			
			Floor Drain			
			Dish Washer			
			Drinking Fountain			
			Urinal			
			Gas System - Outlets			
			Building Sewer (First 100 ft.)			
			Building Sewer (Add'l 100 ft.)			
			Building Sewer (ea. add'l drain)			
			Rainwater Drain			
			Swimming Pool Piping			
			Sand Traps/Receptors			
			Automatic Washing Machine			
			Water Softeners			
			Backwash - Trap			
			Water Lateral			
			Backflow Protective Devices			
			Water Piping (ea. 100 ft.)			
			Lawn Sprinklers (S.D. Only)			
			Lawn Sprinklers (other)			

FEEES

K4

ADDRESS: 11311 BOWLES AVE

LOT NO. BLK NO. TRACT NO. PERMIT NO. 128466A

OWNER: JOHN H. WALLEY

PHONE: 539-4152

CITY: G.G.

OWNER'S ADDRESS: 11311 BOWLES AVE G.G.

NEW BUILDING OR ADDITION - AREA: SQ. FT. 01/28/83

EXISTING BUILDING REMODEL AREA: SQ. FT. 3.00

OCCUPANCY GROUP: PLBPER

USE OF BUILDING AND OR NUMBER OF UNITS: #0105

VALIDATION: ISSNCE 10.00

CHECK ***13.00

PLUMBING CONTRACTOR: OWNER

STATE LIC. NO. & TYPE:

ADDRESS: CITY: PHONE:

WORKER'S COMPENSATION REQUIREMENTS

State Compensation Insurance Policy No. _____ Expiration Date _____

I certify that in the performance of the work for which this permit is issued, I shall not employ any person in any manner so as to become subject to the Worker's Compensation laws of California.

NOTE: If, after making such certificate, the applicant for the permit should become subject to the Worker's Compensation provisions of this code, he shall forthwith comply with the provisions of Section 3700 or his permit shall be deemed revoked.

I certify that I have read this application and state that the above information is correct. I agree to comply with all City ordinances and State laws relating to pending construction. I further agree to hold the City of Garden Grove free and harmless from any liability arising out of injury or bodily damage resulting from work performed pursuant to this permit.

Signature: John H. Walley DATE: 1/28/83

BUSINESS TAX CERTIFICATE INFORMATION

I certify that the following Contractor's License No. _____ and Classification _____ is in full force and effect.

(PRINT) CONTRACTOR (SIGNATURE) CONTRACTOR OR AUTHORIZED AGENT DATE

BUSINESS TAX CERTIFICATE NO. _____ EXPIRATION DATE _____

I certify that I am exempt from Section 7031.6 of the Business and Professional Code, Division 3, Chapter 9, Contractors' License Law, under the following Section:

Owner: Section 7044 Minor work under \$100: Section 7048

Employee working for wages only: Section 7053

Other: JOHN H. WALLEY

(PRINT) PROPERTY OWNER (SIGNATURE) PROPERTY OWNER OR AUTHORIZED AGENT DATE

FINAL 2/4/83 ADAM

UTILITY CO. NOTIFIED

IDENTIFICATION CODE

BUILDING PERMIT NO. ELECTRICAL PERMIT NO.

LAND USE AUTHORIZED BY BUILDING DATE: NR 1-28-83

If work is not started within 120 days from date of issue or if abandoned for more than 120 days, this permit will be null and void.

ITEM	CODE	FEEES
Plan Retention Fee		
Plan Check	3225	300
Permit Issuance	3517	1000
TOTAL FEES		1300

I, INSPECTOR



**CITY OF GARDEN GROVE
BUILDING SERVICES**

**11311 BOWLES AVE
PERMIT#:16-0553
ISSUED:2/23/16**

General Info : 714-741-5307
Inspection Requests : 855-380-8758

Owner PAGE			Telephone		Zip 92841	Building Address 11311 BOWLES AVE		
Address 11311 BOWLES AVE			City GARDEN GROVE		State CA	Suite/Unit/Building		
Applicant SUNCREST SOLAR ELECTRIC			Telephone (801) 924-1100		Zip 84111	TYPE Miscellaneous		ISSUED BY Lizabeth Vasquez
Address 420 E SOUTH TEMPLE SUITE 280			City SALT LAKE CITY		State UT	Inspector Dist. K6	Parcel Number 13223210	LOT TRACT
State Licence 987868			Expires 10/31/15		City Licence		Expires	
Contractor SUNCREST SOLAR ELECTRIC			Telephone (801) 924-1100		Zip 84111	Valuation \$0.00		
Address 420 E SOUTH TEMPLE SUITE 280			City SALT LAKE CITY		State UT	Final Inspector's Signature <i>TCH For DW</i> Date <i>4/11/16</i>		
State Licence 987868			Expires 10/31/15		City Licence		Expires	
Floor Area(sq. ft.)			Residential/Commercial Residential					
Job Description INSTALL ROOF MOUNT SOLAR PHOTOVOLTAIC SYSTEM/PANEL UPGRADE TO 200A/A/C DISCONNECT								
DECLARATION								
I certify that I have read this application/permit and state that the information on all pages of this document is correct. I agree to comply with all City and County ordinances and State laws relating to building construction, and hereby authorize representatives of this City and County to enter upon the above mentioned property for inspection purposes.								
X Applicant's Signature <i>Austin K Teasdale</i>			Print Name <i>Austin K Teasdale</i> Date <i>02/23/2016</i>					

F E E S	Description	Quantity	Amount
	Electrical Plan Check		\$80.00
	Distribution panel	1	\$30.00
	Pwr App 10Hp, 10kw Max		\$12.00
	Service 6V ma, 200 amps max	1	\$30.00
	Issuance Fee	1	\$35.00
	Permit		\$160.00
	Building Plan Check		\$202.50
	TOTAL		\$549.50

This is a building permit when properly filled out, signed and validated, and is subject to expiration if work thereunder is suspended for 180 days.

**Permit Type: Photovoltaic
Permit/ELEC**



11222 Acacia Parkway, Garden Grove, CA 92840 TEL:(714)741-5307

[Back To Details] [Enter Cash Receipt Information] [Print Invoice]

Invoice Number: 27319
 Site Address: 11311 BOWLES AVE
 Work Description: INSTALL ROOF MOUNT SOLAR PHOTOVOLTAIC SYSTEM/PANEL Permit Number 16-0553
 UPGRADE TO 200A/A/C DISCONNECT
 Application: A-226366 Total Amount of Invoice: \$549.50
 Invoice Date: 2/23/16 10:15:50 AM

Finance Code Information

Finance Code Description	Finance Code Number	Amount
1 Building Plan Check	B910	\$202.50
2 Permit	B915	\$160.00
3 Issuance	B920	\$35.00
4 Service 600V, 200A Max	E120	\$30.00
5 Pwr App 10Hp, 10Kw Max	E201	\$12.00
6 Distribution Panel	E245	\$30.00
7 Elec Plan Check	E910	\$80.00
Total		\$549.50

Application Contacts

Role	Name	Address	City	Phone
1 Applicant Contractor	SUNCREST SOLAR ELECTRIC	420 E SOUTH TEMPLE SUITE 280	SALT LAKE CITY	(801) 924-1100
2 Owner	PAGE	11311 BOWLES AVE	GARDEN GROVE	