

MAGNOLIA			011088			1
STREET	AE		ADDRESS		APT. NO.	CARD NO.

ELECTRICAL PERMIT

DEVELOPMENT SERVICES DEPARTMENT

GARDEN GROVE, CALIF.

632-6771

INSTRUCTION: USE TYPEWRITER OR BALL POINT PEN, PRESS FIRMLY. BE SURE ALL COPIES ARE LEGIBLE. NO ERASURES PERMITTED. A DOUBLE FEE WILL BE CHARGED IF WORK IS STARTED BEFORE PERMIT IS ISSUED. (PLEASE PRINT)

LOT NO.	TRACT NO.	IF NOT LISTED BELOW SEE CODE	NUMBER	EACH	FEE
		Residential (1 & 2) sq. ft.		.015	
		Garage, Resid. (1) sq. ft.		.01	
		Service Meter, Single Phase		5.00	
		Service Meter, Three Phase	1	5.00	5.00
		Temporary Power Pole		5.00	
		Pole, Power, Light, etc.		3.00	
		Sub-Panels 1 @		2.00	
		Sub-Panels 3 @	1	2.00	2.00
		Outlets	18	.20	3.60
		Fixtures	7	.20	1.40
		Fixtures, Merc. Quartz, etc.		1.00	
		Heater-Not Over 1650 W		2.00	
		Washer		2.00	
		Dryer		2.00	
		Hot Water Heaters		2.00	
		Dishwasher		2.00	
		Domestic Range or Oven		2.00	
		Power Apparatus-H.P., K.W. or K.V.A. Motors, Transformers, etc.			
		Not Over 1 each	1	1.50	1.50
		Over 1, Not Over 10 each	1	3.00	3.00
		Over 10, Not Over 30 each		5.00	
		Time Clock		1.00	
		Sign	1	7.00	7.00
		Sign Hookup		2.00	

FEES

PLAN CHECK \$ 11.95 TOTAL PERMIT \$ 25.90

SINGLE PHASE SERVICE SIZE 30 40
 AMP. VOLTS RIG. CONDUIT
 THREE PHASE SERVICE SIZE 3 WIRE 4 WIRE 30 40
 100 AMP. 125/208 VOLTS 7 1/2" RIG. CONDUIT

I, INSPECTOR R. J. [Signature] PERMIT AUTHORIZED BY [Signature] DATE 2 Aug 74

ADDRESS 11088 MAGNOLIA ELECTRIC PERMIT NO. 072668 A

OWNER S.D.C. PHONE 644 6440

OWNER'S ADDRESS NEWPORT BEACH CITY

NEW BUILDING OR ADDITION - AREA EXISTING BUILDING REMODEL AREA OCCUPANCY GROUP USE OF BUILDING AND OR NUMBER OF UNITS

ELECTRICAL CONTRACTOR A.J. SCHAFFER PHONE 276 5871

ADDRESS P.O. BOX 2063 CITY CYPRUS STATE LIC. NO. 276555

VALIDATION
 AUG-2-74 11 005
 AUG-2-74 11 003

I HAVE CAREFULLY READ THE ABOVE APPLICATION AND KNOW THE SAME TO BE TRUE AND CORRECT. ALL PROVISIONS OF STATE AND LOCAL LAWS COVERING THIS TYPE OF CONSTRUCTION WILL BE COMPLIED WITH WHETHER SPECIFIED HEREIN OR NOT. NO PERSON SHALL BE EMPLOYED IN VIOLATION OF THE LABOR CODE OF THE STATE OF CALIFORNIA.
 SIGNATURE OF PERMITTEE [Signature] DATE 8/1/74

BRANCH CIRCUIT PANEL CIRCUITRY

CIR. NO.	WIRE SIZE	WIRE SIZE	NOMENCLATURE	NO. OF OUTLET	WATTS L1	WATTS L2	WATTS L3
1							
2							
3							
4							
5							
6							

INSPECTION RECORD

APPROVAL	DATE	INSPECTOR
Underground		
Conduit		
Wiring	<u>8/24/74</u>	<u>[Signature]</u>
Heater		
Filter	<u>10/10/74</u>	<u>[Signature]</u>
Use		
Service	<u>10/30/74</u>	<u>[Signature]</u>
FINAL		
Utility Notified		
BUILDING PERMIT NO.	SIGN PERMIT NO.	VENT. HEAT. AIR COND. PERMIT NO.

BUILDING PERMIT

Public Works & Development - Garden Grove, Ca.

Inspection 638-6771

Information 638-6661

FIRE ZONE C-1 RANCY J TYPE V FIRE SPRINK. FRONT LEFT RIGHT REAR
 LEAVE PROJ. SETBACKS ⊙

PLANNING ACTION

LAND USE APPROVED BY

ERB

DATE 4-5-76

FEES AND BONDS

AMOUNT	REQ'D	PROVIDED
PARCEL MAP		
R & D LOCATION		
STREET CLOS.		
WATER BOND		
WATER ASSESS. FEE		
FIRE HYDRANT FEE		
PARKWAY TREE FEE		
PARK & REC. FEE (DCT)		
DRAIN ASSESS. FEE (DCT)		

NOT REQUIRED

REMARKS

LOG SHEET NO.	DATE	INITIAL

INSPECTION RECORD

FOUNDATION & LOCATION	DATE	INSPECTOR
REINFORCING		
ROUGH-FRAME		
INSULATION ENERGY		
LATH & GYPSUM WALL		
PLAS BR. IN CT.		
SOUND INSULATION		
SMOKE DETECTOR		
PARKING		
LANDSCAPING		
LAND ORIGINAL		
FINAL <u>EXEMPT 3-24-76</u>		
UTILITY RELEASE		

VALUATION \$	FEES
REC'D BY <u>ERB</u>	PLAN CHECKS \$ <u>5.00</u>
AUTHORIZED BY <u>ERB</u>	PERMIT \$ <u>10.00</u>
DATE <u>4-5-76</u>	ISSUANCE \$ <u>5.00</u>
TOTAL	\$ <u>20.00</u>

INSTRUCTION: FILL IN AREA WITHIN HEAVY LINES. USE TYPEWRITER OR BALL POINT PEN. PREPARE FIRMLY. BE SURE ALL INFORMATION IS LEGIBLE. NO ERASURE. PENALTY: A DOUBLE FEE WILL BE CHARGED IF WORK IS STARTED BEFORE PERMIT IS ISSUED.

ADDRESS 11055 Magnolia PERMIT NO. 83843A
 CITY Garden Grove ZIP 92641
 OWNER Dennis D. White PHONE NO. 539-5271
 MAILING ADDRESS 11055 Magnolia CITY G.C. ZIP 92641
 MAILING ADDRESS STATE LIST. NO. TEL. NO.

CONTRACTOR OWNER FEE NO. 11055
 MAILING ADDRESS CITY ZIP

VALIDATION	DATE	AMOUNT
	<u>4-5-76</u>	<u>11 055 *****5.00</u>
	<u>4-5-76</u>	<u>11 053 *****15.00</u>

PRESENT BLOCK USE COMMERCIAL
 CONSTRUCTION Hung Sing WALL
 NEAR X ALTER DEMOLISH
 CONSTRUCTION AREA 320 NO. OF DWELLINGS

I hereby certify that I have read this application and state that the applicant is qualified to comply with all applicable laws and regulations relating to building construction in the City of Garden Grove, California. I have reviewed the plans and specifications submitted and find them to be in compliance with the applicable laws and regulations. I have also reviewed the City of Garden Grove rules and regulations relating to the proposed project and find them to be in compliance with the applicable laws and regulations. I have also reviewed the City of Garden Grove rules and regulations relating to the proposed project and find them to be in compliance with the applicable laws and regulations.

CONTRACTORS SIGN BELOW

I hereby certify that I am a licensed contractor and that my license is in full force and effect.

OWNER/BUILDER SIGN BELOW

I hereby certify that I am exempt from the provisions of Sections 9, 10, 11, 12, 13, 14, 15, 16, 17, 18, 19, 20, 21, 22, 23, 24, 25, 26, 27, 28, 29, 30, 31, 32, 33, 34, 35, 36, 37, 38, 39, 40, 41, 42, 43, 44, 45, 46, 47, 48, 49, 50, 51, 52, 53, 54, 55, 56, 57, 58, 59, 60, 61, 62, 63, 64, 65, 66, 67, 68, 69, 70, 71, 72, 73, 74, 75, 76, 77, 78, 79, 80, 81, 82, 83, 84, 85, 86, 87, 88, 89, 90, 91, 92, 93, 94, 95, 96, 97, 98, 99, 100, 101, 102, 103, 104, 105, 106, 107, 108, 109, 110, 111, 112, 113, 114, 115, 116, 117, 118, 119, 120, 121, 122, 123, 124, 125, 126, 127, 128, 129, 130, 131, 132, 133, 134, 135, 136, 137, 138, 139, 140, 141, 142, 143, 144, 145, 146, 147, 148, 149, 150, 151, 152, 153, 154, 155, 156, 157, 158, 159, 160, 161, 162, 163, 164, 165, 166, 167, 168, 169, 170, 171, 172, 173, 174, 175, 176, 177, 178, 179, 180, 181, 182, 183, 184, 185, 186, 187, 188, 189, 190, 191, 192, 193, 194, 195, 196, 197, 198, 199, 200, 201, 202, 203, 204, 205, 206, 207, 208, 209, 210, 211, 212, 213, 214, 215, 216, 217, 218, 219, 220, 221, 222, 223, 224, 225, 226, 227, 228, 229, 230, 231, 232, 233, 234, 235, 236, 237, 238, 239, 240, 241, 242, 243, 244, 245, 246, 247, 248, 249, 250, 251, 252, 253, 254, 255, 256, 257, 258, 259, 260, 261, 262, 263, 264, 265, 266, 267, 268, 269, 270, 271, 272, 273, 274, 275, 276, 277, 278, 279, 280, 281, 282, 283, 284, 285, 286, 287, 288, 289, 290, 291, 292, 293, 294, 295, 296, 297, 298, 299, 300, 301, 302, 303, 304, 305, 306, 307, 308, 309, 310, 311, 312, 313, 314, 315, 316, 317, 318, 319, 320, 321, 322, 323, 324, 325, 326, 327, 328, 329, 330, 331, 332, 333, 334, 335, 336, 337, 338, 339, 340, 341, 342, 343, 344, 345, 346, 347, 348, 349, 350, 351, 352, 353, 354, 355, 356, 357, 358, 359, 360, 361, 362, 363, 364, 365, 366, 367, 368, 369, 370, 371, 372, 373, 374, 375, 376, 377, 378, 379, 380, 381, 382, 383, 384, 385, 386, 387, 388, 389, 390, 391, 392, 393, 394, 395, 396, 397, 398, 399, 400, 401, 402, 403, 404, 405, 406, 407, 408, 409, 410, 411, 412, 413, 414, 415, 416, 417, 418, 419, 420, 421, 422, 423, 424, 425, 426, 427, 428, 429, 430, 431, 432, 433, 434, 435, 436, 437, 438, 439, 440, 441, 442, 443, 444, 445, 446, 447, 448, 449, 450, 451, 452, 453, 454, 455, 456, 457, 458, 459, 460, 461, 462, 463, 464, 465, 466, 467, 468, 469, 470, 471, 472, 473, 474, 475, 476, 477, 478, 479, 480, 481, 482, 483, 484, 485, 486, 487, 488, 489, 490, 491, 492, 493, 494, 495, 496, 497, 498, 499, 500, 501, 502, 503, 504, 505, 506, 507, 508, 509, 510, 511, 512, 513, 514, 515, 516, 517, 518, 519, 520, 521, 522, 523, 524, 525, 526, 527, 528, 529, 530, 531, 532, 533, 534, 535, 536, 537, 538, 539, 540, 541, 542, 543, 544, 545, 546, 547, 548, 549, 550, 551, 552, 553, 554, 555, 556, 557, 558, 559, 560, 561, 562, 563, 564, 565, 566, 567, 568, 569, 570, 571, 572, 573, 574, 575, 576, 577, 578, 579, 580, 581, 582, 583, 584, 585, 586, 587, 588, 589, 590, 591, 592, 593, 594, 595, 596, 597, 598, 599, 600, 601, 602, 603, 604, 605, 606, 607, 608, 609, 610, 611, 612, 613, 614, 615, 616, 617, 618, 619, 620, 621, 622, 623, 624, 625, 626, 627, 628, 629, 630, 631, 632, 633, 634, 635, 636, 637, 638, 639, 640, 641, 642, 643, 644, 645, 646, 647, 648, 649, 650, 651, 652, 653, 654, 655, 656, 657, 658, 659, 660, 661, 662, 663, 664, 665, 666, 667, 668, 669, 670, 671, 672, 673, 674, 675, 676, 677, 678, 679, 680, 681, 682, 683, 684, 685, 686, 687, 688, 689, 690, 691, 692, 693, 694, 695, 696, 697, 698, 699, 700, 701, 702, 703, 704, 705, 706, 707, 708, 709, 710, 711, 712, 713, 714, 715, 716, 717, 718, 719, 720, 721, 722, 723, 724, 725, 726, 727, 728, 729, 730, 731, 732, 733, 734, 735, 736, 737, 738, 739, 740, 741, 742, 743, 744, 745, 746, 747, 748, 749, 750, 751, 752, 753, 754, 755, 756, 757, 758, 759, 760, 761, 762, 763, 764, 765, 766, 767, 768, 769, 770, 771, 772, 773, 774, 775, 776, 777, 778, 779, 780, 781, 782, 783, 784, 785, 786, 787, 788, 789, 790, 791, 792, 793, 794, 795, 796, 797, 798, 799, 800, 801, 802, 803, 804, 805, 806, 807, 808, 809, 810, 811, 812, 813, 814, 815, 816, 817, 818, 819, 820, 821, 822, 823, 824, 825, 826, 827, 828, 829, 830, 831, 832, 833, 834, 835, 836, 837, 838, 839, 840, 841, 842, 843, 844, 845, 846, 847, 848, 849, 850, 851, 852, 853, 854, 855, 856, 857, 858, 859, 860, 861, 862, 863, 864, 865, 866, 867, 868, 869, 870, 871, 872, 873, 874, 875, 876, 877, 878, 879, 880, 881, 882, 883, 884, 885, 886, 887, 888, 889, 890, 891, 892, 893, 894, 895, 896, 897, 898, 899, 900, 901, 902, 903, 904, 905, 906, 907, 908, 909, 910, 911, 912, 913, 914, 915, 916, 917, 918, 919, 920, 921, 922, 923, 924, 925, 926, 927, 928, 929, 930, 931, 932, 933, 934, 935, 936, 937, 938, 939, 940, 941, 942, 943, 944, 945, 946, 947, 948, 949, 950, 951, 952, 953, 954, 955, 956, 957, 958, 959, 960, 961, 962, 963, 964, 965, 966, 967, 968, 969, 970, 971, 972, 973, 974, 975, 976, 977, 978, 979, 980, 981, 982, 983, 984, 985, 986, 987, 988, 989, 990, 991, 992, 993, 994, 995, 996, 997, 998, 999, 1000.

I am the owner of the above property and will accept responsibility for the above work performed by licensed contractor.

I am the owner of the above property and will accept responsibility for the above work with working at the building site and will accept responsibility for my employees and subcontractors.

Dennis D. White B. 4-5-76

If work is not started within 12 months of date of issuance of this permit, the permit shall be void.

RELOCATION

PRESENT BLDG ADDRESS
 MOVING CONTRACTOR ADDRESS

INSPECTOR'S NOTES

7-28-80 Letter of explanation

BUILDING PERMIT PLOT PLAN
 Development Services Department
 CITY OF GARDEN GROVE

1

PERMIT NO.
 83843A

JOB ADDRESS
 11088 MAGNOLIA

ASSESSORS PARCEL NO. LOT BLOCK TRACT
 132-041-19

PLOT PLAN APPROVED BY
 ERG

JOB DESCRIPTION (PLEASE CHECK)
 New Addition Alteration Repair Move Demolish

OWNER
 URTE

DATE
 4/3/76

USE
 ELECTRICAL WALL
 SIGN

PERMIT VALUE
 \$400.00

DIMENSION PLOT PLAN COMPLETELY SHOWING ALL STRUCTURES ON THE LOT AND THEIR USE

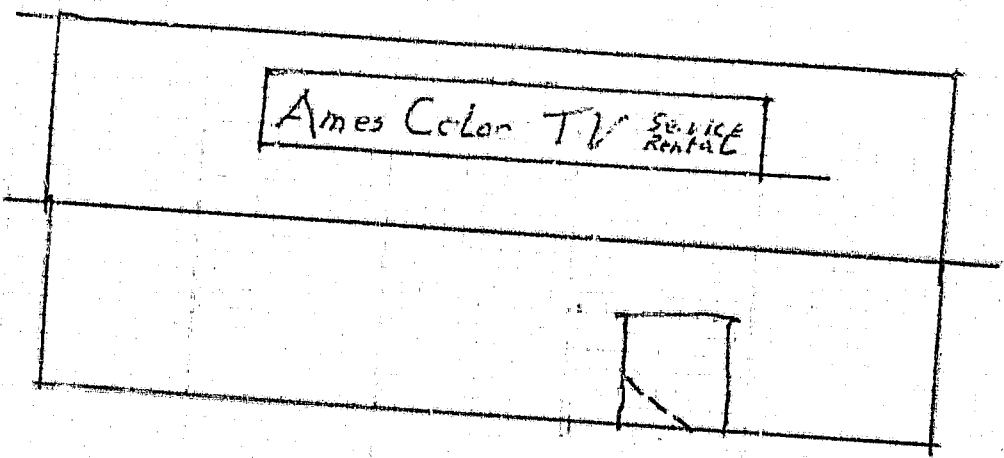

#1 Building Insp. / #2 Assessor / #3 File / #4 Permittee
 I certify the information hereon is complete and correct. By _____

Date _____

No Permit or Plans - Request placed in by owner - JS

CITY OF GARDEN GROVE

Building-Zoning Division

SIGN FIELD CHECK

PERMIT NO. 83843A

ADDRESS: 11088 Magnolia

DATE: 3-17-76

CONTRACTOR: -

PHONE: 539-5271

OWNER: Ames Television - Dennis Urie

RECEIVED BY: JS

(BUILDING) OR (LOT) FRONTAGE: 25'

ZONE: D1

ALLOWABLE SIGN AREA: 75 sq'

Z.A. APPROVAL REQUIRED: _____

EXISTING SIGNS:

PROPOSED SIGNS:

	TYPE	AREA
1.	_____	_____
2.	_____	_____
3.	_____	_____
4.	_____	_____
5.	_____	_____
6.	_____	_____
TOTAL	_____	_____

	TYPE	AREA
7.	<u>Plastic face sign on front of building Electrical</u>	<u>17 1/2' X 2'</u>
8.	_____	_____
9.	_____	_____
10.	_____	_____
11.	_____	_____
12.	_____	_____
TOTAL	_____	_____

COMBINED TOTAL: _____

AMOUNT OVER OR UNDER: _____

COMMENTS: Signs # (), (), () erected prior to issuance of permit.

() Property owner's approval required for pole sign.

() Spacing between pole signs # () and # () inadequate.

() Materials of signs # (), (), () do not meet code.

(APPROVED) (DENIED) BY: [Signature]

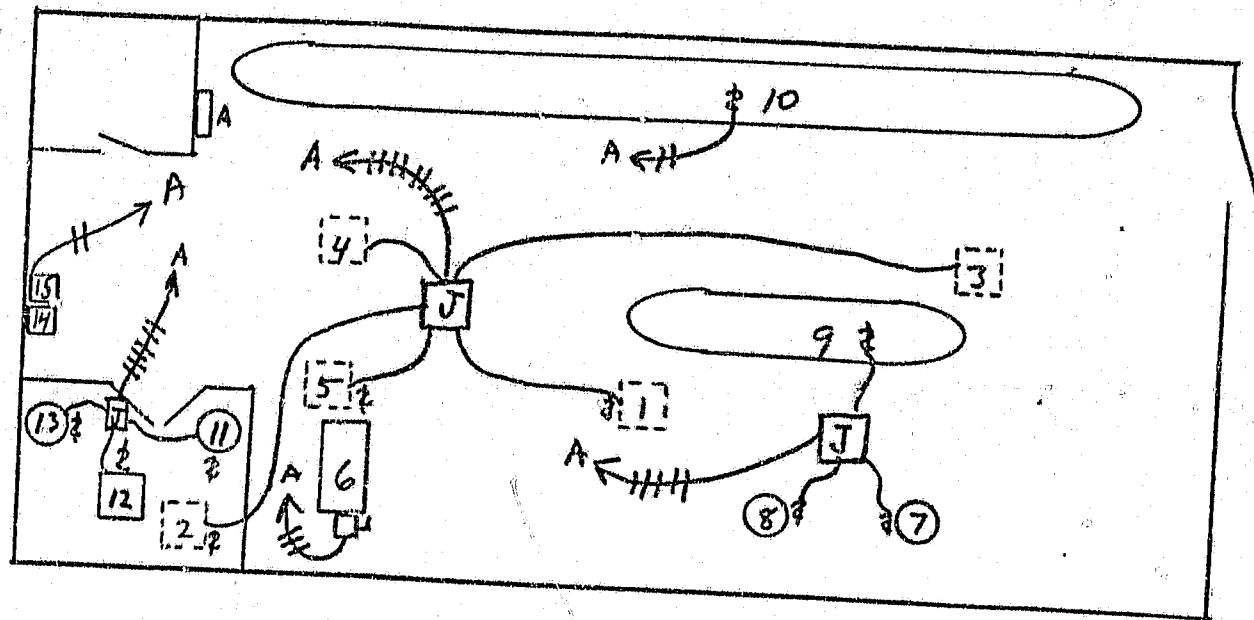

EXISTING U.G. SERVICE
600A 120/240V 1 ϕ 3W
GUTTER FSD

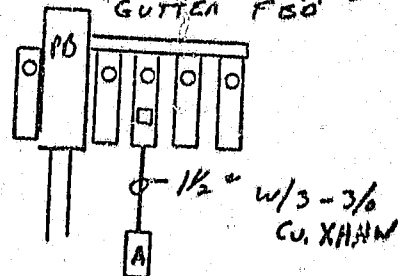

EQUIPMENT

- | | |
|--------------------------|--------------------|
| 1. EXH. FAN (ROOF) | 10. CONVEYOR |
| 2. EXH. FAN (ROOF) | 11. AIR COMPRESSOR |
| 3. EVAP COOLER (ROOF) | 12. BOILER |
| 4. EVAP COOLER (ROOF) | 13. VACUUM |
| 5. SOLVENT COOLER (ROOF) | 14. WASHER |
| 6. DRY CLEANER | 15. DAYER |
| 7. SUZY | |
| 8. TOPPER | |
| 9. CONVEYOR | |

UPGRADE SERVICE TO 200A
120/240V 1 ϕ 3W
UPGRADE SUB PANEL TO 200A
EQUIPMENT HOOKUP
LIGHTING ETC. EXISTING &
BY OTHERS

Dry CLEANER
BCL. INC.
11088 MAGNOLIA
GARDEN GROVE, CA.

KEN'S ELECTRIC SERVICE
LICENSE NO. 379650 C-10
7949 SHOUP AVE.
CANOGA PARK, CA 91304
(213) 884-4034

NEW ELECTRIC SERVICE
 2549 S. HAYDEN BLVD. GARDEN GROVE, CA 92643
 714 952-5500 (714) 952-4044

PANEL A

BC L, INC. DRY CLEANER
 11088 MAGNOLIA
 GARDEN GROVE, CA

200 AMP BUSS MAINLUGS MOUNT SURFACE TOTAL WATTS 35095 TOTAL KW 35 AMPS 146
 120V VOLTS 1 ϕ 60 ~ 3 WSM 1/2 CONDUIT 3/30 CABLES COPPER XHHW

#	Volts	Amps	Watts	LIGHTS	RECEPTACLES	MISC.	REMARKS	WATTS		
								L-1	L-2	L-3
1	1	20	12				GENERAL	1500		
2	1	20	12				LIGHTING		1500	
3	1	20	12					1500		
4	1	20	12				SHOW WINDOW	1500		
5	1	20	12				SIGN		1500	
6	1	20	12				EX FAN	748		
7	2	20	12						748	
8	1	20	12				EX FAN	748		
9	2	20	12						748	
10	1	20	12				EVA? COOLER	1093		
11	1	20	12				EVA? COOLER		1093	
12	2	20	12				SOLVENT COOLER	1122		
13	2	50	6				DRY CLEANER	3783		
14	1	20	12				SUEY	736		
15	1	20	12				TOLPEN		748	
16	1	20	12				CONVEYOR	828		
17	2	20	12				CONVEYOR		1495	
18	1	20	12				AIR COND	1603		
19	1	20	12				BOILER	1023		
20	2	20	12				VACUUM		638	
21	1	20	12				WASHER	638		
22	1	20	12				DRYER	720		
23										
24										
25										
26										
27										
28										
29										
30										
31										
32										
33										
34										
35										
36										
37										
38										
39										
40										
41										
42										

TOTAL (L-1) 17697 (L-2) 17398

TOTAL WATTS 35095 W

TOTAL AMPS 146 A

HEATING, VENTILATING, REFRIGERATION & AIR COND. PERMIT

INSPECTION RECORD

FEES

LB

For Applicant to Fill In

APPROVALS	DATE	INSPECTOR	TYPE OF FIXTURE OR ITEM	NO.	EA.	\$ FEE
FURNACE			Furnace to & incl. 100M B.T.U.			
FURNACE VENTS			More than 100M & incl. 500M B.T.U.			
GAS PIPING			More than 300M & incl. 1MM B.T.U.			
DUCTS			Installation or Relocation of Susp. Heater			
SINGLE DUCT FAN VENT			Installation or Relocation of Wall Heater			
KITCHEN HOOD			Installation or Relocation of Unit Heater			
AIR HANDLING UNIT			Installation of Appliance Vent Only			
EVAPORATIVE COOLER			Repair, Alteration or Addition to any Heating or Cooling System			
BOILER OR COMPRESSOR			Incidental Gas Piping			
DECORATIVE APPLIANCE			Each Range Hood Incl. Duct and Fan			
			Each Vent Fan Connected to a Single Duct	1		5.00
			Each Ventilating System not a Part of a Heating or Air Conditioning System Authorized by Permit			
			Boiler or Compressor to & incl. 5 Hp.	1		5.00
			Absorption System to & incl. 100M B.T.U.			
			Boiler or Compressor to & incl. 15 Hp.			
			Absorption System to & incl. 500M B.T.U.			
			Boiler or Compressor to & incl. 30 Hp.	1		10.00
			Absorption System to & incl. 1MM B.T.U.			
			Boiler or Compressor to & incl. 50 Hp.			
			Absorption System to & incl. 2MM B.T.U.			
			Boiler or Compressor over 50 Hp.			
			Each Evaporative Cooler	2		6.00
			Air Handling Unit to & incl. 2M C.F.M.			
			Air Handling Unit to & incl. 10M C.F.M.			
			Air Handling Unit over 10M C.F.M.			
			OTHER:			
FINAL	12/10/81	ASD				
NOTIFY CO. NOTIFIED						
IDENTIFICATION CODE			ITEM	CODE	FEES	
			Plan Retention Fee			
			Plan Check			
			Permit	3229	26 -	
			ISSUANCE	3517	6 -	
			TOTAL FEES		32.00	
BUILDING PERMIT NO.			ELECTRIC PERMIT NO.			
71953A						
If work is not started within 180 days from date of issue or is abandoned for more than 120 days, this permit will be null and void.			LAND USE		BUILDING	DATE
						12-1-81

ADDRESS: 11088 So Magnolia

LOT NO. BLK NO. TRACT NO. PERMIT NO. 123208A

OWNER: Albert J Keller

OWNER'S ADDRESS: 638-9270 CITY

NEW BUILDING OR ADDITION - AREA: SQ. FT. EXISTING BUILDING REMODEL AREA: SQ. FT. OCCUPANCY GROUP: USE OF BUILDING AND OR PARTS OF UNITS: Single-Family

VALIDATION: HIGHWAY 15500 ONE

HEATING CONTRACTOR: Advanced Steam Equipment STATE ID, NO. & TYPE: C4 263876

ADDRESS: 2636 E. Arthur Long Beach CITY: PHOEN: 531-0855

WORKER'S COMPENSATION REQUIREMENTS
State Compensation Insurance Policy No. WNB137813 Expiration Date 4/1/82
 I certify that in the performance of the work for which this permit is issued, I shall not employ any person in any manner so as to become subject to the Worker's Compensation laws of California.
NOTE: If, after making such certificate, the applicant for the permit should become subject to the Worker's Compensation provisions of this code, he shall forthwith comply with the provisions of Section 5700 or his permit shall be deemed revoked.
 I certify that I have read this application and state that the above information is correct. I agree to comply with all City ordinances and State laws relating to pending construction. I further agree to hold the City of Garden Grove free and harmless from any liability arising out of injury or bodily damage resulting from work performed relating to this permit.

BUSINESS TAX CERTIFICATE INFORMATION
I certify that the following Contractor's License No. and Classification is in full force and effect.
(PRINT) CONTRACTOR (SIGNATURE) CONTRACTOR OR AUTHORIZED AGENT DATE

BUSINESS TAX CERTIFICATE NO. EXPIRATION DATE
I certify that I am exempt from Section 7031.5 of the Business and Professional Code, Division 3, Chapter 9, Contractors' License Law, under the following Section:
Owner: Section 7044 Minor work under \$100: Section 7044
Employee working for wages only: Section 7053
Other:

(PRINT) PROPERTY OWNER (SIGNATURE) PROPERTY OWNER OR AUTHORIZED AGENT DATE

A FEE MAY BE CHARGED FOR REINSPECTION DUE TO NEGLIGENCE, INCOMPLETE WORK, OR FAILURE TO MAKE CORRECTIONS.

I, INSPECTOR

PLUMBING PERMIT

Inspection Requests
638-8771

General Information
638-8881

INSPECTION RECORD

FEES

For Applicant to Fill in

APPROVALS	DATE	INSPECTOR	TYPE OF FIXTURE OR ITEM	NO.	EACH	\$ FEE
So. Piping			Water Closet (Toilet)			
Drain/Pipe/Line			Bath Tub			
Range Plumbing	12/8/81	W. Brown	Shower			
Gas Piping	12/8/81	Agar	Lavatory (Wash Basin)			
Gas Piping			Kitchen Sink			
Gas Piping			Garbage Disposal			
			Laundry Tub or Tray			
			Water Heater			
			Floor Sink			
			Floor Drain	2	1	3-
			Dish Washer			
			Drinking Fountain			
			Urinal			
			Gas System - Outlets	2	3	3-
			Building Sewer (Ft. 100 ft.)			
			Building Sewer (Add'l 100 ft.)			
			Building Sewer (incl. add'l drain)			
			Rainwater Drain			
			Swimming Pool Piping			
			Sand Traps/Receptors			
			Automatic Washing Machine	1	3	3-
			Water Softeners			
			Backwash - Trap			
			Water Lateral			
			Backflow Protective Devices			
			Water Piping (ea. 100 ft.)			
			Lawn Sprinklers (S.F. 6) Only			
			Lawn Sprinklers (other)			

BRESE
11088 So. Magnolia

LG. NO. MKR NO. TRACT NO.

CORNER
Albert J Keller 638-9270

OWNER'S ADDRESS
633 Balford Orange

NEW BUILDING OR ADDITION
NO. FT. 12-01

EXISTING BUILDING
BUILDING NUMBER 12-01

RECORDS
UNBUILT

DEPT. OF BUILDING
NO. 112

VALUATION
ISSUE 6.00
CHECK 15.00

PLUMBING CONTRACTOR
Oscar Steam Engineering

ADDRESS
2636 E. Artesia Long Beach CA 90805

WORKER'S COMPENSATION REQUIREMENTS

State Compensation Insurance Policy No. WNS 81137813

Expiration Date 4/1/82

I certify that in the performance of the work for which this permit is issued, I shall not employ any person in any manner so as to become subject to the Worker's Compensation laws of California.

NOTE: If, after making such certificate, the applicant for the permit should become subject to the Worker's Compensation provisions of this code, he shall forthwith comply with the provisions of Section 3700 or his permit shall be deemed revoked.

I certify that I have read this application and state that the above information is correct. I agree to comply with all City Ordinances and State laws relating to pending construction. I further agree to hold the City of Garden Grove free and harmless from any liability arising out of injury or bodily damage resulting from work performed relevant to this permit.

11/2/81

FINAL 12/9/81 W. Brown

IDENTIFICATION CODE 12-70-81

ITEM	CODE	FEES
Plan Extension Fee		
Plan Check		
Permit	3228	9-
Inspection	3517	6-
TOTAL FEES		15 00

AUTHORIZED BY: JAY

DATE: 12-1-81

IF WORK IS NOT STARTED WITHIN 120 DAYS FROM DATE OF ISSUE OR IF DISCONTINUED FOR MORE THAN 120 DAYS, THIS PERMIT WILL BE NULL AND VOID.

I. INSPECTOR

BUSINESS TAX CERTIFICATE INFORMATION

I certify that the following Contractor's License No. and Classification is in full force and effect.

(PRINT) CONTRACTOR: _____ DATE: _____

(PRINT) PROPERTY OWNER (SIGNATURE) PROPERTY OWNER OR AUTHORIZED AGENT: _____ DATE: _____

BUSINESS TAX CERTIFICATE NO. _____ **EXPIRATION DATE** _____

I certify that I am exempt from Section 7031.5 of the Business and Professions Code, Division 3, Chapter 9, Contractors' License Law, under the following Section:
 Owner: Section 7044 Minor work under \$100. Section 7046
 Employee working for wages only: Section 7053

Other: _____

A FEE MAY BE CHARGED FOR REINSPECTION DUE TO NEGLIGENCE, INCOMPLETE WORK, OR FAILURE TO MAKE CORRECTIONS.

MAGNOLIA

STREET NAME

11088

ADDRESS

APT. NO.

CARD NO.

2

BUILDING PERMIT

Inspection Requests
638-6771

General Information
638-6661

P.C. #

INSPECTION RECORD

For Applicant to Fill in

OCCUPANCY B2	TYPE	OCC. LOAD		FIRE SPRINK.		APPROVAL	DATE	INSPECTOR	ADDRESS
USE ZONE		FRONT	LEFT	RIGHT	REAR				
FIRE ZONE	Evj Proj. Setbacks					CONCRETE FLOOR			LOT NO. BLK NO. TRACT NO. PERMIT NO. 132-061-32 114153A
PLANNING ACTION						REINFORCING			OWNER DENNIS MALONE
LAND USE APPROVED BY						ROUGH FRAME			MAILING ADDRESS CITY ZIP 11088 S. MAGNOLIA
REMARKS:						INSULATION, ENERGY			<input type="checkbox"/> ARCH <input type="checkbox"/> ENGR. DICKERSON SIGN & GRAPHIC
						LATH OR DRYWALL			MAILING ADDRESS CITY ZIP 2930 GRACE LANE Costa Mesa 92626
						PLAS. BROWN CT.			TEL. NO. STATE LIC. NO. & TYPE 546-8150 315917 E-45
						SOUND INSULATION			VALIDATION
						SMOKE DETECTOR			
						PARKING			
						LANDSCAPING			
G.G. SANT. DIS. FEE REQ'D.	O.C. SANT. DIS. FEE REQ'D.			DATE	INITIAL				
PARCEL MAP		REQ'D	PROVIDED						
R/W DEDICATION									
FEES AND BONDS						LAND USE FINAL			
	REV. CODE	AMOUNT				FINAL			
ST. BOND						UTILITY RELEASE			
WATER BOND						IDENTIFICATION CODE			
WATER ASSMT. FEE (ACRG.)									
WATER ASSMT. FEE (FT.)						WORKER'S COMPENSATION REQUIREMENTS			
PARKWAY TREE FEE						State Compensation Insurance Policy No. FARMERS Expiration Date CURRENT			
PARK & REC. FEE (DIST.)						I certify that in the performance of the work for which this permit is issued, I shall not employ any person in any manner so as to become subject to the Worker's Compensation laws of California.			
DRAIN ASSMT. FEE (DIST.)						NOTE: If, after making such certificate, the applicant for the permit should become subject to the Worker's Compensation provisions of this code, he shall forthwith comply with the provisions of Section 3700 or his permit shall be deemed revoked.			
						<input checked="" type="checkbox"/> I certify that I have read this application and state that the above information is correct. I agree to comply with all City ordinances and State laws relating to pending construction. I further agree to hold the City of Garden Grove free and harmless from any liability arising out of injury or bodily damage resulting from work performed relevant to this permit.			
PLAN RETENTION FEE						PERMIT APPLICANT SIGNATURE Dickerson Sign & Graphic DATE 5-5-80			
BLDG. PLAN CHECK		6.50				BUSINESS TAX CERTIFICATE INFORMATION			
BLDG. PERMIT FEE		520	10.40			I certify that the following Contractor's License No. 315917 and Classification E-45 is in full force and effect.			
ISSUANCE		226	10.00			(PRINT) CONTRACTOR DICKERSON SIGN & GRAPHIC DATE 3-5-80			
VALUATION		535	6.00			(SIGNATURE) CONTRACTOR OR AUTHORIZED AGENT Dickerson Sign & Graphic DATE APRIL - 80			
\$ 901.50	TOTAL FEES		22.50			I certify that I am exempt from Section 7031.5 of the Business and Professional Code, Division 3, Chapter 9, Contractors' License Law, and under the following Section:			
AUTHORIZED BY jm				DATE 3-7-80		Owner: Section 7044 <input type="checkbox"/> Minor work under \$100: Section 7048 <input type="checkbox"/>			
						Employee working for wages only: Section 7053 <input type="checkbox"/>			
						Other: _____			
						(PRINT) PROPERTY OWNER (SIGNATURE) PROPERTY OWNER OR AUTHORIZED AGENT DATE			
						CONTRACTOR			
						MAILING ADDRESS CITY ZIP			
						TEL. NO. STATE LIC. NO.			
						PRESENT BLDG. USE RETAIL STORE PROPOSED BLDG. USE RETAIL STORE			
						DESCRIBE WORK TO BE DONE REINSTALL (17) 2'x16' 3/4" INT. ILLUM. SIGN ON BLDG. FACIA.			
						NEW <input checked="" type="checkbox"/> ADD'N <input type="checkbox"/> ALTER. <input type="checkbox"/> REPAIR <input type="checkbox"/> DEMOLISH <input type="checkbox"/>			
						FLOOR AREA (SQ. FT.) 1500 NO. OF STORIES 1 NO. OF DWELLING UNITS _____			
						If work is not started within 120 days from date of issue or if abandoned for more than 120 days, this permit will be null and void.			
						A FEE MAY BE CHARGED FOR RE-INSPECTION DUE TO NEGLIGENCE, INCOMPLETE WORK, OR FAILURE TO MAKE CORRECTIONS.			
						RELOCATION			
						PRESENT BLDG. ADDRESS			
						MOVING CONTRACTOR			
						ADDRESS			

1. INSPECTOR

ELECTRICAL PERMIT

Inspection Requests
634-6771

General Information
638-6661

INSPECTION RECORD

FEES

For Applicant to Fill In

SINGLE PHASE SERVICE SIZE <input type="checkbox"/> UG <input checked="" type="checkbox"/> OH			IF NOT LISTED BELOW SEE CODE			NO.	EA.	FEE
AMPS	VOLTS	RIG. CONDUIT	Residential (R-1 & R-3) sq. ft.					
THREE PHASE SERVICE SIZE <input type="checkbox"/> 3 Wire <input type="checkbox"/> 4 Wire <input type="checkbox"/> UG <input type="checkbox"/> OH			Garage, Resid. (M) sq. ft.					
AMPS	VOLTS	RIG. CONDUIT	Service Motor, Single Phase					
APPROVAL	DATE	INSPECTOR	Service Motor, Three Phase					
Underground			Add'l Motor, Three Phase					
Conduit			Temporary Power Pole					
Wiring - Rough			Pole, Power, Light, etc.					
Heater			Sub-Panels 1 ϕ					
Fixtures & Trim			Sub-Panels 3 ϕ					
Motors			Outlets					
			Fixtures					
			Fixtures, Merc. Quartz, etc.					
			Heater - Not Over 1850 W					
			Washer					
			Dryer					
			Hot Water Heaters					
			Dishwasher					
			Domestic Range or Oven					
			Disposal					
			Power Apparatus - H.P., K.W. or K.V.A. Motors, Transformers, etc.					
			Not Over 1 each					
			Over 1, Not Over 10 each					
			Over 10, Not Over 30 each					
			Indv. Circuits					
			Time Clock					
			Sign					
			Sign Hookup	1		2.00		
Ufer								
Service								
FINAL	10/19/82							
Utility Notified								

ADDRESS: 11088 MAGNOLIA AVE. C/B.

LOT NO. BLK NO. TRACT NO. ELECTRIC PERMIT NO. 132-061-32 114154A

OWNER: DENNIS MALONE 114154A

OWNER'S ADDRESS: 11088 MAGNOLIA AVE. GARDEN GROVE

NEW BUILDING OR ADDITION: 2916 SQ. FT. AREA SIGN

EXISTING BUILDING REMODEL AREA: SQ. FT.

OCCUPANCY GROUP: COMM.

USE OF BUILDING AND OR NUMBER OF UNITS: COMM.

VALIDATION:

ELECTRICAL CONTRACTOR: DIERKERSON SIGN & GRAPHIC 315917-045

STATE LIC. NO. & TYPE: 315917-045

ADDRESS: 2950 GRACE LANE, COSTA MESA 546-8750

PHONE: 546-8750

WORKER'S COMPENSATION REQUIREMENTS

State Compensation Insurance Policy No. _____ Expiration Date _____

I certify that in the performance of the work for which this permit is issued, I shall not employ any person in any manner so as to become subject to the Worker's Compensation laws of California.

NOTE: If, after making such certificate, the applicant for the permit should become subject to the Worker's Compensation provisions of this code, he shall forthwith comply with the provisions of Section 3700 or his permit shall be deemed revoked.

I certify that I have read this application and state that the above information is correct. I agree to comply with all City ordinances and State laws relating to pending construction. I further agree to hold the City of Garden Grove free and harmless from any liability arising out of injury or bodily damage resulting from work performed relevant to this permit.

PERMIT APPLICANT SIGNATURE: _____ DATE: 10-19-82

BUSINESS TAX CERTIFICATE INFORMATION

I certify that the following Contractor's License No. _____ and Classification _____ is in full force and effect.

(PRINT) CONTRACTOR: _____ (SIGNATURE) CONTRACTOR OR AUTHORIZED AGENT: _____ DATE: _____

BUSINESS TAX CERTIFICATE NO. _____ EXPIRATION DATE _____

I certify that I am exempt from Section 7031.5 of the Business and Professional Code, Division 3, Chapter 9, Contractors' License Law, under the following Section:

Owner: Section 7044 Minor work under \$100: Section 704B Employee working for wages only: Section 7053

Other: _____

(PRINT) PROPERTY OWNER: _____ (SIGNATURE) PROPERTY OWNER OR AUTHORIZED AGENT: _____ DATE: _____

A FEE MAY BE CHARGED FOR RE-INSPECTION DUE TO NEGLIGENCE, INCOMPLETE WORK, OR FAILURE TO MAKE CORRECTIONS.

IDENTIFICATION CODE

BUILDING PERMIT NO. 114153A

SIGN PERMIT NO. 114153A

VENT. HEAT. AIR COND. PERMIT NO.

If work is not started within 120 days from date of issue or if abandoned for more than 120 days, this permit will be null and void.

I. INSPECTOR

ITEM	CODE	FEES
Plan Retention Fee		
Plan Check		
Permit Issuance	227	2.00
	535	6.00
TOTAL FEES		8.00

LAND USE AUTHORIZED BY BUILDING DATE

IM 3-7-80

CITY OF GARDEN GROVE

PLOT PLAN

PUBLIC WORKS & DEVELOPMENT 1

OWNER DENNIS MALONE DB THE VIDEO PLACE INC.	JOB ADDRESS 13088 MAGNOLIA AVE	PERMIT NO. 114153A
NAME OF CONSTRUCTION LENDER & BRANCH	ASSESSOR'S PARCEL NO. LOT 132-061-32	BLOCK TRACT
ADDRESS	CITY	PLEASE CHECK ONE OR MORE <input checked="" type="checkbox"/> New <input type="checkbox"/> Addition <input type="checkbox"/> Alteration <input type="checkbox"/> Repair <input type="checkbox"/> Move <input type="checkbox"/> Demolish
	DATE 3-5-80	PERMIT VALUE 901⁰⁰
	JOB DESCRIPTION 2'X16' 3/4" SIGN ON FRONT OF BLDG.	

SHOW NORTH ARROW, PROPERTY LINES AND ADJACENT STREETS.

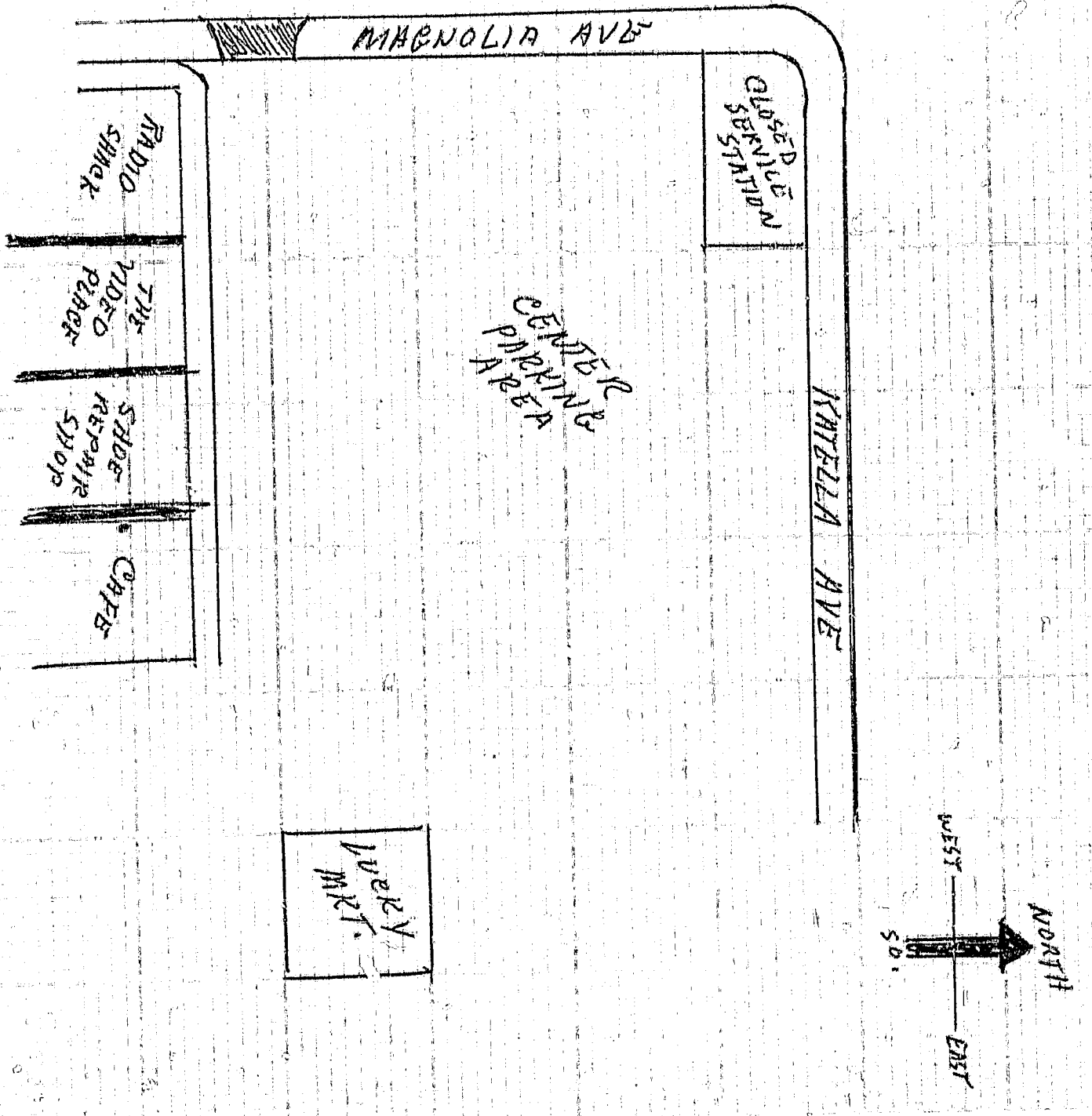

#1 Building Insp./#2 Assessor/#3 Permittee/#4 File
I certify the information hereon is complete and correct.

By Dickinson Sain + Suptic
Rosewill

PLOT PLAN APPROVED BY _____

CITY OF GARDEN GROVE

SIGN FIELD CHECK

ADDRESS: 11088 MARNOLIA
 PERSON TO CONTACT: RAY E. WALKER. RAY E. WALKER PHONE: 534-1631
~~DENNIS MALONE~~
 CONTRACTOR: DICKERSON SIGN & GRAPHIC
 OWNER: DENNIS MALONE.

PERMIT # _____

DATE: 3-15-180

RECEIVED BY: _____

ASSIGNED TO: _____

BY: _____

DATE: 1 1

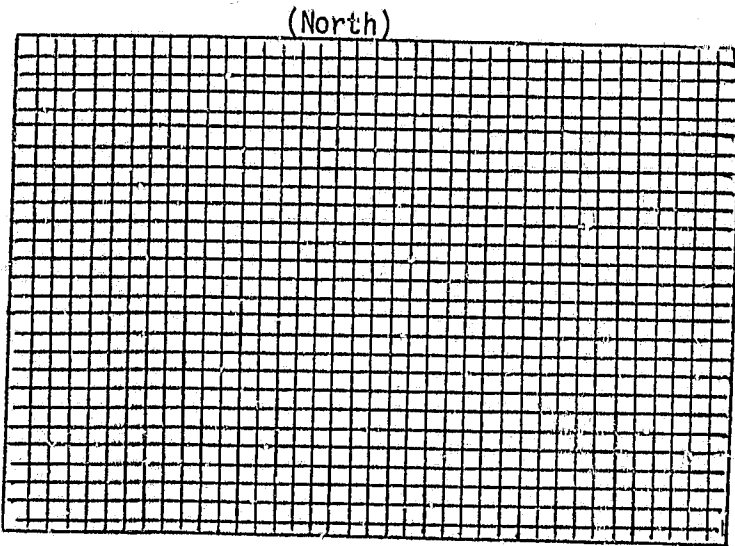

ZONE C-1 PRIMARY SECONDARY
 BUILDING FRONTAGE 254
 LOT FRONTAGE _____
 ALLOWABLE AREA 754

COMMENTS:	TYPE	EXISTING		PROPOSED	
		TYPE	AREA	TYPE	AREA
() OWNERS APPROVAL REQUIRED FOR POLE SIGN	1	_____	_____	7 Wall	324
() SIGNS # (), (), ()	2	_____	_____	8	_____
ERECTED PRIOR TO ISSUANCE OF PERMIT	3	_____	_____	9	_____
() MATERIAL OF SIGNS # (), (), DO NOT MEET CODE.	4	_____	_____	10	_____
() OTHER _____	5	_____	_____	11	_____
	6	_____	_____	12	_____
	TOTAL		<u>324</u>	TOTAL	<u>324</u>

COMBINED TOTAL _____

(OVER) (UNDER) 434

(APPROVED) (DENIED) BY: C. Chen-Strach



General Information: 714-741-5307

CITY OF GARDEN GROVE - DEVELOPMENT SERVICES DEPARTMENT

Inspection Requests: 714-741-5332

PERMIT (PAGE 2 of 2)

PROJECT/SITE/BUILDING DESCRIPTION

JOB Address : 11088 MAGNOLIA ST
 Suite :
 PERMIT NO. : 58478
 Permit Type :
 Type : E
 Owner :
 Applicant : T T SIGNS
 Appl Address : 15173 MORGAN ST
 WESTMINSTER, CA 92683
 Phone : 373-4840
 Insp Dist : SE
 Date : 07/13/01
 Parcel No : 13206131 13206132

PROPOSED WORK:

ELEC FOR WALL SIGN.

FEES

942 22130 GENERAL PLAN	1	2.00
080 32550 CULTURAL ARTS	1	1.00
111 32401 Issuance	1	35.00
111 32412 addt circuits same d	1	6.00
TOTAL		44.00

APPROVAL DATE INSPECTOR

INSPECTION RECORD

Underground _____
 Conduit _____
 Wiring - Rough _____
 Heater _____
 Fixtures & Trim _____
 Motors _____
 Ufer _____
 Service _____

EXPIRED

10-3-02
T.H

AUTHORIZATION

Issued By: jimc Date _____

DECLARATION

I certify that I have read this application/permit and state that the information on all pages of this document is correct. I agree to comply with all City and County ordinances and State laws relating to building construction, and hereby authorize representatives of this City and County to enter upon the above mentioned property for inspection purposes.

Applicant's Signature [Signature]

Print Name THANH MM Date 7-13-01

***** VALIDATION *****

PAID ON 13 Jul 2001 AT 11:15
 RECEIVED BY LARAINEM 198.245.206.215/2 TRANS# 44
 AMOUNT PAID \$137.58 BY CHECK#2070
 TOTAL PAID = \$137.58



General Information: 714-741-5307

CITY OF GARDEN GROVE - DEVELOPMENT SERVICES DEPARTMENT

Inspection Requests: 714-741-5332

PERMIT (PAGE 2 of 2)

PROJECT/SITE/BUILDING DESCRIPTION

JOB Address : 11088 MAGNOLIA ST
 Suite :
 PERMIT NO. : 58477
 Permit Type : SIGN
 Type : B11
 SIGNS
 Owner :
 Applicant : T T SIGNS
 Appl Address : 15173 MORGAN ST
 WESTMINSTER, CA 92683
 Phone : 373-4840
 Insp Dist : SB
 Date : 07/13/01
 Parcel No : 13206131 13206132

Value : 3100
 Floor area : 0

PROPOSED WORK:

(1) CHANNEL LETTER WALL SIGN (ILLUM)

FEES

111 32509 Plan Check	1	20.15
111 32410 Permit	1	31.00
111 32401 issuance	1	35.00
942 22130 General Plan	1	4.98
080 32550 Cultural Arts	1	2.45
TOTAL		93.58

INSPECTION RECORD

APPROVAL	DATE	INSPECTOR
----------	------	-----------

Pre Inspect _____
 Foundation _____
 Concrete Floor _____
 Reinforcing _____
 Masonry _____
 Roof Shtg _____
 Rough Frame _____
 Insul / Energy _____
 Drywall _____
 Lath _____
 Plas. Brown Ct. _____
 Landscaping _____
 Pre Gunitite _____
 Pre Deck _____
 Pre Plaster _____

 Planning Final _____

 Bldg Final _____

 Utility Notified _____

EXPIRED

10-3-02

T.H.

AUTHORIZATION

Issued By: jimc Date _____

DECLARATION

I certify that I have read this application/permit and state that the information on all pages of this document is correct. I agree to comply with all City and County ordinances and State laws relating to building construction, and hereby authorize representatives of this City and County to enter upon the above mentioned property for inspection purposes.

Applicant's Signature Thanh

Print Name THANH MA Date 7-13-01

***** VALIDATION *****
 PAID ON 13 Jul 2001 AT 11:15
 RECEIVED BY LARAINEM 198.245.206.215/2 TRANS# 44
 AMOUNT PAID \$137.58 BY CHECK#2070
 TOTAL PAID = \$137.58
