

212 H. 2010

2112

BUILDING PERMIT

Department of Building
B. C. Adams
Director

CITY OF
GARDEN GROVE

For Applicant to Fill in (Use Ink)

Job Address 12112 Diamond St. Permit No. 7111

Lot No. 75 Tract No. 3537 Blk. No.

Please Attach Maps & Bounds (2 Copies)

ZONING AND BUILDING

Map No. APO Var. No.
Use Zone Main Use Acc. Use
St. Set Back - PL PL
Side Yard Rt Projection
Side Yard Lt Projection
Rear Yard No Parking Sp. Req'd.
Zoning Approved By Date
Group Type Plan Ck.

Remarks:

Owner

Community Homes

Owner's Address

1111 Beverly Blvd., Whittier, Calif.

Description of Work

New Add'n Remodel Relocate

Use of Building

Res. and att. garage

Area of Building

1,209 Sq. Ft.

Valuation \$

12,000.00

Arch. or Engr.

None

Address

None

Contractor

Laramore Const.

Address

1111 Beverly B.

INSPECTION RECORD

APPROVAL	DATE	INSPECTOR
Foundation and Location	9/15/59	J. W. ...
Reinforcing	9/15/59	J. W. ...
Roof Shtg.	10/2/59	J. W. ...
Rough Frame	10/2/59	J. W. ...
Bath or Drywall	11/4/59	E. W. ...
Plas. Brown Ct.	11/16/59	J. W. ...
Utility Release	12/14/59	J. W. ...

Remarks:

I hereby acknowledge that I have read this application and state that the above is correct and agree to comply with all ordinances and State laws regulating building construction.

I hereby certify that I am properly registered with and/or licensed as required by the City of Garden Grove and/or State of California, and that I am the legal owner of the above described property, and I certify that in the performance of the work for which this permit is issued I shall not employ any person in violation of the workman's compensation laws of the State of California.

Signature

Permittee

Albert J. ...

Date

Address 1111 Beverly Blvd., Whittier Lic. No.

PUBLIC WORKS

Street Imp.

Address

By

Date

RELOCATION

PRESENT BLDG. ADDRESS

MOVING CONTRACTOR ADDRESS

INSPECTION FEE

RECEIPT NUMBER

SAFETY

DATE REC'D

REC'D BY

CASH DEP.

DATE REC'D

REC'D BY

RELOCATION AUTHORIZED BY

DATE

FEES

Building Permit \$ 28.00 Rec'd By
Plan Check \$ 14.00 Rec'd By

Remarks:

Permit Authorized By *[Signature]* Date 7-16-59

Routing: \$1 Bldg. Inspector \$2 Office File \$3 Statistics \$4 Owner

BUILDING PERMIT

DEVELOPMENT SERVICES DEPT., GARDEN GROVE 630-6771

INSTRUCTION: FILL IN AREA WITHIN HEAVY LINES. USE TYPEWRITER OR BALL POINT PEN. PRESS HARD. BE SURE ALL COPIES ARE IDENTICAL. NO ERASURES PERMITTED. A DOUBLE FEE WILL BE CHARGED IF WORK IS STARTED BEFORE PERMIT IS ISSUED.

FIRE BOND	OCC. A. TYPE <u>2</u>	OCC. LOAD	FRONT	LEFT	RIGHT	REAR
TYPE <u>R-1</u>	PLANS					
MARK SPACES REQUIRED	SETBACKS		5'-4"		7'-9"	
PLANNING ACTION	Plans					
Lead Use Approved By	Date <u>4-11-72</u>					

Job Address <u>12112 DIAMOND</u>	Permit No. 051852A
Lot No. <u>75</u> Tract No. <u>3537</u>	Bldg. No.
Owner <u>BARRETT, JOHN</u>	Tel. No. <u>897-4114</u>
Mailing Address <u>12112 DIAMOND</u>	City <u>GARDEN GROVE</u>
<input type="checkbox"/> Arch. <input type="checkbox"/> Eng.	State Lic. No. Tel. No.
Mailing Address	City Zip No.

FEES AND BONDS			
	AMOUNT	REQ'D	PROV'D
PARCEL MAP			
R/T DEDICATION			
STREET BOND			
WATER BOND			
WATER ASSMT. FEE			
ADDITIONAL FEE			
PAVEMENT TREE FEE			
LAND ASSESS. FEE			
LAND ASSESS. FEE			

Contractor <u>UNITED REPAIRING SYSTEMS</u>	Lic. No. <u>260356</u>
Mailing Address <u>4100 BOWELL AVE</u>	City <u>ANNHEIM</u>
PRESENT BLDG. USE <u>DWELLING</u>	PROPOSED BLDG. USE <u>FAMILY RM'S & DOWN ROOM</u>
Validation	APR 11 1972 11 167 M****130
DESCRIPTION TO BE DONE	APR 11 1972 11 168 M****260
NEW <input type="checkbox"/> ADD'N <input checked="" type="checkbox"/> ALTER <input type="checkbox"/> REPAIR <input type="checkbox"/> DEMOLISH <input type="checkbox"/>	

INSPECTION RECORD		
APPROVAL	DATE	INSPECTOR
Foundation and Location	<u>4/21/72</u>	<u>[Signature]</u>
Reinforcing		
Roof Shtg.	<u>4-25-72</u>	<u>[Signature]</u>
Rough Frame	<u>5/16/72</u>	<u>[Signature]</u>
Lath or Drywall	<u>5/16/72</u>	<u>[Signature]</u>
Plas. Brown Ct.	<u>6/9/72</u>	<u>[Signature]</u>
Parking		
Landscaping		
Land Use Cond.		
Final	<u>6/9/72</u>	<u>[Signature]</u>
Utility Release		

FLOOR AREA <u>280</u>	NO. OF FLOORS <u>1</u>	NO. OF DWELLING UNITS <u>1</u>
<p>I certify that I have read this application and that the above information is correct. I agree to comply to all City Ordinances and State laws relating to building construction. I certify that in the performance of the above work I shall not employ any person in violation of the Labor Code of California relating to Workman's Compensation Insurance. I further agree to hold the City of Garden Grove free and harmless from any liability arising out of injury or bodily damage resulting from work performed relevant to this permit.</p>		
CONTRACTOR'S SIGN BELOW		
<p>I certify that I am a Licensed contractor and that my license is in full force and effect.</p> <p style="text-align: right;"><u>[Signature]</u> Contractor</p>		
OWNER-BUILDER SIGN BELOW		
<p>I certify that I am exempt from the provisions of Ch. 9, Div. 3, B and P. Code (Contractor's License Law) because (check one):</p> <p><input type="checkbox"/> I am the owner of the above property and will personally perform the above work.</p> <p><input type="checkbox"/> I am the owner of the above property and I will contract to have all of the above work performed by licensed contractors.</p> <p><input type="checkbox"/> I am the owner of the above property and will employ persons to perform the above work with wages as their sole compensation. I will furnish insurance for my employees as required by the Labor Code of California.</p>		
Owner's Signature	By	Authorized Agent
<p>If work is not started within 90 days from date of issue or if abandoned for more than 120 days, this permit will be null and void.</p>		

VALUATION	NOTE: INCLUDE LABOR, MAT. SMITHING, PLUMB., HEAT, ETC.
	\$ <u>3940.00</u>
FEES	
Plan Check	\$ <u>13.00</u>
Building Permit	\$ <u>85.00</u>
Permit Authorized By	Date

RELOCATED	RELOCATED
RELOCATED	RELOCATED

BUILDING PERMIT PLOT PLAN
Development Services Department
CITY OF GARDEN GROVE

JOB ADDRESS <i>12112 DIAMOND</i>		PERMIT NO. <i>51852A</i>
ASSESSORS PARCEL NO.	TRACT <i>3537</i>	LOT <i>75</i>
JOB DESCRIPTION (PLEASE CHECK) <input type="checkbox"/> New <input checked="" type="checkbox"/> Addition <input type="checkbox"/> Alteration <input type="checkbox"/> Repair <input type="checkbox"/> Move <input type="checkbox"/> Demolish		
OWNER <i>BARRETT, JOHN</i>	DATE <i>1/14/92</i>	PERMIT VALUE <i>3900.00</i>

DIMENSION PLOT PLAN COMPLETELY SHOWING ALL STRUCTURES ON THE LOT AND THEIR USE.

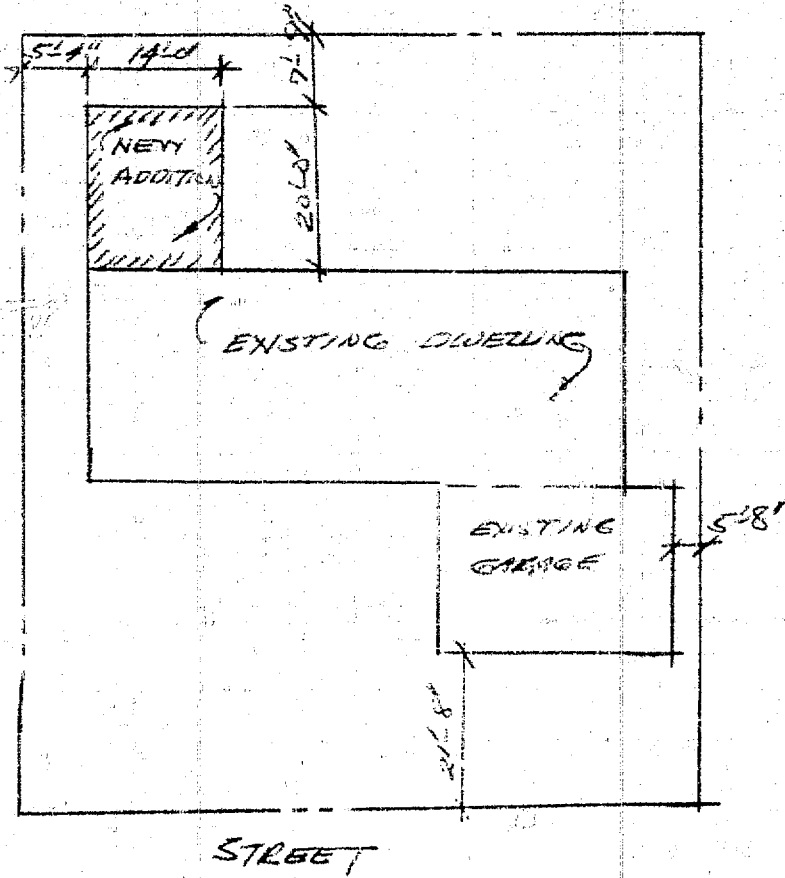

I HAVE RECEIVED A COPY OF THE
BUSINESS OPERATIONS TAX FORM

SIGNATURE _____
DATE _____

#1 Building Insp. / #2 Assessor / #3 File / #4 Permittee
I certify the information herein is accurate and correct.

ELECTRICAL PERMIT

DEPARTMENT OF DEVELOPMENT SERVICES

GARDEN GROVE, CALIFORNIA

PHONE: 537-4200

INSTRUCTION: USE TYPEWRITER OR BALL POINT PEN. PRESS FIRMLY. BE SURE ALL COPIES ARE LEGIBLE. NO ERASURES PERMITTED. A DOUBLE FEE WILL BE CHARGED IF WORK IS STARTED BEFORE PERMIT IS ISSUED.

JOB ADDRESS: 12112 Diamond ELECTRICAL PERMIT NO. 052442 A

OWNER: John T. Barrett PHONE: 897-4414

OWNER'S ADDRESS: _____ CITY: _____

LOT NO. _____ TRACT NO. _____

IF NOT LISTED BELOW SEE CODE NUMBER EACH FEE

Residential (I & H) sq. ft.	280	.01	280
Garage, Resid. (J) sq. ft.		.005	
Service, Single Phase		\$1.00	
Service, Three Phase		1.00	
Meters, Single Phase		1.00	
Meters, Three Phase		1.00	
Pole, Power, Light, etc.		2.00	
Sub-Panels 1 φ		1.00	
Sub-Panels 3 φ		.20	
Outlets Over 20		.10	
Fixtures 1st 20		.20	
Fixtures Over 20		.10	
Fixtures, MERC., QUARTZ, ETC.		1.00	
Heater		1.00	
Washer		1.00	
Dryer		1.00	
Hot Water Heaters		1.00	
Dishwasher		1.00	
Domestic Range or Oven		1.00	
Motors Not Over 1 HP		1.00	
Motors Over 1 Not Over 3 HP		1.50	
Time Clock		1.00	
Sign, 1 Tran. or 1 Ballast		2.00	
Each Additional Tran. or Ballast		1.00	
Sign Hookup		1.00	

NEW BUILDING OR ADDITION - AREA: 280 SQ. FT. EXISTING BUILDING REMODEL AREA: _____ SQ. FT. OCCUPANCY GROUP: _____ USE OF BUILDING AND OR NUMBER OF UNITS: _____

ELECTRICAL CONTRACTOR: DAYAN E.L. CO. PHONE: 521-1096

ADDRESS: 15534 Oakbury Dr CITY: _____ STATE LICENSE NO. _____

VALIDATION: APR 28-72 11 155 *****4.80

I HAVE CAREFULLY READ THE ABOVE APPLICATION AND KNOW THE SAME TO BE TRUE AND CORRECT. ALL PROVISIONS OF STATE AND LOCAL LAWS COVERING THIS TYPE OF CONSTRUCTION WILL BE COMPLIED WITH WHETHER SPECIFIED HEREIN OR NOT. NO PERSON SHALL BE EMPLOYED IN VIOLATION OF THE LABOR CODE OF THE STATE OF CALIFORNIA.

SIGNATURE OF PERMITTEE: [Signature] DATE: 4/25/72

BRANCH CIRCUIT PANEL: CIRCUITRY

CIR. NO.	BRKR. SIZE	WIRE SIZE	NOMENCLATURE	NO. OF OUTLET	WATTS L1	WATTS L2	WATTS L3
1							
2							
3							
4							
5							
6							

INSPECTION RECORD

APPROVAL	DATE	INSPECTOR
Underground		
Conduit		
Wiring	<u>5/1/72</u>	<u>[Signature]</u>
Heater		
Fixtures		
Service		
FINAL	<u>6/9/72</u>	<u>[Signature]</u>
Utility Notified		

ISSUANCE OF PERMIT 2.00

TOTAL FEE 4.80

SINGLE PHASE SERVICE SIZE 15 20 30 40 50 60 75 100
 THREE PHASE SERVICE SIZE 3 WIRE 4 WIRE 3 WIRE 4 WIRE 3 WIRE 4 WIRE

INSPECTOR: _____ PERMIT AUTHORIZED BY: [Signature] DATE: 4-28-72 BUILDING PERMIT NO. 51852 A SIGN PERMIT NO. _____ VERY HEAT. AIR COND. PERMIT NO. _____

GARDEN GROVE

Public Works & Development

PLUMBING PERMIT

Inspection Requests
638-6771

General Information
638-6881

INSPECTION RECORD

FEES

For Applicant to Fill In

DATE	INSPECTOR	TYPE OF FIXTURE OR ITEM	NO.	EACH	\$ FEE
		Water Closet (toilet)			
		Bath Tub			
		Shower			
		Lavatory (Wash Basin)			
		Kitchen Sink			
		Garbage Disposal			
		Laundry Tub or Tray			
		Water Heater	1		300
		Floor Sink			
		Floor Drain			
		Dish Washer			
		Drinking Fountain			
		Urinal			
		Gas System - Outlets			
		Building Sewer (First 100 ft.)			
		Building Sewer (Add'l 100 ft.)			
		Building Sewer (ea. add'l drain)			
		Rainwater Drain			
		Swimming Pool Piping			
		Sand Traps/Filters			
		Automatic Washing Machine			
		Water Softeners			
		Backwash - Trap			
		Water Lateral			
		Backflow Protective Devices			
		Water Piping (ea. 100 ft.)			
		Lawn Sprinklers (S.F.D. Only)			
		Lawn Sprinklers (other)			

EXIST
6/10/82

ITEM	CODE	FEES
Plan Retention Fee		
Plan Check		
Permit	2228	300
Issuance	3517	600
TOTAL FEES		900

ADDRESS
12112 Diamond

LOT NO. BLK NO. TRACT NO.

OWNER
Walker

OWNER'S ADDRESS
Same

NEP, BUILDING OR ADDITION - AREA
SQ. FT.

EXISTING BUILDING REMODEL AREA
SQ. FT.

OCCUPANCY GROUP

USE OR BUILDING OR NUMBER OF UNITS
UNITS

VALIDATION
PLUMBING PERMIT CHECK

PLUMBING CONTRACTOR
Pacific Installers

STATE LIC. NO. & TYPE
211898 B

ADDRESS
7541 Anthony

CITY
GG

PHONE
83947

WORKER'S COMPENSATION REQUIREMENTS

State Compensation Insurance Policy No. *20396A* Expiration Date

I certify that in the performance of the work for which this permit is issued, I shall not employ any person in any manner so as to become subject to the Worker's Compensation laws of California.

NOTE: If, after making such certificate, the applicant for the permit should become subject to the Worker's Compensation provisions of this code, he shall forthwith comply with the provisions of Section 3700 or his permit shall be deemed revoked.

I certify that I have read this application and state that the above information is correct. I agree to comply with all City ordinances and State laws relating to pending construction. I further agree to hold the City of Garden Grove harmless from any liability resulting from injury or bodily damage resulting from work performed pursuant to this permit.

M. Smith 12-10-81

BUSINESS TAX CERTIFICATE INFORMATION

I certify that the following Contractor's License No. *211897* and Classification *B-1* is in full force and effect.

(PRINT) CONTRACTOR (SIGNATURE) CONTRACTOR OR AUTHORIZED AGENT DATE

(PRINT) PROPERTY OWNER (SIGNATURE) PROPERTY OWNER OR AUTHORIZED AGENT DATE

A FEE MAY BE CHARGED FOR RE-INSPECTION DUE TO NEGLIGENCE, INCOMPLETE WORK, OR FAILURE TO MAKE CORRECTIONS.

AUTHORIZED BY
JR

DATE
12-14-81

CITY CO.
OFFICE

IDENTIFICATION CODE

PLUMBING PERMIT NO.

ELECTRICAL PERMIT NO.

Permit must be started within 120 days from date of issue or if not started within 120 days, this permit will be null and void.

PLUMBING PERMIT

INSPECTION RECORD

FEES

For Applicant to Fill in

DATE	INSPECTOR	TYPE OF FIXTURE OR ITEM	NO.	EACH	\$ FEE
		Water Closet (toilet)			
		Bath Tub			
		Shower			
		Lavatory (Wash Basin)			
		Kitchen Sink			
		Garbage Disposal			
		Laundry Tub or Tray			
		Water Heater	1		300
		Floor Sink			
		Floor Drain			
		Dish Washer			
		Drinking Fountain			
		Urinal			
		Gas System - Outlets			
		Building Sewer (First 100 ft.)			
		Building Sewer (Add'l 100 ft.)			
		Building Sewer (ea. add'l basin)			
		Rainwater Drain			
		Swimming Pool piping			
		Sand Traps/Filters			
		Automatic Washing Machine			
		Water Softeners			
		Backwash - Trap			
		Water Lateral			
		Backflow Protective Devices			
		Water Piping (ea. 100 ft.)			
		Lawn Sprinklers (S.F.D. Only)			
		Lawn Sprinklers (other)			

C/O EXIST
6/10/82

NOT REVISION

ADDRESS: **12112 Diamond**

LOT NO. BLK. TO. TRACT NO. **12112**

OWNER: **Walker** PHONE: **894-3917**

OWNER'S ADDRESS: **Same** CITY: **894-3917**

NEW BUILDING OR ADDITION - AREA: SQ. FT. EXISTING BUILDING REMODEL AREA: SQ. FT. OCCUPANCY GROUP: USE OF BUILDING OR NUMBER OF UNITS:

VALIDATION: **PLUMBING** \$ **5.00**
ISSUANCE \$ **6.00**
CHECK \$ **9.00**

PLUMBING CONTRACTOR: **Pacific Installers** STATE LIC. NO. & TYPE: **211898 B-1**

ADDRESS: **7541 Anthony** CITY: **66** PHONE: **839477**

WORKER'S COMPENSATION REQUIREMENTS
State Compensation Insurance Policy No. **20396A** Expiration Date: **12-10-81**
 I certify that in the performance of the work for which this permit is issued, I shall not employ any person in any manner so as to become subject to the Worker's Compensation laws of California.
NOTE: If, after making such certificate, the applicant for the permit should become subject to the Worker's Compensation provisions of this code, he shall forthwith comply with the provisions of Section 3700 or his permit shall be deemed revoked.
 I certify that I have read this application and state that the above information is correct. I agree to comply with all City ordinances and State laws relating to pending construction. I further agree to hold the City of Garden Grove free and harmless from any liability arising out of injury or bodily damage resulting from work performed related to this permit.

PERMIT APPLICANT SIGNATURE: *nrsmith* DATE: **12-10-81**

BUSINESS TAX CERTIFICATE INFORMATION
I certify that the following Contractor's License No. **211898** and Classification **B-1** is in full force and effect.

(PRINT) CONTRACTOR: _____ (SIGNATURE) CONTRACTOR OR AUTHORIZED AGENT: *nrsmith* DATE: _____

BUSINESS TAX CERTIFICATE NO. _____ EXPIRATION DATE: _____
I certify that I am exempt from Section 7031.5 of the Business and Professional Code, Division 3, Chapter 9, Contractors' License Law, under the following Section:
Owner: Section 7044 Minor work under \$100: Section 7048
Employee working for wages only: Section 7052
Other: _____

(PRINT) PROPERTY OWNER: _____ (SIGNATURE) PROPERTY OWNER OR AUTHORIZED AGENT: _____ DATE: _____

ITEM	CODE	FEES
Plan Retention Fee		
Plan Check		
Permit	2228	300
Issuance	3517	6.00
TOTAL FEES		9.00

UTILITY CO. NOTIFIED: _____

IDENTIFICATION CODE: _____

BUILDING PERMIT NO. _____ ELECTRICAL PERMIT NO. _____

LAND USE: _____ AUTHORIZED BY: *NR* BUILDING DATE: **12-14-81**

Work is not started within 120 days from date of issue or if delayed for more than 120 days, this permit will be null and void.

(PRINT) CONTRACTOR: _____ (SIGNATURE) CONTRACTOR OR AUTHORIZED AGENT: *nrsmith* DATE: _____

BUSINESS TAX CERTIFICATE NO. _____ EXPIRATION DATE: _____
I certify that I am exempt from Section 7031.5 of the Business and Professional Code, Division 3, Chapter 9, Contractors' License Law, under the following Section:
Owner: Section 7044 Minor work under \$100: Section 7048
Employee working for wages only: Section 7052
Other: _____

(PRINT) PROPERTY OWNER: _____ (SIGNATURE) PROPERTY OWNER OR AUTHORIZED AGENT: _____ DATE: _____

A FEE MAY BE CHARGED FOR RE-INSPECTION DUE TO NEGLIGENCE, INCOMPLETE WORK, OR FAILURE TO MAKE CORRECTIONS.

HEATING, VENTILATING, REFRIGERATION & AIR COND. PERMIT

Public Works & Development — Garden Grove, Ca.
Inspection 638-6771 Information 638-6661

INSTRUCTION: USE TYPEWRITER OR BALL POINT PEN, PRESS FIRMLY, BE SURE ALL COPIES ARE LEGIBLE, NO ERASURES PERMITTED. A DOUBLE FEE WILL BE CHARGED IF WORK IS STARTED BEFORE PERMIT IS ISSUED. (PLEASE PRINT)

For Applicant to Fill in (PLEASE PRINT)

PERMIT FEES			
TYPE OF FIXTURE OR ITEM	NO.	EA.	TOTAL
Furnace to & including 100,000 B.T.U.	1	5.00	
More than 100,000 & including 500,000 B.T.U.		7.50	
More than 500,000 & including 1,000,000 B.T.U.		10.00	
More than 1,000,000 & including 2,000,000 B.T.U.		15.00	
More than 2,000,000 B.T.U.		25.00	
Installation or Relocation of Floor Furnace		5.00	
Installation or Relocation of Susp. Heater		5.00	
Installation or Relocation of Wall Heater		5.00	
Installation or Relocation of Unit Heater		5.00	
Installation of Appliance Vent Only		2.00	
Repair, Alteration or Addition to any Heating or Cooling System		5.00	
Incidental Gas Piping		1.75	
Each Range Hood Including Duct and Fan		5.00	
Each Vent Fan Connected to a Single Duct		2.00	
Each Ventilating System not a Part of a Heating or Air Conditioning System Authorized by Permit		4.00	
Absorption System to & including 100,000 B.T.U.		5.00	
Boiler or Compressor to & including 15 Horsepower		7.50	
Absorption System to & including 500,000 B.T.U.		7.50	
Boiler or Compressor to & including 30 Horsepower		10.00	
Absorption System to & including 1,000,000 B.T.U.		10.00	
Boiler or Compressor to & including 50 Horsepower		15.00	
Absorption System to & including 2,000,000 B.T.U.		15.00	
Boiler or Compressor over 50 Horsepower		25.00	
Absorption System over 2,000,000 B.T.U.		25.00	
Each Evaporative Cooler		3.00	
Air Handling Unit to & including 2,000 C.F.M.		2.00	
Air Handling Unit to & including 10,000 C.F.M.		5.00	
Air Handling Unit over 10,000 C.F.M.		10.00	
Each Appliance or Equipment Regulated by this Code but not specifically listed in the Fee Schedule		4.00	

ADDRESS PERMIT NO. **090137A**

12112 Diamond Street

LOT NO. _____ TRACT NO. _____

OWNER **John Walker**

OWNER'S ADDRESS **12112 Diamond St., Garden Grove, CA.**

HEATING CONTRACTOR **Graham Bros., Inc.**

CONTRACTOR'S ADDRESS **2956 Randolph, Costa Mesa, CA. 92626**

PHONE **(714) 546-1653** STATE LICENSE NO. **248604**

OCCUPANCY **S.F.D.**

NEW BLDG. EXIST. BLDG.

VALIDATION

I hereby acknowledge that I have read this application and state that the above is correct and agree to comply with all ordinances and State laws and/or licensed as required by the City of Garden Grove and/or State of California, or that I am the legal owner of the above described property, and I certify that in the performance of the work for which this permit is issued I shall not employ any person in violation of the workmen's compensation laws of the State of California.

SIGNATURE OF PERMITTEE *J.P. Christensen* DATE **2/7/77**

APPROVALS	DATE	INSPECTOR
FURNACE		
FURNACE VENTS		
GAS PIPING		
DUCTS		
SINGLE DUCT FAN VENT		
KITCHEN HOOD		
AIR HANDLING UNIT		
EVAPORATIVE COOLER		
BOILER OR COMPRESSOR		
FINAL	3/18/77	
UTILITY CO. NOTIFIED		

FEES	
REC'D BY: _____	PLAN CHECK \$
AUTHORIZED BY: <i>J.S.</i>	PERMIT \$ 11.00
DATE 2-22-77	ISSUANCE \$ 6.00
TOTAL	\$ 17.00

HEATING, VENTILATING, REFRIGERATION & AIR COND. PERMIT

Public Works & Development – Garden Grove, Ca.
Inspection 638-6771 Information 638-6661

INSTRUCTION: USE TYPEWRITER OR BALL POINT PEN, PRESS FIRMLY, BE SURE ALL COPIES ARE LEGIBLE, NO ERASURES PERMITTED. A DOUBLE FEE WILL BE CHARGED IF WORK IS STARTED BEFORE PERMIT IS ISSUED. (PLEASE PRINT)

For Applicant to Fill in (PLEASE PRINT)

PERMIT FEES			
TYPE OF FIXTURE OR ITEM	NO.	EA.	TOTAL
Furnace to & including 100,000 B.T.U.		5.00	
More than 100,000 & including 500,000 B.T.U.		7.50	
More than 500,000 & including 1,000,000 B.T.U.		10.00	
More than 1,000,000 & including 2,000,000 B.T.U.		15.00	
More than 2,000,000 B.T.U.		25.00	
Installation or Relocation of Floor Furnace		5.00	
Installation or Relocation of Susp. Heater		5.00	
Installation or Relocation of Wall Heater		5.00	5.00
Installation or Relocation of Unit Heater		5.00	
Installation of Appliance Vent Only		2.00	
Repair, Alteration or Addition to any Heating or Cooling System		5.00	
Incidental Gas Piping		1.75	
Each Range Hood Including Duct and Fan		5.00	
Each Vent Fan Connected to a Single Duct		2.00	
Each Ventilating System not a Part of a Heating or Air Conditioning System Authorized by Permit		4.00	
Boiler or Compressor to & including 5 Horsepower		5.00	
Absorption System to & including 100,000 B.T.U.		5.00	
Boiler or Compressor to & including 15 Horsepower		7.50	
Absorption System to & including 500,000 B.T.U.		7.50	
Boiler or Compressor to & including 30 Horsepower		10.00	
Absorption System to & including 1,000,000 B.T.U.		10.00	
Boiler or Compressor to & including 50 Horsepower		15.00	
Absorption System to & including 2,000,000 B.T.U.		15.00	
Boiler or Compressor over 50 Horsepower		25.00	
Absorption System over 2,000,000 B.T.U.		25.00	
Each Evaporative Cooler		3.00	
Air Handling Unit to & including 2,000 C.F.M.		2.00	
Air Handling Unit to & including 10,000 C.F.M.		5.00	
Air Handling Unit over 10,000 C.F.M.		10.00	
Each Appliance or Equipment Regulated by this Code but not specifically listed in the Fee Schedule		4.00	

ADDRESS 12112 Diamond		PERMIT NO. 088889A
LOT NO.		TRACT NO.
OWNER J. Walker		
OWNER'S ADDRESS 12112 Diamond		
HEATING CONTRACTOR Pacific Installers		
CONTRACTOR'S ADDRESS 7511 Anthony		
PHONE 839-4770	STATE LICENSE NO. 211848	
OCCUPANCY SFD		
NEW BLDG. <input type="checkbox"/>	EXIST. BLDG. <input checked="" type="checkbox"/>	
VALIDATION 11 190 H***17.00		

I hereby acknowledge that I have read this application and state that the above is correct and agree to comply with all ordinances and State laws regulating plumbing. I hereby certify that I am properly registered with and/or licensed as required by the City of Garden Grove and/or State of California, or that I am the legal owner of the above described property, and I certify that in the performance of the work for which this permit is issued I shall not employ any person in violation of the workmen's compensation laws of the State of California.

SIGNATURE OF PERMITTEE: *[Signature]* DATE: _____

INSPECTION RECORD		
APPROVALS	DATE	INSPECTOR
FURNACE		
FURNACE VENTS		
GAS PIPING		
DUCTS		
SINGLE DUCT FAN VENT		
KITCHEN HOOD		
AIR HANDLING UNIT		
EVAPORATIVE COOLER		
BOILER OR COMPRESSOR		
FINAL		
UTILITY CO. NOTIFIED		

Permit cancelled by Pacific Installers on letter of 12/12/76

FEEES	
REC'D BY: _____	PLAN CHECK \$ _____
AUTHORIZED BY: <i>[Signature]</i>	PERMIT \$ ^{MIN FEE} 4.00
DATE 12-9-76	ISSUANCE \$ 0.00
TOTAL \$ 17.00	

L. INSPECTOR

Bldg. Permit No. _____

DS-0009 - 9/78

ELECTRICAL PERMIT
DEVELOPMENT SERVICES DEPARTMENT
 GARDEN GROVE, CALIF. 638-6771

INSTRUCTION: USE TYPEWRITER OR BALL POINT PEN, PRESS FIRMLY, BE SURE ALL COPIES ARE LEGIBLE, NO ERASURES PERMITTED. A DOUBLE FEE WILL BE CHARGED IF WORK IS STARTED BEFORE PERMIT IS ISSUED. (PLEASE PRINT)

LOT NO.	TRACT NO.	IF NOT LISTED BELOW SEE CODE	NUMBER	EACH	FEE
		Residential (I & H) sq. ft.		.015	
		Garage, Resid. (J) sq. ft.		.01	
		Service Meter, Single Phase		5.00	
		Service Meter, Three Phase		5.00	
		Temporary Power Pole		5.00	
		Pole, Power, Light, etc.		3.00	
		Sub-Panels 1 φ		2.00	
		Sub-Panels 3 φ		2.00	
		Outlets		.20	
		Fixtures		.20	
		Fixtures, Merc. Quartz, etc.		1.00	
		Heater-Not Over 1650 W		2.00	
		Washer		2.00	
		Drver		2.00	
		Hot Water Heaters		2.00	
		Dishwasher		2.00	
		Domestic Range or Oven		2.00	
		Power Apparatus-H.P., K.W. or K.V.A. Motors, Transformers, etc.			
		Not Over 1 each		1.50	
		Over 1, Not Over 10 each		3.00	
		Over 10, Not Over 30 each		5.00	
		<i>furnace</i>			<i>2.00</i>
		Time Clock		1.00	
		Sign		7.50	
		Sign Hookup		2.00	

ADDRESS: **12112 Diamond** ELECTRIC PERMIT NO. **088888 A**

OWNER: **J. Walker** PHONE: **894-3917**

OWNER'S ADDRESS: **12112 Diamond** CITY: **GG**

NEW BUILDING OR ADDITION - AREA: _____ EXISTING BUILDING REMODEL AREA: _____ OCCUPANCY GROUP: **I** USE OF BUILDING AND OR NUMBER OF UNITS: **SEP**

ELECTRICAL CONTRACTOR: **Pacific Installers** PHO: **82-1170**

ADDRESS: **7541 Anthony** CITY: **GG** STATE LIC. NO.: **211898**

VALIDATION: _____ DATE: **12-9-76 11 189 !!!**17.00**

I HAVE CAREFULLY READ THE ABOVE APPLICATION AND KNOW THE SAME TO BE TRUE AND CORRECT. ALL PROVISIONS OF STATE AND LOCAL LAWS COVERING THIS TYPE OF CONSTRUCTION WILL BE COMPLIED WITH WHETHER SPECIFIED HEREIN OR NOT. NO PERSON SHALL BE EMPLOYED IN VIOLATION OF THE LABOR CODE OF THE STATE OF CALIFORNIA.

SIGNATURE OF PERMITTEE: **W. Rosa** DATE: _____

BRANCH CIRCUIT PANEL: CIRCUITRY

CIR. NO.	BRKR. SIZE	WIRE SIZE	NOMENCLATURE	NO. OF OUTLET	WATTS L1	WATTS L2	WATTS L3
1							
2							
3							
4							
5							
6							

INSPECTION RECORD

APPROVAL	DATE	INSPECTOR
Underground		
Conduit		
Wiring		
Heater		
Fixtures		
Ufer		
Service		
FINAL		
Utility Notified		
BUILDING PERMIT NO.	SIGN PERMIT NO.	VENT. HEAT. AIR COND. PERMIT NO.

Permit cancelled from per letter from contractor dated 12/15/76

ISSUANCE OF PERMIT FEE: **6.00**

PLAN CHECK \$ _____ PERMIT FEE \$ **17.00**

SINGLE PHASE SERVICE SIZE UG OH

AMPS. _____ VOLTS _____ RIG. CONDUIT _____

THREE PHASE SERVICE SIZE 3 WIRE 4 WIRE UG OH

AMPS. _____ VOLTS _____ RIG. CONDUIT _____

I. INSPECTOR: **[Signature]** PERMIT AUTHORIZED BY: **[Signature]** DATE: **12-9-76**

Raymond Hill

Ray Benton

Controller's Office

Refunds - Heating & Electric Permits
12112 Diamond Street

Dave Robson

Public Works & Development

February 7, 1977

Heating Permit #88889A and Electric Permit #88888A were issued to Pacific Installers on December 9, 1976, at a cost of \$17.00 each. We have received a written request for refunds, advising us that the job has been cancelled and they will not be performing the work indicated on the permits.

Section 304(d) of the Amendments to the Uniform Mechanical Code and Section 91-12(f) of the Amendments to the National Electric Code permits refunds in the amount exceeding \$5.00. Please refund \$12.00 on each of the above permits, a total of \$24.00 to:

Pacific Installers
7451 Anthony Avenue
Garden Grove, CA 92641

Dave Robson, Manager
Development Services

By:
Robert S. Szolomayer
Permit Section Supervisor

JS:fd

bcc: Nita Sullivan
File 86.2.8
Reading File