

PROPOSAL & INVESTMENT PLAN

City of Garden Grove



The contents of this proposal are confidential trade secret information and intended for the use of City of Garden Grove only. The contents herein may not be reproduced without the specific written permission of KYOCERA Document Solutions. This is a proposal only and informative in nature. Actual contract terms and conditions, as well as final pricing, may change, and will be submitted upon your request.

FOR: RFP No. S-1207 (REPLACEMENT OF 27 MULTI-FUNCTION COPIERS)

ATTENTION: SANDRA SEGAWA, PURCHASING AGENT

CITY OF GARDEN GROVE

11222 ACACIA PARKWAY, ROOM 220

GARDEN GROVE, CA 92840

By: Steve Zaldin, Government Account Executive

Seneca Hayden, Government Sales Manager

949-580-2156

DATE: 2/22/2017

February 22, 2017

City of Garden Grove
11222 Acacia Parkway
Garden Grove, CA 92840

Dear Sandra,

Thank you for considering KYOCERA Document Solutions to help you in your upcoming technology decision. Based on the details within this RFP, we have prepared the following proposal for your approval.

When selecting a solution, there are many variables you need to consider: the company, the features of the product, the quality of the product, the financing available, the cost to obtain the solution, and the service support you will receive. Each company or individual has their own criteria when making a long-term decision, but we feel that we can offer you a complete solution to your needs.

KYOCERA has been in business since 1959. We are a highly diversified global technology company. Our resources are strong and enable us to be the leader in handling large relationships in our market.

To continue to grow as we have over the past 57 years, we need to have complete client satisfaction. Our Performance Assurance Guarantee as well as ongoing quarterly reviews ensures your satisfaction both now and in the future.

We appreciate the opportunity to propose a solution for City of Garden Grove. I look forward to implementing our programs and solutions for you.

Sincerely,



Seneca Hayden
Government Sales Manager

Table of Contents

• Section A

- Management Message - About KYOCERA Document Solutions - Keeping the Future Green
- Kycocera Managed Print Services (KMPS) A Unique Approach
- Federal Government Solutions - Advanced Innovation
- Leverage Your Existing Technology - Secure Your Workflow – AutoStore 7
- Proposal Letter / Certificate of Acceptance
- Bidder / Contractor Statement Regarding Insurance Coverage
- Certificate of Liability Insurance

• Section B

- Implementation & Installation Plan
- Exhibit “B” Proposed Equipment & Pricing Options
- Proposed Solution for City of Garden Grove
- Kyocera Fleet Services (KFS) - Performance Assurance
- Electrical Requirements
- Production Press Electrical Requirements
- Your Dedicated Sales & Service Team
- Business References

• Section C

- Enhanced Fiery Functionality – Ease of Use
- Mobile Print Support
- Security
- Environmentally Conscious
- Kyocera Business Applications
- Workflow Customization
- Business Applications
- Ease of Maintenance – Total Document Solutions

• Section D

- The Power of Kyocera Innovation Corporate Presentation
- TASKalfa 8052ci Series Presentation

• Section E

- Product Brochures & Specifications
- Case Studies & Marketing Brochures

Management Message

At KYOCERA, in order to deliver products and services that delight our customers, we take the "Customer-First" Principle as our top priority. To ensure customer satisfaction, we aim to be a partner that delivers new value to our customers' operations, with employees who relentlessly pursue their dreams, work enthusiastically and achieve self-determined goals.

KYOCERA Document Solutions Inc. is the company that undertakes the document solution business in KYOCERA group, which has consistently opened up new worlds by leveraging leading-edge technologies in a broad range of fields from fine ceramics, electronic devices and communications services to environment and energy markets.

About KYOCERA Document Solutions

KYOCERA Document Solutions America is improving the document management processes of customers and making people's jobs easier through a high-performance, end-to-end digital imaging product line that delivers one of the industry's lowest total costs of ownership (TCO).

The company manufactures and markets computer-connectable document imaging and document management systems, including network-ready digital MFPs/printers, laser printers, color MFPs/printers, digital laser facsimiles, wide format imaging products and a portfolio of Kyocera-developed and third-party applications and network solutions.

KYOCERA Document Solutions America is a group company of Kyocera Corporation, the world's leading developer and manufacturer of advanced ceramics and associated products, including telecommunications equipment, semiconductor packages and electronic components. Kyocera Corporation's consolidated net revenues totaled \$13.32 billion during the year ended March 31, 2016. Kyocera employs more than 68,185 people worldwide (As of March 31, 2016). The U.S. dollar conversion is based on the rate of USD1 = JPY110 rounded to the nearest unit.

Keeping the Future Green

KYOCERA is committed to pursuing a harmonious balance between economic development and environmental preservation. We adhere to the goals of our worldwide Environmental Action Plan in developing office solutions with environmentally friendly and superior energy-and supply-saving features.

While striving to maintain a clear vision in pursuing a balance between economic and environmental preservation, our devices are built around our sustainable ECOSYS technology, offering many hardware features and system settings that can dramatically reduce waste without compromising productivity.

KYOCERA Document Solutions America's Environmental Management System (EMS) at its United States facilities has achieved ISO (International Standard Organization) 14001:2004 certification. This annual certification, verified through an independent audit, is used to distinguish corporations that effectively manage how their activities, products and services impact the environment.

Business Applications

Kyocera has pioneered the development of business applications that set the standard in document workflow customization. The types of workflows that impact a business' efficiency, security, and bottom-line profitability are divided into six different Kyocera-designated categories: *Capture & Distribution, Document Management, Mobile & Cloud, Network Device Management, Output Management and Cost Control & Security*. Kyocera-developed HyPAS business applications and third party software integration capability, enables users to optimize their hardware investment by expanding the capabilities of their Kyocera printer or MFP.

KYOCERA Document Solutions America has attained Gold Certified Partner status in the Microsoft Partner Program with a competency in Information Worker Solutions, recognizing Kyocera's expertise and impact in the document imaging and management marketplace.



Kyocera Managed Print Services (KMPS) A Unique Approach

Bringing Order to an Unmanaged Print Environment

- Eliminate fragmented business practices with remote and proactive management of toner and service needs.
- Take control of soft costs with a one vendor solution and one invoice per month covering all costs associated with print activity.
- Kyocera provides quarterly reviews to regularly assess the success of all deliverables, make recommendations for print strategies, and examine opportunities for ongoing improvement.
- Reduce supplies storage space with remote toner management and 'just in time' toner supply shipment.

Right-Sizing Your Printer Fleet

- Copier companies typically define "Right-Sizing" as a reduction of the total number of printing devices to affect a reduction in the cost-per page of printing.

This requires a migration of output to centralized and expensive multi-function devices.

- Kyocera knows that the “right size” of your fleet caters to the departmental and individual needs of your users.
- With its low cost-per page on local activity, Kyocera improves your document environment through strategic placement of the right device for the right purpose with the right department ...all at the same low cost-per-page.

Print Standardization

- Move toward increased ease of use with the familiarity born of fewer printer models.
- IT Staff benefits from one print driver for all Kyocera devices.
- Users benefit from common displays on all Multi-Function devices.

Kyocera Stands Alone

- Standard copier company business models mandate a move toward centralization of output to expensive multifunctional devices as the only means of reducing on-going cost-per page expenses. This model is of convenient benefit to vendor profit, but is not sensitive to user concerns.
- Kyocera is the only company which can reduce the cost of printing without sacrificing the convenience and privacy of local printing.

Maximized Cost Savings with No Sacrifice

- Unique Ecosys printing technology allows for the same low cost-per-page on your desktop printers and desktop MFP’s as it does to your large Multi-Function Devices.
- This allows Kyocera to customize print solutions which allow your company to achieve its desired cost-per-page savings without users having to sacrifice the privacy and convenience of desktop printing, scanning and faxing.
- The Kyocera Managed Print Program displaces the cost of printer replacement and establishes a predictable refresh strategy.

Optimal Mix of Kyocera Equipment

- Decentralized to meet all departmental needs
- Same cost-per-page across all device types. More access to printing, scanning, faxing, and copying

• B/W \$0.0044
Color \$0.04



B/W \$0.0044
Color \$0.04



B/W \$0.0044
Color \$0.04



Federal Government Solutions

IMPROVE EFFICIENCY. SECURE DATA. PROTECT PUBLIC INFORMATION.

Advanced Innovation

KYOCERA's MFPs offer advanced, cost-effective total document imaging solutions and hardware technology to support your government agency.



Performance You Can Rely On

KYOCERA products have set the standard for reliability



Low TCO

Tiered color programs and more make KYOCERA products among the lowest in total cost of ownership



Government Ready

KYOCERA MFPs and printers:

- Are TAA compliant
- Are on GSA schedule
- Meet Federal Government Compliance requirements
- Offer CAC/PIV Dual Card Authentication

Leverage Your Existing Technology

KYOCERA can securely integrate to your government agency's existing electronic document architecture/platform so you're able to leverage all of your technology to its fullest potential.



DMConnect

Integrate securely and intelligently to your existing document management systems



SharePoint Connector

Connects safely and seamlessly to your existing Microsoft SharePoint server



PRESCRIBE

Works with back office platforms for printing on legacy and back-end systems

Secure Your Workflow

CentraQ™

KYOCERA streamlines document management and workflow, increases productivity, and maintains security while optimizing storage and access of information across your global enterprise.



Secure Release

Release your print jobs securely at any KYOCERA device throughout the office



Protected Process

All print jobs will be stored on a secured print server at your location

AUTOSTORE 7

AutoStore captures documents from virtually any source – from an MFP, network scanner, desktop PC or smartphone. Once documents are captured they can be processed with the application’s powerful capabilities – De-speckling, De-skewing and barcode reading are just a few of the tools available. These cleaned-up, digitized documents can be converted into a variety of formats, such as text searchable PDFs or Microsoft® Office® documents. AutoStore will then route to virtually any destination: fax, email, network folders, PCs, as well as many leading document management systems. Your information is directed where you want it – quickly and accurately.

RFP No. S-1207

CITY OF GARDEN GROVE

PROPOSAL REQUIREMENTS

PROPOSAL LETTER/CERTIFICATE OF ACCEPTANCE

COMPANY NAME:

Kyocera Document Solutions West LLC.

SANDRA SEGAWA, PURCHASING AGENT
CITY OF GARDEN GROVE
11222 ACACIA PARKWAY
GARDEN GROVE, CALIFORNIA 92840

In response to the request to Provide Twenty-Seven (27) New and Unused Multi-Function Digital Copiers and Related Supplies, Maintenance and Support Services for Various Departments for the City of Garden Grove, per the Scope of Work which is attached as Attachment "A". We the undersigned hereby declare that we have carefully read and examined the RFP documents including any plans and specifications, and hereby propose to perform and complete the Work as required in the Contract.

This Contract is not exclusive. The CITY expressly reserves the right to contract for performance of services such as those described herein through other Contractors.

The undersigned agrees to supply the Scope of Work at the costs indicated in its cost proposal if its Proposal is accepted within 120 days from the date specified in the RFP for receipt of proposals.

The undersigned has reviewed the enclosed contract terms and conditions and agrees to accept all terms and conditions of the CITY's contract unless otherwise noted in the proposal response.

If recommended for Contract award, the undersigned agrees to execute a contract which will be prepared by the CITY for execution, within 10 calendar days following Notification of Award. It is understood that the recommendation for contract award will not be placed on the agenda for consideration by the City Council until the CITY has received the executed contract. The CITY will fully execute the contract subject to resolution of Protest filings, if any, and approval by the City Council.

The undersigned will also deliver to the CITY prior to the commencement of Scope of Work the necessary original Certificates of Insurance. If services are authorized to commence prior to the execution of the Contract pursuant to a Notice to Proceed issued by the CITY, pending the execution of the Contract, the services shall be subject to the terms and conditions of the Scope of Work and the Contract.

Incorporated herein and made a part of this Proposal are the Response Data and Proposal Forms required by the Proposal Requirements.

The undersigned acknowledges receipt, understanding and full consideration of the following Addenda to the RFP Documents:

Addenda No. S1207 27 New Multifunction Digital Copiers

Proposer represents that the following person is authorized to negotiate on its behalf with the CITY in connection with this RFP:

Seneca Hayden Regional Sales Manager 949-580-2156

(Name)

(Title)

(Phone)

The undersigned certifies that it has examined and is fully familiar with all of the provisions of the RFP Documents and is satisfied that they are accurate; that it has carefully checked all the words and figures and all statements made in the Proposal Requirements; that it has satisfied itself with respect to other matters pertaining to the proposal which in any way affect the Work or the cost thereof. The undersigned hereby agrees that the CITY will not be responsible for any errors or omissions in these RFP Documents.

BY:

(Signature)

Michael Graves

(Type or Print Name)

Vice President, Technical Operations

(Title)

Michael.Graves@da.kyocera.com

(Email Address)

949-580-2152

(Phone Number)

**BIDDER/CONTRACTOR STATEMENT
REGARDING INSURANCE COVERAGE
(Submit with IFB/RFP Package)**

This signed document must be included with your bid package in order for your bid/proposal to be considered complete!

BIDDER/CONTRACTOR HEREBY CERTIFIES that he/she has reviewed and understands the insurance coverage requirements specified as in the attached Insurance Requirements Checklist.

Should we/I be awarded the contract, we/I certify that we/I can meet the specified requirements for insurance, including insurance coverage of the subcontractors, and agree to name the **City/Successor Agency/Sanitary District** and other additional insureds as per the agreement for the work specified And we/I will comply with the provisions of Section 3700 of the Labor Code, which require every employer to be insured against liability for worker's compensation or to undertake self-insurance in accordance with the provisions of that code, before commencing the performance of the work specified.

Kyocera Document Solutions West LLC.

Please Print (Person, Firm, or Corporation)

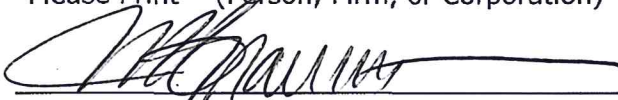

Signature of Authorized Representative

Michael Graves, Vice President

Please Print (Name & Title of Authorized Representative)

2/17/17

949-580-2152

Michael.Graves@da.kyocera.com

Date

Phone Number

Email

Insurance Certificates and Endorsements will also be accepted via email and must be emailed to the following email address only: sandras@garden-grove.org. This is the preferred and quickest method of submitting insurance certificates and endorsements.

Insurance Certificates and Endorsements can also be mailed to: City of Garden Grove
Attention: Sandra Segawa:
Purchasing Division
11222 Acacia Parkway
Garden Grove, CA 92840

NOTE: All insurance certificates and endorsements must be received by the City of Garden Grove Purchasing Division within ten (10) City working days of the original request or the City reserves the right to proceed with the next lowest responsible bidder or the next highest scoring proposer in the process.

ADDITIONAL COVERAGE SCHEDULE

| COVERAGE | LIMITS |
|--|---|
| POLICY TYPE: Workers Compensation and Employers Liability CARRIER: Travelers Property Casualty Company of America POLICY TERM: 01/01/2017 – 01/01/2018 POLICY NUMBER: YJ UB 3F980688 17 | Workers Compensation – Per Statute E.L. Each Accident: \$1,000,000 E. L. Disease – Each Employee: \$1,000,000 E.L. Disease – Policy Limit: \$1,000,000 |

Implementation & Installation Plan

At KYOCERA we follow an **ADIMO** process of **Assessment / Design / Implement / Manage / Optimize**.

Kyocera can install & implement as slow or as quick as convenient for the City. We have the technical & man power to have multiple deliveries and teams installing at all of your locations at once. We can wrap this install up in 3 to 4 days. Here is the ADIMO process:

- **Assessment** - We would plan a meeting with the City of Garden Grove's IT & Facilities department before install and gather the necessary network, print server info and discuss the best plan for a smooth implementation. Provide a report and detailed implementation plan at that time highlighting areas we can improve workflow and reduce environmental impact for the City.
- **Design** - A comprehensive solution for your environment designed to meet your specific requirements. We will provide a detailed Scope of Work for the install with a detailed schedule by the hour.
- **Implementation** – Professional project management and highly qualified technicians ensure minimum disruption from installation to training. We will install over a 3 day period by location and address. We will assist and install all the print drivers, we will set up all the features and short cuts as your users by department have on the existing equipment. We will input the accurate IP addresses and domain settings on the device. Our techs will install the scan destination folders, scan to email, address book, pull from LDAP for scan to email, set up the fax and fax routing if applicable. There will be no more than 1 hour downtime per device. Our techs will be minimally intrusive and cognizant of not interrupting user's work place.
- **Management** – Hassle-free maintenance and support takes care of everything you need, including proactive service and automatic replenishment of consumables. An average 2 to 4 hour response time.
- **Optimization** - Continual improvement of your print environment – optimized through ongoing assessment, reports and consultation. Kyocera is a technology company that can consult and be a benefit to the City of Garden Grove to help automate processes and track and lower costs.
- **Reprographics Department** – Reprographics will take a day and half to install. We will disassemble remove the 3 production copiers. We will install the new production copiers and connect the Fiery. We will have a marketing color specialist on sight setting the Fiery up, calibrating and dialing in the color to the City's specifications. We will perform training at time of install & training will be ongoing at no charge.
- **NSI AutoStore 7** - We will coordinate with our technical team the install and configuration of the NSI AutoStore 7 and the workflow. We have included 3 days of professional services for this install.
- **Pick Up & Trade-In's** - We will pick up all of the existing devices, shrink wrap and store the equipment awaiting return or disposal instructions from the City. City will receive \$13,000 check 3 weeks after delivery is complete. We will have everything complete within 30 days from receiving signed contract.

Exhibit “B” Proposed Equipment & Pricing Options

| Kyocera Production & Office MFP's Location | Current Equipment | Kyocera's Recommended Equipment | | | | | Monthly Base Lease Payment 60 month lease | Monthly Base Lease Payment 60 month lease | Service Cost Per impression B/W | Service Cost Per impression Color | Fair Market Trade In Value | Notes |
|--|--------------------------|--|---------------------|----------------|------------------|-----------------------------|---|---|--|--|-------------------------------|--|
| | Model Name and Number | Model Name and Number | PPM B/W Color | Mo. Avg B/W | Mo. Avg Color | Monthly Volume Rating | | | | | | |
| City Hall-Reprographics 2nd Floor 11222 Acacia Parkway | Ricoh MP 1357EX | Konica Minolta PRESS 1250 | 125 | 81332 | | 3,000,000 | \$ 1,490 | \$ 1,490 | 0.0044 | | \$500 | Option C: recommended model per average volume |
| City Hall-Reprographics 2nd Floor 11222 Acacia Parkway | Ricoh MP C651 | Kyocera 8052ci | 80 70 | 671 | 21702 | 400,000 | \$ 495 | \$ 495 | 0.0044 | 0.04 | \$500 | |
| City Hall-Reprographics 2nd Floor 11222 Acacia Parkway | Ricoh MP 1107EX | Konica Minolta PRESS 1250 | 125 | 47568 | | 3,000,000 | \$ 598 | \$ 598 | 0.0044 | | \$500 | Option C: 8002i (80 ppm) lease= \$190 |
| City Hall-Personell 2nd Floor 11222 Acacia Parkway | Ricoh MP C5502A | Kyocera 6052ci | 60 55 | 11364 | 1263 | 250,000 | \$ 160 | \$ 160 | 0.0044 | 0.04 | \$500 | |
| City Hall-City Clerk 2nd Floor 11222 Acacia Parkway | Ricoh MP 6001SP | Kyocera 6002i (B) 6052ci | 60 55 | 17137 | | 250,000 | \$ 110 | \$ 160 | 0.0044 | 0.04 | \$500 | |
| City Hall-Econ Dev 3rd Floor 11222 Acacia Parkway | Ricoh MP C5502A | Kyocera 6052ci | 60 55 | 5731 | 2456 | 250,000 | \$ 160 | \$ 160 | 0.0044 | 0.04 | \$500 | Option C: 5052ci (50 ppm) lease= \$ |
| City Hall-City Manager 3rd Floor 11222 Acacia Parkway | Ricoh MP 6001SP | Kyocera 6002i (B) 6052ci | 60 55 | 6208 | | 250,000 | \$ 110 | \$ 160 | 0.0044 | 0.04 | \$500 | Option C: 5002i (50ppm) lease= \$ 5052ci (50 ppm) lease= \$ |
| City Hall-Water 1st Floor 11222 Acacia Parkway | Ricoh MP 6001SP | Kyocera 6002i (B) 6052ci | 60 55 | 12548 | | 250,000 | \$ 110 | \$ 160 | 0.0044 | 0.04 | \$500 | |
| City Hall-Engineering 1st Floor 11222 Acacia Parkway | Ricoh MP C5502A | Kyocera 6052ci | 60 55 | 9562 | 1821 | 250,000 | \$ 160 | \$ 160 | 0.0044 | 0.04 | \$500 | |
| Community Meeting Center 11300 Stanford Avenue | Ricoh MP 6001SP | Kyocera 6002i (B) 6052ci | 60 55 | 1854 | | 250,000 | \$ 110 | \$ 160 | 0.0044 | 0.04 | \$500 | Option C: 3011i (30 ppm) Lease= \$85 3252ci (32 ppm) Lease= \$95 |
| Juvenile Justice Center 11301 Acacia Parkway | Ricoh MP 6001SP | Kyocera 6002i (B) 6052ci | 60 55 | 5169 | | 250,000 | \$ 110 | \$ 160 | 0.0044 | 0.04 | \$500 | Option C: 5002i (50ppm) lease= \$90 5052ci (50 ppm) lease= \$140 |
| Fire Department 11301 Acacia Parkway | Ricoh MP C5502A | Kyocera 6052ci | 60 55 | 4570 | 1523 | 250,000 | \$ 160 | \$ 160 | 0.0044 | 0.04 | \$500 | Option C: 5002i (50ppm) lease= \$90 5052ci (50 ppm) lease= \$141 |
| Central Stores 13802 Newhope Street | Ricoh MP 6001SP | Kyocera 6002i (B) 6052ci | 60 55 | 541 | | 250,000 | \$ 110 | \$ 160 | 0.0044 | 0.04 | \$500 | Option C: 3011i (30 ppm) Lease= \$85 3252ci (32 ppm) Lease= \$95 |
| Police Department (Gang Unit) 11301 Acacia Parkway | Ricoh MP 6001SP | Kyocera 6002i (B) 6052ci | 60 55 | 4872 | | 250,000 | \$ 110 | \$ 160 | 0.0044 | 0.04 | \$500 | Option C: 5002i (50ppm) lease= \$90 5052ci (50 ppm) lease= \$141 |

| Kyocera Production & Office MFP's Location | Current Equipment Model Name and Number | Kyocera's Recommended Equipment | | | | | Monthly Base Lease Payment 60 month lease | Monthly Base Lease Payment 60 month lease | Service Cost Per impression B/W | Service Cost Per impression Color | Fair Market Trade In Value | Notes |
|---|--|---|---------------------|----------------|------------------|-----------------------------|---|---|--|--|-------------------------------|--|
| | | Model Name and Number | PPM B/W Color | Mo. Avg B/W | Mo. Avg Color | Monthly Volume Rating | | | | | | |
| Public Works Main Office 13802 Newhope Street | Ricoh MP C5502A | Kyocera 6052ci | 60 55 | 4036 | 448 | 250,000 | \$ 160 | \$ 160 | 0.0044 | 0.04 | \$500 | Option C: 5002i (50ppm) lease= \$90 5052ci (50 ppm) lease= \$141 |
| Police Department (Records) 11301 Acacia Parkway | Ricoh MP 7001SP | Kyocera 8002i | 80 | 28865 | | 450,000 | \$ 190 | \$ 190 | 0.0044 | | \$500 | |
| Police Department (Records) 11301 Acacia Parkway | Ricoh MP 7001SP | Kyocera 8002i | 80 | 34266 | | 450,000 | \$ 190 | \$ 190 | 0.0044 | | \$500 | |
| Police Department (2nd Floor) 11301 Acacia Parkway | Ricoh MP C5502A | Kyocera 6052ci | 60 55 | 9782 | 1462 | 250,000 | \$ 160 | \$ 160 | 0.0044 | 0.04 | \$500 | |
| Police Department (1st Floor Report Writing) 11301 Acacia Parkway | Ricoh MP 6054SP | Kyocera 6002i (B) 6052ci | 60 55 | 10602 | | 250,000 | \$ 110 | \$ 160 | 0.0044 | 0.04 | \$500 | |
| Housing Authority 11277 Garden Grove Blvd | Ricoh MP C3002 | Kyocera 3252ci | 32 32 | 3143 | 64 | 125,000 | \$ 95 | \$ 95 | 0.0044 | 0.04 | \$500 | |
| Housing Authority 12966 Euclid St. Suite 150 | Canon iR- 2830 | Kyocera 3011i (B) 3252ci | 30 (B) 32 32 | 3207 | | 125,000 | \$ 85 | \$ 95 | 0.0044 | 0.04 | \$500 | |
| Cable TV Production 11277 Garden Grove Blvd | Ricoh MP 2852 | Kyocera 3011i (B) 3252ci | 31 (B) 32 32 | 346 | | 125,000 | \$ 85 | \$ 95 | 0.0044 | 0.04 | \$500 | |
| Magnolia Family Resource Center 11402 Magnolia Street | Ricoh MP 2853 | Kyocera 3011i (B) 3252ci | 32 (B) 32 32 | 3316 | | 125,000 | \$ 85 | \$ 95 | 0.0044 | 0.04 | \$500 | |
| Buena Clinton Family Resource Center | Ricoh MP2550SPF | Kyocera 3011i (B) 3252ci | 33 (B) 32 32 | 9458 | | 125,000 | \$ 85 | \$ 95 | 0.0044 | 0.04 | \$500 | |
| Public Works Water Services 13802 Newhope Street | Ricoh C5501 | Kyocera 6052ci | 60 55 | 2261 | 1328 | 250,000 | \$ 160 | \$ 160 | 0.0044 | 0.04 | \$500 | Option C: 5002i (50ppm) lease= \$ 5052ci (50 ppm) lease= \$ |
| Senior Center 11300 Stanford Avenue | Ricoh C2550 | Kyocera 3011i (B) 3252ci | 33 (B) 32 32 | 3068 | 162 | 125,000 | \$ 85 | \$ 95 | 0.0044 | 0.04 | \$500 | |
| NSI Autostore 7 6 Devices / 1 Workflow Installed & Configured | | | | | | | \$ 198 | \$ 198 | | | | Includes professional services, configuration, & on site training. |
| Delivery, Install & Training | | | | | | | \$ 195 | \$ 195 | | | | Includes delivery, networking, picking up existing units and on site training. |
| | | TOTAL | | 321,477 | 32,229 | | \$ 5,876 | \$ 6,326 | | | \$13,000 | |

| Kyocera Desktop Devices Location | Current Equipment | Kyocera's Recommended Equipment | | | | | Monthly Base Lease | Monthly Base Lease | Fair Market Trade In Value | Notes |
|-------------------------------------|-----------------------|-----------------------------------|---------------|-------------|---------------|-----------------------|------------------------|------------------------|----------------------------|--|
| | Model Name and Number | Model Name and Number | PPM B/W Color | Mo. Avg B/W | Mo. Avg Color | Monthly Volume Rating | Payment 60 month lease | Payment 60 month lease | | |
| | HP Printer | Kyocera FS-4200DN | 52 | | | 250,000 | Included Or \$14 less | Included Or \$14 less | 0.0044 | 1-Free FS-4200 Toner Or \$50 trade in value |
| | HP Printer | Kyocera FS-4200DN | 52 | | | 250,000 | Included Or \$14 less | Included Or \$14 less | 0.0044 | 1-Free FS-4200 Toner Or \$50 trade in value |
| | HP Printer | Kyocera FS-4200DN | 52 | | | 250,000 | Included Or \$14 less | Included Or \$14 less | 0.0044 | 1-Free FS-4200 Toner Or \$50 trade in value |
| | HP Printer | Kyocera FS-4200DN | 52 | | | 250,000 | Included Or \$14 less | Included Or \$14 less | 0.0044 | 1-Free FS-4200 Toner Or \$50 trade in value |
| | HP Printer | Kyocera FS-4200DN | 52 | | | 250,000 | Included Or \$14 less | Included Or \$14 less | 0.0044 | 1-Free FS-4200 Toner Or \$50 trade in value |
| | HP Printer | Kyocera FS-4200DN | 52 | | | 250,000 | Included Or \$14 less | Included Or \$14 less | 0.0044 | 1-Free FS-4200 Toner Or \$50 trade in value |
| | HP Printer | Kyocera FS-4200DN | 52 | | | 250,000 | Included Or \$14 less | Included Or \$14 less | 0.0044 | 1-Free FS-4200 Toner Or \$50 trade in value |
| | HP Printer | Kyocera FS-4200DN | 52 | | | 250,000 | Included Or \$14 less | Included Or \$14 less | 0.0044 | 1-Free FS-4200 Toner Or \$50 trade in value |
| | HP Printer | Kyocera FS-4200DN | 52 | | | 250,000 | Included Or \$14 less | Included Or \$14 less | 0.0044 | 1-Free FS-4200 Toner Or \$50 trade in value |
| | HP Printer | Kyocera FS-4200DN | 52 | | | 250,000 | Included Or \$14 less | Included Or \$14 less | 0.0044 | 1-Free FS-4200 Toner Or \$50 trade in value |

| Kyocera Desktop Devices Location | Current Equipment | Kyocera's Recommended Equipment | | | | | Monthly Base Lease | Monthly Base Lease | Fair Market Trade In Value | Notes |
|-------------------------------------|-----------------------|-----------------------------------|---------------|-------------|---------------|-----------------------|------------------------|------------------------|----------------------------|--|
| | Model Name and Number | Model Name and Number | PPM B/W Color | Mo. Avg B/W | Mo. Avg Color | Monthly Volume Rating | Payment 60 month lease | Payment 60 month lease | | |
| | HP Printer | Kyocera FS-4200DN | 52 | | | 250,000 | Included Or \$14 less | Included Or \$14 less | 0.0044 | 1-Free FS-4200 Toner Or \$50 trade in value |
| | HP Printer | Kyocera FS-4200DN | 52 | | | 250,000 | Included Or \$14 less | Included Or \$14 less | 0.0044 | 1-Free FS-4200 Toner Or \$50 trade in value |
| | HP Printer | Kyocera FS-4200DN | 52 | | | 250,000 | Included Or \$14 less | Included Or \$14 less | 0.0044 | 1-Free FS-4200 Toner Or \$50 trade in value |
| | HP Printer | Kyocera FS-4200DN | 52 | | | 250,000 | Included Or \$14 less | Included Or \$14 less | 0.0044 | 1-Free FS-4200 Toner Or \$50 trade in value |
| | HP Printer | Kyocera FS-4200DN | 52 | | | 250,000 | Included Or \$14 less | Included Or \$14 less | 0.0044 | 1-Free FS-4200 Toner Or \$50 trade in value |
| | HP Printer | Kyocera FS-4200DN | 52 | | | 250,000 | Included Or \$14 less | Included Or \$14 less | 0.0044 | 1-Free FS-4200 Toner Or \$50 trade in value |
| | HP Printer | Kyocera FS-4200DN | 52 | | | 250,000 | Included Or \$14 less | Included Or \$14 less | 0.0044 | 1-Free FS-4200 Toner Or \$50 trade in value |
| | HP Printer | Kyocera FS-4200DN | 52 | | | 250,000 | Included Or \$14 less | Included Or \$14 less | 0.0044 | 1-Free FS-4200 Toner Or \$50 trade in value |
| | HP Printer | Kyocera FS-4200DN | 52 | | | 250,000 | Included Or \$14 less | Included Or \$14 less | 0.0044 | 1-Free FS-4200 Toner Or \$50 trade in value |
| | HP Printer | Kyocera FS-4200DN | 52 | | | 250,000 | Included Or \$14 less | Included Or \$14 less | 0.0044 | 1-Free FS-4200 Toner Or \$50 trade in value |

| Kyocera Desktop Devices Location | Current Equipment | Kyocera's Recommended Equipment | | | | | Monthly Base Lease | Monthly Base Lease | Fair Market Trade In Value | Notes |
|-------------------------------------|-----------------------|-----------------------------------|---------------|-------------|---------------|-----------------------|------------------------|------------------------|----------------------------|--|
| | Model Name and Number | Model Name and Number | PPM B/W Color | Mo. Avg B/W | Mo. Avg Color | Monthly Volume Rating | Payment 60 month lease | Payment 60 month lease | | |
| | HP Printer | Kyocera FS-4200DN | 52 | | | 250,000 | Included Or \$14 less | Included Or \$14 less | 0.0044 | 1-Free FS-4200 Toner Or \$50 trade in value |
| | HP Printer | Kyocera FS-4200DN | 52 | | | 250,000 | Included Or \$14 less | Included Or \$14 less | 0.0044 | 1-Free FS-4200 Toner Or \$50 trade in value |
| | HP Printer | Kyocera FS-4200DN | 52 | | | 250,000 | Included Or \$14 less | Included Or \$14 less | 0.0044 | 1-Free FS-4200 Toner Or \$50 trade in value |
| | HP Printer | Kyocera FS-4200DN | 52 | | | 250,000 | Included Or \$14 less | Included Or \$14 less | 0.0044 | 1-Free FS-4200 Toner Or \$50 trade in value |
| | HP Printer | Kyocera FS-4200DN | 52 | | | 250,000 | Included Or \$14 less | Included Or \$14 less | 0.0044 | 1-Free FS-4200 Toner Or \$50 trade in value |
| | HP Printer | Kyocera FS-4200DN | 52 | | | 250,000 | Included Or \$14 less | Included Or \$14 less | 0.0044 | 1-Free FS-4200 Toner Or \$50 trade in value |
| | HP Printer | Kyocera FS-4200DN | 52 | | | 250,000 | Included Or \$14 less | Included Or \$14 less | 0.0044 | 1-Free FS-4200 Toner Or \$50 trade in value |
| | HP Printer | Kyocera FS-4200DN | 52 | | | 250,000 | Included Or \$14 less | Included Or \$14 less | 0.0044 | 1-Free FS-4200 Toner Or \$50 trade in value |
| | HP Printer | Kyocera FS-4200DN | 52 | | | 250,000 | Included Or \$14 less | Included Or \$14 less | 0.0044 | 1-Free FS-4200 Toner Or \$50 trade in value |
| | HP Printer | Kyocera FS-4200DN | 52 | | | 250,000 | Included Or \$14 less | Included Or \$14 less | 0.0044 | 1-Free FS-4200 Toner Or \$50 trade in value |

| Kyocera Desktop Devices Location | Current Equipment | Kyocera's Recommended Equipment | | | | | Monthly Base Lease | Monthly Base Lease | Fair Market Trade In Value | Notes |
|-------------------------------------|-----------------------|-----------------------------------|---------------|-------------|---------------|-----------------------|------------------------|------------------------|----------------------------|--|
| | Model Name and Number | Model Name and Number | PPM B/W Color | Mo. Avg B/W | Mo. Avg Color | Monthly Volume Rating | Payment 60 month lease | Payment 60 month lease | | |
| | HP Printer | Kyocera FS-4200DN | 52 | | | 250,000 | Included Or \$14 less | Included Or \$14 less | 0.0044 | 1-Free FS-4200 Toner Or \$50 trade in value |
| | HP Printer | Kyocera FS-4200DN | 52 | | | 250,000 | Included Or \$14 less | Included Or \$14 less | 0.0044 | 1-Free FS-4200 Toner Or \$50 trade in value |
| | HP Printer | Kyocera FS-4200DN | 52 | | | 250,000 | Included Or \$14 less | Included Or \$14 less | 0.0044 | 1-Free FS-4200 Toner Or \$50 trade in value |
| | HP Printer | Kyocera FS-4200DN | 52 | | | 250,000 | Included Or \$14 less | Included Or \$14 less | 0.0044 | 1-Free FS-4200 Toner Or \$50 trade in value |
| | HP Printer | Kyocera FS-4200DN | 52 | | | 250,000 | Included Or \$14 less | Included Or \$14 less | 0.0044 | 1-Free FS-4200 Toner Or \$50 trade in value |
| | HP Printer | Kyocera FS-4200DN | 52 | | | 250,000 | Included Or \$14 less | Included Or \$14 less | 0.0044 | 1-Free FS-4200 Toner Or \$50 trade in value |
| | HP Printer | Kyocera FS-4200DN | 52 | | | 250,000 | Included Or \$14 less | Included Or \$14 less | 0.0044 | 1-Free FS-4200 Toner Or \$50 trade in value |
| | HP Desktop MFP | Kyocera M3550 | 50 | | | 250,000 | Included Or \$30 less | Included Or \$30 less | 0.0044 | 1-Free M3550 Toner Or \$50 trade in value |
| | HP Desktop MFP | Kyocera M3550 | 50 | | | 250,000 | Included Or \$30 less | Included Or \$30 less | 0.0044 | 1-Free M3550 Toner Or \$50 trade in value |
| | HP Desktop MFP | Kyocera M3550 | 50 | | | 250,000 | Included Or \$30 less | Included Or \$30 less | 0.0044 | 1-Free M3550 Toner Or \$50 trade in value |
| | HP Desktop MFP | Kyocera M3550 | 50 | | | 250,000 | Included Or \$30 less | Included Or \$30 less | 0.0044 | 1-Free M3550 Toner Or \$50 trade in value |

| Kyocera Desktop Devices Location | Current Equipment | Kyocera's Recommended Equipment | | | | | Monthly Base Lease | Monthly Base Lease | Fair Market Trade In Value | Notes |
|-------------------------------------|-----------------------|---------------------------------|---------------|-------------|---------------|-----------------------|------------------------|------------------------|----------------------------|---|
| | Model Name and Number | Model Name and Number | PPM B/W Color | Mo. Avg B/W | Mo. Avg Color | Monthly Volume Rating | Payment 60 month lease | Payment 60 month lease | | |
| | HP Desktop MFP | Kyocera M3550 | 50 | | | 250,000 | Included Or \$30 less | Included Or \$30 less | 0.0044 | 1-Free M3550 Toner Or \$50 trade in value |
| | HP Desktop MFP | Kyocera M3550 | 50 | | | 250,000 | Included Or \$30 less | Included Or \$30 less | 0.0044 | 1-Free M3550 Toner Or \$50 trade in value |
| | HP Desktop MFP | Kyocera M3550 | 50 | | | 250,000 | Included Or \$30 less | Included Or \$30 less | 0.0044 | 1-Free M3550 Toner Or \$50 trade in value |
| | HP Desktop MFP | Kyocera M3550 | 50 | | | 250,000 | Included Or \$30 less | Included Or \$30 less | 0.0044 | 1-Free M3550 Toner Or \$50 trade in value |
| | HP Desktop MFP | Kyocera M3550 | 50 | | | 250,000 | Included Or \$30 less | Included Or \$30 less | 0.0044 | 1-Free M3550 Toner Or \$50 trade in value |
| | HP Desktop MFP | Kyocera M3550 | 50 | | | 250,000 | Included Or \$30 less | Included Or \$30 less | 0.0044 | 1-Free M3550 Toner Or \$50 trade in value |
| | HP Color Printer | Kyocera P6035 | 37 37 | | | 140,000 | Included Or \$20 less | Included Or \$20 less | 0.0044 | 0.04 1-Free set of CMYK Toner Or \$230 trade in value |
| | HP Color Printer | Kyocera P6035 | 37 37 | | | 140,000 | Included Or \$20 less | Included Or \$20 less | 0.0044 | 0.04 1-Free set of CMYK Toner Or \$230 trade in value |
| | HP Color Printer | Kyocera P6035 | 37 37 | | | 140,000 | Included Or \$20 less | Included Or \$20 less | 0.0044 | 0.04 1-Free set of CMYK Toner Or \$230 trade in value |
| | HP Color Printer | Kyocera P6035 | 37 37 | | | 140,000 | Included Or \$20 less | Included Or \$20 less | 0.0044 | 0.04 1-Free set of CMYK Toner Or \$230 trade in value |
| | HP Color Printer | Kyocera P6035 | 37 37 | | | 140,000 | Included Or \$20 less | Included Or \$20 less | 0.0044 | 0.04 1-Free set of CMYK Toner Or \$230 trade in value |

| Kyocera Desktop Devices Location | Current Equipment | Kyocera's Recommended Equipment | | | | Monthly Base Lease | Monthly Base Lease | Fair Market Trade In Value | Notes | |
|-------------------------------------|-----------------------|---------------------------------|---------------|-------------|---------------|-----------------------|--------------------------|----------------------------|----------------|---|
| | Model Name and Number | Model Name and Number | PPM B/W Color | Mo. Avg B/W | Mo. Avg Color | Monthly Volume Rating | Payment 60 month lease | | | Payment 60 month lease |
| | HP Color Printer | Kyocera P6035 | 37 37 | | | 140,000 | Included Or \$20 less | Included Or \$20 less | 0.0044 0.04 | 1-Free set of CMYK Toner Or \$230 trade in value |
| | HP Color Printer | Kyocera P6035 | 37 37 | | | 140,000 | Included Or \$20 less | Included Or \$20 less | 0.0044 0.04 | 1-Free set of CMYK Toner Or \$230 trade in value |
| | HP Color Printer | Kyocera P6035 | 37 37 | | | 140,000 | Included Or \$20 less | Included Or \$20 less | 0.0044 0.04 | 1-Free set of CMYK Toner Or \$230 trade in value |
| | HP Color Printer | Kyocera P6035 | 37 37 | | | 140,000 | Included Or \$20 less | Included Or \$20 less | 0.0044 0.04 | 1-Free set of CMYK Toner Or \$230 trade in value |
| | HP Color Printer | Kyocera P6035 | 37 37 | | | 140,000 | Included Or \$20 less | Included Or \$20 less | 0.0044 0.04 | 1-Free set of CMYK Toner Or \$230 trade in value |

\$1,060 LESS PER MONTH IF DON'T WANT DESKTOP DEVICES INCLUDED

| Option A | Qty | Option B | Qty | Kyocera Desktop Devices | Qty |
|----------|-----|----------|-----|-------------------------|-----|
| 1250 | 2 | 1250 | 2 | FS-4200 | 40 |
| 8052ci | 1 | 8052ci | 1 | M3550 | 10 |
| 8002i | 2 | 8002i | 2 | P6035 | 10 |
| 6052ci | 7 | 6052ci | 16 | | |
| 3252ci | 2 | 3252ci | 6 | | |
| 3011i | 4 | | | | |
| 6002i | 9 | | | | |

PROPOSED SOLUTION FOR: City of Garden Grove

The following is our proposed installation mix of printers, A4/A3 BW and color so that your company can be more efficient with printing devices that save you money and are properly utilized to minimize waste.

Please see attached brochure or specification sheet for more details.

| QTY (A) | QTY (B) | MODEL | DESCRIPTION |
|---------|---------|-------------------|---|
| 1 | 1 | bizhub PRESS 1250 | 125 PPM B/W Production Printer |
| 1 | 1 | bizhub PRESS 1250 | PF-703 Vacuum Paper Feed Unit |
| 1 | 1 | bizhub PRESS 1250 | PI-502 Multi Post INserter |
| 1 | 1 | bizhub PRESS 1250 | LS-506 Large Stacker Unit |
| 1 | 1 | bizhub PRESS 1250 | SD-513 Saddle Stitcher |
| 1 | 1 | bizhub PRESS 1250 | SD-513/F Saddle Stitcher Front |
| 1 | 1 | bizhub PRESS 1250 | CR-101 Creaser Unit |
| 1 | 1 | bizhub PRESS 1250 | FD-504 Square Folding Unit |
| 1 | 1 | bizhub PRESS 1250 | TU-503 Trimmer Unit |
| 1 | 1 | bizhub PRESS 1250 | LC-501 Additional Cart for LS-505 |
| 1 | 1 | bizhub PRESS 1250 | RU-509 Relay / Buffer Pass Unit |
| 1 | 1 | bizhub PRESS 1250 | FS-532 100 Sheet Staple Finisher |
| 1 | 1 | bizhub PRESS 1250 | 125 PPM B/W Production Printer |
| 1 | 1 | bizhub PRESS 1250 | PF-703 Vacuum Paper Feed Unit |
| 1 | 1 | bizhub PRESS 1250 | RU-509 Relay/Buffer Pass Unit |
| 1 | 1 | bizhub PRESS 1250 | FS-532 100 Sheet Staple Finisher |
| 1 | 1 | TASKalfa 8052ci | A3 Color Copier |
| 1 | 1 | TASKalfa 8052ci | EFI COLOR PROFILER SYS 15 V4 W ES-2000 & 5 YR SUPPORT |
| 1 | 1 | TASKalfa 8052ci | 4000 SHEET FINISHER |
| 1 | 1 | TASKalfa 8052ci | EFI SEQUENCE SUITE (IMPOSE + COMPOSE) |
| 1 | 1 | TASKalfa 8052ci | FAX SYSTEM 12 |
| 2 | 2 | TASKalfa TA8002i | A3 Black And White MFP |
| 2 | 2 | TASKalfa TA8002i | 4000 SHEET FINISHER |
| 2 | 2 | TASKalfa TA8002i | FAX SYSTEM 12 |
| 7 | 16 | TASKalfa 6052ci | 60/55 PPM COLOR MFP |
| 7 | 16 | TASKalfa 6052ci | 270 DUAL SHEET SCAN DOC PROCESSOR |
| 7 | 16 | TASKalfa 6052ci | ATTACHMENT KIT FOR DF-7120/7110 |
| 7 | 16 | TASKalfa 6052ci | 1000 SHEET FINISHER |
| 7 | 16 | TASKalfa 6052ci | FAX SYSTEM 12 |
| 7 | 16 | TASKalfa 6052ci | DUAL 1500 SHEET PAPER DECK |
| 9 | 0 | TASKalfa 6002i | A3 B/W MFP |
| 9 | 0 | TASKalfa 6002i | 270 DUAL SHEET SCAN DOC PROCESSOR |
| 9 | 0 | TASKalfa 6002i | ATTACHMENT KIT FOR DF-7120/7110 |
| 9 | 0 | TASKalfa 6002i | 1000 SHEET FINISHER |
| 9 | 0 | TASKalfa 6002i | DUAL 1500 SHEET PAPER DECK |
| 9 | 0 | TASKalfa 6002i | FAX SYSTEM 12 |
| 2 | 6 | TASKalfa 3252ci | 32/32 PPM COLOR MFP |
| 2 | 6 | TASKalfa 3252ci | ATTACHMENT KIT FOR DF-7120/7110 |
| 2 | 6 | TASKalfa 3252ci | 270 DUAL SHEET SCAN DOC PROCESSOR |
| 2 | 6 | TASKalfa 3252ci | 1000 SHEET FINISHER |
| 2 | 6 | TASKalfa 3252ci | DUAL 1500 SHEET PAPER DECK |
| 2 | 6 | TASKalfa 3252ci | FAX SYSTEM 12 |
| 4 | 0 | TASKalfa 3011i | A3 B/W MFP |
| 4 | 0 | TASKalfa 3011i | Attachment kit for DF-7120/DF-791 |

| | | | |
|----|----|------------------|---|
| 4 | 0 | TASKalfa 3011i | Stand |
| 4 | 0 | TASKalfa 3011i | 1,000 Sheet Finisher (Requires AK-740 for Installation) |
| 4 | 0 | TASKalfa 3011i | 270 DUAL SHEET SCAN DOC PROCESSOR |
| 40 | 40 | ECOSYS FS-4200DN | A4 52PPM Monochrome Printer |
| 10 | 10 | ECOSYS M3550idn | 4 in 1 Model |
| 10 | 10 | ECOSYS P6035cdn | Color Printer |
| 6 | 6 | AutoStore 7 | NSI AutoStore 7 |
| | | | |
| | | | |
| | | | |
| | | | |
| | | | |

Please see attached brochure or specification sheet for more details.

Lease Options

| Option A PAYMENT | Option B Payment | TERM |
|------------------|------------------|------|
| \$5,876.00 | \$6,326.00 | 60 |

Includes: FMV Trade in Rebate of \$13,000.00 City will receive 3 weeks after delivery & install.

Maintenance and Supplies

The cost per impression includes:

- All parts, labor, toner and service calls. 4-hour response time.
- Up to 0 mono copies per month with additional mono copies billed quarterly at \$0.0044 per copy.
- Up to 0 color copies per month with additional color copies billed quarterly at \$0.04 per copy.

EXCLUDES: paper and staples.



Document Solutions West



KYOCERA FLEET SERVICES (KFS)

Kyocera Fleet Services (KFS) revolutionizes how our technicians will be able to interface with and repair Kyocera hardware devices remotely.

With Kyocera Fleet Services a qualified technician can gain access to the troubled unit, be able to run maintenance checks, see the machine logs, and even make some preventative adjustments while on his/her computer. If a dispatch is required, the knowledge gained from access to the KFS system allows for call preparation, i.e. parts or supplies, thereby lessening downtime by problem resolution on the first trip.

Kyocera Fleet Services remote maintenance features include

Snapshots:

A System Manager or Technician can obtain Status Pages, Event Log, Fax Reports, Application Status pages, USB Log, etc. remotely.

Panel Screenshot:

A Manager or Technician can remotely capture the device Panel Display to view what the device conditions are at the Customers site.

Remote Restart:

A Remote Restart Command can be sent to the device to power the device OFF/ON to reset it due to an error, etc.

Device settings:

Device settings such as Scan basic and Email SMTP can be changed remotely.

Maintenance mode:

Maintenance mode settings can be viewed and changed remotely, for a Single Device or Multiple Devices of the same model.

Panel note:

Send a custom notification to display on the device Panel to notify users of maintenance activity.

Send file:

A technician can Send a test file remotely to the device for troubleshooting purposes.

Data capture:

Data capture receives and encapsulates print jobs and print activity for the device to aid in troubleshooting.

Firmware upgrade:

Remotely Upgrade single or multiple Device Firmware.

PERFORMANCE ASSURANCE

Response Guarantee

When you contact our Customer Response Center, certified service engineers will attempt to respond to your emergency service calls at your location within three business hours. In no event will our average response time, measured over ninety days, exceed four (4) business hours.

Up-Time Guarantee

No piece of equipment covered by this agreement will experience less than 95% uptime for any two consecutive quarters. In the event that equipment availability is less than guaranteed, PROBLEM UNIT WILL BE REPLACED WITH SAME OR EQUIVILANT UNIT, AT NO ADDITIONAL COST TO CUSTOMER.

Qualified Downtime

Calculations begin at the time KMA receives the emergency service call and continues until the service call is completed by a KMA technician and the piece of equipment is properly operational.

Loaner Equipment

We will deliver and install similar or upgraded equipment for your use at no added cost in the remote event that we are unable to repair the equipment within 48 hours until the original equipment is repaired.

Electrical Requirements

TaskAlfa 8052ci Electrical Requirements: 120V, 60Hz, 12A; 220-240V, 50Hz, 10A

Typical Electricity Consumption (TEC): 120V: 6.3 kWh/week; 220V: 5.9 kWh/week

TaksAlfa 8002i Electrical Requirements: 120V, 60Hz, 12A; 220-240V, 50Hz, 7.2A

Typical Electricity Consumption (TEC): 120V: 4.7 kWh/week; 220V: 4.5 kWh/week

TaskAlfa 6052ci Electrical Requirements: 120V, 60Hz, 12A; 220-240V, 50Hz, 7.2A

Typical Electricity Consumption (TEC): 120V: 3.2 kWh/week; 220V: 3.1 kWh/week

TaskAlfa 6002i Electrical Requirements: 120V, 60Hz, 12A; 220-240V, 50Hz, 7.2A

Typical Electricity Consumption (TEC): 120V: 3.0 kWh/week; 220V: 3.0 kWh/week

TaskAlfa 3252ci Electrical Requirements: 120V, 60Hz, 12A; 220-240V, 50Hz, 7.2A

Typical Electricity Consumption (TEC): 120V: 1.6 kWh/week; 220V: 1.5 kWh/week

TaskAlfa 3011i Electrical Requirements: 120V, 60Hz, 11.6A; 220-240V, 50Hz, 6.3A
Typical Electricity Consumption (TEC): 120V: 1.8 kWh/week; 220V: 1.8 kWh/week

ECOSYS FS-4200dn Electrical Requirements: 120V, 60Hz, 9.7A; 220-240V, 50-60Hz, 5.2A

ECOSYS M3550idn Electrical Requirements: 120v, 60Hz, 10.4A; 220-240V, 50/60Hz, 5.2A

ECOSYS P6035cdn Electrical Requirements: 120v, 60Hz, 10.0A; 220-240V, 50/60Hz, 5.6A

Production Press Electrical Requirements

Konica Minolta bizhub PRESS 1250/1250P/1052 Specification & Installation Guide



KONICA MINOLTA

bizhub PRESS 1250/1250P/1052 Specifications

continued

| | |
|-----------------------|--|
| Noise | 8.0 dB or less (using the measurement method compliant with ISO7779/9266) |
| Power requirements | AC 208–240 V/24 A; 60 Hz |
| Power consumption | 5.76 KW or less (Paper Feeder Unit PF-703 x 2 + Main body + Large Capacity Post Inserter PI-PFU + Relay Unit RU-509 (+ Humidifier HM-102) + Relay Unit RU-510 + Folding Unit FD-503 + Saddle Stitcher SD-506 + Finisher FS-532) |
| Weight | 820.1 lb. (372 kg) |
| Dimensions | <ul style="list-style-type: none"> • Main body: 38.9"(W) x 35.8"(D) x 57.1"(H) inches • Main body + Paper Feeder Unit PF-703 + Relay Unit RU-510 + Folding Unit FD-503 + Finisher FS-532: 142.8"(W) x 35.6"(D) x 57.1"(H) inches |
| Space requirements | (Space required for the safe operation) 7.9 inches or more from the back (back side of the duct); 3.9 inches or more from both right and left sides |
| Operating temperature | 10°C (50°F) to 30°C (86°F)* |
| Humidity | 10% to 80%* |

Duty Cycle

bizhub PRESS 1250/1250P: 3,000,000

bizhub PRESS 1052: 2,000,000

Maximum monthly copy/print volume supported under standard vendor supplied service. Defines the upper end of the expected customer volume for the device. Customers should consider multiple machines if average monthly volume approaches duty cycle on continual basis.

Environmental Requirements

| | |
|-----------------|--|
| Temperature | 50° to 86° F |
| Humidity | 10–80% RH |
| Standby Noise | 60 dBA |
| Operating Noise | 80 dBA |
| Ozone Emission | 1250/1250P: < 0.025 mg/m ³ 1052: < 0.020 mg/m ³ |



Electrical Requirements — Engine

| | | |
|---------------|-------------|---|
| Line Options | Dedicated | NEMA Diagram for L6-30R |
| Voltage | 208–240V AC |  |
| Amperage | 24 A | |
| Cycles | 60 Hz | |
| NEMA Part No. | L6-30R | |
| Cord Length: | 7.5 ft. | |

NOTE: The main electrical outlet must be located within 7.5 feet from the right rear corner of the bizhub PRESS 1250/1250P/1052.

Electrical Requirements — Options

All system options are powered by the engine except the following components which require their own electrical outlets:

| | | |
|---------------------------|----------------|---|
| RU-509 Relay Unit | 5-15R or 5-20R | NEMA Diagram for 5-15R |
| PB-503 Perfect Blender | 5-15R or 5-20R |  <p>or</p>  |
| GP-501 Punch Unit | 5-15R or 5-20R | |
| GP-502 Ring Blender | 5-15R or 5-20R | |
| | | |

NOTE: The main electrical outlet must be located within 7.5 feet from the right rear corner of the bizhub PRESS 1250/1250P/1052.

Your Dedicated Sales & Service Team

Service Dispatch, 949-580-2140 x 1, CA.Branch@da.Kyocera.com

Steve Zaldin, Government Account Executive, 714-865-4379, Steve.Zaldin@da.Kyocera.com

Seneca Hayden, Government Sales Manager, 949-580-2156, Seneca.Hayden@da.Kyocera.com

James Wilks, Sales Director of Federal Government Solutions, 800-996-9591 x 5656, James.Wilks@da.Kyocera.com

Travis Felton, Service Supervisor, 818-438-2007, Travis.Felton@da.Kyocera.com

Richard Gomez, Network Service Supervisor, 949-580-5572, Richard.Gomez@da.Kyocera.com

Michael Graves, Vice President, Technical Operations, 949-580-2152, Michael.Graves@da.Kyocera.com

Eric Nave, Vice President of Sales, 800-996-9591 x 5649, Eric.Nave@da.Kyocera.com

Max Razaqui, President of West, 800-996-9591 x 0204, Max.Razaqui@da.Kyocera.com

Business References

All of these business references have had large installs comparable to City of Garden Grove, all are on lease agreements with all-inclusive managed service & supplies. They have been long term clients of Kyocera.

Newport Mesa Unified School District - Customer Since 2000 – 100+ Kyocera's

Jonathan Koyama 714-424-5079 Lead Procurement Analysis JKoyama@nmusd.us

City of Coronado - Customer Since 2013 – 100+ Kyocera's

Brian Lewton 619-522-2401 IT Manager BLewton@coronado.ca.us

City of El Segundo - Customer Since 2012 – 100+ Kyocera's

Dave Gray 310-524-2232 IT Manager DGray@elsegundo.org

Tempe Unified School District – Customer Since 2012 – 100+ Kyocera's

Bill Nelson 480-730-7387 IT Customer Support Manager BNelson@tempeschools.org

Oxford Preparatory Academy - Customer Since 2012 – 100+ Kyocera's

John McKenzie 714-396-6273 IT Manager John.McKenzie@Oxfordchampions.com



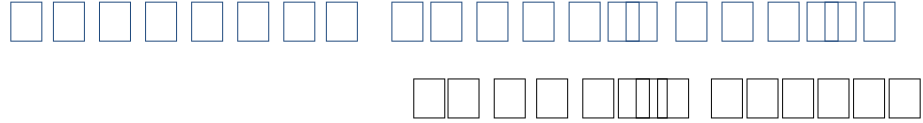

Supported MFPs:

- TASKalfa 8052ci / 7052ci

Fiery System

- Fiery® FS200
- Fiery E300platform
- Intel® Pentium® G850, 2.9 GHz
- Linux
- 500 GB SATA HDD
- 2 GB RAM



Standard

- Spot Colors
- Fiery VUE
- Booklet Maker
- Fiery Paper Catalog

Optional

- Fiery Hot Folders / Virtual Printers
- Color Profile Suite
- Fiery Impose
- Fiery Compose
- Fiery Impose-Compose
- Fiery JobMaster
- Fiery JobMaster-Impose
- Productivity Pack



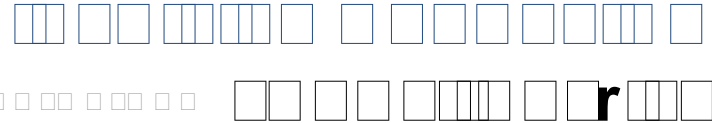
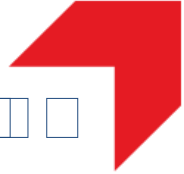

> Operation Panel

- 90° tilt screen



- Help Screen - Help guidance is equipped to navigate operation procedures and enable users to easily use desired functions.

- User-friendly Accessibility Display mode - By pressing the Accessibility Display key, screen characters are magnified for anyone needing a larger visual.

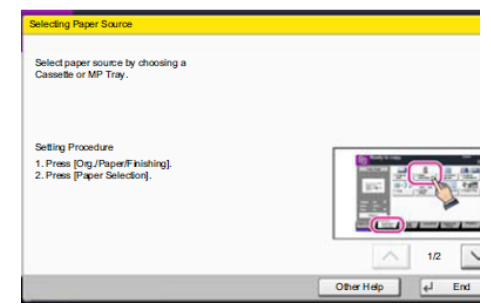
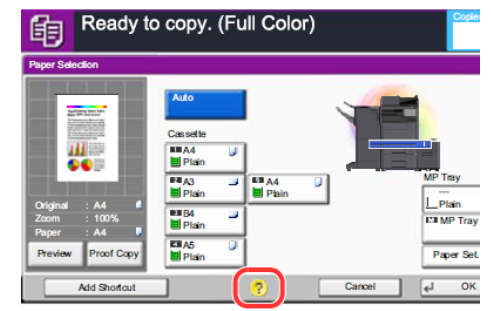

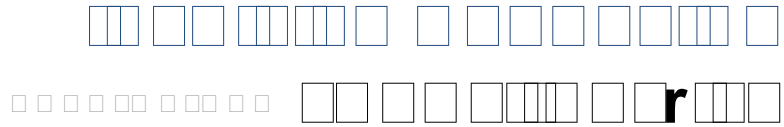
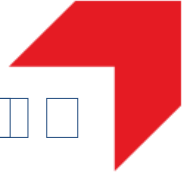

□□□□□□□□□□□□□□□□ □□ □□□ **M**□□

- › Standard Print-from / Scan-to USB convenience



- › Optional USB Keyboard support



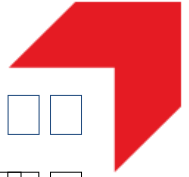
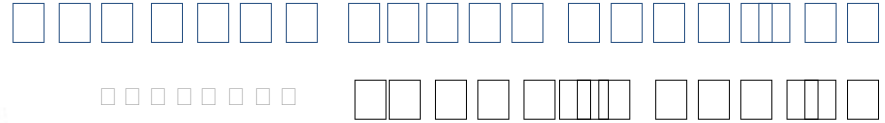

Optimize device uptime and reduce costs with KYOCERA Fleet Services (KFS), a highly-secure cloud-based monitoring solution that offers real-time visibility into...

- > **Proactive Error Resolution:** Take a proactive approach to error resolution to ensure that your fleet operates at peak performance.
- > **Automatic Meter Reading:** Eliminate administrative burden with automatic meter reading, for accurate and timely billing.
- > **View Paper and Toner Levels:** View paper and toner levels to prevent unnecessary workflow interruptions.
- > **Identify Print, Copy, Scan and Error Codes Trends:** Identify print, copy, scan and error codes trends to make more informed decisions (fleet right-sizing), and further optimize workflow.

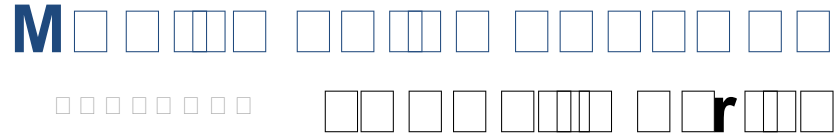

M□□□□□□ □**r**□□□□□□□□

> The TASKalfa Series offers several mobile printing solutions

- □□□□□□□ **M**□□□□□ □**r**□□□□
 - > Using KYOCERA Mobile Print application, you can: (1) print from your smart phone or tablet in your office via a WiFi network., or (2) scan to your smart phone or tablet.
 - > Supports iOS and Android OS
 - > Only available through standard network connection (IB-50/51 not supported), or via Wi-Fi Direct (on compatible Kyocera MFPs and Printers).

- □□□□□□ □**r**□**r**□□□□®
 - > For printing from your iPhone or iPad
 - > Only available through standard network connection (IB-50/51 not supported)



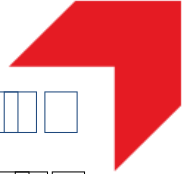

> Concerned about unauthorized access to confidential information? The TASKalfa 8052ci Series offers standard security solutions built into the device software, as well as optional enhancements, to protect sensitive documents from getting into the wrong hands.

- PDF Encryption • Password protection • Private Print • User authentication • Optional Data Security Kit for overwrite and encryption





The TASKalfa Series uses long-life imaging technology to reduce disposable waste:

- › a-Si drum technology
- › ENERGY STAR Compliant
- › Restriction of Hazardous Substances (RoHS) compliant

Energy-Saving Features

- › Conserve energy using the Energy Saver function
 - Program the device to power on or off during specified times to conserve energy.
- › Low Typical Electricity Consumption (TEC) values



Certifications

- › EPEAT Certification – Pending
- › Cerner - Pending



Kyocera-developed software allows us to address each of your customers' unique workflow needs.

HyPAS™



Developed in response to customers' needs



Increase efficiency



Reduce operational costs



Successful solution integration



□□ □□□ □□ □□ **M** □□□ □□ □□ □□ □□ □□ **FOR...**

□ **d** □□□□□□□

In this rapidly changing digital world, schools and universities need a cost-efficient way to manage documents effectively and securely.



□ □□□□□□ **r** □

Our customized business applications turn complex workflows into simple processes and bring true innovation to the healthcare environment business needs.



□□□□□

Document management is vital to the practice of law. Law firms need a way to ensure efficient document workflow while preserving the accuracy and security of information.



□□□□ **r** □□□□□

Our customizable business applications coupled with our award-winning printers and MFPs deliver powerful, streamlined document workflows that address your unique business needs.









Maintenance Improvement (Modular Replacement Design)

- Easy access for improved serviceability. Reducing service time and costs
 - Module units (Developer, Drum, Transfer Belt, Fuser)

Each module can be replaced individually in any order !

Installation and service time is dramatically reduced enabling your dealership to do more with less

TOTAL DOCUMENT SOLUTIONS



“Our mission is to deploy the KYOCERA Total Document Solutions approach in all our activities in order to increase customers’ document value in an environmentally friendly manner.”