

M



General Information: 714-741-5307

CITY OF GARDEN GROVE - DEVELOPMENT SERVICES DEPARTMENT

Inspection Requests: 714-741-5332

PERMIT (PAGE 2 of 2)

PROJECT/SITE/BUILDING DESCRIPTION

JOB Address : 13531 HARBOR BLVD
 Suite :
 PERMIT NO. : 41318
 Permit Type : SIGN
 Type : B11
 SIGNS
 Owner : JENSEN, DONALD WARREN & SUSIE
 Applicant : OUTDOOR SYSTEMS, INC.
 Appl Address : 1731 WORKMAN ST
 LOS ANGELES, CA 90031
 Phone : 213 276-7269

PROPOSED WORK:

BILLBOARD SIGN

Insp Dist : ZB
 Date : 01/26/98
 Parcel No : 10012212

Value : 25000
 Floor area : 0

FEEES

111 32509 Plan Check	1	110.50
111 32410 Permit	1	213.75
111 32401 Issuance	1	30.00
942 22130 General Plan	1	30.65
080 32550 Cultural Arts	1	15.10
111 32509 PLAN CHECK FEE CREDI	1	-110.50
TOTAL		289.50

INSPECTION RECORD

APPROVAL	DATE	INSPECTOR
Pre Inspect		
Foundation	7/7/98	[Signature]
Concrete Floor		
Reinforcing		
Masonry		
Roof Shtg		
Rough Frame		
Insul / Energy		
Drywall		
Lath		
Plas. Brown Ct.		
Landscaping		
Pre Gunite		
Pre Deck		
Pre Plaster		
Planning Final		
Bldg Final	9-17-98	[Signature]
Utility Notified		

AUTHORIZATION

Issued By: jimc _____ Date _____

DECLARATION

I certify that I have read this application/permit and state that the information on all pages of this document is correct. I agree to comply with all City and County ordinances and State laws relating to building construction, and hereby authorize representatives of this City and County to enter upon the above mentioned property for inspection purposes.

Applicant's Signature _____
 Print Name Terome Rustad Date 1-26-98

***** VALIDATION *****
 PAID ON 26 Jan 1998 AT 16:30
 RECEIVED BY DOXIE 198.245.206.11/2 TRANS# 256
 AMOUNT PAID \$579.00 BY CHECK#018254
 TOTAL PAID = \$579.00



PERMIT

(PAGE 1 OF 2)

Permit No.: 41318
Job Address: 13531 HARBOR

Type of Permit: [X] Bldg. [] Elec.
[] Mech. [] Plumb. [] Grading [] Street
[X] Sign [] Pool/Spa [] Fire Supp. Syst.

Owner
Address
Phone

Contractor OUTDOOR SYSTEMS
Address 1731 WORKMAN Street
LA CA 90031 Phone 213-276-7269
Lic. Class D34-C-10-B Lic. No. 732968

Architect/Engineer C. DENNIS HEE
Address 9440 TELSTAR #5
ELEMENTE CA 91731 Phone 818-448-7870
Type of Lic. N/A Lic. No. SE2543

Applicant Same as Above
Address
Phone

DECLARATIONS

CONTRACTOR DECLARATION

[X] I hereby affirm under penalty of perjury that I am licensed under provisions of Chapter 9 (commencing with Section 7000) of Division 3 of the Business and Professions Code, and my license is in full force and effect.

OWNER-BUILDER DECLARATION

Sec. 7031.5, Business and Professions Code (B&PC) states: "Any city or county which requires a permit to construct, alter, improve, demolish, or repair any structure, prior to its issuance, also requires the applicant for such permit to file a signed statement that he or she is licensed pursuant to the provisions of the Contractors License Law (Chapter 9; commencing with Section 7000; of Division 3 of the B&PC) or that he or she is exempt therefrom and the basis for the alleged exemption. Any violation of Section 7031.5 by any applicant for a permit subjects the applicant to a civil penalty of not more than \$500." I hereby affirm under penalty of perjury that I am exempt from the Contractors License Law for the following reason.

[] I, as owner of the property, or my employees with wages as their sole compensation, will do the work, and the structure is not intended or offered for sale. Sec. 7044, B&PC states: "The Contractor License Law does not apply to an owner of property who builds or improves thereon, and who does such work himself or herself or through his or her own employees, provided that such improvements are not intended or offered for sale. If, however, the building or improvement is sold within one year of completion, the owner-builder will have the burden of proving that he or she did not build or improve for the purpose of sale."

[] I, as owner of the property, am exclusively contracting with licensed contractors to construct the project. Sec. 7044, B&PC states: "The Contractors License Law does not apply to an owner of property who builds or improves thereon, and who contracts for such project with a contractor(s) licensed pursuant to the Contractor License Law."

[] I am exempt under Sec. _____, B&PC for the following reason:

WORKERS' COMPENSATION DECLARATION

I hereby affirm under penalty of perjury one of the following declarations:

[X] I have and will maintain workers' compensation insurance, as required by Section 3700 of the Labor Code, for the performance of the work for which this permit is issued. My workers' compensation insurance carrier and policy number are:

Carrier AMERICAN HOME ASSURANCE
Policy Number MCS854126

[] I certify that in the performance of the work for which this permit is issued, I shall not employ any person in any manner so as to become subject to the workers' compensation laws of California, and agree that if I should become subject to the workers' compensation provisions of Sec. 3700 of the Labor Code, I shall forthwith comply with those provisions.

[] I have and will maintain a certificate of consent to self insure for workers' compensation, as provided for by Section 3700 of the Labor Code, for the performance of the work for which this permit is issued.

WARNING: FAILURE TO SECURE WORKERS' COMPENSATION COVERAGE IS UNLAWFUL, AND SHALL SUBJECT AN EMPLOYER TO CRIMINAL PENALTIES AND CIVIL FINES UP TO ONE HUNDRED THOUSAND DOLLARS (\$100,000), IN ADDITION TO THE COST OF COMPENSATION, DAMAGES AS PROVIDED FOR IN SECTION 3706 OF THE LABOR CODE, INTEREST, AND ATTORNEY'S FEES.

CONSTRUCTION LENDING AGENCY

[] I hereby affirm under penalty of perjury that there is a construction lending agency for the performance of the work for which this permit is issued (Sec. 3097 Civil Code).

Lender N/A
Address

HAZMAT/AQMD DECLARATION

Will the applicant or future building occupant handle a hazardous material or a mixture containing a hazardous material equal or greater than the amounts specified in the hazardous materials information guide?

[X] NO [] YES

Refer to the AQMD permitting checklist and/or guidelines. Will the intended use of the building by the applicant or future building occupant require a permit for construction or modification from the South Coast Air Quality Management District (SCAQMD)?

[X] NO [] YES

I have read the hazardous material information guide and the SCAQMD permitting checklist. I understand my requirements under State of California Health and Safety Code, Section 2505, 2533, and 2534 concerning hazardous material reporting.

[X] YES [] NO

DEMOLITION/ASBESTOS DECLARATION

As applicant for a demolition permit, I certify that I have read Section 19827.5 of the Health and Safety Code and declare as follows:

[X] I declare that written asbestos notification is not applicable to the scheduled project.

[] On the attached sheet(s) are copies of all written asbestos notifications regarding the above referenced building that are required to be submitted to the United States Environmental Protection Agency or to a designated State agency, or both, pursuant to Part 61 of Title 40 of the Code of Federal Regulation or successor to that part.

DECLARATION

I certify that I have read this application/permit and state that the information on all pages of this document is correct. Under penalty of perjury, I hereby affirm all of the checked/marked declarations on this document. I agree to comply with all City and County ordinances and State laws relating to building construction, and hereby authorize representatives of this City and County to enter upon the above mentioned property for inspection purposes. I acknowledge that if work is not started within 180 days from the date of issue or if abandoned for more than 180 days, this permit will be null and void. I acknowledge that a fee may be charged for reinspection due to negligence, incomplete work, or a failure to make corrections.

Signature [Signature]
Print Name Jerome Rostad Date 1-26-98



General Information: 714-741-5307

CITY OF GARDEN GROVE - DEVELOPMENT SERVICES DEPARTMENT

Inspection Requests: 714-741-5332

PERMIT (PAGE 2 of 2)

PROJECT/SITE/BUILDING DESCRIPTION

JOB Address : 13531 HARBOR BLVD
 Suite :
 PERMIT NO. : 44467
 Permit Type :
 Type : E

Owner : JENSEN, DONALD WARREN & SUSIE
 Applicant : OUTDOOR SYSTEMS, INC.
 Appl Address : 1731 WORKMAN ST
 LOS ANGELES, CA 90031
 Phone : 213 276-7269

Insp Dist : ZE
 Date : 09/16/98
 Parcel No : 10012212

PROPOSED WORK:

ILLUMINATION OF BILLBOARD SIGN

FEES

942 22130 GENERAL PLAN	1	2.00
080 32550 CULTURAL ARTS	1	1.00
111 32401 Issuance	1	35.00
111 32412 SERVICE 600V200MAX	1	30.00
111 32412 Time Clock	1	4.50
111 32412 SIGN BRANCH CIRCUITS	4	22.00
TOTAL		94.50

INSPECTION RECORD

APPROVAL _____ DATE _____ INSPECTOR _____

Underground _____

Conduit _____

Wiring - Rough _____

Heater _____

Fixtures & Trim _____

Motors _____

Ufer _____

Service _____

AUTHORIZATION

Issued By: diane b Date _____

DECLARATION

I certify that I have read this application/permit and state that the information on all pages of this document is correct. I agree to comply with all City and County ordinances and State laws relating to building construction, and hereby authorize representatives of this City and County to enter upon the above mentioned property for inspection purposes.

Applicant's Signature Robert G. Hansen

Print Name ROBERT G. HANSEN Date 9-16-98

FINAL 9-17-98 DM

Utility Notified 9-17-98 DM
100A FWY SIGN

***** VALIDATION *****

PAID ON 16 Sep 1998 AT 11:39

RECEIVED BY DOXIE 198.245.206.215/2 TRANS# 70

AMOUNT PAID \$189.00 BY CHECK#032410

TOTAL PAID = \$189.00



PERMIT

(PAGE 1 OF 2)

Permit No.: 44467
Job Address: 13531 1/2 Harbor Blvd.

Type of Permit: [] Bldg. [X] Elec.
[] Mech. [] Plumb. [] Grading [] Street
[X] Sign [] Pool/Spa [] Fire Supp. Syst.

Owner Donald Jensen
Address 12463 Shore Dr.
Leavenworth WA 98826 Phone 509/548-2258

Contractor Outdoor Systems
Address 1731 Workman St.
Los Angeles CA 90031 Phone 323/222-7171
Lic. Class C-61/D-34/ Lic. No. 732968
C-10/B

Architect/Engineer C. Dennis Lee, Ph.D.
Address 9440 Telstar #5
El Monte CA 91731 Phone 626/448-7870
Type of Lic. _____ Lic. No. SE2543

Applicant Outdoor Systems
Address same as above
_____ Phone _____

DECLARATIONS

CONTRACTOR DECLARATION

[X] I hereby affirm under penalty of perjury that I am licensed under provisions of Chapter 9 (commencing with Section 7000) of Division 3 of the Business and Professions Code, and my license is in full force and effect.

OWNER-BUILDER DECLARATION

Sec. 7031.5, Business and Professions Code (B&PC) states: "Any city or county which requires a permit to construct, alter, improve, demolish, or repair any structure, prior to its issuance, also requires the applicant for such permit to file a signed statement that he or she is licensed pursuant to the provisions of the Contractors License Law (Chapter 9; commencing with Section 7000; of Division 3 of the B&PC) or that he or she is exempt therefrom and the basis for the alleged exemption. Any violation of Section 7031.5 by any applicant for a permit subjects the applicant to a civil penalty of not more than \$500." I hereby affirm under penalty of perjury that I am exempt from the Contractors License Law for the following reason.

[] I, as owner of the property, or my employees with wages as their sole compensation, will do the work, and the structure is not intended or offered for sale. Sec. 7044, B&PC states: "The Contractor License Law does not apply to an owner of property who builds or improves thereon, and who does such work himself or herself or through his or her own employees, provided that such improvements are not intended or offered for sale. If, however, the building or improvement is sold within one year of completion, the owner-builder will have the burden of proving that he or she did not build or improve for the purpose of sale."

[] I, as owner of the property, am exclusively contracting with licensed contractors to construct the project. Sec. 7044, B&PC states: "The Contractors License Law does not apply to an owner of property who builds or improves thereon, and who contracts for such project with a contractor(s) licensed pursuant to the Contractor License Law."

[] I am exempt under Sec. _____, B&PC for the following reason:

WORKERS' COMPENSATION DECLARATION

I hereby affirm under penalty of perjury one of the following declarations:

[] I have and will maintain workers' compensation insurance, as required by Section 3700 of the Labor Code, for the performance of the work for which this permit is issued. My workers' compensation insurance carrier and policy number are:

Carrier Indemnity Ins.Co.of N. America
Policy Number C42294536

[] I certify that in the performance of the work for which this permit is issued, I shall not employ any person in any manner so as to become subject to the workers' compensation laws of California, and agree that if I should become subject to the workers' compensation provisions of Sec. 3700 of the Labor Code, I shall forthwith comply with those provisions.

[] I have and will maintain a certificate of consent to self insure for workers' compensation, as provided for by Section 3700 of the Labor Code, for the performance of the work for which this permit is issued.

WARNING: FAILURE TO SECURE WORKERS' COMPENSATION COVERAGE IS UNLAWFUL, AND SHALL SUBJECT AN EMPLOYER TO CRIMINAL PENALTIES AND CIVIL FINES UP TO ONE HUNDRED THOUSAND DOLLARS (\$100,000), IN ADDITION TO THE COST OF COMPENSATION, DAMAGES AS PROVIDED FOR IN SECTION 3706 OF THE LABOR CODE, INTEREST, AND ATTORNEY'S FEES.

CONSTRUCTION LENDING AGENCY

[] I hereby affirm under penalty of perjury that there is a construction lending agency for the performance of the work for which this permit is issued (Sec. 3097 Civil Code).

Lender N/A
Address _____

HAZMAT/AQMD DECLARATION

Will the applicant or future building occupant handle a hazardous material or a mixture containing a hazardous material equal or greater than the amounts specified in the hazardous materials information guide?

[X] NO [] YES

Refer to the AQMD permitting checklist and/or guidelines. Will the intended use of the building by the applicant or future building occupant require a permit for construction or modification from the South Coast Air Quality Management District (SCAQMD)?

[X] NO [] YES

I have read the hazardous material information guide and the SCAQMD permitting checklist. I understand my requirements under State of California Health and Safety Code, Section 2505, 2533, and 2534 concerning hazardous material reporting.

[X] YES [] NO

DEMOLITION/ASBESTOS DECLARATION

As applicant for a demolition permit, I certify that I have read Section 19827.5 of the Health and Safety Code and declare as follows:

[] I declare that written asbestos notification is not applicable to the scheduled project.

[] On the attached sheet(s) are copies of all written asbestos notifications regarding the above referenced building that are required to be submitted to the United States Environmental Protection Agency or to a designated State agency, or both, pursuant to Part 61 of Title 40 of the Code of Federal Regulation or successor to that part.

DECLARATION

I certify that I have read this application/permit and state that the information on all pages of this document is correct. Under penalty of perjury, I hereby affirm all of the checked/marked declarations on this document. I agree to comply with all City and County ordinances and State laws relating to building construction, and hereby authorize representatives of this City and County to enter upon the above mentioned property for inspection purposes. I acknowledge that if work is not started within 180 days from the date of issue or if abandoned for more than 180 days, this permit will be null and void. I acknowledge that a fee may be charged for reinspection due to negligence, incomplete work, or a failure to make corrections.

Signature [Signature]
Print Name ALY BLANUW Date 9/16/98



General Information: 714-741-5307

CITY OF GARDEN GROVE - DEVELOPMENT SERVICES DEPARTMENT

Inspection Requests: 714-741-5332

PERMIT (PAGE 2 of 2)

PROJECT/SITE/BUILDING DESCRIPTION

JOB Address : 13551 HARBOR BLVD
 Suite :
 PERMIT NO. : 87793
 Permit Type : BUILDING
 Type : B33
 REPAIRS
 Owner : DONALD WARREN JENSEN
 Applicant : VANESSA CASTILLO
 Phone : 909-985-4555

Contractor : LISTER ROOFING
 Address : 1637 PACIFIC COAST HIGHWAY
 CityStZip : WILMINGTON, CA 90744
 Phone :

Insp Dist : R15
 Date : 10/30/06
 Parcel No : 10012211

Value : 4800
 Floor area : 0

PROPOSED WORK:

O22 - REROOF
 T/O SHAKES, APPLY 1/2"CDX, (1) LAYER 30# ASTM
 FELT & 30YR COMP SHINGLES.

FEES

111 32410 Permit	1	134.39
111 32401 issuance	1	35.00
942 22130 General Plan	1	6.97
080 32550 Cultural Arts	1	3.43
TOTAL		179.79

APPROVAL	DATE	INSPECTOR
Pre Inspect	11/6/06	[Signature]
Foundation		
Concrete Floor		
Reinforcing		
Masonry		
Roof Shtg		
Rough Frame		
Insul / Energy		
Drywall		
Lath		
Plas.Brown Ct.		
Landscaping		
Pre Gunite		
Pre Deck		
Pre Plaster		
Planning Final		
Bldg Final	11/8/06	[Signature]
Utility Notified		

AUTHORIZATION

Issued By: jimc _____ Date _____

DECLARATION

I certify that I have read this application/permit and state that the information on all pages of this document is correct. I agree to comply with all City and County ordinances and State laws relating to building construction, and hereby authorize representatives of this City and County to enter upon the above mentioned property for inspection purposes.

Applicant's Signature [Signature]
 Print Name Vanessa Castillo Date 10-30-06

***** VALIDATION *****
 PAID ON 30 Oct 2006 AT 09:26
 RECEIVED BY KATRENAS 198.245.206.215/2 TRANS# 31
 AMOUNT PAID \$179.79 BY CHECK#2436
 TOTAL PAID = \$179.79

ELECTRIC PERMIT

Department of Building
Permits

CITY OF
GARDEN GROVE
JE 7-4200

Applicant Fill in (use ink)

Electric Permit No.

Job Address

13551 S. Harbor

2384

LOT NO.

TRACT NO.

	NUMBER	EA.	FEE
New Residence Sq. Ft.		.01	
Residence Garage Sq. Ft.		.005	
Services	1	1.00	1.00
Motors	1	1.00	1.00
Fixtures 1st 20		.20	
Fixtures, Additional		.10	
Fixtures, Mercury Vapor		1.00	
Outlets, 1st 20		.20	
Outlets, Additional		.10	
Any Pole		2.00	
Dryer		1.00	
Dishwasher		1.00	
Furnace		1.00	
Garbage Disposal		1.00	
Fan		1.00	
Heater (or. 1650 W)		.50	
Domestic Range		1.00	
Domestic Oven		1.00	
Motors—Not Over 1 H.P.		1.00	
Motors Over 1 Not Over 3 H.P.		1.50	
Motors Over 3 Not Over 8		2.00	
Motors Over 8 Not Over 15		2.50	
If Not Listed Above, See Code			
Permit Fee			2.00
Total Fee			4.00

Owner *Chas. Devore*

Owner's Address *13551 S. Harbor*

New Bldg. Old Bldg. Use—*Res.*

Electrical Contr. *Spone Electric*

Address *13141 Century Blvd.*

Phone *582-3550* State License No. *206590*

Validation DEC 19-63 11 002 1/4 *****4.00

I hereby acknowledge that I have read this application and state that the above is correct and agree to comply with all ordinances and State laws regulating electrical wiring.

I hereby certify that I am properly registered with and/or licensed as required by the City of Garden Grove and/or State of California, or that I am the legal owner of the above described property, and I certify that in the performance of the work for which this permit is issued I shall not employ any person in violation of the workmen's compensation laws of the State of California.

Signature of Permittee *M. L. Brown* Date *12/18/63*

SIGNS

One Sign—1 Transformer	2.00
Additional Sign, Same Location	1.00
Additional Transf. or flashers, Time Clock	1.00
Lamp Holding Devices, 1st 20	.05
Lamp Holding Devices, Next 100	.03
Sign and 1 Transformer, Moved	
Altering or Changing Lettering	
For Connecting (Hook-up)	
Permit Fee	2.00
Total Fee	

	Date	Inspector
Conduit		
Wiring		
Fixtures		
U. G.		
Sign Footing		
Final		
Utility Notified	<i>12-22-63</i>	<i>Chas. Devore</i>
Service Size Amp. <i>20</i>	<i>12-28-63</i>	<i>Chas. Devore</i>
Wire		<i>1/2" Conduit</i>

Authorized By *Chas. Devore* Date *12-18-63*

Building Permit No.

BUILDING PERMIT

Department of Building
B. C. Adams
Director

CITY OF
GARDEN GROVE

ZONING AND BUILDING

Map No.	APO	Var. No.
Use Zone <i>C-1</i>	Main Use	Acc. Use <input checked="" type="checkbox"/>
St. Set Back -	PL <i>EXISTING</i> PL	
Side Yard Pt	<i>29'</i>	Projection
Side Yard Lt	<i>31</i>	Projection
Rear Yard	<i>185</i>	No Parking Sp. Req'd.
Zoning Approved By	<i>WPA</i>	Date <i>5/28/58</i>
Group <input checked="" type="checkbox"/>	Type <i>I</i>	Plan Ck. <i>WPA</i>
Remarks:		

INSPECTION RECORD

APPROVAL	DATE	INSPECTOR
Foundation and Location	<i>5-29-58</i>	<i>WPA</i>
Reinforcing		
Roof Shng.	<i>6-23-58</i>	<i>WPA</i>
Rough Frame	<i>6-23-58</i>	<i>WPA</i>
Lath or Drywall		
Plas. Brown Ct.		
Final	<i>7-10-58</i>	<i>WPA</i>
Utility Release		

Remarks:

FEES

Building Permit	\$ <i>3</i>	Rec'd By
Plan Check	\$ <i>4</i>	Rec'd By

Remarks:

Permit Authorized By *WPA* Date *5/28/58*

Routing: 81 Bldg. Inspector 82 Office File 83 Statistics 84 Owner

For Applicant to Fill In (Also Ind)

Job Address <i>13551 S. Harbor</i>	Permit No. <i>2902</i>	
Lot No.	Tract No.	Blk. No.
Please Attach Maps & Bounds (2 Copies)		
Owner <i>Charles W. Deane</i>		
Owner's Address <i>13551 S. Harbor</i>		
Description of Work New <input type="checkbox"/> Add'n <input checked="" type="checkbox"/> Remodel <input type="checkbox"/> Relocate <input type="checkbox"/>		
Use of Building <i>equipment shelter</i>		
Area of Building <i>30' x 32'</i>	Valuation \$ <i>1920⁰⁰</i>	
Arch. or Engr.	Address	
Contractor <i>Charles W. Deane</i>	Address	

I hereby acknowledge that I have read this application and state that the above is correct and agree to comply with all ordinances and State laws regulating building construction.

I hereby certify that I am properly registered with and/or licensed as required by the City of Garden Grove and/or State of California, or that I am the legal owner of the above described property, and I certify that in the performance of the work for which this permit is issued I shall not employ any person in violation of the workmen's compensation laws of the State of California.

Signature of Permittee *Charles W. Deane* Date *May 15/58*

Address *13551 S. Harbor* Lic. No.

PUBLIC WORKS

Street Imp. By Date

RELOCATION

PRESENT BLDG. ADDRESS

MOVING CONTRACTOR ADDRESS

INSPECTION FEE RECEIPT NUMBER

SURETY DATE REC'D BY

CASH DEP. DATE REC'D BY

RELOCATION AUTHORIZED BY DATE

MAY 28 1958
MAY 28 1958
MAY 28 1958
MAY 28 1958

PLOT PLAN

Department of Building
B. C. Adams
Director

CITY OF
GARDEN GROVE

Job Address 13551 Harbor

Permit Number
2902

DIMENSION PLOT PLAN COMPLETELY SHOWING
ALL BLDGS. ON THE LOT AND THEIR USE

Lot Tract Blk.

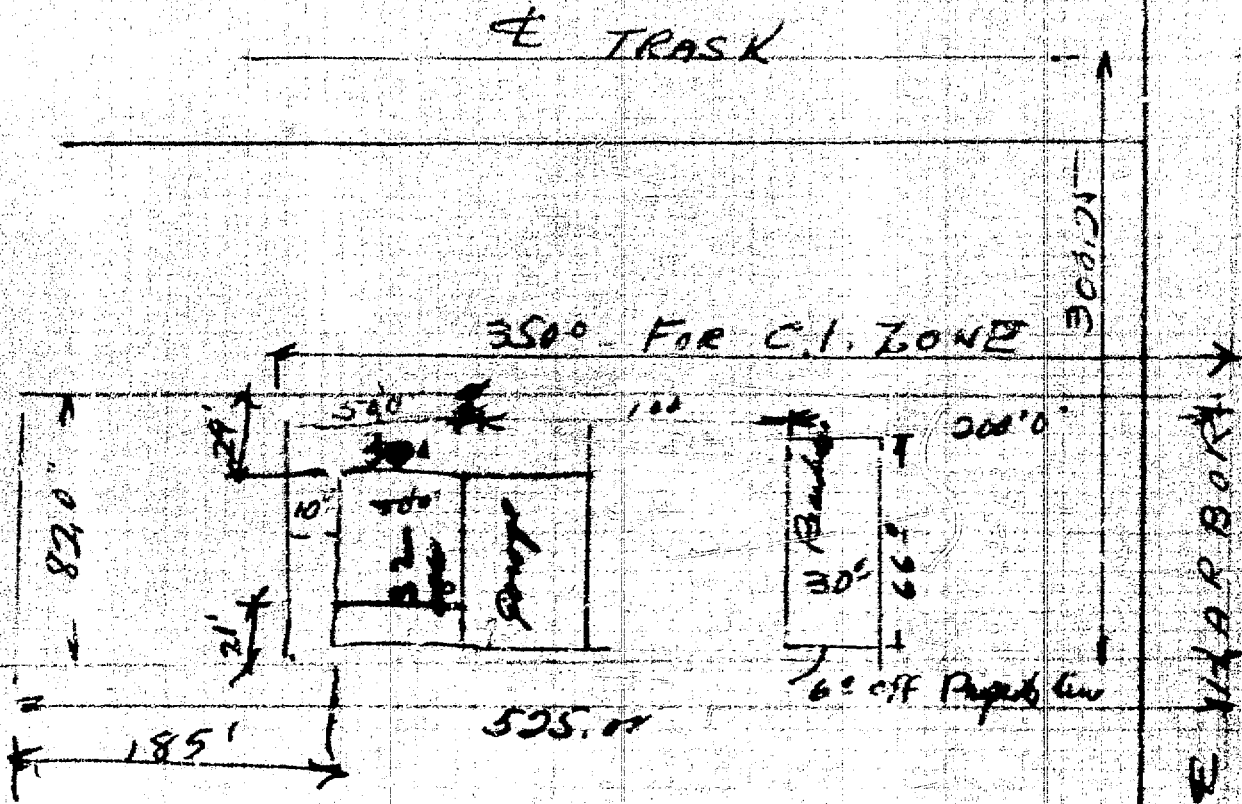

5/28/58

HOUSE AREA 2360 ^{sq}
GARAGE 1440 ^{sq}
TOTAL 3800

1/4 ^{sq} OF 3800 = 960 ^{sq}

OK to add 960 ^{sq} NECESSARY
BLDG WITHOUT STREET DEED.

13551 So Harbor
Blvd.
Garden Grove

I certify the information furnished hereon is complete and correct. By Chas. W. O'Connell 5/28/58

Routing: #1 Building Inspector

#2 Office File

#3 Owner

PLUMBING PERMIT

1

Department of Building
 Harry E. Pollock
 Chief

CITY OF
 GARDEN GROVE

For Applicant to Fill In (No Ink)

Job Address 13551 Harbor Blvd 000030

PERMIT FEES

NO.	TYPE OF SERVICE OR ITEM	AMOUNT	\$	FEES
	Water Closet (Toilet)	\$1.00		
	Bath Tub	1.00		
	Shower	1.00		
	Lavatory (Wash Basin)	1.00		
	Kitchen Sink	1.00		
	Garbage Disposal	1.00		
	Laundry Tub or Tray	1.00		
	Water Heater	1.50		
	5' up Sht.	1.00		
	Floor Sink	1.00		
	Floor Drain	1.00		
	Dish Washer	1.00		
	Drinking Fountain	1.00		
	Urinal	1.00		
	Gas System - Outlets	1.00		
	House Sewer	1.00		
	Lawn Sprinklers	2.00		
	Swimming Pool Piping	1.00		
	Sand Traps	1.00		
	Automatic Washing Mach.	1.00		
	Water Softeners	1.50		
	Backwash - Trap	1.50		
1	Water Lateral	1.00		1.00

Lot No. _____ Tract No. _____ Blk. No. _____

Owner Devore

Owner's Address 13551 Harbor Blvd

Plumbing Contractor C & H Pkg

Contractor's Address 12826 N. Woodward

Phone 530-0611 City Lic. No. 2329

Use of Bldg. Residence

New Bldg. Old Bldg.

Validation Jul 30 64 11 064 M*****3.00

I hereby acknowledge that I have read this application and state that the above is correct and agree to comply with all ordinances and State laws regulating plumbing.

I hereby certify that I am properly registered with and/or licensed as required by the City of Garden Grove and/or State of California, or that I am the legal owner of the above described property, and I certify that in the performance of the work to which this permit is issued I shall not violate any portion in violation of the workman's compensation laws of the State of California.

Signature of Permittee John Devore 7-30-64

Address _____

APPROVALS	DATE	INSPECTOR
SOIL PIPING		
GROUND PLUMBING		
ROUGH PLUMBING		
GAS PIPING		
GAS VENT		
SEPTIC TANK or Cesspool		
SEWER		
GAS TEST		
MAIN DRAIN AND VACUUM LINES		
WATER HEATER		
BACKWASH		
WATER LATERAL		
FINAL	<u>7-30-64</u>	<u>Regan</u>
UTILITY CO. NOTIFIED		

Issuance of Permit _____ 2 00

TOTAL FEE \$ 3.00

Permit Authorized By Regan Date 7-30-64

Routing: #1 Plumbing Inspector #2 Office File #3 Owner Bldg. Permit # _____

INSPECTION RECORD

For Applicant to Fill in:

TYPE	OCG LOAD	FIRE SPRINK.
FRONT	LEFT	RIGHT
REAR	SEE Plat Plans	
PLANNING ACTION	PLANS	DATE
LAND USE APPROVED BY	Dave Wilson 3/31/80	
REMARKS	2 pole signs not exceeding 50 # total	
REQ'D	PROVIDED	
ST BOND		
WATER BOND		
WATER ASSMT FEE (ACRG)		
WATER ASSMT FEE (FT)		
PARKWAY TREE FEE		
PARK & REC FEE (DIST)		
DRAIN ASSMT FEE (DIST)		
PLAN RETENTION FEE		
BLDG. PLAN CHECK	520	6.50
BLDG. PERMIT FEE	226	10.00
ISSUANCE	533	6.00
VALUATION	1800.00	
TOTAL FEES	2059	22.50
AUTHORIZED BY	DATE	
	AKS/80	

APPROVAL	DATE	INSPECTOR
FOUNDATION & LOCATION	5/13/80	
CONCRETE FLOOR REINFORCING		
ROOF SHTG		
ROUGH FRAME		
INSULATION, ENERGY		
LATH OR DRYWALL		
PLAS. BROWN CT.		
SOUND INSULATION		
SMOKE DETECTOR		
PARKING		
LANDSCAPING		
LAND USE FINAL		
FINAL	4-1-81	
UTILITY RELEASE		
IDENTIFICATION CODE		

WORKER'S COMPENSATION REQUIREMENTS

State Compensation Insurance Policy No. _____ Expiration Date _____

I certify that in the performance of the work for which this permit is issued, I shall not employ any person in any manner so as to become subject to the Worker's Compensation laws of California.

NOTE: If, after making such certificate, the applicant for the permit should become subject to the Worker's Compensation provisions of this code, he shall forthwith comply with the provisions of Section 3700 or his permit shall be deemed revoked.

I certify that I have read this application and state that the above information is correct. I agree to comply with all City ordinances and State laws relating to pending construction. I further agree to hold the City of Garden Grove free and harmless from any liability arising out of injury or bodily damage resulting from work performed relevant to this permit.

PERMIT APPLICANT SIGNATURE _____ DATE _____

BUSINESS TAX CERTIFICATE INFORMATION

I certify that the following Contractor's License No. _____ and Classification _____ is in full force and effect.

(PRINT) CONTRACTOR _____ (SIGNATURE) CONTRACTOR OR AUTHORIZED AGENT _____ DATE _____

BUSINESS TAX CERTIFICATE NO. _____ EXPIRATION DATE _____

I certify that I am exempt from Section 7031.5 of the Business and Professional Code, Division 3, Chapter 9, Contractors' License Law, under the following Section:

Owner: Section 7044 Minor work under \$100: Section 7048

Employee working for wages only: Section 7053

Other: _____

(PRINT) PROPERTY OWNER (SIGNATURE) PROPERTY OWNER OR AUTHORIZED AGENT _____ DATE _____

ADDRESS	13551 HARBOR BLVD.		
LOT NO.	BLK NO.	TRACT NO.	PERMIT NO.
			114887A
OWNER	DONALD A BRACCI 537-8443		
MAILING ADDRESS	SAME GARDEN GROVE 92647		
TEL. NO.	STATE LIC NO & TYPE		
VALIDATION	04/28/80	#0012	
	BIDDER	10.00	
	PLANNING	6.50	
	ISSUANCE	6.00	
	CHECK	22.50	
CONTRACTOR	OWNER		
MAILING ADDRESS	CITY ZIP		
TEL. NO.	STATE LIC NO.		
PRESENT BLDG. USE	COMM		
PROPOSED BLDG. USE			
DESCRIBE WORK TO BE DONE	2 POLE SIGNS		
NEW <input type="checkbox"/> ADD'N <input type="checkbox"/> ALTER <input type="checkbox"/> REPAIR <input type="checkbox"/> DEMOLISH <input type="checkbox"/>			
FLOOR AREA (SQ. FT.)	NO. OF STORIES	NO. OF DWELLING UNITS	
504			
If work is not started within 120 days from date of issue or if abandoned for more than 120 days, this permit will be null and void.			
A FEE MAY BE CHARGED FOR REINSPECTION DUE TO NEGLIGENCE, INCOMPLETE WORK OR FAILURE TO MAKE CORRECTIONS.			
RELOCATION			
PRESENT BLDG. ADDRESS			
MOVING CONTRACTOR			
ADDRESS			

ELECTRICAL PERMIT

INSPECTION RECORD

FEEES

For Applicant to Fill in

THREE PHASE SERVICE SIZE	WIRE	RIG. CONDUIT	IF NOT LISTED BELOW SEE CODE	NO.	EA.	FEE
AMPS	VOLTS	RIG. CONDUIT	Residential (R 1 & R-3) sq. ft.			
THREE PHASE SERVICE SIZE	WIRE	RIG. CONDUIT	Garage, Resid. (M) sq. ft.			
AMPS	VOLTS	RIG. CONDUIT	Service Meter, Single Phase			
APPROVAL	DATE	INSPECTOR	Service Meter, Three Phase			
Underground			Add'l Meter, Three Phase			
Conduit			Temporary Power Pole			
Wire			Pole, Power, Light, etc.			
Heater			Sub-Panels 1 @			
Fixtures & Trim			Sub-Panels 3 @			
Motors			Outlets			
			Fixtures			
			Fixtures, Merc. Quartz, etc.			
			Heater—Not Over 1650 W			
			Washer			
			Dryer			
			Hot Water Heaters			
			Dishwasher			
			Domestic Range or Oven			
			Disposal			
			Power Apparatus—H.P., K.W. or K.V.A. Motors, Transformers, etc.			
			Not Over 1 each			
			Over 1, Not Over 10 each			
			Over 10, Not Over 30 each			
			Ind. Circuits			
			Time Clock			
			Sign			
			Sign Hookup			7.50
Other						
Service						
FINAL	Exp. Date	4-1-81				
Utility Not Fed						
IDENTIFICATION CODE			ITEM	CODE		FEEES
			Sign Retention Fee			
			Plan Check			
			Permit	337		7.50
			Issuance	335		6.00
			TOTAL FEES			13.50
BUILDING PERMIT NO.	PERMIT NO.		LAND USE	AUTHORIZED BY	DATE	
114987A				[Signature]	4/5/81	

ADDRESS
13551 Harbor Blvd

LOT NO. BLK NO. TRACT NO. ELECTRIC PERMIT NO.
114987A

OWNER
Donald A. Branci PHONE **537-8443**

OWNER'S ADDRESS
Same CITY

NEW BUILDING OR EXISTING BUILDING
ADD'L AREA REMODEL AREA

USE OF BUILDING AND OR NUMBER OF UNITS
Comm

VALIDATION
04/28/81 #0013
ELTPEP 7.50
ISSUE 6.00
CHECK #0013.50

ELECTRICAL CONTRACTOR
Owner STATE LIC. NO. & TYPE #0013.50

ADDRESS CITY PHONE

WORKER'S COMPENSATION REQUIREMENTS

State Compensation Insurance Policy No. _____ Expiration Date _____

I certify that in the performance of the work for which this permit is issued, I shall not employ any person in any manner so as to become subject to the Worker's Compensation laws of California.

NOTE: If, after making such certificate, the applicant for the permit should become subject to the Worker's Compensation provisions of this code, he shall forthwith comply with the provisions of Section 3700 or his permit shall be deemed revoked.

I certify that I have read this application and state that the above information is correct. I agree to comply with all City ordinances and State laws relating to pending construction. I further agree to hold the City of Garden Grove free and harmless from any liability arising out of injury or bodily damage resulting from work performed relevant to this permit.

PERMIT APPLICANT SIGNATURE _____ DATE _____

BUSINESS TAX CERTIFICATE INFORMATION

I certify that the following Contractor's License No. _____ and Classification _____ is in full force and effect.

(PRINT) CONTRACTOR (SIGNATURE) CONTRACTOR OR AUTHORIZED AGENT DATE

BUSINESS TAX CERTIFICATE NO. _____ EXPIRATION DATE _____

I certify that I am exempt from Section 7031 B of the Business and Professional Code, Division 3, Chapter 9 Contractors' License Law, under the following Section:

Owner Section 7044 Minor work under \$100 Section 7048
Employee working for wages only Section 7053

Other **C. Branci**

(PRINT) EXEMPT OWNER (SIGNATURE) EXEMPT OWNER OR AUTHORIZED AGENT DATE

A FEE MAY BE CHARGED FOR REINSPECTION DUE TO NEGLIGENCE, INCOMPLETE WORK, OR FAILURE TO MAKE CORRECTIONS.

OWNER I. BRANDELLI, D. BRACCI, R. BRACCI	JOB ADDRESS 13551 HARBOR BLVD	PERMIT NO. 114987A
NAME OF CONSTRUCTION LENDER & BRANCH	ASSESSORS PARCEL NO. LOT BLOCK TRACT 100-122-12-23-15	
	PLEASE CHECK ONE OR MORE <input type="checkbox"/> New <input checked="" type="checkbox"/> Addition <input type="checkbox"/> Alteration <input type="checkbox"/> Repair <input type="checkbox"/> Move <input type="checkbox"/> Demolish	
ADDRESS 13551 HARBOR BLVD	CITY GARDEN GROVE	DATE 4.28.80
	JOB DESCRIPTION 2 pole signs	PERMIT VALUE \$1800 ⁰⁰

SHOW NORTH ARROW, PROPERTY LINES AND ADJACENT STREETS.

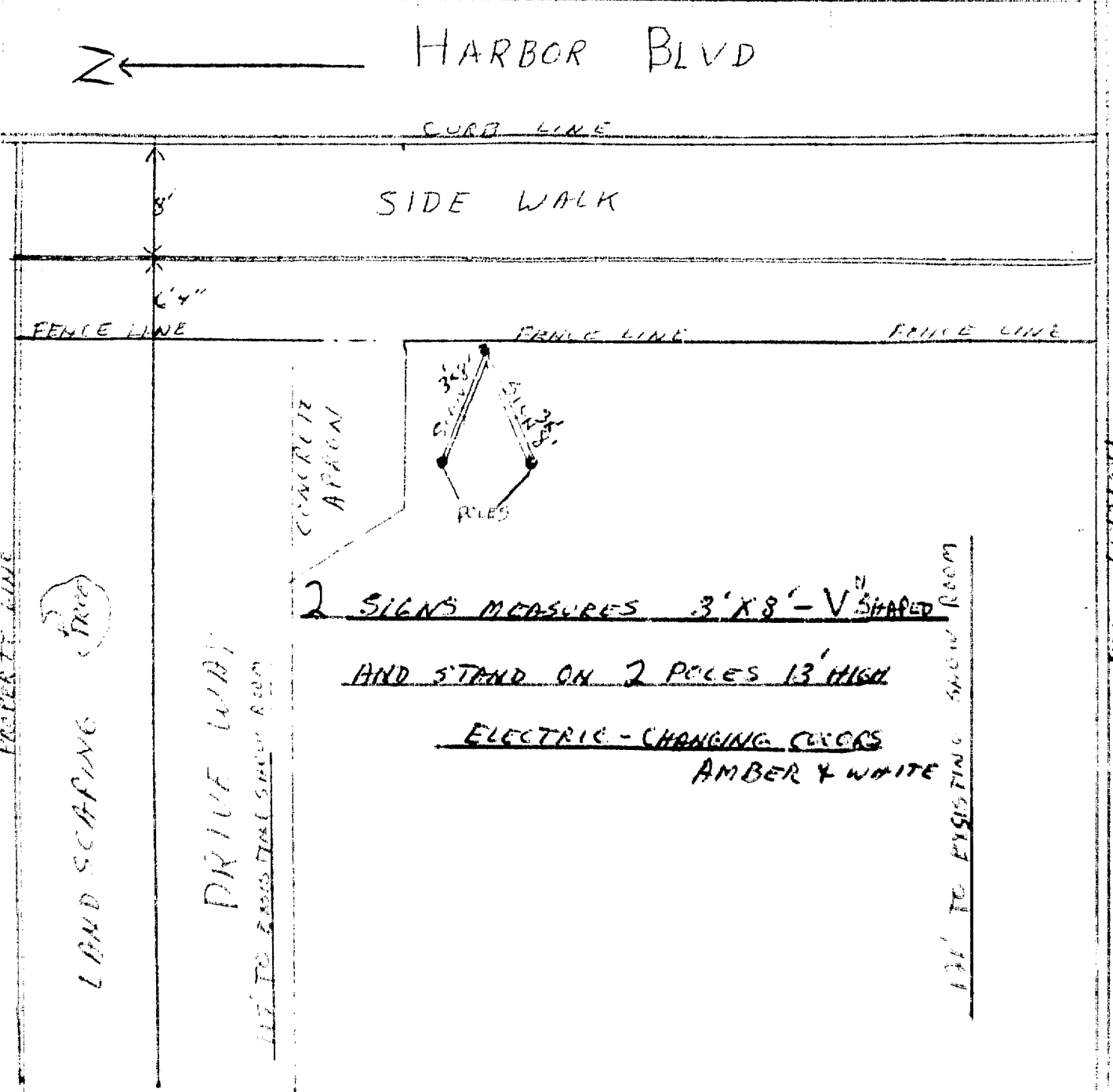

#1 Building Insp./#2 Assessor/#3 Permittee/ed Etc I certify the information herein is complete and correct

By

CITY OF GARDEN GROVE
Development Services Department

ELECTRICAL PERMIT

Inspection Requests
741-5332

General Information
741-5307

INSPECTION RECORD

FEES

For Applicant to Fill in

SINGLE PHASE SERVICE SIZE <input type="checkbox"/> UG <input type="checkbox"/> OH		
AMPS	VOLTS	RIG. CONDUIT
THREE PHASE SERVICE SIZE <input type="checkbox"/> 3 Wire <input type="checkbox"/> 4 Wire <input type="checkbox"/> UG <input type="checkbox"/> OH		
AMPS	VOLTS	RIG. CONDUIT
APPROVAL	DATE	INSPECTOR
Underground		
Conduit		
Wiring - Rough		
Heater		
Fixtures & Trim		
Motors		
Final	5-4-89	H/K

IF NOT LISTED BELOW SEE CODE	NO.	EA.	FEE
Residential (R-1 & R-3) sq. ft.			
Garage, Resid. (M) sq. ft.			
Service Meter, Single Phase			
Service Meter, Three Phase			
Add'l Meter, Three Phase			
Temporary Power Pole			
Pole, Power, Light, etc.	2		6
Sub-Panels 1 ☉			
Sub-Panels 3 ☉			
Outlets	30		15
Fixtures			
Fixtures, Merc. Quartz, etc.			
Heater - Not Over 1650 V			
Washer			
Dryer			
Hot Water Heaters			
Dishwasher			
Domestic Range or Oven			
Disposal			
Power Apparatus - H.P., K.V.I. or K.V.A. Motors, Transformers, etc.			
Not Over 1 each			
Over 1, Not Over 10 each			
Over 10, Not Over 30 each			
Indv. Circuits			
Time Clock			
Sign			
Sign Hookup			

ADDRESS			
13551 Harbor Bl			
LOT NO.		BLK NO. TRACT NO.	
		ELECTRICAL PERMIT NO.	
		162514A	
OWNER			
Villa d'esta			
OWNER'S ADDRESS			CITY
NEW BUILDING OR ADDITION - AREA	EXISTING BUILDING REMODEL AREA	OCCUPANCY GROUP	USE OF BUILDING AND OR NUMBER OF UNITS
SQ. FT.	SQ. FT.		

VALIDATION		
4/89 ✓		
ELECTRICAL CONTRACTOR	STATE LIC. NO. & TYPE	
JBELECTRIC	301958 C10	
ADDRESS	CITY	PHONE
114 School St Covina		332-1862

WORKER'S COMPENSATION REQUIREMENTS

State Compensation Insurance Policy No. 84WC2157562 Expiration Date 10/89

I certify that in the performance of the work for which this permit is issued, I shall not employ any person in any manner so as to become subject to the Worker's Compensation laws of California.

NOTE: If, after making such certificate, the applicant for the permit should become subject to the Worker's Compensation provisions of this code, he shall forthwith comply with the provisions of Section 3700 or his permit shall be deemed revoked.

I certify that I have read this application and state that the above information is correct. I agree to comply with all City ordinances and State laws relating to pending construction. I further agree to hold the City of Garden Grove free and harmless from any liability arising out of injury or bodily damage resulting from work performed pursuant to this permit.

Paula Siskin 2/28/89
PERMIT APPLICANT SIGNATURE DATE

BUSINESS TAX CERTIFICATE INFORMATION

I certify that the following Contractor's License No. 301958 and Classification C10 is in full force and effect.

JBELECTRIC
 Paula Siskin 5/1/89
(PRINT) CONTRACTOR (SIGNATURE) CONTRACTOR OR AUTHORIZED AGENT DATE

BUSINESS TAX CERTIFICATE NO. EXPIRATION DATE

I certify that I am exempt from Section 7031.5 of the Business and Professional Code, Division 3, Chapter 9, Contractors' License Law, under the following Section:

Owner: Section 7044 Minor work under \$200. Section 7048

Employee working for wages only. Section 7053

Other:

(PRINT) PROPERTY OWNER (SIGNATURE) PROPERTY OWNER OR AUTHORIZED AGENT DATE

ITEM	CODE	FEES
Plan Retention Fee		
Plan Check		
Permit Issuance		31
TOTAL FEES		
		31

BUILDING PERMIT NO.	ELECTRICAL PERMIT NO.	VENT. HEAT & AIR COND. PERMIT NO.
LAND USE	AUTHORIZED BY	
	BUILDING	
	DATE	
	5/21/89	

A FEE MAY BE CHARGED FOR REINSPECTION DUE TO NEGLIGENCE, INCOMPLETE WORK, OR FAILURE TO MAKE CORRECTIONS.

If work is not started within 180 days from date of issue or if abandoned for more than 180 days, this permit will be null and void.

INSPECTOR

ELECTRICAL PERMIT

INSPECTION RECORD

FEES

For Applicant to Fill in

SINGLE PHASE SERVICE SIZE <input type="checkbox"/> UG <input type="checkbox"/> OH			IF NOT LISTED BELOW SEE CODE	NO.	EA.	FEE
AMPS	VOLTS	RIG. CONDUIT	Residential (R-1 & R-3) sq. ft.			
THREE PHASE SERVICE SIZE <input type="checkbox"/> 3 Wire <input type="checkbox"/> 4 Wire <input type="checkbox"/> UG <input type="checkbox"/> OH			Garage, Resid. (M) sq. ft.			
AMPS	VOLTS	RIG. CONDUIT	Service Meter, Single Phase			
APPROVAL	DATE	INSPECTOR	Service Meter, Three Phase			
Underground			Add'l Meter, Three Phase			
Conduit			Temporary Power Pole			
Wiring - Rough			Pole, Power, Light, etc.			
Heater			Sub-Panels 1 ϕ			
Fixtures & Trim			Sub-Panels 3 ϕ			
Motors			Outlets <i>Switches</i>	12		6.00
			Fixtures			
			Fixtures, Merc. Quartz, etc.			
			Heater—Not Over 1650 W			
			Washer			
			Dryer			
			Hot Water Heaters			
			Dishwasher			
			Domestic Range or Oven			
			Disposal			
			Power Apparatus—H.P., K.W. or K.V.A. Motors, Transformers, etc.			
			Not Over 1 each			
			Over 1, Not Over 10 each			
			Over 10, Not Over 30 each			
			Indv. Circuits			
			Time Clock			
			Sign			
			Sign Hookup			
Other						
Service						
FINAL	5/16/88	<i>JD</i>				
Utility Notified						
IDENTIFICATION CODE						
BUILDING PERMIT NO.	SIGNER PERMIT NO.	VERT. HEAT. AIR COND. PERMIT NO.				
If work is not started within 180 days from date of issue or if abandoned for more than 180 days, this permit will be null and void.						
INSPECTOR						

ADDRESS 13551 Harbor Blvd			
LOT NO.	BLK NO.	TRACT NO.	ELECTRIC PERMIT NO. 157052A
OWNER Villa d'Este			PHONE 537-8443
OWNER'S ADDRESS 13551 Harbor Garden Grove			
NEW BUILDING OR ADDITION - AREA SQ. FT.	EXISTING BUILDING REMODEL AREA SQ. FT.	OCCUPANCY GROUP	USE OF BUILDING AND OR NUMBER OF UNITS
VALIDATION <i>EPer 6.00</i> <i>Washer 10.00</i> <i>#2164A 16.00</i>			
ELECTRICAL CONTRACTOR JBElectric		STATE LIC. NO. & TYPE 301950	
ADDRESS 114 School St Covina		CITY	PHONE 818 332-1862
WORKER'S COMPENSATION REQUIREMENTS			
State Compensation Insurance Policy No. 88WC2151562 Expiration Date 10/1/88			
<input type="checkbox"/> I certify that in the performance of the work for which this permit is issued, I shall not employ any person in any manner so as to become subject to the Worker's Compensation laws of California.			
NOTE: If, after making such certificate, the applicant for the permit should become subject to the Worker's Compensation provisions of this code, he shall forthwith comply with the provisions of Section 3700 or his permit shall be deemed revoked.			
<input type="checkbox"/> I certify that I have read this application and state that the above information is correct. I agree to comply with all City ordinances and State laws relating to pending construction. I further agree to hold the City of Garden Grove free and harmless from any liability arising out of injury or bodily damage resulting from work performed pursuant to this permit.			
Signature <i>George DeLanau</i>			DATE 5/9/88
PERMIT APPLICANT SIGNATURE DATE			
BUSINESS TAX CERTIFICATE INFORMATION			
I certify that the following Contractor's License No. 21938 and Classification C-10 is in full force and effect.			
Signature <i>JBElectric</i>		Signature <i>George DeLanau</i>	
(PRINT) CONTRACTOR		(SIGNATURE) CONTRACTOR OR AUTHORIZED AGENT	
DATE 5/9/88		DATE	
BUSINESS TAX CERTIFICATE NO. _____ EXPIRATION DATE _____			
I certify that I am exempt from Section 7031.5 of the Business and Professional Code, Division 3, Chapter 9 Contractors' License Law under the following Section: Owner: Section 7044 <input type="checkbox"/> Minor work under \$200: Section 7038 <input type="checkbox"/> Employee working for wages only: Section 7053 <input type="checkbox"/>			
Other: _____			
(PRINT) PROPERTY OWNER		(SIGNATURE) PROPERTY OWNER OR AUTHORIZED AGENT	DATE
A FEE MAY BE CHARGED FOR RE-INSPECTION DUE TO NEGLIGENCE, INCOMPLETE WORK, OR FAILURE TO MAKE CORRECTIONS.			