



**CITY OF GARDEN GROVE**  
**FIRE DEPARTMENT**

---

**Tel: (714) 741-5600**  
**Fax: (714) 741-5640**

3/9/2017

Richard McCondichie  
Salem Engineering Group  
(909)

RE: Records Search for 10801 Garden Grove Blvd., Garden Grove CA

Enclosed are the records found concerning the history of the above-mentioned site(s), especially as it pertains to fire code violation history, permits, the use, storage, or disposal of hazardous substances, and the installation or removal of underground flammable or combustible liquid storage tanks.

The City of Garden Grove Fire Department has utilized its best efforts to locate the records requested. However, the City makes no representation as to the accuracy of the records or that all records requested were retained or located. The City does not provide records on spills, leaks or clean-up, as that information is provided through the County of Orange Health Dept.

Sincerely,

A handwritten signature in black ink that reads 'Brad Spell'. The signature is written in a cursive, flowing style.

Brad Spell  
Fire Captain/Senior Fire Protection Specialist

2012 HAZARDOUS MATERIALS BUSINESS  
PLAN UPDATE

**The Home Depot USA, Inc.**  
2455 Paces Ferry Road, C-19  
Atlanta, Georgia 30339

THE HOME DEPOT STORE # 6639

*(Facility ID)*

10801 Garden Grove Blvd

*(Facility Address)*

file 69

Garden Grove

*(Facility City)*

Orange

*(Facility County)*

POST THIS DOCUMENT ON-SITE SO IT WILL BE AVAILABLE IN THE EVENT OF GOVERNMENT  
AGENCY INSPECTION, SITE ASSESSMENT OR AUDIT.



1525 Faraday Avenue, Suite 290 ♦ Carlsbad, CA 92008 ♦ (760)602-3839 Fax (760)602-3838



Infrastructure · Water · Environment · Buildings

ARCADIS U.S., Inc.  
1525 Faraday Avenue  
Suite 290  
Carlsbad  
California 92008  
Tel 760 602 3800  
Fax 760 602 3838  
www.arcadis-us.com

City of Garden Grove Fire Department  
Hazardous Materials Division  
11301 Acacia Parkway  
Garden Grove, California 92842  
(714) 741-5636

Subject:  
The Home Depot USA, Inc.  
Hazardous Materials Business Plan Updates

To Whom It May Concern:

Date:  
February 28, 2012

The Home Depot USA, Inc. (Home Depot) authorizes ARCADIS U.S., Inc. (ARCADIS) to certify and submit Hazardous Materials Business Plan (HMBP) updates on their behalf for the 2012 reporting year. The plan has been updated to include the current emergency contacts and current hazardous material inventories. Attached is the required submittal for the 2012 HMBP update for the following Home Depot location:

Contact:  
Lesley Schafer

Phone:  
760.602.3839

Email:  
TierIIAdministrator@arcadis-us.com

- Store #6639 – 10801 Garden Grove Boulevard

Our ref:  
HT114841.0011.00004

The HMBP updates are being submitted in accordance with California Health and Safety Code (HSC) Chapter 6.95, Article 1, Sections 25500 – 25520. Please direct regulatory correspondence to the address above. If you have any questions, contact ARCADIS at (860) 533-9915 or TierIIAdministrator@arcadis-us.com

Sincerely,

ARCADIS U.S., Inc.

v-mail 3/5

Lesley Schafer  
Compliance Specialist

Attachments:  
2012 Hazardous Materials Business Plan Update Submittal

Imagine the result



City of Garden Grove  
 11301 Acacia Parkway  
 Garden Grove, CA 92842  
 (714) 741-5636

# CUPA

## BUSINESS ACTIVITIES

**FACILITY INFORMATION**

### I. FACILITY INFORMATION

FACILITY ID#	3 0 0 3 5 000069	1. EPA ID # (Hazardous Waste Only)	
--------------	------------------	------------------------------------	--

3. BUSINESS NAME (Same as FACILITY NAME or DBA-Doing Business As)  
**The Home Depot Store #6639**

### II. ACTIVITIES DECLARATION

NOTE: If you check YES to any part of this list,  
 please submit the Business Owner/Operator Identification page.

Does your facility...

If Yes, please complete these pages of the UPCF...

**A. HAZARDOUS MATERIALS**

Have on site (for any purpose) hazardous materials at or above 55 gallons for liquids, 500 pounds for solids, or 200 cubic feet for compressed gases (include liquids in ASTs and USTs); or the applicable Federal threshold quantity for an extremely hazardous substance specified in 40 CFR Part 355, Appendix A or B; or handle radiological materials in quantities for which an emergency plan is required pursuant to 10 CFR Parts 30, 40 or 70?

YES  NO 4.

✓ HAZARDOUS MATERIALS INVENTORY - CHEMICAL DESCRIPTION (Form3)

**B. UNDERGROUND STORAGE TANKS (USTs)**

1. Own or operate underground storage tanks?
2. Intent to upgrade existing or install new USTs?
3. Need to report closing a UST?

YES  NO 5.

✓ UST FACILITY (Formerly SWRCB Form A)  
 ✓ UST TANK (one page per tank)(Formerly Form B)

YES  NO 6.

✓ UST FACILITY  
 ✓ UST TANK (one page per tank)  
 ✓ UST INSTALLATION - CERTIFICATE OF COMPLIANCE (one page per tank)(Formerly Form C)

YES  NO 7.

✓ UST TANK (closure portion-one page per tank)

**C. ABOVE GROUND PETROLEUM STORAGE TANKS (ASTs)**

1. Own or operate ASTs above these thresholds:
  - any tank capacity is greater than 660 gallons, or
  - the total aggregate capacity for the entire facility (ASTs, drums and portable containers) greater than 1,320 gallons?

YES  NO 8.

✓ NO FORM REQUIRED TO CUPAS

**D. HAZARDOUS WASTE**

1. Generate hazardous waste?
2. Recycle more than 100 kg/month of excluded or exempted recyclable materials (per HSC §25143.2)?
3. Treat hazardous waste on site?
4. Treatment subject to financial assurance requirements (for Permit by Rule and Condition Authorization)?
5. Consolidate hazardous waste generated at a remove site?
6. Need to report the closure/removal of a tank that was classified waste and cleaned onsite?

YES  NO 9.

✓ EPA ID #-provide at the top of this page

YES  NO 10.

✓ RECYCLABLE MATERIALS REPORT (one per recycler)

YES  NO 11.

✓ ONSITE HAZARDOUS WASTE TREATMENT - FACILITY (Formerly DTSC Forms 1772)

YES  NO 12.

✓ ONSITE HAZARDOUS WASTE TREATMENT - UNIT (one page per unit) (Formerly DTSC Forms 1772A,B,C,D and L)

YES  NO 13.

✓ CERTIFICATION OF FINANCIAL ASSURANCE (Formerly DTSC Form 1232)

YES  NO 14.

✓ REMOVE WASTE/CONSOLIDATION SITE ANNUAL NOTIFICATION (Formerly DTSC Form 1196)

✓ HAZARDOUS WASTE TANK CLOSURE CERTIFICATION (Formerly DTSC Form 1249)

**E. LOCAL REQUIREMENTS**

Cal-ARP: California Accidental Release Prevention Program  
*H&SC Chapter 6.95, Article 2, §25531 et seq*  
 - Stationary Source with more than a Threshold Quantity of a Regulated Substance in a Process

YES  NO 15.

✓ REGULATED SUBSTANCE REPORTING FORM (Orange County CUPA)



# CITY OF GARDEN GROVE FIRE DEPARTMENT

11301 Acacia Parkway, Garden Grove, CA 92842 (714) 741-5600 (714) 741-5636

FORM 1

## Hazardous Materials Business Information Form

Page 2 of 3

### BUSINESS INFORMATION

FACILITY # (Supplied by GGFD)	3	0	0	3	5	BEGINNING DATE	1	ENDING DATE	2	
						3/1/2012		2/28/2013		
BUSINESS NAME	4							BUSINESS PHONE	5	
The Home Depot Store #6639							714-539-0319			
BUSINESS SITE ADDRESS	6									
10801 Garden Grove Blvd										
CITY	7						STATE	8	ZIP	9
GARDEN GROVE						CA	92843			
DUN & BRADSTREET	10				SIC CODE (4 DIGIT #)	11		FIRE DISTRICT	12	
783266950				5211		Garden Grove				
COUNTY	13									
ORANGE										
BUSINESS OPERATOR NAME	14						OPERATOR'S PHONE	15		
The Home Depot USA, Inc.						770-433-8211 x82714				

### BUSINESS OWNER

OWNER NAME	16						OWNER PHONE	17	
The Home Depot USA Inc.						770-433-8211 x82714			
OWNER MAILING ADDRESS	18								
2455 Paces Ferry Road, C-19									
CITY	19				STATE	20		ZIP	21
Atlanta				GA		30339			

### ENVIRONMENTAL CONTACT

CONTACT NAME	22						CONTACT PHONE	23	
ARCADIS US, Inc.						860-645-1084			
CONTACT MAILING ADDRESS	24								
160 Chapel Road, Suite 201 C/O Compliance Department									
CITY	25				STATE	26		ZIP	27
Manchester				CT		06042			

### PRIMARY

### EMERGENCY CONTACTS

### SECONDARY

NAME	28			NAME	33			
Mark Vitug			Jamie Ramirez					
TITLE	29			TITLE	34			
Store Manager			District Operations Manager					
BUSINESS PHONE	30			BUSINESS PHONE	35			
714-539-0319			714-539-0319					
24-HR. PHONE	31			24-HR. PHONE	36			
714-539-0319			714-539-0319					
PAGER #	32			PAGER #	37			
NA			NA					

### ADDITIONAL LOCALLY COLLECTED INFORMATION

DESCRIBE THE TYPE OF BUSINESS OPERATION:	38			TOTAL # OF EMPLOYEES	39		
Home Improvement Retailer							
BILLING ADDRESS (IF DIFFERENT FROM ABOVE)	40			ATTENTION	41		
160 Chapel Road, Suite 201			Compliance Department				
PROPERTY OWNER NAME	42		ADDRESS	43		PHONE	44
The Home Depot USA, Inc.		2455 Paces Ferry Road, C-19		770-433-8211 x82714			

**Certification:** Based on my inquiry of those individuals responsible for obtaining the information, I certify under penalty of law that I have personally examined and am familiar with the information submitted and believe the information is true, accurate, and complete.

SIGNATURE OF OWNER/OPERATOR OR DESIGNATED REPRESENTATIVE	45			DATE	46		
			2/28/2012				
NAME OF SIGNER (print)	47			NAME OF DOCUMENT PREPARER (print)	49		
Lesley Schafer			ARCADIS US, Inc.				
TITLE OF SIGNER	48			TITLE OF DOCUMENT PREPARER	50		
Compliance Specialist			Consultant				



# HAZARDOUS MATERIALS INVENTORY FORM

FORM 3

ADD  DELETE  REVISED 1

Page 3 of 5 2

FACILITY ID#	3 0 0 3 5	38	BUSINESS NAME	The Home Depot Store #6639	3
--------------	-----------	----	---------------	----------------------------	---

## I. FACILITY INFORMATION

CHEMICAL LOCATION	Batteries in Receiving and on Equipment				4	
CONFIDENTIAL LOCATION EPCRA	<input type="checkbox"/> Yes <input checked="" type="checkbox"/> No	5	MAP #	6	GRID #	7

## II. CHEMICAL INFORMATION

CHEMICAL NAME			WASTE	<input type="checkbox"/> Yes <input checked="" type="checkbox"/> No	8	TRADE SECRET	<input type="checkbox"/> Yes <input checked="" type="checkbox"/> No	11		
COMMON NAME	Lead Acid Batteries		If EPCRA see instructions		9	An EHS Chemical	<input type="checkbox"/> Yes <input checked="" type="checkbox"/> No	12		
CAS #	10.	FIRE CODE HAZARD CLASSES (supplied by GGFD)		Corrosive				13		
TYPE (Check one item only)	<input type="checkbox"/> a. PURE	<input type="checkbox"/> b. MIXTURE	<input type="checkbox"/> c. WASTE	14	RADIOACTIVE	Yes	No	15		
PHYSICAL STATE (Check one item only)	<input type="checkbox"/> a. SOLID	<input checked="" type="checkbox"/> b. LIQUID	<input type="checkbox"/> c. GAS	17	FED HAZARD CATEGORIES	<input type="checkbox"/> a. FIRE	<input type="checkbox"/> b. REACTIVE	<input type="checkbox"/> c. PRESSURE RELEASE		
						<input checked="" type="checkbox"/> d. ACUTE HEALTH	<input checked="" type="checkbox"/> e. CHRONIC HEALTH	18		
AVERAGE DAILY AMOUNT	19	367.22	MAXIMUM DAILY AMOUNT	20	367.22	ANNUAL WASTE AMOUNT	21	0		
				STATE WASTE CODE	22	791				
UNITS	<input checked="" type="checkbox"/> a. GALLONS	<input type="checkbox"/> b. CUBIC FEET	<input type="checkbox"/> c. POUNDS	<input type="checkbox"/> d. TONS	23	DAYS ON SITE	24	365		
				LARGEST CONTAINER	25	141				
				*If EHS, amount must be in pounds.						
STORAGE CONTAINER (Check all that apply)	<input type="checkbox"/> a. ABOVEGROUND TANK	<input type="checkbox"/> e. PLASTIC DRUM	<input type="checkbox"/> i. VAT	<input type="checkbox"/> m. CYLINDER	<input type="checkbox"/> q. TANK WAGON	<input type="checkbox"/> b. UNDERGROUND TANK	<input type="checkbox"/> f. NONMETALLIC DRUM	<input type="checkbox"/> l. FIBER DRUM	<input type="checkbox"/> n. GLASS CONTAINER	<input type="checkbox"/> r. RAIL CAR
		<input type="checkbox"/> c. TANK INSIDE BLDG	<input type="checkbox"/> g. METAL CONTAINER	<input type="checkbox"/> j. BAG(S)	<input type="checkbox"/> o. PLASTIC CONTAINER	<input type="checkbox"/> d. STEEL DRUM	<input type="checkbox"/> h. CARBOY	<input type="checkbox"/> k. BOX(S)	<input type="checkbox"/> p. IN MACH OR EQUIP	<input checked="" type="checkbox"/> t. OTHER
STORAGE PRESSURE	<input type="checkbox"/> a. AMBIENT	<input checked="" type="checkbox"/> b. ABOVE AMBIENT	<input type="checkbox"/> c. BELOW AMBIENT	27						
STORAGE TEMPERATURE	<input checked="" type="checkbox"/> a. AMBIENT	<input type="checkbox"/> b. ABOVE AMBIENT	<input type="checkbox"/> c. BELOW AMBIENT	<input type="checkbox"/> d. CRYOGENIC	28					

%WT	HAZARDOUS COMPONENT (For mixture or waste only)	EHS	CAS #
1 40 29	Sulfuric Acid	<input checked="" type="checkbox"/> Yes <input type="checkbox"/> No 30	7664-93-9 32
2 29		<input type="checkbox"/> Yes <input type="checkbox"/> No 31	32
3 29		<input type="checkbox"/> Yes <input type="checkbox"/> No 31	32
4 29		<input type="checkbox"/> Yes <input type="checkbox"/> No 31	32
5 29		<input type="checkbox"/> Yes <input type="checkbox"/> No 31	32

If more hazardous components are present at greater than 1% by weight if non-carcinogenic, or 0.1% by weight if carcinogenic, attach additional sheets of paper capturing the required information.

## PLACARDING INFORMATION

UNDOT # \_\_\_\_\_ 33  
Refer to shipping papers or MSDS

DOT HAZARD CLASS 8 \_\_\_\_\_ 34  
Refer to shipping papers or MSDS

EPCRA  YES  NO 35

X \_\_\_\_\_ 36  
If EPCRA, Please Sign Here

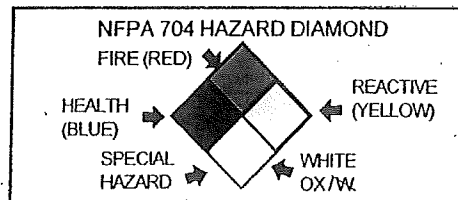

MAKE AS MANY COPIES OF CHEMICAL INVENTORY FORM AS NEEDED



# HAZARDOUS MATERIALS INVENTORY FORM

FORM 3

ADD  DELETE  REVISED 1

Page 4 of 5 2

FACILITY ID#	3 0 0 3 5	38	BUSINESS NAME	The Home Depot Store #6639	3
--------------	-----------	----	---------------	----------------------------	---

## I. FACILITY INFORMATION

CHEMICAL LOCATION	Outside	4
CONFIDENTIAL LOCATION EPCRA	<input type="checkbox"/> Yes <input checked="" type="checkbox"/> No	5
MAP #		6
GRID #		7

## II. CHEMICAL INFORMATION

CHEMICAL NAME	Petroleum Hydrocarbons	WASTE	<input type="checkbox"/> Yes <input checked="" type="checkbox"/> No	8	TRADE SECRET	<input type="checkbox"/> Yes <input checked="" type="checkbox"/> No	11	
COMMON NAME	Diesel Fuel	If EPCRA see instructions						
An EHS Chemical		<input type="checkbox"/> Yes <input checked="" type="checkbox"/> No	12					
*If EHS is "Yes", all amounts must be LBS								
CAS #	68334-30-5	10	FIRE CODE HAZARD CLASSES (supplied by GGFD)	Corrosive				13
TYPE (Check one item only)	<input type="checkbox"/> a. PURE <input checked="" type="checkbox"/> b. MIXTURE <input type="checkbox"/> c. WASTE	14	RADIOACTIVE	<input type="checkbox"/> Yes <input checked="" type="checkbox"/> No	15	CURIES	NA	16
PHYSICAL STATE (Check one item only)	<input type="checkbox"/> a. SOLID <input checked="" type="checkbox"/> b. LIQUID <input type="checkbox"/> c. GAS	17	FED HAZARD CATEGORIES	<input checked="" type="checkbox"/> a. FIRE <input type="checkbox"/> b. REACTIVE <input type="checkbox"/> c. PRESSURE RELEASE	18			
				<input type="checkbox"/> d. ACUTE HEALTH <input checked="" type="checkbox"/> e. CHRONIC HEALTH				
AVERAGE DAILY AMOUNT	100	19	MAXIMUM DAILY AMOUNT	100	20	ANNUAL WASTE AMOUNT	0	21
STATE WASTE CODE		NA						22
UNITS	<input checked="" type="checkbox"/> a. GALLONS <input type="checkbox"/> b. CUBIC FEET <input type="checkbox"/> c. POUNDS <input type="checkbox"/> d. TONS	23	DAYS ON SITE	365	24	LARGEST CONTAINER	100	25
*If EHS, amount must be in pounds.								
STORAGE CONTAINER (Check all that apply)	<input checked="" type="checkbox"/> a. ABOVEGROUND TANK <input type="checkbox"/> b. UNDERGROUND TANK <input type="checkbox"/> c. TANK INSIDE BLDG <input type="checkbox"/> d. STEEL DRUM	<input type="checkbox"/> e. PLASTIC DRUM <input type="checkbox"/> f. NONMETALLIC DRUM <input type="checkbox"/> g. METAL CONTAINER <input type="checkbox"/> h. CARBOY	<input type="checkbox"/> i. VAT <input type="checkbox"/> j. FIBER DRUM <input type="checkbox"/> k. BAG(S) <input type="checkbox"/> l. BOX(S)	<input type="checkbox"/> m. CYLINDER <input type="checkbox"/> n. GLASS CONTAINER <input type="checkbox"/> o. PLASTIC CONTAINER <input type="checkbox"/> p. IN MACH OR EQUIP	<input type="checkbox"/> q. TANK WAGON <input type="checkbox"/> r. RAIL CAR <input type="checkbox"/> s. TOTE BIN <input type="checkbox"/> t. OTHER	26		
STORAGE PRESSURE	<input type="checkbox"/> a. AMBIENT <input checked="" type="checkbox"/> b. ABOVE AMBIENT <input type="checkbox"/> c. BELOW AMBIENT	27						
STORAGE TEMPERATURE	<input checked="" type="checkbox"/> a. AMBIENT <input type="checkbox"/> b. ABOVE AMBIENT <input type="checkbox"/> c. BELOW AMBIENT <input type="checkbox"/> d. CRYOGENIC	28						

%WT	HAZARDOUS COMPONENT (For mixture or waste only)	EHS	CAS #
1 29		<input type="checkbox"/> Yes <input type="checkbox"/> No	7664-93-9
2 29		<input type="checkbox"/> Yes <input type="checkbox"/> No	
3 29		<input type="checkbox"/> Yes <input type="checkbox"/> No	
4 29		<input type="checkbox"/> Yes <input type="checkbox"/> No	
5 29		<input type="checkbox"/> Yes <input type="checkbox"/> No	

If more hazardous components are present at greater than 1% by weight if non-carcinogenic, or 0.1% by weight if carcinogenic, attach additional sheets of paper capturing the required information.

## PLACARDING INFORMATION

UNDOT # \_\_\_\_\_ 33  
Refer to shipping papers or MSDS

DOT HAZARD CLASS 3 \_\_\_\_\_ 34  
Refer to shipping papers or MSDS

EPCRA  YES  NO \_\_\_\_\_ 35

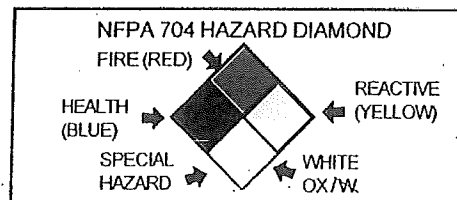

X \_\_\_\_\_ 36  
If EPCRA, Please Sign Here

MAKE AS MANY COPIES OF CHEMICAL INVENTORY FORM AS NEEDED



# HAZARDOUS MATERIALS INVENTORY FORM

FORM 3

ADD  DELETE  REVISED 1

Page 5 of 5 2

FACILITY ID#	3 0 0 3 5	38	BUSINESS NAME	The Home Depot Store #6639	3
--------------	-----------	----	---------------	----------------------------	---

## I. FACILITY INFORMATION

CHEMICAL LOCATION	Outside	4
CONFIDENTIAL LOCATION EPCRA	<input type="checkbox"/> Yes <input checked="" type="checkbox"/> No	5
MAP #		6
GRID #		7

## II. CHEMICAL INFORMATION

CHEMICAL NAME	Propane	WASTE	<input type="checkbox"/> Yes <input checked="" type="checkbox"/> No	8	TRADE SECRET	<input type="checkbox"/> Yes <input checked="" type="checkbox"/> No	11
COMMON NAME	Propane	If EPCRA see instructions		9	An EHS Chemical	<input type="checkbox"/> Yes <input checked="" type="checkbox"/> No	12
*If EHS is "Yes", all amounts must be LBS							

CAS #	74-98-6	10	FIRE CODE HAZARD CLASSES (supplied by GGFD)	Corrosive	13
-------	---------	----	---	-----------	----

TYPE (Check one item only)	<input type="checkbox"/> a. PURE <input type="checkbox"/> b. MIXTURE <input type="checkbox"/> c. WASTE	14	RADIOACTIVE	<input type="checkbox"/> Yes <input checked="" type="checkbox"/> No	15	CURIES	NA	16
PHYSICAL STATE (Check one item only)	<input type="checkbox"/> a. SOLID <input type="checkbox"/> b. LIQUID <input checked="" type="checkbox"/> c. GAS	17	FED HAZARD CATEGORIES	<input checked="" type="checkbox"/> a. FIRE <input type="checkbox"/> b. REACTIVE <input checked="" type="checkbox"/> c. PRESSURE RELEASE <input type="checkbox"/> d. ACUTE HEALTH <input type="checkbox"/> e. CHRONIC HEALTH	18			

AVERAGE DAILY AMOUNT	1507.5	19	MAXIMUM DAILY AMOUNT	1507.5	20	ANNUAL WASTE AMOUNT	0	21	STATE WASTE CODE	NA	22
----------------------	--------	----	----------------------	--------	----	---------------------	---	----	------------------	----	----

UNITS	<input type="checkbox"/> a. GALLONS <input type="checkbox"/> b. CUBIC FEET <input checked="" type="checkbox"/> c. POUNDS <input type="checkbox"/> d. TONS	23	DAYS ON SITE	365	24	LARGEST CONTAINER	34	25
*If EHS, amount must be in pounds.								

STORAGE CONTAINER (Check all that apply)	<input type="checkbox"/> a. ABOVEGROUND TANK <input type="checkbox"/> b. UNDERGROUND TANK <input type="checkbox"/> c. TANK INSIDE BLDG <input type="checkbox"/> d. STEEL DRUM <input type="checkbox"/> e. PLASTIC DRUM <input type="checkbox"/> f. NONMETALLIC DRUM <input type="checkbox"/> g. METAL CONTAINER <input type="checkbox"/> h. CARBOY <input type="checkbox"/> i. VAT <input type="checkbox"/> j. FIBER DRUM <input type="checkbox"/> k. BAG(S) <input type="checkbox"/> l. BOX(S) <input checked="" type="checkbox"/> m. CYLINDER <input type="checkbox"/> n. GLASS CONTAINER <input type="checkbox"/> o. PLASTIC CONTAINER <input type="checkbox"/> p. IN MACH OR EQUIP <input type="checkbox"/> q. TANK WAGON <input type="checkbox"/> r. RAIL CAR <input type="checkbox"/> s. TOTE BIN <input type="checkbox"/> t. OTHER	26
--	---	----

STORAGE PRESSURE	<input type="checkbox"/> a. AMBIENT <input checked="" type="checkbox"/> b. ABOVE AMBIENT <input type="checkbox"/> c. BELOW AMBIENT	27
STORAGE TEMPERATURE	<input checked="" type="checkbox"/> a. AMBIENT <input type="checkbox"/> b. ABOVE AMBIENT <input type="checkbox"/> c. BELOW AMBIENT <input type="checkbox"/> d. CRYOGENIC	28

%WT	HAZARDOUS COMPONENT (For mixture or waste only)	EHS	CAS #
1	29	<input type="checkbox"/> Yes <input type="checkbox"/> No	7664-93-9
2	29	<input type="checkbox"/> Yes <input type="checkbox"/> No	
3	29	<input type="checkbox"/> Yes <input type="checkbox"/> No	
4	29	<input type="checkbox"/> Yes <input type="checkbox"/> No	
5	29	<input type="checkbox"/> Yes <input type="checkbox"/> No	

If more hazardous components are present at greater than 1% by weight if non-carcinogenic, or 0.1% by weight if carcinogenic, attach additional sheets of paper capturing the required information.

## PLACARDING INFORMATION

UNDOT # \_\_\_\_\_ 33  
Refer to shipping papers or MSDS

DOT HAZARD CLASS 2.1 \_\_\_\_\_ 34  
Refer to shipping papers or MSDS

EPCRA  YES  NO 35

X \_\_\_\_\_ 36  
If EPCRA, Please Sign Here

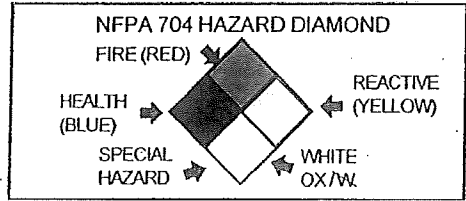

MAKE AS MANY COPIES OF CHEMICAL INVENTORY FORM AS NEEDED



The Home Depot Store #6639 2012 Waste Inventory

Waste Description	Container Type	Container Size	Average Amount Stored Onsite (Pounds)	Maximum Amount Onsite (Pounds)	Number of Days Onsite
ACID, INORGANIC	Bucket	5 gal	28	124	365
AEROSOLS	Drum	30 gal	152	240	365
BASE, INORGANIC	Bucket	5 gal	33	75	365
BLEACH	Bucket	5 gal	7	7	365
FERTILIZER BAGS, RCRA	Bucket	5 gal	25	46	365
FERTILIZER SWEEPINGS, RCRA	Drum	30 gal	26	130	365
FIRE EXTINGUISHERS	Individual Units	Fire Extinguishers	10	10	365
FLAMMABLE LIQUIDS	Bucket	5 gal	70	160	365
FLAMMABLE SOLIDS	Bucket	5 gal	163	163	365
GASOLINE	Caddy	25 gal	94	130	365
NON-RCRA MATERIALS	Drum	30 gal	119	241	365
NON-RCRA MATERIALS	Bucket	5 gal	357	750	365
OXIDIZERS, SOLID	Bucket	5 gal	4	4	365
PROPANE CYLINDERS	Bucket	5 gal	12	20	365
SUMP WASTE	Bucket	5 gal	1,282	2,836	365
TOXIC LIQUIDS	Bucket	5 gal	27	43	365
TOXIC SOLIDS	Bucket	5 gal	6	6	365
WASTE OIL	Bucket	5 gal	200	200	365



SCALE: NOT TO SCALE  
DATE: 04/04/2008

LEGEND

- ☆ SAFE REFUGE AREA
- ▨ STORM DRAIN
- ⊙ FIRE HYDRANT
- ⊙ GAS MAIN
- ⊙ WATER MAIN

A B C D E F G H I

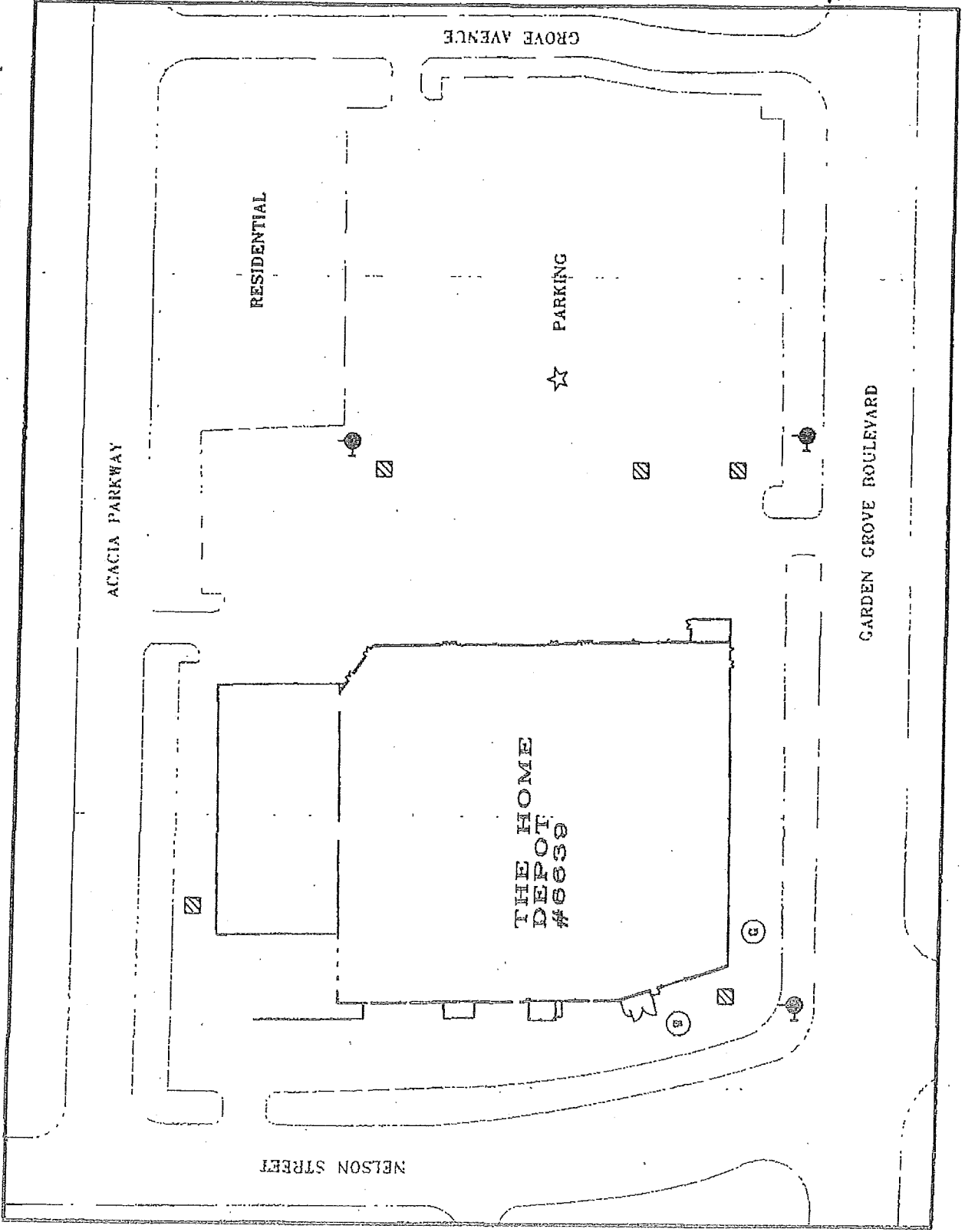

PREPARED BY:

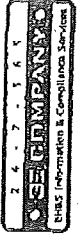

1905 Aston Avenue  
Carlsbad, CA 92008

**UNIFIED PROGRAM CONSOLIDATED FORM  
FACILITY INFORMATION  
BUSINESS OWNER/OPERATOR IDENTIFICATION**

Page 1 of 1

**I. IDENTIFICATION**

FACILITY ID # <i>(Agency Use Only)</i>										1.	BEGINNING DATE 2011/08/01	100.	ENDING DATE 2012/07/31	101.	
BUSINESS NAME <i>(Same as Facility Name or DBA - Doing Business As)</i>												3.	BUSINESS PHONE (714) 539-0319	102.	
BUSINESS SITE ADDRESS 10801 Garden Grove Blvd												103.	BUSINESS FAX	102a.	
BUSINESS SITE CITY Garden Grove										104.	STATE CA	ZIP CODE 92843	105.	COUNTY Orange	108.
DUN & BRADSTREET 783266950										106.	PRIMARY SIC 5211	107.	PRIMARY NAICS 444110	107a.	
BUSINESS MAILING ADDRESS 160 Chapel Road, Suite 201												108a.			
BUSINESS MAILING CITY Manchester										108b.	STATE CT	108c.	ZIP CODE 06042	108d.	
BUSINESS OPERATOR NAME The Home Depot USA, Inc.										109.	BUSINESS OPERATOR PHONE 770.433.8211 x 82714			110.	

**II. BUSINESS OWNER**

OWNER NAME The Home Depot USA, Inc.										111.	OWNER PHONE 770.433.8211 x 82714			112.
OWNER MAILING ADDRESS 2455 Paces Ferry Road, C-19												113.		
OWNER MAILING CITY Atlanta										114.	STATE GA	115.	ZIP CODE 30339	116.

**III. ENVIRONMENTAL CONTACT**

CONTACT NAME ARCADIS US, Inc.										117.	CONTACT PHONE 860.645.1084			118.
CONTACT MAILING ADDRESS 160 Chapel Road, Suite 201 C/O Compliance Department										119.	CONTACT EMAIL tieriiadministrator@arcadis-us.com			119a.
CONTACT MAILING CITY Manchester										120.	STATE CT	121.	ZIP CODE 06042	122.

**-PRIMARY-**

**IV. EMERGENCY CONTACTS**

**-SECONDARY-**

NAME Mariann Stratman						123.	NAME Jamie Ramirez						128.
TITLE Store Manager						124.	TITLE District Operations Manager						129.
BUSINESS PHONE (714) 539-0319						125.	BUSINESS PHONE (714) 539-0319						130.
24-HOUR PHONE (714) 539-0319						126.	24-HOUR PHONE (714) 539-0319						131.
PAGER #						127.	PAGER #						132.

ADDITIONAL LOCALLY COLLECTED INFORMATION:

Billing Address: ARCADIS US, Inc., 160 Chapel Road, Suite 201 C/O Compliance Department, Manchester, CT 06042

Property Owner: The Home Depot USA, Inc. Phone No.: 770.433.8211 x 82714

**Certification:** Based on my inquiry of those individuals responsible for obtaining the information, I certify under penalty of law that I have personally examined and am familiar with the information submitted and believe the information is true, accurate, and complete.

SIGNATURE OF OWNER/OPERATOR OR DESIGNATED REPRESENTATIVE 				DATE 8/5/2011	134.	NAME OF DOCUMENT PREPARER ARCADIS US, Inc.				135.	
NAME OF SIGNER (print) Lesley Schafer, Agent for the Home Depot						136.	TITLE OF SIGNER Compliance Specialist, ARCADIS US, Inc.				137.

**UNIFIED PROGRAM CONSOLIDATED FORM  
HAZARDOUS MATERIALS  
HAZARDOUS MATERIALS INVENTORY – CHEMICAL DESCRIPTION**  
(One page per material per building or area)

 ADD

 DELETE

 REVISE

200.

Page 2 of 3

**I. FACILITY INFORMATION**

BUSINESS NAME (Same as Facility Name or DBA – Doing Business As) 3.

The Home Depot Store #6639

CHEMICAL LOCATION 201.

Batteries in Receiving and on Equipment

CHEMICAL LOCATION CONFIDENTIAL EPCRA 202.

 YES  NO

 FACILITY ID #  
(Agency Use Only)

1.

MAP # (Optional) 203.

203.

GRID # (Optional) 204.

204.

**II. CHEMICAL INFORMATION**

CHEMICAL NAME 205.

Lead, Inorganic

TRADE SECRET 206.

If subject to EPCRA, refer to instructions

 Yes  No

COMMON NAME 207.

Lead

EHS\* 208.

 Yes  No

CAS# 209.

7439-92-1

\*If EHS is "Yes," all amounts below must be in lbs.

FIRE CODE HAZARD CLASSES (Complete if required by CUPA) 210.

TOXIC

HAZARDOUS MATERIAL 211.

TYPE (Check one item only)

 a. PURE  b. MIXTURE  c. WASTE

RADIOACTIVE 212.

 Yes  No

CURIES 213.

N/A

PHYSICAL STATE 214.

(Check one item only)

 a. SOLID  b. LIQUID  c. GAS

LARGEST CONTAINER 215.

1420

FED HAZARD CATEGORIES 216.

(Check all that apply)

 a. FIRE  b. REACTIVE  c. PRESSURE RELEASE  d. ACUTE HEALTH  e. CHRONIC HEALTH

AVERAGE DAILY AMOUNT 217.

7886

MAXIMUM DAILY AMOUNT 218.

7886

ANNUAL WASTE AMOUNT 219.

N/A

STATE WASTE CODE 220.

N/A

UNITS\* 221.

(Check one item only)

 a. GALLONS  b. CUBIC FEET  c. POUNDS  d. TONS

\* If EHS, amount must be in pounds.

DAYS ON SITE 222.

365

STORAGE CONTAINER 223.

 a. ABOVEGROUND TANK  f. CAN  k. BOX  p. TANK WAGON  
 b. UNDERGROUND TANK  g. CARBOY  l. CYLINDER  q. RAIL CAR  
 c. TANK INSIDE BUILDING  h. SILO  m. GLASS BOTTLE  r. OTHER  
 d. STEEL DRUM  i. FIBER DRUM  n. PLASTIC BOTTLE  
 e. PLASTIC/NONMETALLIC DRUM  j. BAG  o. TOTE BIN

STORAGE PRESSURE 224.

 a. AMBIENT  b. ABOVE AMBIENT  c. BELOW AMBIENT

STORAGE TEMPERATURE 225.

 a. AMBIENT  b. ABOVE AMBIENT  c. BELOW AMBIENT  d. CRYOGENIC

% WT 226.

HAZARDOUS COMPONENT (For mixture or waste only) 227.

EHS 228.

CAS # 229.

 1.  Yes  No

 2.  Yes  No

 3.  Yes  No

 4.  Yes  No

 5.  Yes  No

If more hazardous components are present at greater than 1% by weight if non-carcinogenic, or 0.1% by weight if carcinogenic, attach additional sheets of paper capturing the required information.

ADDITIONAL LOCALLY COLLECTED INFORMATION 246.

DOT Hazard Class: 6.1

If EPCRA, Please Sign Here.

### The Home Depot Store #6639 2011 Hazardous Waste Inventory

Common Name	Type of Container	Size of Container	Average Amount (Pounds) Stored Onsite	Maximum Amount (Pounds) Onsite	Number of Days Onsite
AEROSOLS	Drum	30 gallon	6.20	2,262.00	365
FLAMMABLE AND COMBUSTABLE LIQUIDS	Bucket	5 gallon	5.49	2,004.00	365
FLAMMABLE SOLIDS	Bucket	5 gallon	2.30	838.00	365
OXIDIZERS	Bucket	5 gallon	0.04	13.00	365
TOXIC LIQUIDS	Bucket	5 gallon	3.10	1,130.00	365
ACID INORGANIC	Bucket	5 gallon	0.55	200.00	365
BASE INORGANIC	Bucket	5 gallon	0.89	324.00	365
ALKALINE BATTERIES	Bucket	5 gallon	1.53	559.00	365
BASE INORGANIC	Bucket	5 gallon	0.37	136.00	365
COMPRESSED GAS CYLINDERS (FIRE EXTINGUISHER)	Individual Pieces	N/A	0.01	4.00	365
GASOLINE	Caddy	25 gallon	0.21	76.00	365
COMPRESSED GAS CYLINDERS (SMALL)	Bucket	5 gallon	0.05	18.00	365
NICKEL CADMIUM BATTERIES	Bucket	5 gallon	0.45	164.00	365
NON-RCRA MATERIALS	Bucket	5 gallon	5.30	1,934.00	365
WASTE OIL	Drum	30 gallon	0.10	36.00	365
LEAD ACID BATTERIES (AUTOMOTIVE)	Bucket	5 gallon	0.08	30.00	365
FERTILIZERS WITH PESTICIDES (BROKEN BAGS ONLY)	Bucket	5 gallon	0.14	50.00	365
FERTILIZER SWEEPINGS ONLY (NO BAGS)	Drum	30 gallon	1.98	722.00	365
NON-RCRA MATERIALS	Bucket	5 gallon	0.68	248.00	365
SUMP WASTE	Box	8 Cu. Ft.	7.68	2,802.00	365
CRUSHED BULBS - MERCURY DEBRIS	Bucket	5 gallon	1.35	494.00	365
FLUORESCENT LIGHT TUBES - STRAIGHT	Box	8 Cu. Ft.	0.52	191.00	365
FLUORESCENT LIGHT TUBES - STRAIGHT	Box	8 Cu. Ft.	0.64	232.00	365
NON-RCRA MATERIALS	Bucket	5 gallon	4.53	1,655.00	365
FLUORESCENT LIGHT TUBES - STRAIGHT	Box	8 Cu. Ft.	9.53	3,478.00	365

