



General Information: 714-741-5307

CITY OF GARDEN GROVE - DEVELOPMENT SERVICES DEPARTMENT

Inspection Requests: 714-741-5332

PERMIT (PAGE 2 of 2)

PROJECT/SITE/BUILDING DESCRIPTION

JOB Address : 7390 HUNT AVE
Suite :
PERMIT NO. : 88513
Permit Type :
Type : P

Owner :
Applicant : PAUL BROWN
Phone : 714-847-1976

Contractor : P M BROWN GENERAL BUILDING CON
Address : 18383 ENTERPRISE
CityStZip : HUNTINGTON BEACH, CA 92648
Phone : 847-1976

Insp Dist : ZP
Date : 12/20/06
Parcel No :

PROPOSED WORK:

PLBG FOR T.I.

FEES

942 22130 GENERAL PLAN	1	2.00
080 32550 CULTURAL ARTS	1	1.00
111 32401 Issuance	1	35.00
111 32415 Kitchen Sink	3	28.50
111 32415 Laundry Tub or Tray	1	9.50
111 32415 Water Heater	1	9.50
111 32415 GREASE/SAND TRAPS	1	95.00
TOTAL		180.50

APPROVAL	DATE	INSPECTOR
Soil Piping		
Ground Plumbing		
Rough Plumbing	2/21/07	Jim C
Gas Piping		
Gas Vent		
Sewer		
Main Drain		
Vacuum Lines		
Water Heater		
Backwash		
Water Lateral		

OK TO COVER 13' of sewer

Sewer/Trap ac to cover 3/5/07

FINAL 3/29/07 Agrom
Utility Notified

AUTHORIZATION

Issued By: jimc Date

DECLARATION

I certify that I have read this application/permit and state that the information on all pages of this document is correct. I agree to comply with all City and County ordinances and State laws relating to building construction, and hereby authorize representatives of this City and County to enter upon the above mentioned property for inspection purposes.

Applicant's Signature
Print Name Paul Brown Date 12-20-06

***** VALIDATION *****
PAID ON 20 Dec 2006 AT 09:14
RECEIVED BY KATRENAS 198.245.206.215/2 TRANS# 2
CASH PAID = \$180.50 CASH RETURNED = \$0.00
TOTAL PAID = \$180.50



General Information: 714-741-5307

CITY OF GARDEN GROVE - DEVELOPMENT SERVICES DEPARTMENT

Inspection Requests: 714-741-5332

PERMIT (PAGE 2 of 2)

PROJECT/SITE/BUILDING DESCRIPTION

JOB Address : 7390 HUNT AVE
 Suite :
 PERMIT NO. : 95985
 Permit Type :
 Type : P

Owner : AARON THOMAS CO.
 Applicant :
 Phone :

Contractor : ARCHITECT & BUILDER CO.
 Address : 1154 WILDFLOWER RD. #300
 CityStZip : TEMPLE CITY, CA 91780
 Phone : 626-358-1111

Insp Dist : ZP
 Date : 10/02/08
 Parcel No :

PROPOSED WORK:

REPLACE SINKS AND WATER HEATER IN INDUSTRIAL BLDG

FEES

111 32401 Issuance	1	35.00
111 32415 Lavatory	1	9.50
111 32415 Kitchen Sink	3	28.50
111 32415 Water Heater	1	9.50
TOTAL		82.50

APPROVAL DATE INSPECTOR

Soil Piping _____
 Ground Plumbing _____
 Rough Plumbing _____
 Gas Piping _____
 Gas Vent _____
 Sewer _____
 Main Drain _____
 Vacuum Lines _____
 Water Heater _____
 Backwash _____
 Water Lateral _____

FINAL 11/11/08 [Signature]

Utility Notified _____

AUTHORIZATION

Issued By: yoavs Date _____

DECLARATION

I certify that I have read this application/permit and state that the information on all pages of this document is correct. I agree to comply with all City and County ordinances and State laws relating to building construction, and hereby authorize representatives of this City and County to enter upon the above mentioned property for inspection purposes.

Applicant's Signature [Signature]
 Print Name My Hassan Date 10/2/08

***** VALIDATION *****
 PAID ON 02 Oct 2008 AT 13:45
 RECEIVED BY EDWARDM 198.245.206.215/2 TRANS# 130
 AMOUNT PAID \$82.50 BY CHECK#3877
 TOTAL PAID = \$82.50



**CITY OF GARDEN GROVE
BUILDING SERVICES**

General Info : 714-741-5307
Inspection Requests : 714-741-5332

7390 HUNT AVE

PERMIT#:12-2406

ISSUED:12/3/12

Owner			Telephone	Zip	Building Address				
Address		City	State		7390 HUNT AVE				
Applicant					Suite/Unit/Building		TYPE		
brown construction		Telephone	714-847-1976	Zip	92648		ISSUED BY		
1838/3 enterprise		City	huntington beach		ca		Don Lucas		
State Licence		Expires	City Licence		Expires		Inspector Dist.	Parcel Number	
395857		N/A				H7		LOT	
								TRACT	
Contractor					Valuation				
brown construction		Telephone	714-847-1976	Zip	\$82,300.00				
1838/3 enterprise		City	huntington beach						
State Licence		Expires	City Licence						
395857		N/A							
Final					Inspector's Signature <u>PLB</u>				
					Date <u>12/17/12</u>				
Floor Area(sq. ft.)		Residential/Commercial							
		Commercial							
Job Description									
construct dry packaging rooms inside existing building									
DECLARATION									
I certify that I have read this application/permit and state that the information on all pages of this document is correct. I agree to comply with all City and County ordinances and State laws relating to building construction, and hereby authorize representatives of this City and County to enter upon the above mentioned property for inspection purposes.									
X Applicant's Signature <u>[Signature]</u>									
Print Name <u>PAUL BROWN</u> Date <u>12-3-12</u>									

Permit Type:
MECH/PLUMB/ELEC/BLDG



**CITY OF GARDEN GROVE
BUILDING SERVICES**

General Info : 714-741-5307
Inspection Requests : 714-741-5332

**7390 HUNT AVE
PERMIT#:12-2406
ISSUED:12/3/12**

**F
E
E
S**

Description	Quantity	Amount
A.C. condensing unit to 5 tons	1	\$9.00
Heat pumps, to , BTU	1	\$9.00
Ducts	1	\$12.00
Lawn Sprinkler (Non-Residential) - Vacuum breakers or backflow prevention devices	1	\$15.00
Gas System	6	\$22.00
Industrial waste pre-treatment interceptor, sand trap, receptor	1	\$95.00
Floor drain	1	\$9.50
Floor sink	3	\$28.50
Water Heater	1	\$30.00
Kitchen Sink	1	\$9.50
Subpanel/Distribution Panels (three phase)	1	\$65.00
Hot Water Heater	1	\$9.50
Receptical, switch, outlet, and fixture	40	\$35.00
Water Plan Check	1.75	\$105.00
General Plan Update Fee, Valuation		\$98.17
Cultural Arts Fee, Valuation		\$49.08
Plan Check Fee - Disabled Access (Commercial)	1	\$58.71
Plan Check Fee - Energy Conservation (Commercial)	1	\$58.71
Plan Check Fee		\$587.09
Building Permit Document Retention Fee	1	\$5.00
Building Technology Fee	1	\$10.00
Plan Retention	25	\$100.00
BSASRF State Fee		\$4.00
Engineering Plan Check - Tenant Improvement	1	\$55.00
Fire Plan Check Fee - Commercial TI under 6000 sqft	1	\$55.00
SMI (Commercial)	1	\$17.28
Issuance Fee	1	\$35.00
Building Permit Fee		\$885.50
One-Stop Permit Center Surcharge		\$17.71
TOTAL		\$2,490.25

Permit Type:

MECH/PLUMB/ELEC/BLDG



**CITY OF GARDEN GROVE
BUILDING SERVICES**

General Info : 714-741-5307
Inspection Requests : 714-741-5332

✓
7390 HUNT AVE
PERMIT#:13-0566
ISSUED:3/25/13

Owner			Telephone	Zip	Building Address			
Address		City	State	7390 HUNT AVE				
Applicant			Telephone	Zip	TYPE		ISSUED BY	
brown construction			714-847-1976	92648	Addition		Joanne Chung	
Address		City	State	Inspector Dist.	Parcel Number	LOT	TRACT	
1838/3 enterprise		huntington beach	ca	H7				
State Licence	Expires	City Licence	Expires		Valuation			
395857	N/A				\$25,400.00			
Contractor			Telephone	Zip	Final			
brown construction			714-847-1976	92648	Inspector's Signature <u><i>ME</i></u>			
Address		City	State	Date <u>8/27/13</u>				
1838/3 enterprise		huntington beach	ca					
State Licence	Expires	City Licence	Expires					
395857	N/A							
Floor Area(sq. ft.)		Residential/Commercial						
337		Commercial						
Job Description ADD DETACHED BOILER RM								
DECLARATION								
I certify that I have read this application/permit and state that the information on all pages of this document is correct. I agree to comply with all City and County ordinances and State Laws relating to building construction, and hereby authorize representatives of this City and County to enter upon the above mentioned property for inspection purposes.								
X	Applicant's Signature		<u><i>[Signature]</i></u>					
	Print Name	Date		<u>3-25-13</u>				
F E E S	Description		Quantity	Amount				
	Plan Check Fee - Energy Conservation (Commercial)		1	\$27.52				
	Plan Check Fee			\$275.15				
	General Plan Update Fee, Valuation			\$31.67				
	Cultural Arts Fee, Valuation			\$15.83				
	Plan Check Fee - Disabled Access (Commercial)		1	\$27.52				
	Boilers/Compressors/Absorption Systems, up to 5hp or 5, BTU			\$35.00				
	Gas System		1	\$18.50				
	Water Piping		20	\$39.50				
	Floor sink		1	\$9.50				
	Receptical, switch, outlet, and fixture		10	\$10.00				
	Building Permit Document Retention Fee		1	\$5.00				
	Building Technology Fee		1	\$10.00				
	BSASRF State Fee			\$2.00				
	Issuance Fee		1	\$35.00				
Building Permit Fee			\$415.00					
One-Stop Permit Center Surcharge			\$8.30					
TOTAL			\$965.49					

This is a building permit when properly filled out, signed and validated, and is subject to expiration if work thereunder is suspended for 180 days.

**Permit Type:
BLDG/MECH/PLUMB/ELEC**



**CITY OF GARDEN GROVE
BUILDING SERVICES**

General Info : 714-741-5307
Inspection Requests : 714-741-5332

7390 HUNT AVE
PERMIT#:13-1066
ISSUED:6/3/13

Owner			Telephone		Zip	Building Address				
Address		City	State			7390 HUNT AVE				
Applicant						Suite/Unit/Building				
B D B INCORPORATED			Telephone 530-8150		Zip	TYPE Electrical Permit		ISSUED BY Yoav Shernock		
Address 11743 CARDINAL CIR		City	State			Inspector Dist. H7		Parcel Number	LOT	TRACT
State Licence 275622 C10		Expires N/A	City Licence		Expires	Valuation				
Contractor						\$0.00				
B D B INCORPORATED			Telephone 530-8150		Zip	Final				
Address 11743 CARDINAL CIR		City	State			Inspector's Signature		EXPIRED		
State Licence 275622 C10		Expires N/A	City Licence		Expires	Date				
Floor Area(sq. ft.)		Residential/Commercial Commercial								
Job Description ELECTRICAL IMPROVEMENTS FOR T.I. AT INDUSTRIAL SPACE--ADD PANELBOARDS, TRANSFORMERS, POWER BOXES, BATTERY CHARGER OUTLETS, CIRCULATING PUMP OUTLET, CORD DROP OUTLETS, DUPLEX RECEPTACLE OUTLETS										
DECLARATION										
I certify that I have read this application/permit and state that the information on all pages of this document is correct. I agree to comply with all City and County ordinances and State laws relating to building construction, and hereby authorize representatives of this City and County to enter upon the above mentioned property for inspection purposes.										
X Applicant's Signature										
Print Name		TIM MAYLAND Date 6-3-13								
F E E S						Description		Quantity	Amount	
						Subpanel/Distribution Panels (single phase)		3	\$90.00	
						Power Apparatus - Over 5 but not over HP/kW/kVA/kVAR		2	\$90.00	
						Power Apparatus - Over but not over HP/kW/kVA/kVAR		2	\$24.00	
						Power Apparatus - Not over HP/kW/kVA/kVAR		13	\$123.50	
						Receptical, switch, outlet, and fixture		10	\$10.00	
						Building Permit Document Retention Fee		1	\$5.00	
						Building Technology Fee		1	\$10.00	
						Electrical Plan Check Fee		1	\$286.88	
						Issuance Fee		1	\$35.00	
TOTAL			\$674.38							

This is a building permit when properly filled out, signed and validated, and is subject to expiration if work thereunder is suspended for 180 days.

Permit Type: ELEC

ORIGINAL



**CITY OF GARDEN GROVE
BUILDING SERVICES**

7390 HUNT AVE

PERMIT#:13-1265

ISSUED:6/18/13

General Info : 714-741-5307

Inspection Requests : 714-741-5332

Owner			Telephone		Zip	Building Address																								
Address			City		State	7390 HUNT AVE																								
Applicant			Telephone		Zip	Suite/Unit/Building		TYPE		ISSUED BY																				
brown construction			714-847-1976		92648	Plumbing Permit		Plumbing Permit		Joanne Chung																				
Address			City		State	Inspector Dist.		Parcel Number	LOT	TRACT																				
1838/3 enterprise			huntington beach		ca	H7																								
State Licence		Expires	City Licence		Expires	Valuation																								
395857		N/A				\$0.00																								
Contractor			Telephone		Zip	Final																								
brown construction			714-847-1976		92648	Inspector's Signature																								
Address			City		State	Date																								
1838/3 enterprise			huntington beach		ca	EXPIRED																								
State Licence		Expires	City Licence		Expires	<table border="1" style="width:100%; border-collapse: collapse;"> <thead> <tr> <th></th> <th>Description</th> <th>Quantity</th> <th>Amount</th> </tr> </thead> <tbody> <tr> <td rowspan="5" style="vertical-align: middle; font-size: 2em; font-weight: bold;">F E E S</td> <td>Building Permit Document Retention Fee</td> <td>1</td> <td>\$5.00</td> </tr> <tr> <td>Building Technology Fee</td> <td>1</td> <td>\$10.00</td> </tr> <tr> <td>Ad-hoc</td> <td>1</td> <td>\$15.00</td> </tr> <tr> <td>Gas System</td> <td>1</td> <td>\$18.50</td> </tr> <tr> <td>TOTAL</td> <td></td> <td>\$48.50</td> </tr> </tbody> </table>						Description	Quantity	Amount	F E E S	Building Permit Document Retention Fee	1	\$5.00	Building Technology Fee	1	\$10.00	Ad-hoc	1	\$15.00	Gas System	1	\$18.50	TOTAL		\$48.50
	Description	Quantity	Amount																											
F E E S	Building Permit Document Retention Fee	1	\$5.00																											
	Building Technology Fee	1	\$10.00																											
	Ad-hoc	1	\$15.00																											
	Gas System	1	\$18.50																											
	TOTAL		\$48.50																											
395857		N/A																												
Floor Area(sq. ft.)		Residential/Commercial																												
		Commercial																												
Job Description																														
SUPP TO PERMIT 13-0566--INSTALL MEDIUM PRESSURE GAS LINE																														
DECLARATION																														
I certify that I have read this application/permit and state that the information on all pages of this document is correct. I agree to comply with all City and County ordinances and State laws relating to building construction, and hereby authorize representatives of this City and County to enter upon the above mentioned property for inspection purposes.																														
<input checked="" type="checkbox"/> Applicant's Signature																														
Print Name <u>PAUL BROWN</u> Date <u>6-18-13</u>																														

This is a building permit when properly filled out, signed and validated, and is subject to expiration if work thereunder is suspended for 180 days.

Permit Type: PLUMB

ORIGINAL

ELECTRICAL PERMIT

INSPECTION RECORD

FEES

For Applicant to Fill in

SINGLE PHASE SERVICE SIZE <input type="checkbox"/> UG <input type="checkbox"/> OH		IF NOT LISTED BELOW SEE CODE		NO.	EA.	FEES	ADDRESS										
THREE PHASE SERVICE SIZE <input type="checkbox"/> 3 Wire <input checked="" type="checkbox"/> 4 Wire <input type="checkbox"/> UG <input type="checkbox"/> OH 200 AMP 480V 3757 RIG. CONDUIT		Residential (R-1 & R-3) sq. ft.					7390 HUNT AVE										
APPROVAL		DATE		INSPECTOR			LOT NO.		BLK NO.		TRACT NO.		ELECTRIC PERMIT NO.				
Underground							OWNER		PHONE		514		8977543				
Conduit							OWNER'S ADDRESS		CITY		Tom Bracon		Jim Chan				
Wiring - Rough		2-14-86		Ⓟ			NEW BUILDING OR ADDITION - AREA		EXISTING BUILDING REMODEL AREA		OCCUPANCY GROUP		USE OF BUILDING AND OR NUMBER OF UNITS				
Heater							SQ. FT.		SQ. FT.								
Fixtures & Trim							VALIDATION				WES-NESEN		Brown-NESEN				
Motors							ELECTRICAL CONTRACTOR		STATE LIC. NO. & TYPE		James Electric		450534				
Room # 107 - TO BE WIRED UNDER SEPARATE PERMIT - NOT THIS ELEC. CONTRACTOR - 3-17-86 - M.E. Butler		Washer		1		3-		3		-		ADDRESS		CITY		PHONE	
		Dryer		1		3-		3		-		24976 SARA LN.		LAGUNA HILLS		7685144	
		Hot Water Heaters		1		3-		3		-							
		Dishwasher															
		Domestic Range or Oven															
		Disposal															
		Power Apparatus—H.P., K.W. or K.V.A. Motors, Transformers, etc.															
		Not Over 1 each															
		Over 1, Not Over 10 each		3		5 ⁰⁰		16		50							
		Over 10, Not Over 30 each															
Indv. Circuits																	
Time Clock																	
Sign																	
Sign Hookup																	
Utility																	
Service																	
FINAL		3-17-86		K													
Utility Notified																	
IDENTIFICATION CODE																	
BUILDING PERMIT NO.		SIGN PERMIT NO.		VENT. HEAT. AIR COND. PERMIT NO.													
TOTAL FEES						323.32											
LAND USE		AUTHORIZED BY		BUILDING		DATE											
		M. E. Butler		2-13-86													
* If work is not started within 180 days from date of issue or if abandoned for more than 180 days, this permit will be null and void.																	

A FEE MAY BE CHARGED FOR RE-INSPECTION DUE TO NEGLIGENCE, INCOMPLETE WORK, OR FAILURE TO MAKE CORRECTIONS.

CITY OF GARDEN GROVE
Public Works & Development

ELECTRICAL PERMIT

Inspection Requests
638-6771

General Information
638-6661

INSPECTION RECORD

FEES

For Applicant to Fill in

SINGLE PHASE SERVICE SIZE UG OH
 AMPS VOLTS RIG. CONDUIT
 THREE PHASE SERVICE SIZE 3 Wire 4 Wire UG OH
 AMPS VOLTS RIG. CONDUIT

IF NOT LISTED BELOW SEE CODE	NO.	EA.	FEE
Residential (R-1 & R-3) sq. ft.			
Garage, Resid. (M) sq. ft.			
Service Meter, Single Phase			
Service Meter, Three Phase			
Add'l Meter, Three Phase			
Temporary Power Pole			
Pole, Power, Light, etc.			
Sub-Panels 1 φ			
Sub-Panels 3 φ			
Outlets	14.00		7.00
Fixtures	15.00		7.50
Fixtures, Merc. Quartz, etc.			
Heater—Not Over 1650 W			
Washer			
Dryer			
Hot Water Heaters			
Dishwasher			
Domestic Range or Oven			
Disposal			
Power Apparatus—H.P., K.W. or K.V.A. Motors, Transformers, etc.			
Not Over 1 each			
Over 1, Not Over 10 each			
Over 10, Not Over 30 each			
Indv. Circuits			
Time Clock			
Sign			
Sign Hookup			

ADDRESS
7390 HUNT AVE.
 LOT NO. BLK NO. TRACT NO. ELECTRIC PERMIT NO. 1448004

OWNER
AARON THOMAS Co. PHONE 597-5553

OWNER'S ADDRESS
SAME CITY

NEW BUILDING OR ADDITION AREA SQ. FT. EXISTING BUILDING REMODEL AREA SQ. FT. OCCUPANCY GROUP USE OF BUILDING AND OR NUMBER OF UNITS

VALIDATION
APPROVED 3/18/86

ELECTRICAL CONTRACTOR
Cook Electric Inc STATE LIC. NO. & TYPE 350473

ADDRESS
3915 CASSA ST. CITY N.P. BEACH PHONE 760 9612

WORKER'S COMPENSATION REQUIREMENTS
 State Compensation Insurance Policy No. 453586 Expiration Date AUG 86
 I certify that in the performance of the work for which this permit is issued, I shall not employ any person in any manner so as to become subject to the Worker's Compensation laws of California.
 NOTE: If, after making such certificate, the applicant for the permit should become subject to the Worker's Compensation provisions of this code, he shall forthwith comply with the provisions of Section 3700 or his permit shall be deemed revoked.
 I certify that I have read this application and state that the above information is correct. I agree to comply with all City ordinances and State laws relating to pending construction. I further agree to hold the City of Garden Grove harmless from any liability arising out of injury or property damage resulting from work performed pursuant to this permit.
 HUNT [Signature] DATE 3/18/86

BUSINESS TAX CERTIFICATE INFORMATION
 I certify that the following Contractor's License No. 350473 and Classification C-10 is in full force and effect. 3/18/86

(PRINT) CONTRACTOR (SIGNATURE) CONTRACTOR OR AUTHORIZED AGENT DATE

BUSINESS TAX CERTIFICATE NO. EXPIRATION DATE
 I certify that I am exempt from Section 7031.5 of the Business and Professional Code, Division 3, Chapter 9, Contractors' License Law, under the following Section:
 Owner: Section 7044 Minor work under \$200: Section 7048 Employee working for wages only: Section 7053

Other:
 (PRINT) PROPERTY OWNER (SIGNATURE) PROPERTY OWNER OR AUTHORIZED AGENT DATE

A FEE MAY BE CHARGED FOR RE-INSPECTION DUE TO NEGLIGENCE, INCOMPLETE WORK, OR FAILURE TO MAKE CORRECTIONS.

APPROVAL	DATE	INSPECTOR
Underground		
Conduit		
Wiring - Rough		
Heater		
Fixtures & Trim		
Motors		
User		
Service		

FINAL 3-18-86 [Signature]
 Utility Notified

IDENTIFICATION CODE

BUILDING PERMIT NO. SIGN PERMIT NO. VENT, HEAT, AIR COND. PERMIT NO.

If work is not started within 180 days from date of issue or if abandoned for more than 180 days, this permit will be null and void.

ITEM	CODE	FEES
Plan Retention Fee		
Plan Check		
Permit		14.50
Issuance		10.00
TOTAL FEES		24.50

AUTHORIZED BY [Signature] DATE 3-18-86
 LAND USE BUILDING DATE

PLUMBING PERMIT

INSPECTION RECORD

FEES

For Applicant to Fill

APPROVALS	DATE	INSPECTOR	TYPE OF FIXTURE OR ITEM	NO.	EACH	\$ FEE
Soil Piping	1/27/86	ERK	Water Closet (toilet)	10	4.50	45.00
Ground Plumbing			Bath Tub			
Rough Plumbing	2/13/86	ERK	Shower	1	4.50	4.50
Gas Piping			Lavatory (Wash Basin)	7	4.50	31.50
Gas Vent			Kitchen Sink			
Sewer			Garbage Disposal			
Man Drain and Vacuum Lines			Laundry Tub or Tray			
Water Heater			Water Heater			
Backwash			Floor Sink	3	4.50	13.50
Water Lateral			Floor Drain	2	4.50	9.00
			Dish Washer			
			Drinking Fountain			
			Urinal	1	4.50	4.50
			Gas System - Outlets			
			Building Sewer (First 100 ft.)			
			Building Sewer (Adj. 100 ft.)			
			Building Sewer (ex. add'l drain)			
			Rainwater Drain			
			Swimming Pool Piping			
			Sand Traps/Receptors			
			Automatic Washing Machine	1	4.50	4.50
			Water Softeners			
			Backwash - Trap			
			Water Lateral			
			Backflow Protective Devices			
			Water Piping (tra. 100 ft.)			
			Lawn Sprinklers (S.F. @ 1/2")			
			Lawn Sprinklers (other)			
FINAL	3/24/86	ERK				
UTILITY CO. NOTIFIED						
IDENTIFICATION CODE			ITEM	CODE		FEES
			Plan Reception Fee			76.50
			Plan Check			172.50
			Permit			10.00
			Issuance			
			TOTAL FEES			199.00
BUILDING PERMIT NO.	ELECTRICAL PERMIT NO.		LAND USE	AUTHORIZED BY (SIGNATURE)	DATE	
144279A				JPK	1-27-86	

ADDRESS: 7390 HUNT (DIAWA BUILDING)
 LOT NO. BLOCK NO. TRACT NO. PERMIT ID:
 OWNER: DIAWA CORP 8956645
 7421 CHAPMAN CG
 5000.00
 PLUMBING CONTRACT PRICE: \$29965
 ADDRESS: 7252 GARDEN GROVE WEST
WORKER'S COMPENSATION REQUIREMENTS
 State Compensation Insurance Policy No. 416 321311 Expiration Date 1-1-87
 I certify that in the performance of the work for which this permit is issued, I shall not employ any person in any manner so as to become subject to the Worker's Compensation laws of California.
NOTE: If, after making such certificate, the applicant for the permit should become subject to the Worker's Compensation provisions of this code, he shall forthwith comply with the provisions of Section 3700 or his permit shall be deemed revoked.
 I certify that I have read this application and state that the above information is correct. I agree to comply with all City or Finance and State laws relating to pending construction. I further agree to hold the City of Garden Grove harmless from any liability arising out of injury or property damage resulting from work performed relevant to this permit.
 SIGNATURE: [Signature] DATE: 1-24-86
BUSINESS TAX CERTIFICATE INFORMATION
 I certify that the following Contractor's License No. SOIL HESS and Classification PLUMBER is in full force and effect.
 (PRINT) CONTRACTOR: [Signature] (SIGNATURE) CONTRACTOR OR AUTHORIZED AGENT: [Signature] DATE: [Date]
 BUSINESS TAX CERTIFICATE NO. [Number] EXPIRATION DATE: [Date]
 I certify that I am exempt from Section 7031.5 of the Business and Professions Code, Division 3, Chapter 9, Contractors' License Law, under the following Section:
 Owner-Built on 7044 Minor work under \$200 Section 7040
 Employed working for wages only - Section 7033
 Other: _____
 (PRINT) PROPERTY OWNER (SIGNATURE) PROPERTY OWNER OR AUTHORIZED AGENT: [Signature] DATE: [Date]
 ALL FEES MUST BE PAID UPON RECEIPT OF PERMIT. NO WORK SHALL BE PERFORMED UNTIL ALL FEES ARE PAID IN FULL. INCOMPLETE WORK SHALL BE SUBJECT TO STOPPING AND REMOVAL.

HEATING, VENTILATING, REFRIGERATION & AIR COND. PERMIT

INSPECTION RECORD

FEES

For Applicant to Fill in

APPROVALS	DATE	INSPECTOR	TYPE OF FIXTURE OR ITEM	NO.	EA.	\$ FEE	ADDRESS			
FURNACE			Furnace to & incl. 100M B.T.U.				7390 HUNT			
FURNACE VENTS			More than 100M & incl. 500M B.T.U.				LOT NO. BLK NO. TRACT NO. PERMIT NO.			
GAS PIPING			More than 500M & incl. 1MM B.T.U.				OWNER			
DUCTS	3/3/86	EJA	Installation or Relocation of Susp. Heater				DAIWA CORP.			
SINGLE DUCT FAN VENT			Installation or Relocation of Wall Heater				OWNER'S ADDRESS			
KITCHEN HOOD			Installation or Relocation of Unit Heater				7390 HUNT GARDEN GROVE			
AIR HANDLING UNIT			Installation of Appliance Vent Only				NEW BUILDING OR ADDITION - AREA			
EVAPORATIVE COOLER			Repair, Alteration or Addition to any Heating or Cooling System				EXISTING BUILDING REMODEL AREA			
BOILER OR COMPRESSOR			Incidental Gas Piping				OCCUPANCY GROUP			
DECORATIVE APPLIANCE			Each Range Hood incl. Duct and Fan				USE OF BUILDING AND OR NUMBER OF UNITS			
			Each Vent Fan Connected to a Single Duct				Office & CLEAN RM.			
			Each Ventilating System not a Part of a Heating or Air Conditioning System Authorized by Permit	10	50	65.00	VALIDATION			
			Boiler (Compressor) to & incl. 5 Hp.	3	6.50	19.50	HEATING CONTRACTOR			
			Absorption System to & incl. 100M B.T.U.				CHUCK AIR COND			
			Boiler (Compressor) to & incl. 15 Hp.	1	12.00	12.00	STATE LIC. NO. & TYPE			
			Absorption System to & incl. 500M B.T.U.				329676			
			Boiler or Compressor to & incl. 30 Hp.				ADDRESS			
			Absorption System to & incl. 1MM B.T.U.				807E. COOLIDGE ST CITY			
			Boiler or Compressor to & incl. 50 Hp.				LONG BEACH, CA			
			Absorption System to & incl. 2MM B.T.U.				PHONE			
			Boiler or Compressor over 50 Hp.				213-			
			Each Evaporative Cooler				423-5813			
			Air Handling Unit to & incl. 2M C.F.M.	3	5.00	15.00	WORKER'S COMPENSATION REQUIREMENTS			
			Air Handling Unit to & incl. 10M C.F.M.				State Compensation Insurance Policy No. 544716-18-86			
			Air Handling Unit over 10M C.F.M.				Expiration Date			
			OTHER:				<input type="checkbox"/> I certify that in the performance of the work for which this permit is issued, I shall not employ any person in any manner so as to become subject to the Worker's Compensation laws of California. NOTE: If, after making such certificate, the applicant for the permit should become subject to the Worker's Compensation provisions of this code, he shall forthwith comply with the provisions of Section 3700 or his permit shall be deemed revoked. <input checked="" type="checkbox"/> I certify that I have read this application and state that the above information is correct. I agree to comply with all City ordinances and State laws relating to pending construction. I further agree to hold the City of Garden Grove free and harmless from any liability arising out of injury or bodily damage resulting from work performed relevant to this permit. Chuck Dodd 2/18/86 PERMIT APPLICANT SIGNATURE DATE			
FINAL	3/12/86	EJA					BUSINESS TAX CERTIFICATE INFORMATION			
UTILITY CO. NOTIFIED							I certify that the following Contractor's License No. 329676 and Classification C-10 is in full force and effect.			
IDENTIFICATION CODE			ITEM	CODE	FEES		CHUCK DODD Chuck Dodd 2/18/86			
			Plan Retention Fee				(PRINT) CONTRACTOR (SIGNATURE) CONTRACTOR OR AUTHORIZED AGENT DATE			
			Plan Check				SR-ADA 1L-664962			
			Permit		11.50		BUSINESS TAX CERTIFICATE NO. EXPIRATION DATE			
			Issuance		10.00		I certify that I am exempt from Section 7031.5 of the Business and Professional Code, Division 3, Chapter 9, Contractors' License Law, under the following Section:			
			TOTAL FEES			121.50	Owner: Section 7044 <input type="checkbox"/> Minor work under \$100: Section 7048 <input type="checkbox"/>			
							Employee working for wages only: Section 7053 <input type="checkbox"/>			
							Other: _____			
							(PRINT) PROPERTY OWNER (SIGNATURE) PROPERTY OWNER OR AUTHORIZED AGENT DATE			
			LAND USE	BUILDING	DATE		A FEE MAY BE CHARGED FOR RE-INSPECTION DUE TO NEGLIGENCE, INCOMPLETE WORK, OR FAILURE TO MAKE CORRECTIONS.			
							2-18-86			

If work is not started within 120 days from date of issue or if abandoned for more than 120 days, this permit will be null and void.

I. INSPECTOR

INSPECTION RECORD

For Applicant to Fill in

OCCUPANCY USE ZONE	TYPE	OCC. LOAD		FIRE SPRINK		APPROVAL	DATE	INSPECTOR
		FRONT	LEFT	RIGHT	REAR			
PLANNING ACTION	Evil Proj					FOUNDATION & LOCATION		
LAND USE APPROVED BY	Setbacks					CONCRETE FLOOR		
REMARKS:						REINFORCING		
						ROOF SHTG		
						ROUGH FRAME		
						INSULATION ENERGY		
						LATH OR DRYSWALL		
						PLAS BROWN ET		
						SOUND INSULATION		
						SMOKE DETECTOR		
						PARKING		
						LANDSCAPE		
LA. SANT. DIS. FEE REQ'D.	O.C. SANT. DIS. FEE REQ'D.	DATE	INITIAL	REQ'D	PROVIDED			
PARCEL MAP						LAND USE FINAL		
R/W DEDICATION						FINAL	10-31-86	GM
FEES AND BONDS						LT. CITY RELEASE		
	REV. CODE	AMOUNT				IDENTIFICATION CODE		
ST. BOND								
WATER BOND								
WATER ASSMT FEE ACRO								
WATER ASSMT FEE FT								
PARKWAY TREE FEE								
PARK & REC FEE DIST								
DRAIN ASSMT FEE DIST								
PLAN RETENT. FEE								
BLDG PLAN CHECK		51.00						
BLDG PERM. FEE		34.30						
ISSUANCE		10.00						
VALUATION		4516.00						
TOTAL FEES							95.34	

ADDRESS	7390 HUNT AVE.		
LOT NO	BCK NO	TRCKY NO	TRK NO
			170487A
OWNER	DAIWA		
MAILING ADDRESS	CITY	ZIP	
	7421 CHAPMAN AVE. GG		
	<input type="checkbox"/> ARCH	<input type="checkbox"/> ENCR	
MAILING ADDRESS	CITY	ZIP	
TEL. NO.	STATE LIC. NO. & TYPE		
	362599 / C-16		
VALIDATION			
CONTRACTOR			
PYRO AUTOMATIC			
MAILING ADDRESS	CITY	ZIP	
	1863 N. NEVILLE ORANGE 92665		
TEL. NO.	STATE LIC. NO.		
	637-7622	362599	
PRESENT BLDG. USE	PROPOSED BLDG. USE		
	OFFICE		
DESCRIBE WORK TO BE DONE			
FIRESPRINKLER INSTALLATION			
NEW	<input checked="" type="checkbox"/> ALTER	<input type="checkbox"/> REPAIR	<input type="checkbox"/> DEMOLITION
BLDG. AREA	NO. OF STORIES	NO. OF DWELLING UNITS	
SQ. FT. 5810	STORIES 2	UNITS 0	
PERMITS MAY BE CHARGED FOR ALL INSPECTIONS AND FEES IN EXCESS OF COMPLETE WORK OR FAILURE TO MAKE CORRECTIONS			
RELOCATION			
PERMITS MAY BE CHARGED FOR ALL INSPECTIONS AND FEES IN EXCESS OF COMPLETE WORK OR FAILURE TO MAKE CORRECTIONS			
ADDRESS			

WORKER'S COMPENSATION REQUIREMENTS

State Compensation Insurance Policy No. 40-0295-84-S effective on Date 10-31-86 JSF/EG

I certify that in the performance of the work for which this permit is issued, I shall not employ any person in any manner so as to become subject to the Workers' Compensation Laws of the State of California.

NOTE: If other laws apply, the applicant shall file the appropriate forms with the State Compensation Insurance Fund in compliance with the provisions of Section 10300 of the Labor Code. Failure to do so shall constitute a violation of the permit.

I certify that I have read this application and state that the above information is correct. I agree to comply with all City ordinances and State laws relating to pending construction. I further agree to hold the City of Garden Grove harmless from any liability arising out of injury or bodily damage resulting from work performed hereunder.

John Michael 2-14-86

BUSINESS TAX CERTIFICATE INFORMATION

I certify that the following Contractor's License No. 362599 and Pyro Auto is in full force and effect.

PRINTED CONTRACTOR SIGNATURE: John Michael DATE: 2-14-86

219994

BUSINESS TAX CERTIFICATE INFORMATION

I certify that I am exempt from Section 7031.5 of the Business and Professions Code, Chapter 9, Contractors' License Law, under the following conditions:

Owner: DAIWA Major work under \$100, Section 7048

Employee wages only: Section 7055

Other: _____

(PRINT) PROPERTY OWNER SIGNATURE: _____ DATE: _____

OR AUTHORIZED AGENT

L. INSPECTOR

BUILDING PERMIT

Inspection Requests
638-6771

General Information
638-6661

INSPECTION RECORD

For Applicant to Fill in

F.C. # _____

OCUPANCY B2 TYPE VN OCC. LOAD YES	FRONT	LEFT	RIGHT	REAR
USE ZONE PUD	Eav Proj.			
FIRE ZONE ---	Setbacks NO CHANGE			
PLANNING ACTION NONE	DATE 1-27-86 PLANS PROVIDED			
LAND USE APPROVED BY JPS	REMARKS:			
G.G. SANT. DIS. FEE REQ'D.	O.C. SANT. DIS. FEE REQ'D.	DATE	INITIAL	
PARCEL MAP	REQ'D	PROVIDED		
R/W DEDICATION	LAND USE FINAL			
FEES AND BONDS				
	REV. CODE	AMOUNT		
ST. BOND				
WATER BOND				
WATER ASSMT. FEE (ACRG.)				
WATER ASSMT. FEE (FT.)				
PARKWAY TREE FEE				
PARK & REC. FEE (DIST.)				
DRAIN ASSMT. FEE (DIST.)				
PLAN RETENTION FEE		45 65		
BLDG. PLAN CHECK		345 44		
BLDG. PERMIT FEE		517 10		
ISSUANCE		10 00		
VALIDATION				
\$ 130000.00	TOTAL FEES	918 19		
AUTHORIZED BY JPS	DATE	1-27-86		

APPROVAL	DATE	INSPECTOR
FOUNDATION & LOCATION	1/29/86	
CONCRETE FLOOR		
REINFORCING		
ROOF SHTG		
ROUGH FRAME	2/14/86	
INSULATION, ENERGY		
LATH OR DRYWALL	2/24/86	
PLAS. BROWN CT.		
SOUND INSULATION		
SMOKE DETECTOR		
PARKING		
LANDSCAPING		
LAND USE FINAL		
FINAL		
UTILITY RELEASE		
IDENTIFICATION CODE		

EP 1/3/86

WORKER'S COMPENSATION REQUIREMENTS

State Compensation Insurance Policy No. _____ Expiration Date _____

I certify that in the performance of the work for which this permit is issued, I shall not employ any person in any manner so as to become subject to the Worker's Compensation laws of California.

NOTE: If, after making such certificate, the applicant for the permit should become subject to the Worker's Compensation provisions of this code, he shall forthwith comply with the provisions of Section 3700 or his permit shall be deemed revoked.

I certify that I have read this application and state that the above information is correct. I agree to comply with all City ordinances and State laws relating to pending construction. I further agree to hold the City of Garden Grove free and harmless from any liability arising out of injury or bodily damage resulting from work performed pursuant to this permit.

PERMIT APPLICANT SIGNATURE _____ DATE **1-27-86**

BUSINESS TAX CERTIFICATE INFORMATION

I certify that the following Contractor's License No. _____ and Classification _____ is in full force and effect.

(PRINT) CONTRACTOR **BROWN** (SIGNATURE) CONTRACTOR OR AUTHORIZED AGENT _____ DATE _____

BUSINESS TAX CERTIFICATE NO. _____ EXPIRATION DATE _____

I certify that I am exempt from Section 7031.5 of the Business and Professional Code, Division 3, Chapter 9, Contractors' License Law, under the following Section:

Owner: Section 7044 Minor work under \$200: Section 7048
Employee working for wages only: Section 7053

Other: _____

(PRINT) PROPERTY OWNER (SIGNATURE) PROPERTY OWNER OR AUTHORIZED AGENT _____ DATE _____

ADDRESS 1390 HUNT (ADJACENT BUILDING)			
LOT NO.	BLK NO.	TRACT NO.	PERMIT NO. 1442704
OWNER DINA CORP.		TEL. NO. 895-6645	
MAILING ADDRESS 7421 CHAPMAN G.G.		CITY --- ZIP ---	
<input type="checkbox"/> ARCH <input checked="" type="checkbox"/> ENGR. ROBERT PARLEE			
MAILING ADDRESS 2662 E. 20TH SIGNAL HILL		CITY --- ZIP ---	
TEL. NO. 213 294-2662	STATE LIC. NO. & TYPE CE 10046		
VALIDATION			
		2-PLAN	345.44
		8-PER	517.10
		ISS	10.00
		1#7143A 1-27'86	CHECK 918.19
CONTRACTOR BROWN-NESEER CONST.			
MAILING ADDRESS 18383 ENTERPRISE LN.		CITY --- ZIP ---	
TEL. NO. 714 847-1976	STATE LIC. NO. 395857		
PRESENT BLDG. USE WAREHOUSE	PROPOSED BLDG. USE WAREHOUSE		
DESCRIBE WORK TO BE DONE TENANT IMPROVEMENT OFFICE (END STORY)			
NEW <input type="checkbox"/> ADD'N <input type="checkbox"/> ALTER. <input type="checkbox"/> REPAIR <input type="checkbox"/> DEMOLISH <input type="checkbox"/>			
FLOOR AREA (SQ. FT.) 5000	NO. OF STORIES 2	NO. OF DWELLING UNITS 0	
If work is not started within 180 days from date of issue or if abandoned for more than 180 days, this permit will be null and void.			
A FEE MAY BE CHARGED FOR RE-INSPECTION DUE TO NEGLIGENCE, INCOMPLETE WORK, OR FAILURE TO MAKE CORRECTIONS.			
RELOCATION			
PRESENT BLDG. ADDRESS _____			
MOVING CONTRACTOR _____			
ADDRESS _____			

CITY OF GARDEN GROVE

PLOT PLAN

PUBLIC WORKS & DEVELOPMENT 1

OWNER DIANA CORP.	JOB ADDRESS 7390 HUNT G.G.			PERMIT NO. 144279A
NAME OF CONSTRUCTION LENDER & BRANCH LOUE	ASSESSORS PARCEL NO. 131-651-2930	LOT	BLOCK	TRACT
	PLEASE CHECK ONE OR MORE <input type="checkbox"/> New <input checked="" type="checkbox"/> Addition <input checked="" type="checkbox"/> Alteration <input type="checkbox"/> Repair <input type="checkbox"/> Move <input type="checkbox"/> Demolish			
ADDRESS	CITY	DATE 1.27.86	JOB DESCRIPTION TENANT IMP. (2ND STORY)	PERMIT VALUE \$130000.00

SHOW NORTH ARROW, PROPERTY LINES AND ADJACENT STREETS.

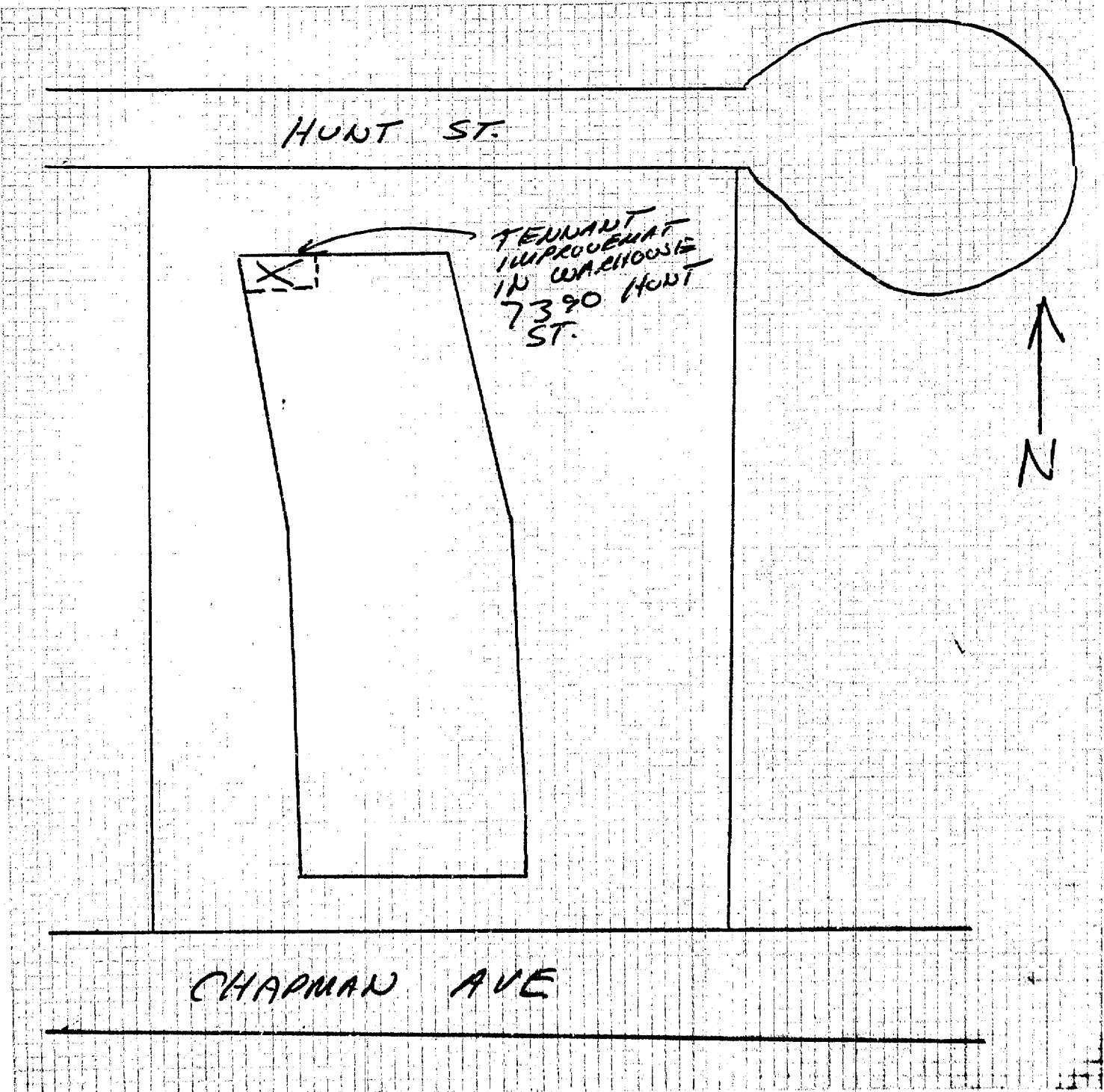

#1 Building Insp./#2 Assessor/#3 Permittee/#4 File
I certify the information hereon is complete and correct.

PLOT PLAN APPROVED BY _____

By _____