

# BUILDING PERMIT

Department of Building **CITY OF GARDEN GROVE**  
 BERNARD C. ADAMS, Director

## ZONING AND BUILDING

Use Zone <b>R-3</b>	Main Use <b>Apts.</b>	Acc. Use <b>-</b>	Var. No. <b>SP105-62</b>
St. Set Back - <b>10'</b>	PL		
Side Yard <b>15'</b>	Projection		
Side Yard <b>55'</b>	Projection		
Rear Yard <b>35'</b>	Stories <b>1</b>	Parking Req'd. <b>6</b>	
Zoning Approved By		Date	
Group	Type	Plan Ck.	
Remarks:			

## INSPECTION RECORD

APPROVAL	DATE	INSPECTOR
Foundation and Location		
Reinforcing		
Roof Shig.		
Rough Frame		
Lath or Drywall		
Plas. Brown Ct.		
Other		
Land Use		
Final	<b>8-19-62</b>	<b>[Signature]</b>
Utility Release	<b>8-31-62</b>	<b>[Signature]</b>

FEES		
Plan Check	<b>\$51.50</b>	Building Permit
Bonds	<b>\$</b>	Expiration Date
		<b>\$103.00</b>

Permit Authorized By **[Signature]** Date **5-18-62**

Routing: #1 Bldg. Director #2 Office File #3 Statistics #4 Owner

#1 copy sent

For Applicant to Fill in (USE INK) **PC 7302**  
 Job Address **15713 - 15713** Permit No. **18781**  
**15713** - **A-B-C-D**

Lot No. Tract No. Blk No.  
 Please Attach Meters & Bounds (2 Copies)

Owner **Calco Land & Development Co., Inc.**  
 Owner's Address **811 N. Broadway, Santa Ana**

Description of Work New  Add'n  Remodel  Relocate   
 Use of Building **Multiple Unit - 4 Units**  
 Area of Building **4140 sq. ft.** Valuation **\$35000**

Validation  
 Arch. or Engr. **Mendez** Address **2537 S. Main, Santa Ana**

Contractor **Calco-Ralph Evey** Phone **EL 7-7669**  
 Address **811 N. Broadway, Santa Ana**

I hereby acknowledge that I have read this application and state that the above is correct and agree to comply with all ordinances and State laws regulating building construction.  
 I hereby certify that I am properly registered with and/or licensed as required by the City of Garden Grove and/or State of California, or that I am the legal owner of the above described property, and I certify that in the performance of the work for which this permit is issued I shall not employ any person in violation of the workmen's compensation laws of the State of California.  
 Signature of Permittee **Robert Balon** Date **4/16/62**  
 Lic. No.

Address **811 N. Broadway, Santa Ana**  
**RELOCATION**

PRESENT BLDG. ADDRESS  
 MOVING CONTRACTOR ADDRESS

## PUBLIC WORKS

Street Address	REQUIRED	PROVIDED
<b>OK</b>		
Record of Survey	<b>No</b>	
R/W Dedication	<b>Yes</b>	<b>yes</b>
Bonds	<b>Yes</b>	<b>yes</b>
Encroachment Permit	<b>No</b>	<b>yes</b>

Remarks

# PLUMBING PERMIT

Department of Building  
 B. C. Adams  
 Director IE 7-4200

CITY OF  
 GARDEN GROVE

For Applicant to Fill in (Use Int)

Job 13923 Permit No. 25792  
 Address 1244 ERIN ABCD

### PERMIT FEES

No.	TYPE OF FIXTURE OR ITEM	EACH	\$	FOR
12	Water Closet (Toilet)	\$1.00	12	-
8	Bath Tub	1.00	8	-
4	Shower	1.00	4	-
12	Lavatory (Wash Basin)	1.00	12	-
8	Kitchen Sink	1.00	8	-
8	Garbage Disposal	1.00	8	-
	Laundry Tub or Tray	1.00		
8	Water Heater	1.50	12	-
	Slop Sink	1.00		
	Floor Sink	1.00		
	Floor Drain	1.00		
	Dish Washer	1.00		
	Drinking Fountain	1.00		
	Urinal	1.00		
4	Gas System <sup>3</sup> / <sub>4</sub> Outlets	1.00	4	40
	House Sewer	1.00		
	Lawn Sprinklers	2.00		
	Swimming Pool Piping	1.00		
	Sand Traps	1.00		
	Automatic Washing Mach.	1.00		
	Water Softeners	1.50		
	Backwash	1.50		

Lot No. \_\_\_\_\_ Tract No. \_\_\_\_\_ Blk. No. \_\_\_\_\_

Owner Calco Development

Owner's Address 811 N. BROADWAY, S.A.

Plumbing Contractor 20th CENTURY P.B.E.

Contractor's Address 11546 S.L.A., ORANGE

Phone ME 89601 City Lic. No. \_\_\_\_\_

Use of Bldg. DWELLING

New Bldg.  Old Bldg.

Validation MAY 21-62 11 034 W\*\*\*75.10

I hereby acknowledge that I have read this application and state that the above is correct and agree to comply with all ordinances and State laws regulating plumbing.

I hereby certify that I am properly registered with and/or licensed as required by the City of Garden Grove and/or State of California, or that I am the legal owner of the above described property, and I certify that in the performance of the work for which this permit is issued I shall not employ any person in violation of the workmen's compensation laws of the State of California.

Signature of Permittee B.J. Smith Date May 18, 1962

Address \_\_\_\_\_

APPROVALS	DATE	INSPECTOR
SOIL PIPING	<u>5-24-62</u>	<u>[Signature]</u>
GROUND PLUMBING	<u>5-29-62</u>	<u>[Signature]</u>
ROUGH PLUMBING	<u>6-21-62</u>	<u>[Signature]</u>
GAS PIPING		
GAS VENT		
SEPTIC TANK or Cesspool		
SEWER		
GAS TEST		
MAIN DRAIN AND VACUUM LINES		
WATER HEATER		
BACKWASH		
FINAL	<u>9-22-62</u>	<u>[Signature]</u>
UTILITY CO. NOTIFIED	<u>AUG 3 1962</u>	<u>[Signature]</u>

Issuance of Permit 2 00

TOTAL FEE 115.40 \$ 75.40

Permit Authorized By CR Date 5-28-62

Routing: #1 Plumbing Inspector #2 Office File #3 Owner Bldg. Permit # 18781

# PLUMBING PERMIT

Department of Building  
B. C. Adams  
Director JE 7-4200

CITY OF  
GARDEN GROVE

For Applicant to Fill In (Use Ink)

Job 13923 Cabin Permit No. \_\_\_\_\_  
Address CAICO APTS 27817  
Lot No. \_\_\_\_\_ Tract No. \_\_\_\_\_ Blk. No. \_\_\_\_\_

## PERMIT FEES

No.	TYPE OF FIXTURE OR ITEM	EACH	\$	FEE
	Water Closet (Toilet)	\$1.00		
	Bath Tub	1.00		
	Shower	1.00		
	Lavatory (Wash Basin)	1.00		
	Kitchen Sink	1.00		
	Garbage Disposal	1.00		
	Laundry Tub or Tray	1.00		
	Water Heater	1.50		
	Stop Sink	1.00		
	Floor Sink	1.00		
	Floor Drain	1.00		
	Dish Washer	1.00		
	Drinking Fountain	1.00		
	Urinal	1.00		
	Gas System — Outlets	1.00		
	House Sewer	1.00		
7	Lawn Sprinklers	2.00	14	00
	Swimming Pool Piping	1.00		
	Sand Traps	1.00		
	Automatic Washing Mach.	1.00		
	Water Softeners	1.50		
	Backwash	1.50		

Owner Calico Land & Development  
Owner's Address 13923 Cabin  
Plumbing Contractor Site Development Co.  
Contractor's Address 2334 W. Santa Ana St. Santa Ana Calif  
Phone 542-1091 City Lic. No. \_\_\_\_\_

Use of Bldg. \_\_\_\_\_  
New Bldg.  Old Bldg.   
Validation OCT 30-62 11 054 M\*\*\*16.00

I hereby acknowledge that I have read this application and state that the above is correct and agree to comply with all ordinances and State laws regulating plumbing.  
I hereby certify that I am properly registered with and/or licensed as required by the City of Garden Grove and/or State of California, or that I am the legal owner of the above described property, and I certify that in the performance of the work for which this permit is issued I shall not employ any person in violation of the workmen's compensation laws of the State of California.

Signature of Permittee William H. Hines Date Oct 30-1962

APPROVALS	DATE	INSPECTOR
SOIL PIPING		
GROUND PLUMBING		
ROUGH PLUMBING		
GAS PIPING		
GAS VENT		
SEPTIC TANK or Cesspool		
SEWER		
GAS TEST		
MAIN DRAIN AND VACUUM LINES		
WATER HEATER		
BACKWASH		
FINAL		
UTILITY CO. NOTIFIED		

Issuance of Permit \_\_\_\_\_ 2 00  
TOTAL FEE \$ 16 00

Permit Authorized By R. G. Adams Date 10-30-62

Routing: #1 Plumbing Inspector #2 Office File #3 Owner Bldg. Permit # \_\_\_\_\_

# HEATING, VENTILATION, REFRIGERATION & AIR CONDITIONING PERMIT

1

DEPARTMENT OF BUILDING  
B. C. ADAMS - DIRECTOR  
JES 7-4222

CITY OF  
GARDEN GROVE

FOR APPLICANT TO FILL IN (USE INK)

JOB ADDRESS 13923  
17042 Erin ABCD

PERMIT NO.

1512

PERMIT FEES #168

NUMBER	TYPE OF FIXTURE OR ITEM	EACH	FEE
6	FURNACE	\$1.00	6 -
8	WARM AIR OUTLET	.25	2 -
6	FURNACE VENTS	1.00	6 -
	GAS PIPING _____ OUTLETS	1.00	
	MISC. APPLIANCES	1.00	
	COMMERCIAL HEATING	2.00	
	COMMERCIAL WARM AIR OUTLETS	.50	
	COMMERCIAL FURNACE VENTS	2.00	
	EXHAUST OUTLETS	1.00	
	REPAIR, ALTERATION OR ADDITION TO HEATING SYSTEM	1.00	
	VENTILATION SYSTEM	3.00	
	RESTAURANT KITCHEN HOOD	3.00	
	CONDENSING UNIT 20 H.P. OR LESS	2.00	
	CONDENSING UNIT TO 50 H.P.	5.00	
	CONDENSING UNIT OVER 50 H.P.	10.00	
	REPAIR OR ALTERATION TO REFRIGERATION SYSTEM	3.00	
	EVAPORATIVE COOLERS	1.00	
	ISSUANCE OF PERMIT		1 00
	<b>TOTAL FEE</b>	\$	<u>15 -</u>

LOT NO. \_\_\_\_\_ TRACT NO. \_\_\_\_\_

OWNER Calco Development

OWNER'S ADDRESS 811 N. Broadway, Santa Ana

CONTRACTOR 20th Century Plbg. Co., Inc.

CONTRACTOR'S ADDRESS 11546 S. Los Angeles, Orange

PHONE KE8-9601 CITY LIC. NO. \_\_\_\_\_

USE OF BUILDING Res.

NEW BUILDING  OLD BUILDING

VALIDATION JUN 22-62 11 097 W\*\*\*\*15.00

I hereby acknowledge that I have read this application and state that the above is correct and agree to comply with all ordinances and State laws regulating plumbing.  
I hereby certify that I am properly registered with and/or licensed as required by the City of Garden Grove and/or State of California, or that I am the legal owner of the above described property, and I certify that in the performance of the work for which this permit is issued I shall not employ any person in violation of the workmen's compensation laws of the State of California.

SIGNATURE OF PERMITTEE John J. Boyd DATE 6-22-62

APPROVALS	DATE	INSPECTOR
FURNACE		
REGISTER OUTLETS		<u>Paul P. [Signature]</u>
FURNACE VENTS		
GAS PIPING		
MISC. APPLIANCES		
EXHAUST OUTLETS		
RESTAURANT KITCHEN HOOD		
VENTILATION SYSTEM		
CONDENSING UNIT 20 H.P. OR LESS		
CONDENSING UNIT 50 H.P.		
CONDENSING UNIT OVER 50 H.P.		
FINAL	<u>8 22 62</u>	<u>[Signature]</u>
UTILITY CO. NOTIFIED	<u>AUG 31 1962</u>	<u>J.S.</u>

PERMIT AUTHORIZED BY [Signature] DATE 6-22-62

ROUTING: #1 INSPECTOR #2 OFFICE FILE #3 OWNER

BUILDING PERMIT NO. \_\_\_\_\_

# ELECTRIC PERMIT

Department of Building  
B. C. Adams  
Director

CITY OF  
GARDEN GROVE  
JE 7-4200

LOT NO. \_\_\_\_\_ TRACT NO. \_\_\_\_\_

	NUMBER	EA.	FEE
New Residence Sq. Ft. <del>1340</del> 4080		.01	40 80
Residential Garage Sq. Ft.		.005	
Services	1	1.00	1 -
Motors		1.00	
Fixtures 1st 20		.20	
Fixtures, Additional		.10	
Fixtures, Mercury Vapor		1.00	
Outlets, 1st 20		.20	
Outlets, Additional		.10	
Any Pole		2.00	
Dryer		1.00	
Dishwasher		1.00	
Furnace		1.00	
Garbage Disposal		1.00	
Fan		1.00	
Heater Inc. 1650 W		.50	
Domestic Range		1.00	
Domestic Oven		1.00	
Motors—Not Over 1 H.P.		1.00	
Motors Over 1 Not Over 3 H.P.		1.50	
Motors Over 3 Not Over 8		2.00	
Motors Over 8 Not Over 15		2.50	
If Not Listed Above, See Code			
Permit Fee			2 00
Total Fee			43 80

Applicant Fill in (use ink) Electric Permit No

Job Address **13923**  
**13944 - 7. E. Ave** 17645

Owner **Calco**

Owner's Address \_\_\_\_\_

New Bldg.  Old Bldg.  Use \_\_\_\_\_

Electrical Contr. **Virgil S. Lombardi**

Address \_\_\_\_\_

Phone **OX-37544** State License No. **163786**

Validation **JUN 12-62 11 226 M\*\*\*\*43.80**

I hereby acknowledge that I have read this application and state that the above is correct and agree to comply with all ordinances and State laws regulating electrical wiring.

I hereby certify that I am properly registered with and/or licensed as required by the City of Garden Grove and/or State of California, or that I am the legal owner of the above described property, and I certify that in the performance of the work for which this permit is issued I shall not employ any person in violation of the workmen's compensation laws of the State of California.

Signature of Permittee **Virgil S. Lombardi 16-62**

## SIGNS

One Sign—1 Transformer	2.00
Additional Sign, Same Location	1.00
Additional Transf. or flashers, Time Clock	1.00
Lamp Holding Devices, 1st 20	.06
Lamp Holding Devices, Next 100	.03
Sign and 1 Transformer, Moved	
Altering or Changing Lettering	
For Connecting (Hook-up)	
Permit Fee	2 00
Total Fee	

	Date	Inspector
Conduit		
Wiring		
Fixtures		
U. G.		
Sign Footing		
Final		
Utility Notified	<b>8-22-62</b>	<b>REP</b>
	<b>AUG 31 1962 J.S.</b>	

Authorized By \_\_\_\_\_ Date **8/22/62** Building Permit No. \_\_\_\_\_

# CERTIFICATE OF OCCUPANCY

2

DEPARTMENT OF BUILDING

CITY OF GARDEN GROVE

B. C. ADAMS, Director

11391 ACACIA

JOB ADDRESS 13923 Zaria - Bldg. 7 PERMIT NO. 18781

USE OF BUILDING 1 1/2 Unit Apt GROUP H TYPE V

USE ZONE B-2 APPROVED BY H. Dotson DATE 8-29-62

ZONING REMARKS 6 Parking Spaces required

Floor load sign installed per Section 2308 Yes  No

Room capacity sign installed per section 3301 (1) Yes  No

The above described building has been inspected and found to comply with the provisions of the Uniform Building Code.

ISSUED TO Galco Land & Dev. Co. ADDRESS 11 W. Broadway, S.A.

Authorized By \_\_\_\_\_ DATE September 27, 1962

**D. E. HIBST PRINCIPAL BLDG. INSPECTOR**

**Notice! Post in a Conspicuous Place on the Premises**

# PLUMBING PERMIT

Department of Building  
707-4000

CITY OF  
GARDEN GROVE

1

For Applicant to Fill In (Use Ink)

Job *Wash Room* Permit No. **025661A**  
Address *13923 Erin St.*

Lot No. Tract No. Blk. No.

Owner *Messinger*

Owner's Address *3221 W. Bell Avenue*

Plumbing Contractor *Scott Plumbing*

Contractor's Address *301 S. Valley St. Anaheim*

Phone *535-6286* City Lic. No. *206*

Use of Bldg. *apt House -*

New Bldg.  Old Bldg.

Validation *DEC 14-67* *TI 060 W\*\*\*\*3.50*

I hereby acknowledge that I have read this application and state that the above is correct and agree to comply with all ordinances and State laws regulating plumbing.

I hereby certify that I am properly registered with and/or licensed as required by the City of Garden Grove and/or State of California, or that I am the legal owner of the above described property, and I certify that in the performance of the work for which this permit is issued I shall not employ any person in violation of the workmen's compensation laws of the State of California.

Signature of Permittee *Ray Scott* Date *12-12-67*

Address

APPROVALS	DATE	INSPECTOR
SOIL PIPING		
GROUND PLUMBING		
ROUGH PLUMBING		
GAS PIPING		
GAS VENT		
SEPTIC TANK or Cesspool		
SEWER		
GAS TEST		
MAIN DRAIN AND VACUUM LINES		
WATER HEATER		
BACKWASH		
WATER LATERAL		
FINAL	<i>12-16-67</i>	<i>Riggs</i>
UTILITY CO. NOTIFIED		

QTY.	TYPE OR SPECIES OR ITEM	EACH	TOTAL	PER
	Water Closet (Toilet)	\$1.50		
	Bath Tub	1.50		
	Showers	1.50		
	Lavatory (Wash Basin)	1.50		
	Kitchen Sink	1.50		
	Garbage Disposal	1.50		
	Laundry Tub or Tray	1.50		
	Water Heater	1.50	<i>1.50</i>	
	Step Sink	1.50		
	Floor Sink	1.50		
	Floor Drain	1.50		
	Dish Washer	1.50		
	Drinking Fountain	1.50		
	Urinal	1.50		
	Gas System - Outlets	1.50		
	House Sewer	1.50		
	Lawn Sprinklers (Single Dwelling) Only	2.00		
	Swimming Pool Piping	1.50		
	Sand Traps	1.50		
	Automatic Washing Mach.	1.50		
	Water Softeners	1.50		
	Backwash - Trap	1.50		
	Water Lateral	1.50		
	Backflow Protective Devices	2.00		

Issuance of Permit 2 00  
TOTAL FEE \$ *3 50*

Permit Authorized By *17910* Date *12-14-67*

ROUTING: #1 Plumbing Inspector #2 Statistics #3 Owner #4 Office File Bldg. Permit #

**APPLICATION FOR A  
BUILDING PERMIT**

DEPARTMENT OF BUILDING, GARDEN GROVE, CALIF.

**INSTRUCTION:** USE TYPEWRITER OR BALL POINT PEN. PRESS FIRMLY. BE SURE ALL COPIES ARE LEGIBLE. NO ERASURES PERMITTED. A DOUBLE FEE WILL BE CHARGED IF WORK IS STARTED BEFORE PERMIT IS ISSUED.

CODE <b>S-5-3-0</b>		INFORMATION PROVIDED BY BLDG. DEPT.	
EXTERIOR WALL MATERIAL		ROOF FRAMING MATERIAL	
PARTITIONING MATERIAL		ROOF COVERING MATERIAL	
LOT WIDTH	LOT DEPTH	NO. OF EXISTING BLDGS. ON LOT	
USE ZONE <b>R-3</b>	FIRE ZONE	OCCU. PANCY <b>J</b>	TYPE <b>V</b>
REAR SET	FRONT	RIGHT SIDE	LEFT SIDE
BACKS	<b>NO CHANGE</b>		
SITE PLAN NO.	USE PERMIT OR VARIANCE NO.	PARK SPACES REQ'D.	

Job Address <b>13923-D Erin St</b>	Permit No. <b>010217A</b>
Lot No. <b>13923-D</b>	Blk. No.
CONTRACTOR <b>Owner-Builder</b>	STATE LIC. NO.
MAILING ADDRESS <b>same</b>	TEL. NO.
<input type="checkbox"/> ARCH. <input type="checkbox"/> ENGR.	STATE LIC. NO.
MAILING ADDRESS <b>same</b>	TEL. NO.
OWNER <b>G. Messinger</b>	TEL. NO.
MAILING ADDRESS <b>13923-D Erin St</b>	
NEW <input type="checkbox"/> ADD'N <input type="checkbox"/> ALTER <input checked="" type="checkbox"/> REPAIR <input type="checkbox"/> DEMOLISH <input type="checkbox"/>	

Zoning Approved By **ELM** Date **7-6-65**  
Remarks: **NO PLAN**  
**PUBLIC WORKS**

FLOOR AREA (SQ. FT.)	NO. OF STORIES	NO. OF DWELLING UNITS
PRESENT BLDG. USE <b>open carports</b>	PROPOSED BLDG. USE <b>closed garages</b>	

Street Address	<b>OK</b>	By <b>ELM</b>
Record of Survey	REQUIRED	PROVIDED
R/W Dedication		
Bonds		
Encroachment Permit		

Validation **JUL -6-65 11 050 M\*\*\*12.00**  
DESCRIBE WORK TO BE DONE  
**enclose existing carports  
To acquire 16 closed garages**

**REMARKS**

**OWNER-BUILDER PERMIT RESTRICTIONS:** An owner-builder must reside within the building for which this permit is issued, (accessory building excepted). Said building may not contain more than 3 dwelling units. Otherwise, this permit can be issued only to a contractor licensed in the State of California and a business license must be procured from the City of Garden Grove.

APPROVAL	DATE	INSPECTOR
Foundation and Location		
Reinforcing		
Roof Shtg.		
Rough Frame		
Lath or Drywall		
Plas. Brown Ct.		
Other		
Land Use		
Final	<b>9-15-65</b>	<b>ELM</b>
Utility Release		

**WORKMEN'S COMPENSATION INSURANCE REQUIREMENTS:** A certificate or duplicate thereof of workmen's compensation insurance must be on file with the City of Garden Grove prior to the issuance of this permit unless: 1. This permit is for less than \$100 valuation or, 2. The applicant qualifies as an owner-builder and signs the statement below -

I certify that in the performance of the work for which this permit is issued, I shall not employ any person in any manner so as to become subject to the workmen's compensation laws of California.

VALUATION **\$800.00**  
NOTE: INCLUDE LABOR, MAT. WIRING, PLUMB., HEAT., ETC.

SIGNATURE **Glen P. Messinger**

<b>FEES</b>	
Plan Check	<b>\$ NONE</b>
Bond	<b>\$</b>
Building Permit	<b>\$12.00</b>
Expiration Date	

(c-) CERTIFICATE ON FILE

**APPLICANT'S CERTIFICATION:** I have carefully read and examined the above application and find the same to be true and correct. All provisions of the laws and ordinances of the City of Garden Grove and State of California will be complied with whether specified herein or not.

Permit Authorized By **ELM** Date **7-6-65**  
1 Bldg. Inspector

Signature of Permittee <b>Glen P. Messinger</b>	Date <b>7-6-65</b>	BUS. LIC. NO.
Address <b>13923-D Erin St</b>	<b>RELOCATION</b>	
PRESENT BLDG. ADDRESS		
MOVING CONTRACTOR	ADDRESS	



# PLOT PLAN

Department of Building

CITY OF  
GARDEN GROVE

Job Address

1325 DEERIN ST

Permit Number

10217

Lot

Tract

Blk.

DIMENSION PLOT PLAN COMPLETELY SHOWING  
ALL BLDGS. ON THE LOT AND THEIR USE

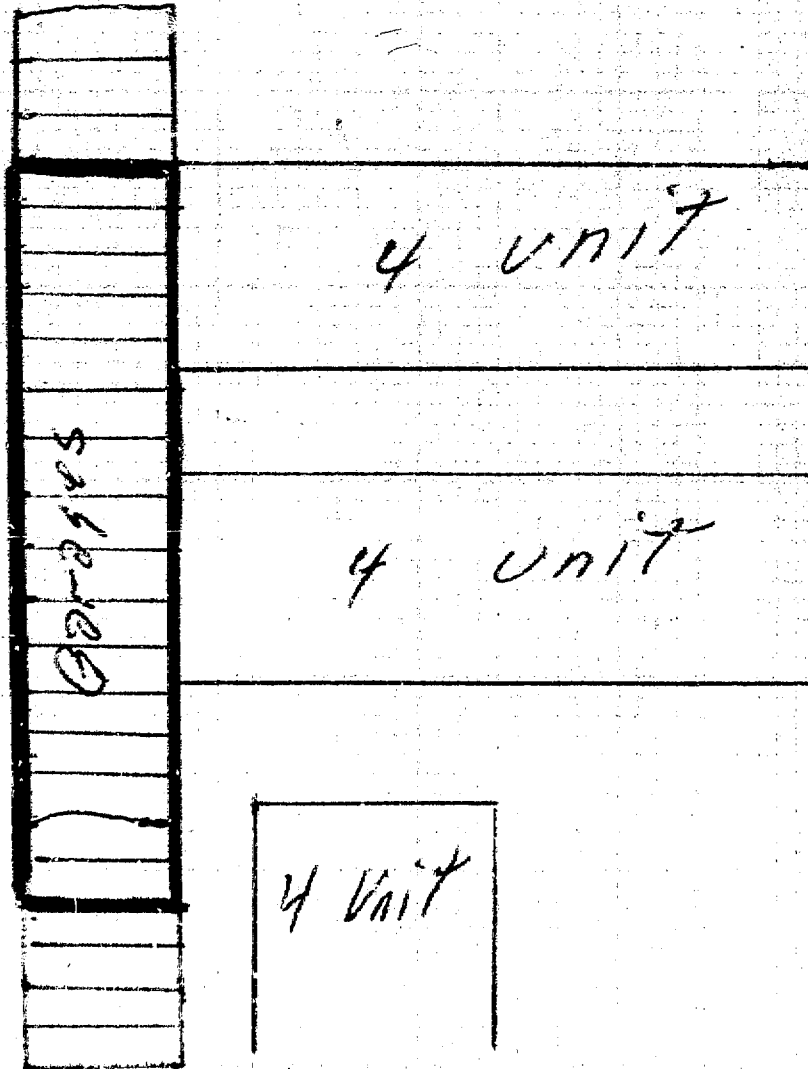
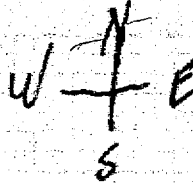

I certify the information hereon is complete and correct.  
Routing: #1 Building Inspector #2 Office File #3 Owner

By

Date 7-6-65

# PLUMBING PERMIT

Department of Building  
537-4200

CITY OF  
GARDEN GROVE

## PERMIT FEES

No	TYPE OF FIXTURE OR ITEM	EACH	\$ FEE
	Water Closet (Toilet)	\$1.50	
	Bath Tub	1.50	
	Shower	1.50	
	Lavatory (Wash Basin)	1.50	
	Kitchen Sink	1.50	
	Garbage Disposal	1.50	
	Laundry Tub or Tray	1.50	
	Water Heater	1.50	1.50
	Slop Sink	1.50	
	Floor Sink	1.50	
	Floor Drain	1.50	
	Dish Washer	1.50	
	Drinking Fountain	1.50	
	Urinal	1.50	
	Gas System — Outlets	1.50	
	House Sewer	1.50	
	Lawn Sprinklers	2.00	
	Swimming Pool Piping	1.50	
	Sand Traps	1.50	
	Automatic Washing Mach.	1.50	
	Water Softeners	1.50	
	Backwash — Trap	1.50	
	Water Lateral	1.50	
	Backflow Protective Devices	2.00	

*TOP WATER*

For Applicant to Fill in (Use Ink)

Job Address 13923 Erin St Permit No. 030981 A

Lot No. \_\_\_\_\_ Tract No. \_\_\_\_\_ Blk. No. \_\_\_\_\_

Owner Elizabeth Smith

Owner's Address Home - apt 11

Plumbing Contractor Scott Plumbing

Contractor's Address 301 S Valley St

Phone 535-6286 City Lic. No. 347

Use of Bldg. CPTR

New Bldg.  Old Bldg.

Validation SEP 25 68 11 055 MAR 13 68

I hereby acknowledge that I have read this application and state that the above is correct and agree to comply with all ordinances and State laws regulating plumbing.

I hereby certify that I am properly registered with and/or licensed as required by the City of Garden Grove and/or State of California, or that I am the legal owner of the above described property, and I certify that in the performance of the work for which this permit is issued I shall not employ any person in violation of the workmen's compensation laws of the State of California.

Signature of Permittee Ray Scott Date 9/23/68

Address \_\_\_\_\_

APPROVALS	DATE	INSPECTOR
SOIL PIPING		
GROUND PLUMBING		
ROUGH PLUMBING		
GAS PIPING		
GAS VENT		
SEPTIC TANK or Cesspool		
SEWER		
GAS TEST		
MAIN DRAIN AND VACUUM LINES		
WATER HEATER		
BACKWASH		
WATER LATERAL		
FINAL		
UTILITY CO. NOTIFIED		

Issuance of Permit 2 00

TOTAL FEE \$ 3 50

Permit Authorized By R19910 Date 9-25-68

ROUTING: #1 Plumbing Inspector #2 Statistics #3 Owner #4 Office File Bldg. Permit # ONE

# BUILDING PERMIT

Inspection Requests  
638-6771

General Information  
836-6961

## INSPECTION RECORD

For Applicant to Fill in

OCCUPANCY	OCC LOAD	FEE SFF#&K				APPROVAL	DATE	INSPECTOR
		FRONT	LEFT	RIGHT	REAR			
USE ZONE						PRE INSPECTION		
						FOUNDATION & LOCATION		
						CONCRETE FLOOR		
						REINFORCING		
PLANNING ACTION					PLANS DATE	MASONRY		
LAND USE APPROVED BY						ROOF SHTG	1-9-87 R. G.F.	
REMARKS						ROUGH FRAME		
						INSULATION ENERGY		
						DRYWALL		
						LATH		
						PLAS BRWN CT		
G.G.SANITDIS FEE REQ'D	G.G.SANITDIS FEE REQ'D			REQ'D	PROVIDED			
PARCEL MAP								
R/W DEDICATION								
<b>FEES AND BONDS</b>								
	REV. CODE		AMOUNT					
ST BOND								
WATER BOND								
WATER ASSEMT FEE ADDS								
WATER ASSEMT FEE ADDS								
PARK ASSEMT FEE								
PARK ASSEMT FEE								
CHAIN ASSEMT FEE ADDS								
CHAIN ASSEMT FEE ADDS								
PLAS BRWN CT								
PLAS BRWN CT								
TOTAL FEES								

**WORKER'S COMPENSATION REQUIREMENTS**

State Compensation Insurance Policy No. \_\_\_\_\_ Expiration Date \_\_\_\_\_

I certify that in the performance of the work for which this permit is issued, I shall not employ any person in any manner so as to become subject to the Worker's Compensation Laws of California.

**NOTE:** After making such certification, the applicant for the permit shall be deemed to have agreed to the Worker's Compensation provisions of this code. No work shall be done until the City of Garden Grove has been notified in writing that the applicant complies with the provisions of Section 37.11. If the permit shall be otherwise revoked.

I certify that I have read this application and note that the above information is correct and agree to comply with all City ordinances and State laws relating to pending construction. I further agree to hold the City of Garden Grove harmless from and against all liability amount out of injury or property damage resulting therefrom.

**BUSINESS TAX CERTIFICATE INFORMATION**

Business Tax Certificate No. \_\_\_\_\_ Expiration Date \_\_\_\_\_

**Just Class Roofing**

714-539-7600

**ADDRESS** 13923 Erin St

**OWNER** Richard Furman 833 8224

**WORKING ADDRESS** 11511 Dine St Newport Beach

AFFH

ENSH

MARKING

**INSPECT** 15.00  
**B-PER** 51.00  
**ISS** 10.00  
**182142A 1-08'87 CHECK** 76.00

**Just Class Roofing**

**WORKING ADDRESS** 9381 Central Ave #411

**TEL TO** 714-539-7600 411/32

**PRESENT BLDG USE** Apartments

**PROPOSED BLDG USE** Senior Center

**DESCRIBE WORK TO BE DONE** Remove old breathing pipe, set new 7' high, 2" dia. 1" thick. Add 1" wall.

**NEW USE** 4000 2 6

**RELOCATION**

INSPECTOR



# BUILDING PERMIT

Inspection Request  
638-5771

General Information  
626-8881

*M-15-16*

## INSPECTION RECORD

For Applicant to Fill in

OCCU RANCY	TYPE	OCC. LOAD		FIRE SPRINK.		APPROVAL	DATE	INSPECTOR
		FRONT	LEFT	RIGHT	REAR			
USE ZONE						FOUNDATION & LOCATION		
FIRE ZONE	Eav Proj. Setbacks					CONCRETE FLOOR REINFORCING		
PLANNING ACTION						ROOF SHTG	7-24-85	D.M.
LAND USE APPROVED BY					PLANS DATE	ROUGH FRAME		
REMARKS						INSULATION, ENERGY		
						LATH OR DRYWALL		
						PLAS BROWN CT.		
						SOUND INSULATION		
						SMOKE DETECTOR		
						PARKING		
						LANDSCAPING		
G.G. SANT. DIS. FEE REQ'D.	O.C. SANT. DIS. FEE REQ'D.			DATE	INITIAL			
				REQ'D	PROVIDED			
PARCEL MAP						LAND USE FINAL		
R/W DEDICATION						FINAL	8-2-85	D.M.
FEES AND BONDS						IDENTIFICATION CODE		
	REV. CODE	AMOUNT						
ST. BOND								
WATER BOND								
WATER ASSMT. FEE (ACRG.)								
WATER ASSMT. FEE (FT.)								
PARKWAY TREE FEE								
REC. FEE (DIST.)								
DRAIN ASSMT. FEE (DIST.)								
PLAN RETENTION FEE								
BLDG. PLAN CHECK			15					
BLDG. PERMIT FEE			69	03				
ISSUANCE			10					
VALUATION								
			TOTAL FEES	94	03			
Authorized By								

<p><b>WORKER'S COMPENSATION REQUIREMENTS</b></p> <p>State Compensation Insurance Policy No. <u>625457</u> Expiration Date _____</p> <p><input type="checkbox"/> I certify that in the performance of the work for which this permit is issued, I shall not employ any person in any manner so as to become subject to the Worker's Compensation laws of California.</p> <p>NOTE: If, after making such certificate, the applicant for the permit should become subject to the Worker's Compensation provisions of this code, he shall forthwith comply with the provisions of Section 3700 or his permit shall be deemed revoked.</p> <p><input checked="" type="checkbox"/> I certify that I have read this application and state that the above information is correct. I agree to comply with all City ordinances and State laws relating to pending construction. I further agree to hold the City of Garden Grove free and harmless from any liability arising out of injury or bodily damage resulting from work performed relevant to this permit.</p> <p>PERMIT APPLICANT SIGNATURE: <u>V. G. Sullivan</u> DATE: _____</p>	
<p><b>BUSINESS TAX CERTIFICATE INFORMATION</b></p> <p>I certify that the following Contractor's License No. _____ and Classification _____ is in full force and effect.</p> <p>(PRINT) CONTRACTOR _____ (SIGNATURE) CONTRACTOR OR AUTHORIZED AGENT _____ DATE _____</p> <p>BUSINESS TAX CERTIFICATE NO. _____ EXPIRATION DATE _____</p> <p>I certify that I am exempt from Section 7031.5 of the Business and Professional Code, Division 3, Chapter 9, Contractors' License Law, under the following Section:</p> <p>Owner: Section 7044 <input type="checkbox"/> Minor work under \$200: Section 7048 <input type="checkbox"/></p> <p>Employee working for wages only: Section 7053 <input type="checkbox"/></p> <p>Other: _____</p> <p>(PRINT) PROPERTY OWNER (SIGNATURE) PROPERTY OWNER OR AUTHORIZED AGENT _____ DATE _____</p>	

<p>ADDRESS</p> <p><u>13923 ERIN ST. #456A</u></p> <p>LD. NO. MCR NO. TRACT NO. PARCEL NO.</p>	
<p>OWNER</p> <p><u>INVESTOR</u></p> <p><u>REALTY MGT.</u></p> <p>MAILING ADDRESS</p> <p><u>1151 DOVE ST. N.B. 92160</u></p> <p>ARCH _____ ENGR. _____</p> <p>MAILING ADDRESS _____ CITY _____ ZIP _____</p>	<p>TEL. NO.</p> <p><u>833-8224</u></p> <p>CITY _____ ZIP _____</p>
<p>TEL. NO.</p> <p><u>539-7600</u></p> <p>STATE LIC. NO. &amp; TYPE</p> <p><u>41133 C-39</u></p>	<p>VALIDATION</p> <p>B-PLAN 15.00</p> <p>B-FER 69.03</p> <p>ISS 10.00</p>
<p>CONTRACTOR</p> <p><u>FIRST CLASS ROOFING</u></p> <p>MAILING ADDRESS</p> <p><u>9381 CENTRAL GG. 92644</u></p> <p>TEL. NO.</p> <p><u>539-7600</u></p> <p>STATE LIC. NO.</p> <p><u>41133 C-39</u></p>	<p>PRESENT BLDG. USE</p> <p>PROPOSED BLDG. USE</p> <p>REMOVE EXISTING BDR.</p> <p>+ Recover with 3# 15 + Rex K</p> <p>(CHIPPED OUTS)</p> <p>NEW <input type="checkbox"/> ADD'N <input type="checkbox"/> ALTER <input type="checkbox"/> REPAIR <input checked="" type="checkbox"/> DEMOLISH <input type="checkbox"/></p>
<p>FLOOR AREA (SQ. FT.)</p> <p><u>8200</u></p>	<p>NO. OF STORIES</p> <p><u>1</u></p> <p>NO. OF DWELLING UNITS</p> <p>_____</p>
<p>A FEE MAY BE CHARGED FOR RE-INSPECTION DUE TO NEGLIGENCE, INCOMPLETE WORK, OR FAILURE TO MAKE CORRECTIONS</p>	
<p>RELOCATION</p> <p>PRESENT BLDG. ADDRESS</p> <p>MOVING CONTRACTOR</p> <p>ADDRESS</p>	

*[Signature]*

*7/15/85*