

# BUILDING PERMIT

Department of Building  
 S. C. Adams  
 Director

CITY OF  
 GARDEN GROVE

## ZONING AND BUILDING

Use Zone C-2 Variance No. \_\_\_\_\_  
 Map No. 97-21 Main Use  Acc. Use   
 Set Back - C/L ST 70' @ C/L ST \_\_\_\_\_  
 Side Yard Rt 10' Projection \_\_\_\_\_  
 Side Yard Lt \_\_\_\_\_ Projection \_\_\_\_\_  
 Rear Yard \_\_\_\_\_ No Parking Sp. Req'd. \_\_\_\_\_  
 Zoning Approved By BCA Date 4-8-57  
 Group F-2 Type J Plan Cl. BCA  
 Remarks: \_\_\_\_\_

## INSPECTION RECORD

APPROVAL	DATE	INSPECTOR
Foundation and Location	<u>4/10/57</u>	<u>DK</u>
Reinforcing		
Roof Sheg.	<u>4/17/57</u>	<u>DK</u>
Rough Frame	<u>4/22/57</u>	<u>DK</u>
Leth or Drywall		
Flas. Brown Ct.		
Final	<u>4/24/57</u>	<u>DK Subj. To Plan</u>
Utility Release		<u>DK</u>

Remarks: \_\_\_\_\_

## FEES

Building Permit	\$ <u>10.00</u>	Rec'd <u>4/8-57</u>
Plan Check	\$ <u>5.00</u>	Rec'd <u>4/8-57</u>
Remarks:	<u>15.00</u>	

Permit Authorized By BCA Date 4-8-57

Routing: #1 Bldg. Inspector    #2 Office File    #3 Statistics    #4 Owner

For Applicant to Fill in (Rev. 1-52)

Job Address 5642 9th St Permit No. 291  
 Lot No. 2 Tract No. 1275 Blk. No. \_\_\_\_\_  
 Lot A F Please Attach Plans & Details 2 Copies  
 Owner WELTON T. HURST  
 Owner's Address 9511 W. HURSTSON  
 Description of Work BLDG. ADDITION  
 Use of Building R.E. OFFICE  
 Area of Building 540 sq ft Valuation \$ 2500.00  
 Arch. or Engr. KEN FAY Address 312 W. 9th St  
 Contractor \_\_\_\_\_ Address \_\_\_\_\_

I hereby acknowledge that I have read the application and plans that the above is correct and agree to comply with all ordinances and State laws regulating building construction.

I hereby certify that I am properly registered with and, or licensed as required by the City of Garden Grove and, or State of California, or that I am the legal owner of the above described property, and I certify that in the performance of the work for which this permit is issued I shall not employ any person or waitress at the worker's compensation laws of the State of California.

Signature of Permittee W. T. Hurst  
 Address Same

## VALIDATION BY CASHIER

Plan Check \_\_\_\_\_  
 Bldg. Pt. \_\_\_\_\_

## RELOCATION

PRESENT BLDG. ADDRESS \_\_\_\_\_  
 MOVING CONTRACTOR ADDRESS \_\_\_\_\_  
 INSPECTION FEE RECEIPT NUMBER \_\_\_\_\_  
 SUBMIT DATE REC'D REC'D BY \_\_\_\_\_  
 CASH D.P. DATE REC'D REC'D BY \_\_\_\_\_  
 RELOCATION AUTHORIZED BY \_\_\_\_\_ DATE \_\_\_\_\_

SECTION FROM THE COMBINED SURVEY  
OF THE LOT AND TRAIL VE

Lot 5  
Plot A

1072

120'

NEWLAND STREET

160'

Med. Bldg

12' 18'

30'  
New Bldg  
EXISTING BLDG

284  
CHAS

22 Office Inspect

23 Office Ins

24 Owner

99. Blvd

# CERTIFICATE OF OCCUPANCY 2

DEPARTMENT OF BUILDING  
CITY OF GARDEN GROVE  
11391 ACACIA

S. C. ADAMS, Director

JOB ADDRESS: 16512 PERMIT NO. 0811  
USE OF BUILDING: R-2 GROUP: R-2 TYPE: R  
USE ZONE: R-2 APPROVED BY: [Signature] DATE: 11-1-72

### ZONING REMARKS

Floor load sign installed per Section 2308 Yes  No   
Room capacity sign installed per section 3301 (1) Yes  No

The above described building has been inspected and found to comply with the provisions of the Uniform Building Code.

ISSUED TO: [Signature] ADDRESS: 16512  
Authorized By: [Signature] DATE: 11-1-72

**Notice! Post in a Conspicuous Place on the Premises**

# BUILDING PERMIT

DEPARTMENT OF BUILDING & SAFETY, GARDEN GROVE PH. 537-4000

INSTRUCTION: FILL IN AREA WITHIN HEAVY LINES  
USE TYPEWRITER OR BALL POINT PEN. PRESS FIRMLY. BE SURE ALL COPIES ARE  
LEGIBLE. NO ERASURES PERMITTED. A DOUBLE FEE WILL BE CHARGED IF WORK  
IS STARTED BEFORE PERMIT IS ISSUED.

FIRE ZONE  
OCCUPANCY **F-2** TYPE **V** OCC. LOAD

Job Address **9642 Garden Grove Bl** Permit No. **035759 A**  
Lot No. Tract No.

REMARKS **No Plans**  
**PLANNING**

Owner **G.F. Ziegle** Tel. No. **4302849**  
Mailing Address **8642 Garden Grove Bl** City **GG** Zip No.

USE ZONE SETBACKS FRONT LEFT RIGHT REAR  
EAVE PROJ.

Arch. State Lic. No.  
 Engr. Tel. No.

PLANNING ACTION PARK SPACES **REQUIRED**

Mailing Address City Zip No.

Zoning Approved By Date

Contractor **Owner/Build** Lic. No. Tel. No.

Remarks:

Mailing Address City Zip No.

**PUBLIC WORKS**

PRESENT BLDG. USE **TV Sales & Rental** PROPOSED BLDG. USE **General Rental Center**

Amount Rec'd Provided

**JUL 16-69 11 059 5.00**

Street Bond  
Water Bond  
Water Assmt Fee  
Fire Hydrant F.F. Fee  
Parkway Tree Fee  
Landscape Bond

Validation  
DESCRIBE WORK TO BE DONE **Demolish 516 Sq Ft of Bldg**

Remarks

NEW  ADD'N  ALTER.  REPAIR  DEMOLISH

**INSPECTION RECORD**

FLOOR AREA (SQ. FT.) **516** NO. OF STORIES **1** NO. OF DWELLING UNITS **1**

APPROVAL DATE INSPECTOR

I certify that I have read this application and state that the above information is correct. I agree to comply to all City Ordinances and State laws relating to building construction. I certify that in the performance of the above work I shall not employ any person in violation of the Labor Code of California relating to Workman's Compensation Insurance. I further agree to hold the City of Garden Grove free and harmless from any liability arising out of injury or bodily damage resulting from work performed relevant to this permit.

Foundation and Location

CONTRACTORS SIGN BELOW  
I certify that I am a licensed contractor and that my license is in full force and effect.

Reinforcing

By \_\_\_\_\_ Date \_\_\_\_\_  
Contractor Authorized Agent

Roof Shtg.

OWNER-BUILDER SIGN BELOW  
I certify that I am exempt from the provisions of Ch. 9, Div. 3, B and P, Code (Contractor's License Law) because (check one):

Rough Frame

I am the owner of the above property and will personally perform the above work.

Lath or Drywall

I am the owner of the above property and I will contract to have all of the above work performed by licensed contractors.

Plas. Brown Ct.

I am the owner of the above property and will employ persons to perform the above work with wages as their sole compensation. I will furnish insurance for the employees as required by the Labor Code of California.

Other **Demolished**

By \_\_\_\_\_ Date \_\_\_\_\_  
Owner's Signature Authorized Agent

Final **Demolished** **9-16-69** **WZ**

If work is not started within 60 days from date of issue or if abandoned for more than 120 days, this permit will be null and void.

Utility Release

**RELOCATION**

VALUATION NOTE: INCLUDE LABOR, MAT. WIRING, PLUMB., HEAT., ETC. **\$10000**

PRESENT BLDG. ADDRESS  
MOVING CONTRACTOR ADDRESS

FEES  
Plan Check **\$ NONE** Building Permit **\$ 500**  
Bond **\$** Expiration Date

Permit Authorized By **ELM** Date **7-16-69**  
1 Bldg Inspector

# BUILDING PERMIT PLOT PLAN

Department of Building  
CITY OF GARDEN GROVE

NAME OF CONSTRUCTION LENDER & BRANCH N/A	
ADDRESS	CITY
PLANNING DEPT. APPROVAL EC	DATE 7-16-69

ASSESSOR'S PARCEL NO. 97-213-19	DATE 7-16-69	PERMIT NO. 357591
JOB ADDRESS AND CITY 8642 Garden Grove Blvd.		
LEGAL DESCRIPTION:	LOT	BLOCK
JOB DESCRIPTION (PLEASE CHECK) <input type="checkbox"/> New <input type="checkbox"/> Addition <input type="checkbox"/> Alteration <input type="checkbox"/> Repair <input type="checkbox"/> Move <input checked="" type="checkbox"/> Demolish		
OWNER George F. Ziegler	USE	PERMIT VALUE \$100

DIMENSION PLOT PLAN COMPLETELY SHOWING ALL BLDGS. ON THE LOT AND THEIR USE.

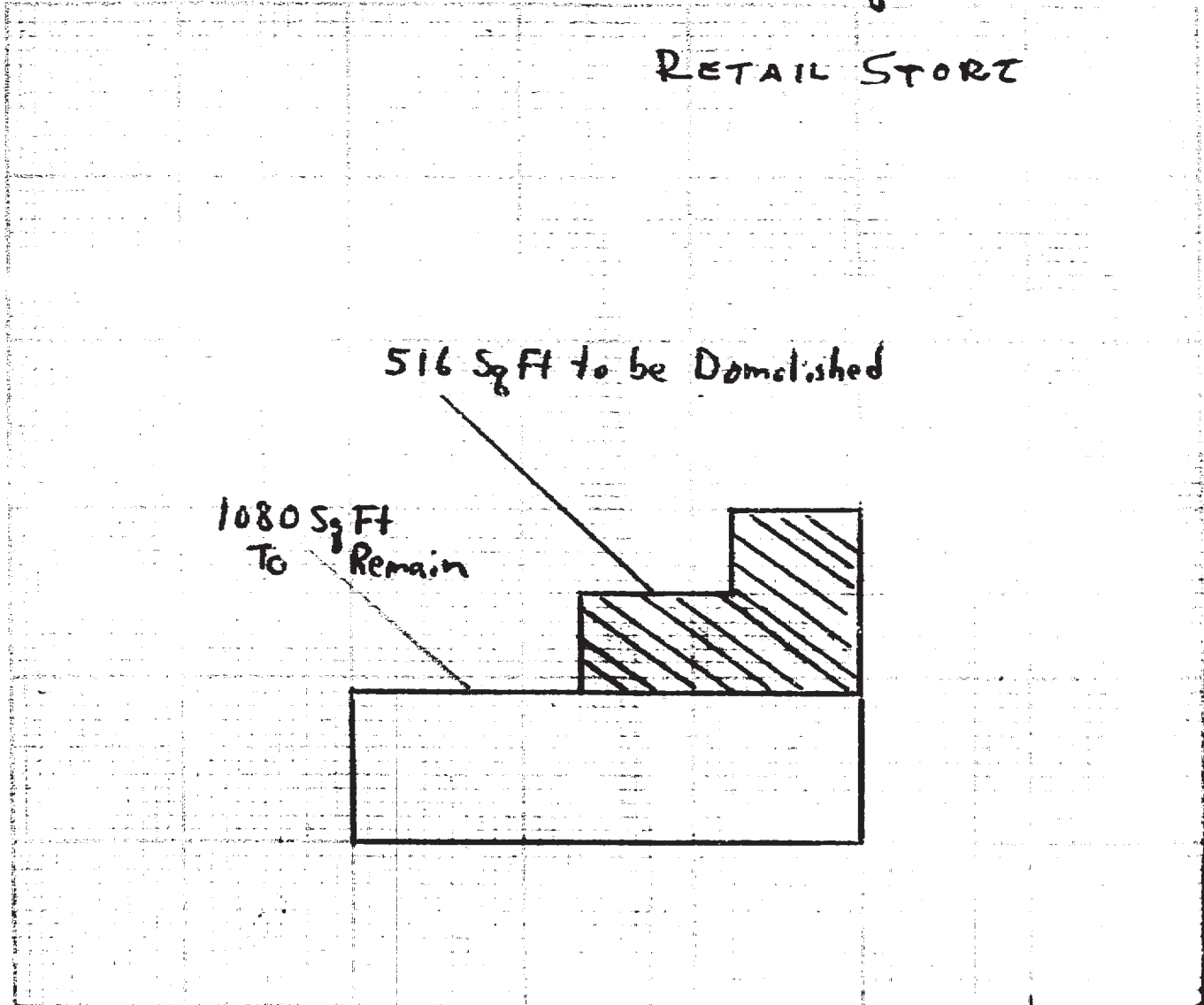

#1 Building Insp. / #2 Assessor / #3 File / #4 Permittee

I certify the information hereon is complete and correct. By \_\_\_\_\_

Date \_\_\_\_\_

# ELECTRICAL PERMIT

DEPARTMENT OF BUILDING AND SAFETY

GARDEN GROVE, CALIFORNIA

PHONE: 537-4200

INSTRUCTION: USE TYPEWRITER OR BALL POINT PEN. PRINT FIRMLY. BE SURE ALL COPIES ARE LEGIBLE. NO REVISIONS PERMITTED. A DOUBLE FEE WILL BE CHARGED IF WORK IS STARTED BEFORE PERMIT IS ISSUED.

JOB ADDRESS **GROVE 095-071A**  
**8642 GARDEN**

OWNER **NAZ REALTY**

OWNER'S ADDRESS

NEW BUILDING OR ADDITION - AREA SQ. FT.	EXISTING BUILDING REMODEL AREA SQ. FT.	OCCUPANCY GROUP	USE OF BUILDING AND OR NUMBER OF UNITS
---	--	-----------------	--

ELECTRICAL CONTRACTOR  
**E. J. BYINGTON COMPANY**

ADDRESS **12340 HARBOR BLVD GARDEN CA 92540**

VALIDATION **NOV 25-69 11 028**

I HAVE CAREFULLY READ THE ABOVE APPLICATION AND KNOW THE SAME TO BE TRUE AND CORRECT. ALL PROVISIONS OF STATE AND LOCAL LAWS COVERING THIS TYPE OF CONSTRUCTION WILL BE COMPLIED WITH WHETHER SPECIFIED HEREIN OR NOT. NO PERSON SHALL BE EMPLOYED IN VIOLATION OF THE LABOR CODE OF THE STATE OF CALIFORNIA.  
 SIGNATURE OF PERMITTEE **[Signature]** DATE **7-25-69**

BRANCH CIRCUIT PANEL - CIRCUITRY							
CIR. NO.	BRKR. SIZE	WIRE SIZE	NOMENCLATURE	NO. OF OUTLET	WATTS LT.	WATTS LT.	WATTS LT.
1							
2							
3							
4							
5							
6							

### INSPECTION RECORD

APPROVAL	DATE	INSPECTOR
Underground		
Conduit		
Wiring	<b>8-27-69</b>	<b>RSP</b>
Ceiling Heat Cable		
Fixtures		
Service		
Final	<b>8-28-69</b>	<b>RSP</b>
Utility Notified		

SINGLE PHASE SERVICE SIZE \_\_\_\_\_ AMPS. \_\_\_\_\_ WIRE \_\_\_\_\_ RISE CONDUIT

THREE PHASE SERVICE SIZE  3 WIRE  4 WIRE \_\_\_\_\_ AMPS. \_\_\_\_\_ WIRE \_\_\_\_\_ RISE CONDUIT

BUILDING PERMIT NO **0357591** SIGN PERMIT NO. \_\_\_\_\_ VENT. HEAT AIR COND PERMIT NO. \_\_\_\_\_

IF NOT LISTED BELOW SEE CODE	NUMBER	EACH	FEE
Residential (I & H) sq. ft.		.01	
Garage, Resid. (J) sq. ft.		.005	
Service, Single Phase		\$1.00	
Service, Three Phase		1.00	
Motors, Single Phase		1.00	
Motors, Three Phase		1.00	
Pole, Power, Light, etc.		2.00	
Sub-Panels 1 φ		1.00	
Sub-Panels 3 φ		1.00	
Outlets 1st 20	<b>10</b>	.20	<b>2-</b>
Outlets Over 20		.10	
Fixtures 1st 20		.20	
Fixtures Over 20		.10	
Fixtures, High Voltage Type		1.00	
Radiant Heat		1.00	
Washer		1.00	
Dryer		1.00	
Hot Water Heaters		1.00	
Dishwasher		1.00	
Domestic Range or Oven		1.00	
Motors Not Over 1 HP		1.00	
Motors Over 1 Not Over 3 HP		1.50	
Time Clock		1.00	
Sign, 1 Tran. or 1 Ballast		2.00	
Each Additional Tran. or Ballast		1.00	
Sign Hookup		1.00	

ISSUANCE OF PERMIT **2 00**

TOTAL FEE **4-**

INSPECTOR **[Signature]** PERMIT AUTHORIZED BY **[Signature]** DATE **7-25-69**

**CITY OF GARDEN GROVE**  
Public Works & Development

**ELECTRICAL PERMIT**

Inspection Requests  
638-6771

General Information  
638-6881

**INSPECTION RECORD**

SINGLE PHASE SERVICE SIZE 200 AMPS	3 WIRE	3 WIRE	RIG. CONDUIT	UG	OH
THREE PHASE SERVICE SIZE	3 WIRE	4 WIRE	UG	OH	
APPROVAL	DATE	VOLTS	RIG. CONDUIT	INSPECTOR	
Underground					
Conduit					
Wiring - Rough					
Master					
Fixtures & Trim					
Motors					
<p><i>Sitewent meter</i></p> <p><i>Completed 11-4-82</i></p> <p><i>1-28-82</i></p> <p><i>1-29-82</i></p>					
IDENTIFICATION CODE					
BUILDING PERMIT NO.					
VENT. PERMIT NO.					

**FEES**

IF NOT LISTED BELOW	NO.	EA.	FEES
SALE CODE			
Residential (R-1 & R-3) sq. ft.			
Garage, Pool, (M) sq. ft.			
Service Meter, Single Phase	1		5.00
Service Meter, Three Phase			
Add'l Meter, Three Phase			
Temporary Power Pole			
Pole, Power, Light, etc.			
Sub-Panels 10 RECESSED	3		6.00
Sub-Panels 30			
Outlet			
Fixtures			
Fixtures, Merc. Quartz, etc.			
Heater--Not Over 1650 W			
Washer			
Dryer			
Hot Water Heaters			
Dishwasher			
Domestic Range or Oven			
Disposal			
Power Apparatus--H.P., K.W. or K.V.A. Motors, Transformers, etc.			
Not Over 1 each			
Over 1, Not Over 10 each			
Over 10, Not Over 30 each			
Indv. Circuits			
Time Clock			
Sign			
Sign Hookup			
ITEM	CODE	FEES	
Plan Patenting Fee			
Plan Check			
Permit			17.00
Issuance			6.00
TOTAL FEES			17.00

**ADDRESS**  
12771 Westwood Dr. Garden Grove, CA 92647

**OWNER**  
H. J. Reed

**OWNER'S ADDRESS**  
12771 Westwood Dr. Garden Grove, CA 92647

**PHONE**  
382-3333

**CITY**  
GARDEN GROVE

**STATE LIC. NO. & TYPE**  
C.P. 382333

**NEW BUILDING OR EXISTING BUILDING**  
EXISTING BUILDING

**ADDITION - AREA**  
11/03/82

**TYPE**  
ISSUANCE

**VALIDATION**  
CHECK

**NO. OF UNITS**  
1

**PERMIT APPLICANT SIGNATURE**  
H. J. Reed

**BUSINESS TAX CERTIFICATE INFORMATION**  
I certify that the following Contractor's License No. 12771 Westwood Dr. Garden Grove, CA 92647 is in full force and effect.

**WORKER'S COMPENSATION REQUIREMENTS**  
I certify that I have read this application and state that the above information is correct. I agree to comply with all City ordinances and State laws relating to pending construction. I further agree to hold the City of Garden Grove free and harmless from any liability arising out of injury or bodily damage resulting from work performed relevant to this permit.

**EXPIRATION DATE**  
11-4-82

**PERMIT NO.**  
1-28-82

**EXPIRATION DATE**  
1-29-82

**CONTRACTOR**  
H. J. Reed

**CONTRACTOR'S LICENSE NO.**  
C.P. 382333

**CONTRACTOR'S SIGNATURE**  
H. J. Reed

**CONTRACTOR'S ADDRESS**  
12771 Westwood Dr. Garden Grove, CA 92647

**CONTRACTOR'S PHONE**  
382-3333

**CONTRACTOR'S CITY**  
GARDEN GROVE

**CONTRACTOR'S STATE LIC. NO. & TYPE**  
C.P. 382333

**CONTRACTOR'S BUSINESS TAX CERTIFICATE INFORMATION**  
I certify that I am exempt from Section 7031.5 of the Business and Professions Code, Division 3, Chapter 9, Contractors' License Law, under the following Section:  
Owner: Section 7044  
Employee working for wages only: Section 7048  
Minor work under \$100: Section 7048

**PROPERTY OWNER SIGNATURE**  
H. J. Reed

**PROPERTY OWNER ADDRESS**  
12771 Westwood Dr. Garden Grove, CA 92647

**PROPERTY OWNER CITY**  
GARDEN GROVE

**PROPERTY OWNER STATE LIC. NO. & TYPE**  
C.P. 382333

**PROPERTY OWNER BUSINESS TAX CERTIFICATE INFORMATION**  
I certify that I am exempt from Section 7031.5 of the Business and Professions Code, Division 3, Chapter 9, Contractors' License Law, under the following Section:  
Owner: Section 7044  
Employee working for wages only: Section 7048  
Minor work under \$100: Section 7048

**PROPERTY OWNER SIGNATURE**  
H. J. Reed

**PROPERTY OWNER ADDRESS**  
12771 Westwood Dr. Garden Grove, CA 92647

**PROPERTY OWNER CITY**  
GARDEN GROVE

**PROPERTY OWNER STATE LIC. NO. & TYPE**  
C.P. 382333

**PROPERTY OWNER BUSINESS TAX CERTIFICATE INFORMATION**  
I certify that I am exempt from Section 7031.5 of the Business and Professions Code, Division 3, Chapter 9, Contractors' License Law, under the following Section:  
Owner: Section 7044  
Employee working for wages only: Section 7048  
Minor work under \$100: Section 7048

**A FEE MAY BE CHARGED FOR RE-INSPECTION DUE TO NEGLIGENCE, INCOMPLETE WORK, OR FAILURE TO MAKE CORRECTIONS.**