



General Information: 714-741-5307

CITY OF GARDEN GROVE - DEVELOPMENT SERVICES DEPARTMENT

Inspection Requests: 714-741-5332

# PERMIT (PAGE 2 of 2)

## PROJECT/SITE/BUILDING DESCRIPTION

JOB Address : 9670 TRASK AVE  
 Suite :  
 PERMIT NO. : 92174  
 Permit Type : FIRE SUPP.  
 Type : B16  
           FIRE SPRINKLERS  
 Owner : CAR NOA GGT LLC  
 Applicant : GREG BROWN  
 Phone : 909-548-6633

Contractor : FIRE 1 FIRE PROTECTION SERVICE  
 Address : 21220 SLIVER CLOUD  
 CityStZip : DIAMOND BAR, CA 91765  
 Phone : 909-598-2665

Insp Dist : FS  
 Date : 10/02/07  
 Parcel No : 09809064

Value : 38000  
 Floor area : 6000

## PROPOSED WORK:

O30 - SPRINKLER  
 NEW FIRE SPRINKLERS FOR ADDITION TO EXIS TING  
 AUTO DEALER.

## FEEES

111 32073 Permit	1	548.76
111 32401 issuance	1	35.00
942 22130 General Plan	1	45.90
080 32550 Cultural Arts	1	22.61
<b>TOTAL</b>		<b>652.27</b>

APPROVAL	DATE	INSPECTOR
Pre Inspect		
Foundation		
Concrete Floor		
Reinforcing		
Masonry		
Roof Shtg		
Rough Frame		
Insul / Energy		
Drywall		
Lath		
Plas. Brown Ct.		
Landscaping		
Pre Gunite		
Pre Deck		
Pre Plaster		
Planning Final		
Bldg Final	10/2/07	[Signature]
Utility Notified		

Pre Inspect \_\_\_\_\_  
 Foundation \_\_\_\_\_  
 Concrete Floor \_\_\_\_\_  
 Reinforcing \_\_\_\_\_  
 Masonry \_\_\_\_\_  
 Roof Shtg \_\_\_\_\_  
 Rough Frame \_\_\_\_\_  
 Insul / Energy \_\_\_\_\_  
 Drywall \_\_\_\_\_  
 Lath \_\_\_\_\_  
 Plas. Brown Ct. \_\_\_\_\_  
 Landscaping \_\_\_\_\_  
 Pre Gunite \_\_\_\_\_  
 Pre Deck \_\_\_\_\_  
 Pre Plaster \_\_\_\_\_  
 Planning Final \_\_\_\_\_  
 Bldg Final 10/2/07 [Signature]  
 Utility Notified \_\_\_\_\_

## AUTHORIZATION

Issued By: yoavs \_\_\_\_\_ Date \_\_\_\_\_

## DECLARATION

I certify that I have read this application/permit and state that the information on all pages of this document is correct. I agree to comply with all City and County ordinances and State laws relating to building construction, and hereby authorize representatives of this City and County to enter upon the above mentioned property for inspection purposes.

Applicant's Signature [Signature]  
 Print Name \_\_\_\_\_ Date 10/2/07

\*\*\*\*\* VALIDATION \*\*\*\*\*  
 PAID ON 02 Oct 2007 AT 08:55  
 RECEIVED BY EVAR 198.245.206.215/2 TRANS# 42  
 AMOUNT PAID \$652.27 BY CHECK#5794  
 TOTAL PAID = \$652.27

\*\*\*\*\*



General Information: 714-741-5307

CITY OF GARDEN GROVE - DEVELOPMENT SERVICES DEPARTMENT

Inspection Requests: 714-741-5332

# PERMIT (PAGE 2 of 2)

## PROJECT/SITE/BUILDING DESCRIPTION

JOB Address : 9670 TRASK AVE  
 Suite :  
 PERMIT NO. : 92806  
 Permit Type : FIRE SUPP.  
 Type : B16  
           FIRE SPRINKLERS  
 Owner : CAR NOA GGT LLC  
 Applicant : ROBERT DURBIN  
 Phone : 714-577-8676

Contractor : LEADING EDGE SOUND & SECURITY  
 Address : 3920 F PROSPECT AVE.  
 CityStZip : YORBA LINDA, CA 92886  
 Phone : 714-577-8676

Insp Dist : FS  
 Date : 11/28/07  
 Parcel No : 09809064

Value : 7000  
 Floor area : 10000

## PROPOSED WORK:

O30 - SPRINKLER  
 INSTALL FIRE ALARM SYSTEM AT AUTO DEALER.

## FEES

111 32073 Permit	1	161.42
111 32401 issuance	1	35.00
942 22130 General Plan	1	9.55
080 32550 Cultural Arts	1	4.70
<b>TOTAL</b>		<b>210.67</b>

APPROVAL	DATE	INSPECTOR
Pre Inspect		
Foundation		
Concrete Floor		
Reinforcing		
Masonry		
Roof Shtg		
Rough Frame		
Insul / Energy		
Drywall		
Lath		
Plas. Brown Ct.		
Landscaping		
Pre Gunite		
Pre Deck		
Pre Plaster		
Planning Final		
Bldg Final	11/28/07	RG Fire
Utility Notified		

Pre Inspect \_\_\_\_\_  
 Foundation \_\_\_\_\_  
 Concrete Floor \_\_\_\_\_  
 Reinforcing \_\_\_\_\_  
 Masonry \_\_\_\_\_  
 Roof Shtg \_\_\_\_\_  
 Rough Frame \_\_\_\_\_  
 Insul / Energy \_\_\_\_\_  
 Drywall \_\_\_\_\_  
 Lath \_\_\_\_\_  
 Plas. Brown Ct. \_\_\_\_\_  
 Landscaping \_\_\_\_\_  
 Pre Gunite \_\_\_\_\_  
 Pre Deck \_\_\_\_\_  
 Pre Plaster \_\_\_\_\_  
 Planning Final \_\_\_\_\_  
 Bldg Final RG Fire 11/28/07  
 Utility Notified \_\_\_\_\_

## AUTHORIZATION

Issued By: yoavs \_\_\_\_\_ Date \_\_\_\_\_

## DECLARATION

I certify that I have read this application/permit and state that the information on all pages of this document is correct. I agree to comply with all City and County ordinances and State laws relating to building construction, and hereby authorize representatives of this City and County to enter upon the above mentioned property for inspection purposes.

Applicant's Signature [Signature]  
 Print Name Robert Durbin Date 11/28/07

\*\*\*\*\* VALIDATION \*\*\*\*\*  
 PAID ON 28 Nov 2007 AT 08:29  
 RECEIVED BY LARAINEM 198.245.206.215/2 TRANS# 4  
 AMOUNT PAID \$210.67 BY CHECK#2756  
 TOTAL PAID = \$210.67

\*\*\*\*\*



# PERMIT (PAGE 2 of 2)



## PROJECT/SITE/BUILDING DESCRIPTION

JOB Address : 9444 TRASK AVE  
 Suite :  
 PERMIT NO. : 92608  
 Permit Type : BUILDING  
 Type : B21  
 MISCELLANEOUS  
 Owner : CAR NOA GGT LLC  
 Applicant :  
 Phone :  
 Contractor : PACIFIC LIFT AND EQUIPMENT COM  
 Address : 61 W MOUNTAIN ST  
 CityStZip : PASADENA, CA 91103  
 Phone : 626-797-4100  
 Insp Dist : ZB  
 Date : 11/06/07  
 Parcel No : 09809063  
 Value : 190000  
 Floor area : 0

## PROPOSED WORK:

O39 - MISCELLEANEOUS

INSTALL MECHANICAL AUTOMOTIVE LIFTS

## FEES

111 32509 PLAN CHECK 65% (\$42.0	1	1130.05
111 32410 Permit	1	1580.49
111 32401 issuance	1	35.00
942 22130 General Plan	1	224.12
080 32550 Cultural Arts	1	110.39
111 32509 PLAN CHECK FEE CREDI	1	-1130.05
<b>TOTAL</b>		<b>1950.00</b>

APPROVAL	DATE	INSPECTOR
Pre Inspect		
Foundation	(PH) 1/15/08	[Signature]
Concrete Floor		
Reinforcing		
Masonry		
Roof Shtg		
Rough Frame		
Insul / Energy		
Drywall		
Lath		
Plas. Brown Ct.		
Landscaping		
Pre Gunite		
Pre Deck		
Pre Plaster		
Planning Final		
Bldg Final	2/7/08	[Signature]
Utility Notified		

## AUTHORIZATION

Issued By: yoavs Date

## DECLARATION

I certify that I have read this application/permit and state that the information on all pages of this document is correct. I agree to comply with all City and County ordinances and State laws relating to building construction, and hereby authorize representatives of this City and County to enter upon the above mentioned property for inspection purposes.

Applicant's Signature [Signature]  
 Print Name Bruno Cusick Date 11-6-07

\*\*\*\*\* VALIDATION \*\*\*\*\*  
 PAID ON 06 Nov 2007 AT 10:53  
 RECEIVED BY EVAR 198.245.206.215/2 TRANS# 98  
 AMOUNT PAID \$1950.00 BY CHECK#12498  
 TOTAL PAID = \$1950.00

\*\*\*\*\*



General Information: 714-741-5307

CITY OF GARDEN GROVE - DEVELOPMENT SERVICES DEPARTMENT

Inspection Requests: 714-741-5332

# PERMIT (PAGE 2 of 2)

## PROJECT/SITE/BUILDING DESCRIPTION

JOB Address : 9444 TRASK AVE  
 Suite :  
 PERMIT NO. : 93439  
 Permit Type : BUILDING  
 Type : B21  
           MISCELLANEOUS  
 Owner : CAR NOA GGT LLC  
 Applicant :  
 Phone :  
 Contractor : PACIFIC LIFT AND EQUIPMENT COM  
 Address : 61 W MOUNTAIN ST  
 CityStZip : PASADENA, CA 91103  
 Phone : 626-797-4100  
 Insp Dist : ZB  
 Date : 02/06/08  
 Parcel No : 09809063  
 Value : 20000  
 Floor area : 0

## PROPOSED WORK:

O39 - MISCELLEANEOUS

ADDING AN ALIGNMENT RACK RECESSED IN A PIT  
(SUPPLEMENTAL PERMIT TO BLDG. P ERMIT #  
92608).

## FEES

111 32410 Permit	1	337.11
111 32401 SUPPLEMENT PERMIT/FE	1	15.00
<b>TOTAL</b>		<b>352.11</b>

APPROVAL      DATE      INSPECTOR

Pre Inspect \_\_\_\_\_  
 Foundation \_\_\_\_\_  
 Concrete Floor \_\_\_\_\_  
 Reinforcing \_\_\_\_\_  
 Masonry \_\_\_\_\_  
 Roof Shtg \_\_\_\_\_  
 Rough Frame \_\_\_\_\_  
 Insul / Energy \_\_\_\_\_  
 Drywall \_\_\_\_\_  
 Lath \_\_\_\_\_  
 Plas. Brown Ct. \_\_\_\_\_  
 Landscaping \_\_\_\_\_  
 Pre Gunite \_\_\_\_\_  
 Pre Deck \_\_\_\_\_  
 Pre Plaster \_\_\_\_\_  
 Planning Final \_\_\_\_\_  
 Bldg Final 2/11/08 [Signature]  
 Utility Notified \_\_\_\_\_

## AUTHORIZATION

Issued By: yoavs      Date \_\_\_\_\_

## DECLARATION

I certify that I have read this application/permit and state that the information on all pages of this document is correct. I agree to comply with all City and County ordinances and State laws relating to building construction, and hereby authorize representatives of this City and County to enter upon the above mentioned property for inspection purposes.

Applicant's Signature [Signature]  
Print Name Bruno Cisick Date 2-6-08

\*\*\*\*\* VALIDATION \*\*\*\*\*  
 PAID ON 06 Feb 2008 AT 11:37  
 RECEIVED BY RONP 198.245.206.215/2 TRANS# 78  
 AMOUNT PAID \$352.11 BY CHECK#12778  
 TOTAL PAID = \$352.11

\*\*\*\*\*



General Information: 714-741-5307

CITY OF GARDEN GROVE - DEVELOPMENT SE

quest 741-5332

# PERMIT (PAGE 2 of

## PROJECT/SITE/BUILDING DESCRIPTION

JOB Address : 9670 TRASK AVE  
 Suite :  
 PERMIT NO. : 87614  
 Permit Type : DEMO  
 Type : B15  
 DEMOLITIONS - OTHERS  
 Owner : LA DON G HIX  
 Applicant : BRENT OSBORN  
 Phone : 949-362-0956

Contractor : SAUERS CONSTRUCTION  
 Address : 26469 RANCHO PARKWAY SOUTH  
 CityStZip : LAKE FOREST, CA 92630  
 Phone : 949-362-0756

Insp Dist : ZB  
 Date : 10/20/06  
 Parcel No : 09809064

Value : 45000  
 Floor area : 0

## PROPOSED WORK: ✓

O38 - DEMO OTHER  
 DEMO COMMERCIAL BLDG AT TOYOTA OF GARDEN GROVE.

## FEES

111 32509 PLAN CHECK 65% \$42.0	1	
111 32410 Permit	1	621.95
111 32401 issuance	1	35.00
942 22130 General Plan	1	54.
080 32550 Cultural Arts	1	26.6
<b>TOTAL</b>		<b>737.70</b>

APPROVAL      DATE      INSPECTOR

Pre Inspect \_\_\_\_\_  
 Foundation See Brent Osborn Report  
 Concrete Floor See Report  
 Reinforcing \_\_\_\_\_  
 Masonry \_\_\_\_\_  
 Roof Shtg \_\_\_\_\_  
 Rough Frame See Report  
 Insul / Energy \_\_\_\_\_  
 Drywall See Report  
 Lath See Report  
 Plas. Brown Ct See Report  
 Landscaping \_\_\_\_\_  
 Pre Gunite \_\_\_\_\_  
 Pre Deck \_\_\_\_\_  
 Pre Plaster \_\_\_\_\_

## AUTHORIZATION

Planning Final \_\_\_\_\_  
 Bldg Final 2/19/08 B. Garcia Issued By: j.mc Date \_\_\_\_\_

## DECLARATION

I certify that I have read this application/permit and state that the information on all pages of this document is correct. I agree to comply with all City and County ordinances and State laws relating to building construction, and hereby authorize representatives of this City and County to enter upon the above mentioned property for inspection purposes.

Applicant's Signature Jaime Ramos  
 Print Name JAIME RAMOS Date 4/19/07

\*\*\*\*\* VALIDATION \*\*\*\*\*  
 PAID ON 19 Apr 2007 AT 08:18  
 RECEIVED BY RONP 198.245.206.215/2 TRANS# 13  
 AMOUNT PAID \$737.70 BY CHECK#8106  
 TOTAL PAID = \$737.70

\*\*\*\*\*



General Information: 714-741-5307

CITY OF GARDEN GROVE - DEVELOPMENT SERVICES DEPARTMENT

Inspection Requests: 714-741-5332

# PERMIT (PAGE 2 of 2)

## PROJECT/SITE/BUILDING DESCRIPTION

JOB Address : 9670 TRASK AVE  
 Suite :  
 PERMIT NO. : 89893  
 Permit Type : DEMO  
 Type : B15  
 DEMOLITIONS - OTHERS  
 Owner : LA DON G HIX  
 Applicant :  
 Phone :  
 Contractor : SAUERS CONSTRUCTION  
 Address : 26469 RANCHO PARKWAY SOUTH  
 CityStZip : LAKE FOREST, CA 92630  
 Phone : 949-362-0756  
 Insp Dist : ZB  
 Date : 04/18/07  
 Parcel No : 09809064  
 Value : 15000  
 Floor area : 0

## PROPOSED WORK:

O38 - DEMO OTHER

DEMO COMMERCIAL BLDG USED FOR AUTO SALES

## FEEES

111 32410 Permit	1	269.54
111 32401 issuance	1	35.00
942 22130 General Plan	1	18.93
080 32550 Cultural Arts	1	9.32
<b>TOTAL</b>		<b>332.79</b>

APPROVAL      DATE      INSPECTOR

Pre Inspect \_\_\_\_\_  
 Foundation \_\_\_\_\_  
 Concrete Floor \_\_\_\_\_  
 Reinforcing \_\_\_\_\_  
 Masonry \_\_\_\_\_  
 Roof Shtg \_\_\_\_\_  
 Rough Frame \_\_\_\_\_  
 Insul / Energy \_\_\_\_\_  
 Drywall \_\_\_\_\_  
 Lath \_\_\_\_\_  
 Plas.Brown Ct. \_\_\_\_\_  
 Landscaping \_\_\_\_\_  
 Pre Gunitite \_\_\_\_\_  
 Pre Deck \_\_\_\_\_  
 Pre Plaster \_\_\_\_\_  
 \_\_\_\_\_  
 Planning Final \_\_\_\_\_  
 \_\_\_\_\_  
 Bldg Final 2/19/08 RAMOS  
 \_\_\_\_\_  
 Utility Notified \_\_\_\_\_

## AUTHORIZATION

Issued By: yoavs      Date \_\_\_\_\_

## DECLARATION

I certify that I have read this application/permit and state that the information on all pages of this document is correct. I agree to comply with all City and County ordinances and State laws relating to building construction, and hereby authorize representatives of this City and County to enter upon the above mentioned property for inspection purposes.

Applicant's Signature Jaime Ramos  
 Print Name JAIME RAMOS Date 4/18/07

\*\*\*\*\* VALIDATION \*\*\*\*\*  
 PAID ON 18 Apr 2007 AT 09:10  
 RECEIVED BY RONP 198.245.206.215/2 TRANS# 12  
 CASH PAID = \$400.00 CASH RETURNED = \$67.21  
 TOTAL PAID = \$332.79

\*\*\*\*\*



General Information: 714-741-5307

CITY OF GARDEN GROVE - DEVELOPMENT SERVICES DEPARTMENT

Inspection Requests: 714-741-5332

# PERMIT (PAGE 2 of 2)

## PROJECT/SITE/BUILDING DESCRIPTION

JOB Address : 9670 TRASK AVE  
 Suite :  
 PERMIT NO. : 90256  
 Permit Type : GRADING  
 Type : B20  
 GRADING  
 Owner : LA DON G HIX  
 Applicant : BRENT OSBORN  
 Phone : 949-598-9544

Contractor : SAUERS CONSTRUCTION  
 Address : 26469 RANCHO PARKWAY SOUTH  
 CityStZip : LAKE FOREST, CA 92630  
 Phone : 949-362-0756

Insp Dist : ZB  
 Date : 05/09/07  
 Parcel No : 09809064

## PROPOSED WORK:

07 - GRADING

GRADING & REVAMPING PARKING LOT. TOYOTA OF GARDEN GROVE.

## FEES

111 32520 GRADING PLAN CHECK	1	60.00
111 32290 GRADING PERMIT	1	60.00
111 32401 issuance	1	35.00
111 32520 ADDL. GRADING \$90.00	4	360.00
111 32520 ADDL. GRADING \$90.00	12	1080.00
111 32290 GRADING INSP. DEPOSI	1	1500.00
111 32520 GRADING PLAN CHECK	1	-125.00
<b>TOTAL</b>		<b>2970.00</b>

Value : 2000  
 Floor area : 100  
 \*\*\*\*\* VALIDATION \*\*\*\*\*  
 PAID ON 09 May 2007 AT 11:18  
 RECEIVED BY EVAR 198.245.206.215/2 TRANS# 53  
 AMOUNT PAID \$2970.00 BY CHECK#181027  
 TOTAL PAID = \$2970.00

### \*\*\*\*\*DATE\*\*\*\*\*HOURS\*\*\*\*\*

Pre Const	_____	_____
Rough Grade	_____	_____
Concrete	_____	_____
Asphalt	_____	_____
Storm Drain	_____	_____
Water	_____	_____
Final Grade	_____	_____
Misc.	_____	_____
Total Hours	_____	_____

Inspector 2/19/08 RBM  
 Remarks per final grade cert attached.

## AUTHORIZATION

Issued By: yoavs Date \_\_\_\_\_

## DECLARATION

I certify that I have read this application/permit and state that the information on all pages of this document is correct. I agree to comply with all City and County ordinances and State laws relating to building construction, and hereby authorize representatives of this City and County to enter upon the above mentioned property for inspection purposes.

Applicant's Signature [Signature]  
 Print Name Ryan Sauers Date 5/9/07



General Information: 714-741-5307

CITY OF GARDEN GROVE - DEVELOPMENT SERVICES DEPARTMENT

Inspection Requests: 714-741-5332

# PERMIT (PAGE 2 of 2)

## PROJECT/SITE/BUILDING DESCRIPTION

JOB Address : 9670 TRASK AVE  
 Suite :  
 PERMIT NO. : 90288  
 Permit Type : BUILDING  
 Type : B7  
 ALTERATIONS TO OTHER BUILDINGS  
 Owner : LA DON G HIX  
 Applicant : BRENT OSBORN  
 Phone : 949-598-9544

Contractor : SAUERS CONSTRUCTION  
 Address : 26469 RANCHO PARKWAY SOUTH  
 CityStZip : LAKE FOREST, CA 92630  
 Phone : 949-362-0756

Insp Dist : ZB  
 Date : 05/10/07  
 Parcel No : 09809064

Value : 1500000  
 Floor area : 0

## PROPOSED WORK:

043 - T.I. COMMERCIAL  
 T.I. & SERVICE CANOPY FOR TOYOTA OF G.G.

## FEEES

111 32410 Permit	1	7141.02
111 32401 issuance	1	35.00
<b>TOTAL</b>		<b>7176.02</b>

APPROVAL	DATE	INSPECTOR
Pre Inspect		
Foundation		
Concrete Floor		
Reinforcing		
Masonry		
Roof Shtg		
Rough Frame		
Insul / Energy		
Drywall		
Lath		
Plas. Brown Ct.		
Landscaping		
Pre Gunite		
Pre Deck		
Pre Plaster		
Planning Final		
Bldg Final	2/19/08	[Signature]
Utility Notified		

## AUTHORIZATION

Issued By: yoavs \_\_\_\_\_ Date \_\_\_\_\_

## DECLARATION

I certify that I have read this application/permit and state that the information on all pages of this document is correct. I agree to comply with all City and County ordinances and State laws relating to building construction, and hereby authorize representatives of this City and County to enter upon the above mentioned property for inspection purposes.

Applicant's Signature [Signature]  
 Print Name JAMES RAMOS Date 5/10/07

\*\*\*\*\* VALIDATION \*\*\*\*\*  
 PAID ON 10 May 2007 AT 16:58  
 RECEIVED BY EVAR 198.245.206.215/2 TRANS# 190  
 AMOUNT PAID \$9374.55 BY CHECK#181051  
 TOTAL PAID = \$9374.55

\*\*\*\*\*



**CITY OF GARDEN GROVE - COMMUNITY DEVELOPMENT DEPARTMENT**  
**Plot Plan Form**

Planning Action:	Zone: <u>PD</u>	Coverage:	Job Address: <u>9670 Trask</u>	Permit No.: <u>90288</u>
Approved By: <u>[Signature]</u>	Date: <u>4/20/07</u>	Increase:	Assessor Parcel No.:	Tract & Lot #:
Remarks:			Occupancy:	Const. Type:
			<input type="checkbox"/> New	<input type="checkbox"/> Alter <input type="checkbox"/> Add <input type="checkbox"/> Repair <input type="checkbox"/> Demo

**Job Description:**

T.I. and addition to car Dealership Bldg.

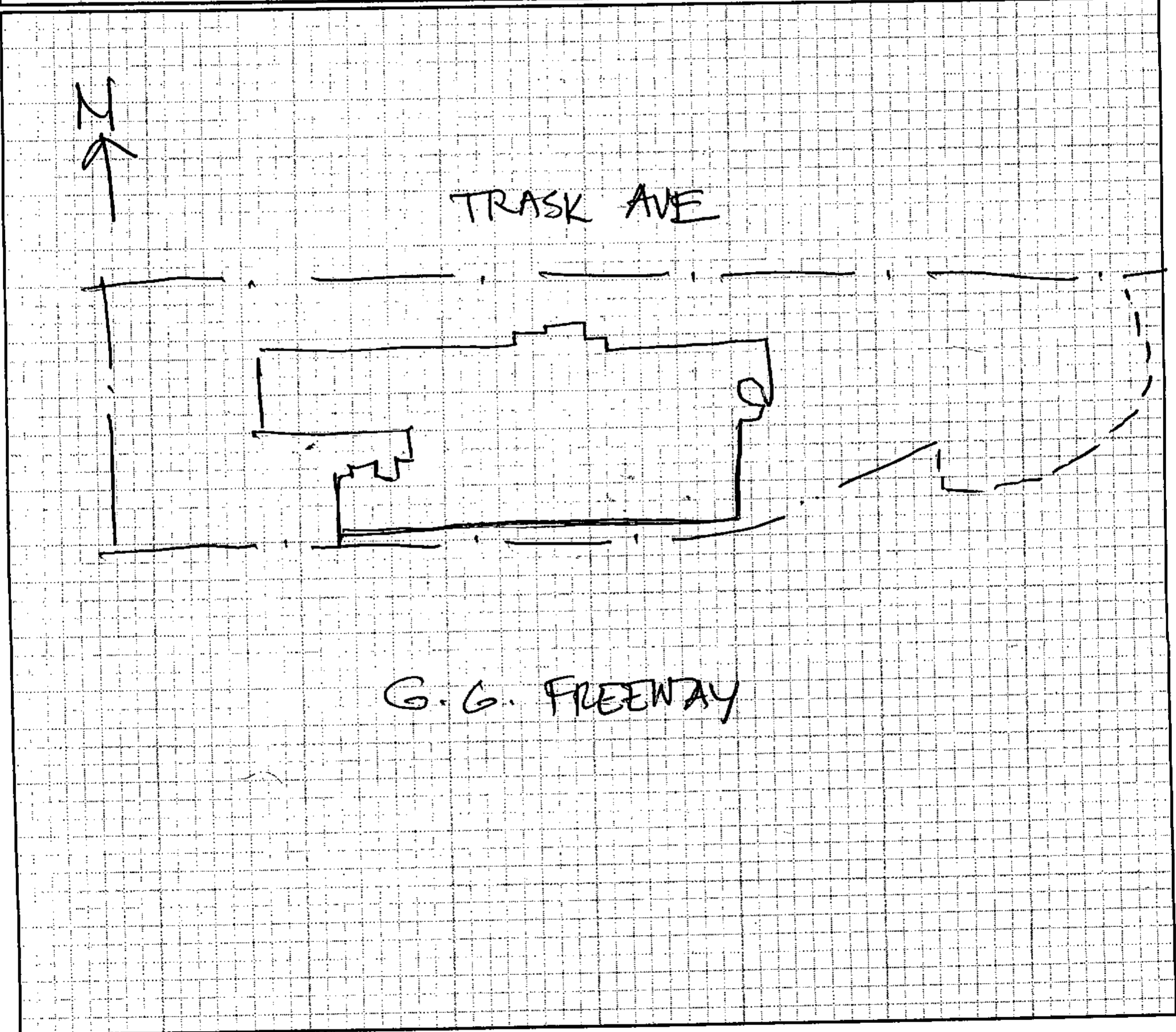

I certify the information hereon is complete & correct.

Owner's Name (print)

Signature (owner/agent)

Date

WHITE: INSPECTION

YELLOW: ASSESSOR

PINK: PERMITTEE

**City of Garden Grove  
Community Development Department**

**Certificate of Occupancy**

The building (or portion thereof) described below has been inspected for compliance with the requirements of the applicable codes and ordinances for the group and division of occupancy and the use for which the proposed occupancy is classified.

**BUILDING/SITE INFORMATION**

Building Address: 9670 TRASK AVENUE Permit: 90288

Use of Building: AUTO SALES/SERVICE Use Zone: PUD

Occupancy: B. M. S-3, S-1 Type of Construction: VN Sprinklered: YES

TENANT IMPROVEMENT TO EXISTING BUILDING AND 8,994 SQ. FT.  
EXPANDED BUILDING AREA (TOYOTA OF GARDEN GROVE)

**OWNER INFORMATION**

Owner's Name: NOARUS AUTOMOTIVE GROUP

Street Address: 6701 CENTER DRIVE WEST, STE. 925

City: LOS ANGELES State: CA Zip: 90045

**CLEARANCES**

Building Division Approval: *Paul B. Mann* Date: 2/15/08

Planning Division Approval: *Paul Gust* Date: 2-12-08

Engineering Division Approval: *[Signature]* Date: 2/13/08

Fire Dept. Approval: *SUSOTTO* Date: 2/13/08

**ADVISEMENT**

Issuance of a Certificate of Occupancy shall not be construed as an approval of a violation of the provisions of the applicable codes or other ordinances of this jurisdiction. Certificates presuming to give authority to violate or cancel the provisions of the applicable codes or other ordinances of this jurisdiction shall not be valid. This Certificate is revocable pursuant to Section 109.6 of the Uniform Building Code.

Susan Emery, Director  
Building Services Manager

*Russ Schuller for Susan Emery* Date: 2-19-08  
*Acting Bldg Serv. Mgr.*

**POST IN A CONSPICUOUS PLACE**



General Information: 714-741-5307

CITY OF GARDEN GROVE - DEVELOPMENT SERVICES DEPARTMENT

Inspection Requests: 714-741-5332

# PERMIT (PAGE 2 of 2)

## PROJECT/SITE/BUILDING DESCRIPTION

JOB Address : 9670 TRASK AVE  
 Suite :  
 PERMIT NO. : 94486  
 Permit Type : BUILDING  
 Type : B21  
 MISCELLANEOUS  
 Owner : CAR NOA GGT LLC  
 Applicant : ADRIAN CASTANEDA  
 Phone : 714-683-1120

Contractor : P.S. SERVICES  
 Address : 2820 E. GRETТА LANE  
 CityStZip : ANAHEIM, CA 92806  
 Phone : 714-683-1120

Insp Dist : SB  
 Date : 05/12/08  
 Parcel No : 09809064

Value : 1  
 Floor area :

## PROPOSED WORK:

CHANGE OF CONTRACTOR PERMIT FOR PERMIT #94286 & 94287.

## FEES

111 32401 issuance	1	35.00
TOTAL		35.00

### APPROVAL DATE INSPECTOR

Pre Inspect \_\_\_\_\_  
 Foundation 6-6-08 T.H.  
 Concrete Floor \_\_\_\_\_  
 Reinforcing \_\_\_\_\_  
 Masonry \_\_\_\_\_  
 Roof Shtg \_\_\_\_\_  
 Rough Frame \_\_\_\_\_  
 Insul / Energy \_\_\_\_\_  
 Drywall \_\_\_\_\_  
 Lath \_\_\_\_\_  
 Plas. Brown Ct. \_\_\_\_\_  
 Landscaping \_\_\_\_\_  
 Pre Gunite \_\_\_\_\_  
 Pre Deck \_\_\_\_\_  
 Pre Plaster \_\_\_\_\_

Planning Final \_\_\_\_\_  
 Bldg Final 10-20-08 T.H.  
 Utility Notified \_\_\_\_\_

## AUTHORIZATION

Issued By: jimc Date \_\_\_\_\_

## DECLARATION

I certify that I have read this application/permit and state that the information on all pages of this document is correct. I agree to comply with all City and County ordinances and State laws relating to building construction, and hereby authorize representatives of this City and County to enter upon the above mentioned property for inspection purposes.

Applicant's Signature [Signature]  
 Print Name ADRIAN CASTANEDA Date 05/12/08

\*\*\*\*\* VALIDATION \*\*\*\*\*  
 PAID ON 12 May 2008 AT 12:42  
 RECEIVED BY JEFFKU 198.245.206.215/2 TRANS# 85  
 AMOUNT PAID \$35.00 BY CHECK#2197  
 TOTAL PAID = \$35.00

\*\*\*\*\*



General Information: 714-741-5307

CITY OF GARDEN GROVE - DEVELOPMENT SERVICES DEPARTMENT

Inspection Requests: 714-741-5332

# PERMIT (PAGE 2 of 2)

## PROJECT/SITE/BUILDING DESCRIPTION

JOB Address : 9444 TRASK AVE  
 Suite : 9678  
 PERMIT NO. : 93088  
 Permit Type : BUILDING  
 Type : B21  
 MISCELLANEOUS  
 Owner : CAR NOA GGT LLC  
 Applicant : PACIFIC LIFT AND EQUIPMENT  
 Phone : 626-255-6814  
 Contractor : PACIFIC LIFT AND EQUIPMENT COM  
 Address : 61 W MOUNTAIN ST  
 CityStZip : PASADENA, CA 91103  
 Phone : 626-797-4100

Insp Dist : ZB  
 Date : 01/03/08  
 Parcel No : 09809063

Value : 15000  
 Floor area : 0

## PROPOSED WORK:

O39 - MISCELLEANEOUS  
 INSTALL ABOVEGROUND OIL STORAGE TANKS

## FEES

111 32509 PLAN CHECK 65%(\$42.0	1	192.72
111 32410 Permit	1	269.54
111 32401 issuance	1	35.00
942 22130 General Plan	1	18.93
080 32550 Cultural Arts	1	9.32
111 32509 PLAN CHECK FEE CREDI	1	-192.72
<b>TOTAL</b>		<b>332.79</b>

APPROVAL      DATE      INSPECTOR

Pre Inspect \_\_\_\_\_  
 Foundation \_\_\_\_\_  
 Concrete Floor \_\_\_\_\_  
 Reinforcing \_\_\_\_\_  
 Masonry \_\_\_\_\_  
 Roof Shtg \_\_\_\_\_  
 Rough Frame \_\_\_\_\_  
 Insul / Energy \_\_\_\_\_  
 Drywall \_\_\_\_\_  
 Lath \_\_\_\_\_  
 Plas. Brown Ct. \_\_\_\_\_  
 Landscaping \_\_\_\_\_  
 Pre Gunitite \_\_\_\_\_  
 Pre Deck \_\_\_\_\_  
 Pre Plaster \_\_\_\_\_  
 Planning Final \_\_\_\_\_  
 Bldg Final \_\_\_\_\_  
 Utility Notified \_\_\_\_\_

**EXPIRED**  
 12/19/08

## AUTHORIZATION

Issued By: yoavs      Date \_\_\_\_\_

## DECLARATION

I certify that I have read this application/permit and state that the information on all pages of this document is correct. I agree to comply with all City and County ordinances and State laws relating to building construction, and hereby authorize representatives of this City and County to enter upon the above mentioned property for inspection purposes.

Applicant's Signature Bruno Cusick  
 Print Name Bruno Cusick Date 1-3-08

\*\*\*\*\* VALIDATION \*\*\*\*\*  
 PAID ON 03 Jan 2008 AT 11:09  
 RECEIVED BY YESENIAV 198.245.206.215/2 TRANS# 97  
 AMOUNT PAID \$911.82 BY CHECK#12588  
 TOTAL PAID = \$911.82

\*\*\*\*\*



**CITY OF GARDEN GROVE  
BUILDING SERVICES**

General Info : 714-741-5307  
Inspection Requests : 714-741-5332

**9670 TRASK AVE**  
PERMIT#:12-0543  
ISSUED:3/8/12

<b>Owner</b> CAR NOA GGT LLC			Telephone			Zip 92844			<b>Building Address</b> 9670 TRASK AVE																																							
Address 9670 TRASK AVE			City Garden Grove			State CA			<b>Suite/Unit/Building</b>																																							
<b>Applicant</b> SUPERIOR AWNING			Telephone 714-654-6440			Zip 91402			TYPE Miscellaneous																																							
Address 14555 TITUS			City VAN NUYS			State CA			ISSUED BY Yoav Shernock																																							
State Licence 589431		Expires N/A		City Licence		Expires		Inspector Dist. N14		Parcel Number 09809064		LOT	TRACT																																			
<b>Contractor</b> SUPERIOR AWNING			Telephone 714-654-6440			Zip 91402			<b>Valuation</b> \$13,500.00																																							
Address 14555 TITUS			City VAN NUYS			State CA			<b>Final</b> Inspector's Signature <u>R Price</u> Date <u>5-1-2012</u>																																							
State Licence 589431		Expires N/A		City Licence		Expires		<table border="1" style="width:100%; border-collapse: collapse;"> <tr> <th style="writing-mode: vertical-rl; transform: rotate(180deg);">F E E S</th> <th>Description</th> <th>Quantity</th> <th>Amount</th> </tr> <tr> <td></td> <td>General Plan Update Fee, Valuation</td> <td></td> <td>\$17.67</td> </tr> <tr> <td></td> <td>Cultural Arts Fee, Valuation</td> <td></td> <td>\$8.83</td> </tr> <tr> <td></td> <td>Plan Check Fee</td> <td></td> <td>\$166.41</td> </tr> <tr> <td></td> <td>BSASRF State Fee</td> <td></td> <td>\$1.00</td> </tr> <tr> <td></td> <td>Issuance Fee</td> <td>1</td> <td>\$35.00</td> </tr> <tr> <td></td> <td>One-Stop Permit Center Surcharge</td> <td></td> <td>\$5.02</td> </tr> <tr> <td></td> <td>Building Permit Fee</td> <td></td> <td>\$251.00</td> </tr> <tr> <td></td> <td><b>TOTAL</b></td> <td></td> <td><b>\$484.93</b></td> </tr> </table>					F E E S	Description	Quantity	Amount		General Plan Update Fee, Valuation		\$17.67		Cultural Arts Fee, Valuation		\$8.83		Plan Check Fee		\$166.41		BSASRF State Fee		\$1.00		Issuance Fee	1	\$35.00		One-Stop Permit Center Surcharge		\$5.02		Building Permit Fee		\$251.00		<b>TOTAL</b>		<b>\$484.93</b>
F E E S	Description	Quantity	Amount																																													
	General Plan Update Fee, Valuation		\$17.67																																													
	Cultural Arts Fee, Valuation		\$8.83																																													
	Plan Check Fee		\$166.41																																													
	BSASRF State Fee		\$1.00																																													
	Issuance Fee	1	\$35.00																																													
	One-Stop Permit Center Surcharge		\$5.02																																													
	Building Permit Fee		\$251.00																																													
	<b>TOTAL</b>		<b>\$484.93</b>																																													
Floor Area(sq. ft.)		Residential/Commercial		Commercial																																												
Job Description STEEL-FRAME CANOPY WITH FABRIC COVER AND PAINTED SIGNAGE AT AUTO DEALERSHIP BUILDING																																																
<p align="center"><b>DECLARATION</b></p> <p>I certify that I have read this application/permit and state that the information on all pages of this document is correct. I agree to comply with all City and County ordinances and State laws relating to building construction, and hereby authorize representatives of this City and County to enter upon the above mentioned property for inspection purposes.</p>																																																
X Applicant's Signature <u>[Signature]</u>			Print Name <u>Drew Sullivan</u>			Date <u>3/08/2012</u>																																										

*This is a building permit when property filled out, signed and validated, and is subject to expiration if work thereunder is suspended for 180 days.*

ORIGINAL

Permit Type: BLDG

CITY OF GARDEN GROVE - COMMUNITY DEVELOPMENT DEPARTMENT

Plot Plan Form

Planning Action: <i>Approval</i>	Zone: <i>RD16382</i>	Coverage:
Approved By: <i>[Signature]</i>	Date: <i>8/24/12</i>	Increase:
Remarks:		

Job Address: <i>9670 TRASK AVE</i>	Permit No.: <i>12-0543</i>
Assessor Parcel No.:	Tract & Lot #:
Occupancy:	Const. Type:
<input type="checkbox"/> New <input type="checkbox"/> Alter <input type="checkbox"/> Add <input type="checkbox"/> Repair <input type="checkbox"/> Demo	

**Job Description:** *MANUFACTURE & INSTALL (1) FREESTANDING CANOPY WITH FOOTINGS*

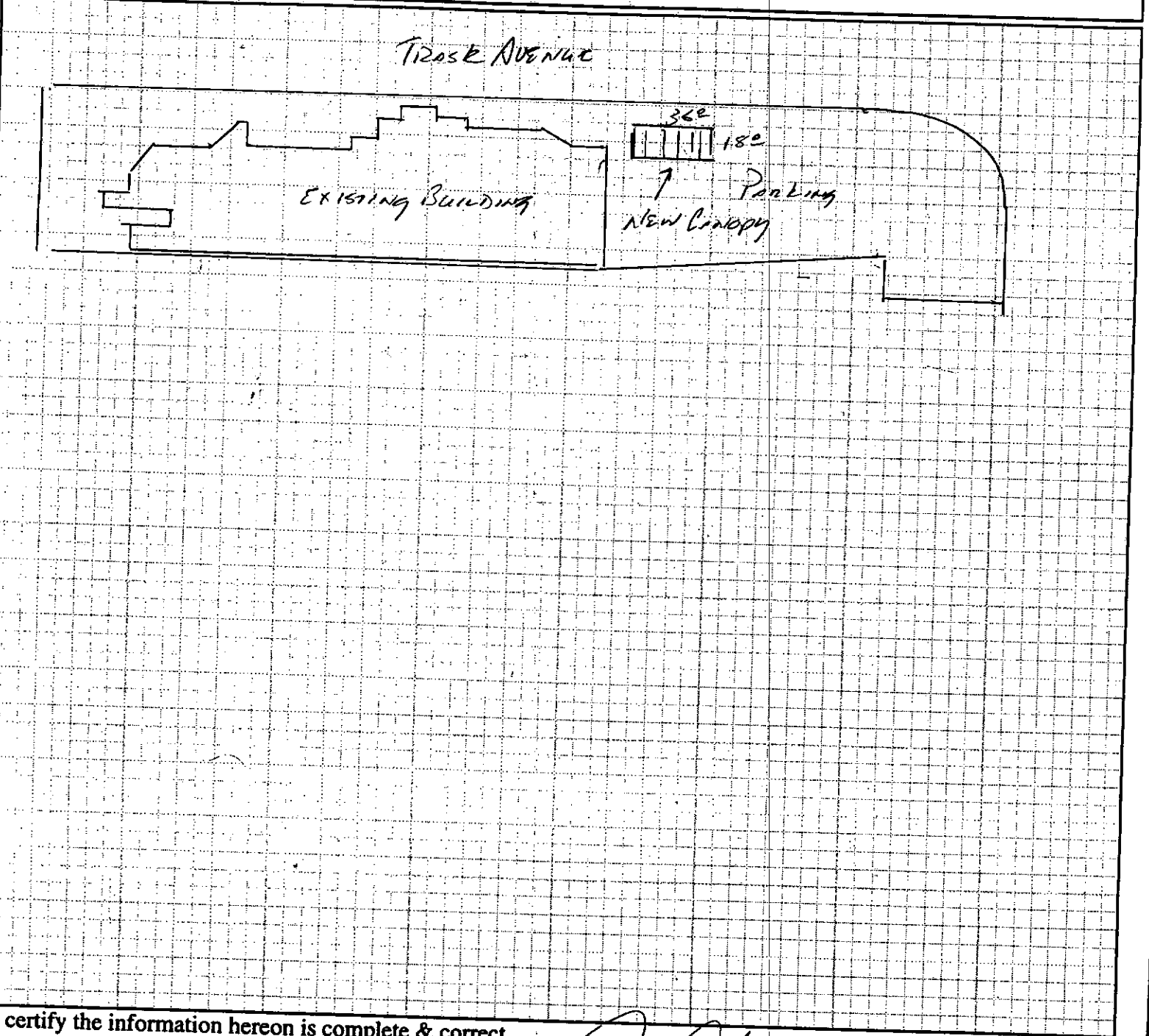

I certify the information hereon is complete & correct.

*DEVON SNEYDER*  
Owner's Name (print)

*[Signature]*  
Signature (owner/agent)

*1/30/2012*  
Date