



General Information: 714-741-5307

CITY OF GARDEN GROVE - DEVELOPMENT SERVICES DEPARTMENT

Inspection Requests: 714-741-5332

PERMIT (PAGE 2 of 2)

PROJECT/SITE/BUILDING DESCRIPTION

JOB Address : 11762 STUART DR
 Suite :
 PERMIT NO. : 43948
 Permit Type : BUILDING
 Type : B21
 MISCELLANEOUS
 Owner : JAMBOREE HOUSING CORP
 Applicant : RPM PROPERTY SERVICES INC.
 Appl Address : 6141 ORANGE AVE, #1
 CYPRESS, CA 90630
 Phone : 995-7330

Insp Dist : Q13
 Date : 08/11/98
 Parcel No : 10050302

Value :15000
 Floor area :0

PROPOSED WORK:

REMOVE EXIST. LOUVERED WINDOWS (52), INSTALL
 HORIZONTAL SLIDING WINDOWS.

FEES

111 32410 Permit	1	239.96
111 32401 Issuance	1	30.00
111 32429 Strong Motion Fee (R	1	1.50
942 22130 General Plan	1	18.93
080 32550 Cultural Arts	1	9.32
TOTAL		299.71

INSPECTION RECORD

APPROVAL DATE INSPECTOR

Pre Inspect _____
 Foundation _____
 Concrete Floor _____
 Reinforcing _____
 Masonry _____
 Roof Shtg _____
 Rough Frame _____
 Insul / Energy _____
 Drywall _____
 Lath _____
 Plas.Brown Ct. _____
 Landscaping _____
 Pre Gunite _____
 Pre Deck _____
 Pre Plaster _____

 Planning Final _____

Bldg Final 10-20-98 

Utility Notified _____

***** VALIDATION *****
 PAID ON 11 Aug 1998 AT 17:05
 RECEIVED BY DOXIE 198.245.206.215/2 TRANS# 220
 AMOUNT PAID \$499.57 BY CHECK#2626
 TOTAL PAID = \$499.57

AUTHORIZATION

Issued By: dianeb Date _____

DECLARATION

I certify that I have read this application/permit and state that the information on all pages of this document is correct. I agree to comply with all City and County ordinances and State laws relating to building construction, and hereby authorize representatives of this City and County to enter upon the above mentioned property for inspection purposes.

Applicant's Signature 

Print Name Phil Dunford Date 8/11/98



General Information: 714-741-5307

CITY OF GARDEN GROVE - DEVELOPMENT SERVICES DEPARTMENT

Inspection Requests: 714-741-5332

PERMIT (PAGE 2 of 2)

PROJECT/SITE/BUILDING DESCRIPTION

JOB Address : 11762 STUART DR
 Suite :
 PERMIT NO. : 43949
 Permit Type :
 Type : E

Owner : JAMBOREE HOUSING CORP
 Applicant : RPM PROPERTY SERVICES INC.
 Appl Address : 6141 ORANGE AVE, #1
 CYPRESS, CA 90630
 Phone : 995-7330

Insp Dist : Q13
 Date : 08/11/98
 Parcel No : 10050302

PROPOSED WORK:

CONVERT 18 EXTERIOR INCANDESCENT LIGHT FIXTURES TO 9 WATT FLUOR.

FEES

942 22130 GENERAL PLAN	1	2.00
080 32550 CULTURAL ARTS	1	1.00
111 32401 Issuance	1	30.00
111 32412 Fixtures 1-20	20	16.00
111 32412 Fixtures over-20	2	1.10
TOTAL		50.10

APPROVAL _____ DATE _____ INSPECTOR _____
INSPECTION RECORD
 Underground _____
 Conduit _____
 Wiring - Rough _____
 Heater _____
 Fixtures & Trim _____
 Motors _____
 Ufer _____
 Service _____

FINAL 10/20/98
 Utility Notified _____

***** VALIDATION *****
PAID ON 11 Aug 1998 AT 17:05
RECEIVED BY DOXIE 198.245.206.215/2 TRANS# 220
AMOUNT PAID \$499.57 BY CHECK#2626
TOTAL PAID = \$499.57

AUTHORIZATION

Issued By: dianeb Date _____

DECLARATION

I certify that I have read this application/permit and state that the information on all pages of this document is correct. I agree to comply with all City and County ordinances and State laws relating to building construction, and hereby authorize representatives of this City and County to enter upon the above mentioned property for inspection purposes.

Applicant's Signature

Print Name Phil Dunford Date 8/11/98



General Information: 714-741-5307

CITY OF GARDEN GROVE - DEVELOPMENT SERVICES DEPARTMENT

Inspection Requests: 714-741-5332

PERMIT (PAGE 2 of 2)

PROJECT/SITE/BUILDING DESCRIPTION

JOB Address : 11762 STUART DR
 Suite :
 PERMIT NO. : 42555
 Permit Type : BUILDING
 Type : B33
 REPAIRS
 Owner : JAMBOREE HOUSING CORP
 Applicant : WEATHER-TITE ROOFING
 Appl Address : 23704-5 EL TORO RD #320
 LAKE FOREST, CA 92630
 Phone : 768-4992

Insp Dist : Q13
 Date : 05/18/98
 Parcel No : 10050302

Value : 9000
 Floor area : 0

PROPOSED WORK:

T/O & REROOF W/15# FELT & 20YR SAPHALTIC SHINGLES

FEES

111 32410 Permit	1	158.04
111 32401 Issuance	1	30.00
942 22130 General Plan	1	11.89
080 32550 Cultural Arts	1	5.86
TOTAL		205.79

INSPECTION RECORD

APPROVAL	DATE	INSPECTOR
Pre Inspect		
Foundation		
Concrete Floor		
Reinforcing		
Masonry	5-21-98	<i>[Signature]</i>
Roof Shtg		
Rough Frame		
Insul / Energy		
Drywall		
Lath		
Plas. Brown Ct.		
Landscaping		
Pre Gunite		
Pre Deck		
Pre Plaster		
Planning Final		
Bldg Final	5-28-98	<i>[Signature]</i>
Utility Notified		

AUTHORIZATION

Issued By: valq _____ Date _____

DECLARATION

I certify that I have read this application/permit and state that the information on all pages of this document is correct. I agree to comply with all City and County ordinances and State laws relating to building construction, and hereby authorize representatives of this City and County to enter upon the above mentioned property for inspection purposes.

Applicant's Signature Rosendo Deros

Print Name Rosendo Deros Date 5-18-98

***** VALIDATION *****
 PAID ON 18 May 1998 AT 11:58
 RECEIVED BY DOXIE 198.245.206.11/2 TRANS# 63
 AMOUNT PAID \$205.79 BY CHECK#4297
 TOTAL PAID = \$205.79



General Information: 714-741-5307

CITY OF GARDEN GROVE - DEVELOPMENT SERVICES DEPARTMENT

Inspection Requests: 714-741-5332

PERMIT (PAGE 2 of 2)

PROJECT/SITE/BUILDING DESCRIPTION

JOB Address : 11762 STUART DR
 Suite :
 PERMIT NO. : 43495
 Permit Type :
 Type : P

Owner : JAMBOREE HOUSING CORP
 Applicant : OWNER
 Appl Address : 11762 STUART DR

Phone :

Insp Dist : Q13
 Date : 07/09/98
 Parcel No : 10050302

PROPOSED WORK:

WATER HEATER

FEES

942 22130 GENERAL PLAN	1	2.00
080 32550 CULTURAL ARTS	1	1.00
111 32401 Issuance	1	30.00
111 32415 Water Heater	1	8.50
111 32415 MINIMUM PLUMBING FEE	1	16.50
TOTAL		58.00

APPROVAL _____ DATE _____ INSPECTOR _____
INSPECTION RECORD

Soil Piping _____
 Ground Plumbing _____
 Rough Plumbing _____
 Gas Piping _____
 Gas Vent _____
 Sewer _____
 Main Drain _____
 Vacuum Lines _____
 Water Heater _____
 Backwash _____
 Water Lateral _____

FINAL 7-20-98

Utility Notified _____

AUTHORIZATION

Issued By: valq _____ Date _____

DECLARATION

I certify that I have read this application/permit and state that the information on all pages of this document is correct. I agree to comply with all City and County ordinances and State laws relating to building construction, and hereby authorize representatives of this City and County to enter upon the above mentioned property for inspection purposes.

Applicant's Signature _____

Print Name TONY MAGGI Date 7/9/98

***** VALIDATION *****
 PAID ON 09 Jul 1998 AT 16:07
 RECEIVED BY DOXIE 198.245.206.215/2 TRANS# 120
 AMOUNT PAID \$58.00 BY CHECK#1247
 TOTAL PAID = \$58.00



General Information: 714-741-5307

CITY OF GARDEN GROVE - DEVELOPMENT SERVICES DEPARTMENT

Inspection Requests: 714-741-5332

PERMIT (PAGE 2 of 2)

PROJECT/SITE/BUILDING DESCRIPTION

JOB Address : 11672⁷⁶² STUART DR
Suite :
PERMIT NO. : 43825
Permit Type :
Type : H
Owner : VITANATCHI, MOVIN & ANURI
Applicant : RELIABLE ENERGY MANAGEMENT INC
Appl Address : 6226 CHERRY
LONG BEACH, CA 90805
Phone : 310 530-3963
Insp Dist : SSB
Date : 08/03/98
Parcel No : 10056308

PROPOSED WORK:

REPLACE WALL HEATERS IN (9) APT UNITS.

FEEES

942 22130 GENERAL PLAN	1	2.00
080 32550 CULTURAL ARTS	1	1.00
111 32401 Issuance	1	30.00
111 32418 Install/Reloc Wall H	9	108.00
TOTAL		141.00

APPROVAL DATE INSPECTOR

INSPECTION RECORD

Furnace _____
Furnace Vents _____
Gas Piping _____
Ducts _____
Duct Fan Vent _____
Kitchen Hood _____
Air Handl Unit _____
Evap Cooler _____
Boiler Comp _____
Decor Appl _____

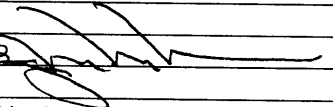
FINAL 8-13-98 
Utility Notified _____

AUTHORIZATION

Issued By: jimc Date _____

DECLARATION

I certify that I have read this application/permit and state that the information on all pages of this document is correct. I agree to comply with all City and County ordinances and State laws relating to building construction, and hereby authorize representatives of this City and County to enter upon the above mentioned property for inspection purposes.

Applicant's Signature Michael A. Wren

Print Name Michael A. Wren Date 8/5/98

***** VALIDATION *****
PAID ON 03 Aug 1998 AT 11:56
RECEIVED BY DOXIE 198.245.206.215/2 TRANS# 77
AMOUNT PAID \$141.00 BY CHECK#5590
TOTAL PAID = \$141.00



General Information: 714-741-5307

CITY OF GARDEN GROVE - DEVELOPMENT SERVICES DEPARTMENT

Inspection Requests: 714-741-5332

PERMIT (PAGE 2 of 2)

PROJECT/SITE/BUILDING DESCRIPTION

JOB Address : 11762 STUART DR
 Suite :
 PERMIT NO. : 43950
 Permit Type :
 Type : P

Owner : JAMBOREE HOUSING CORP
 Applicant : RPM PROPERTY SERVICES INC.
 Appl Address : 6141 ORANGE AVE, #1
 CYPRESS, CA 90630
 Phone : 995-7330

Insp Dist : Q13
 Date : 08/12/98
 Parcel No : 10050302

PROPOSED WORK:

CHANGE OUT POOL FILTER, PUMP, FLOW METER AND CHLORINATOR

FEES

942 22130 GENERAL PLAN	1	2.00
080 32550 CULTURAL ARTS	1	1.00
111 32401 Issuance	1	30.00
111 32415 OTHER FIXTURE	4	40.00
TOTAL		73.00

APPROVAL _____ DATE _____ INSPECTOR _____
INSPECTION RECORD

Soil Piping _____
 Ground Plumbing _____
 Rough Plumbing _____
 Gas Piping _____
 Gas Vent _____
 Sewer _____
 Main Drain _____
 Vacuum Lines _____
 Water Heater _____
 Backwash _____
 Water Lateral _____

FINAL 10-29-98 _____
 Utility Notified _____

AUTHORIZATION

Issued By: dianeb Date _____

DECLARATION

I certify that I have read this application/permit and state that the information on all pages of this document is correct. I agree to comply with all City and County ordinances and State laws relating to building construction, and hereby authorize representatives of this City and County to enter upon the above mentioned property for inspection purposes.

Applicant's Signature Phil Dunford
 Print Name Phil Dunford Date 8/11/98

***** VALIDATION *****
 PAID ON 11 Aug 1998 AT 17:05
 RECEIVED BY DOXIE 198.245.206.215/2 TRANS# 220
 AMOUNT PAID \$499.57 BY CHECK#2626
 TOTAL PAID = \$499.57



General Information: 714-741-5307

CITY OF GARDEN GROVE - DEVELOPMENT SERVICES DEPARTMENT

Inspection Requests: 714-741-5332

PERMIT (PAGE 2 of 2)

PROJECT/SITE/BUILDING DESCRIPTION

JOB Address : 11762 STUART DR
 Suite :
 PERMIT NO. : 43950
 Permit Type :
 Type : P

Owner : JAMBOREE HOUSING CORP
 Applicant : RPM PROPERTY SERVICES INC.
 Appl Address : 6141 ORANGE AVE, #1
 CYPRESS, CA 90630
 Phone : 995-7330

Insp Dist : Q13
 Date : 08/12/98
 Parcel No : 10050302

PROPOSED WORK:

CHANGE OUT POOL FILTER, PUMP, FLOW METER AND CHLORINATOR

FEES

942 22130 GENERAL PLAN	1	2.00
080 32550 CULTURAL ARTS	1	1.00
111 32401 Issuance	1	30.00
111 32415 OTHER FIXTURE	4	40.00
TOTAL		73.00

APPROVAL _____ DATE _____ INSPECTOR _____
INSPECTION RECORD

Soil Piping _____
 Ground Plumbing _____
 Rough Plumbing _____
 Gas Piping _____
 Gas Vent _____
 Sewer _____
 Main Drain _____
 Vacuum Lines _____
 Water Heater _____
 Backwash _____
 Water Lateral _____

COPY

FINAL 02998 _____
 Utility Notified _____

AUTHORIZATION

Issued By: _____ Date _____

DECLARATION

I certify that I have read this application/permit and state that the information on all pages of this document is correct. I agree to comply with all City and County ordinances and State laws relating to building construction, and hereby authorize representatives of this City and County to enter upon the above mentioned property for inspection purposes.

Applicant's Signature _____

Print Name _____ Date _____



General Information: 714-741-5307

CITY OF GARDEN GROVE - DEVELOPMENT SERVICES DEPARTMENT

Inspection Requests: 714-741-5332

PERMIT (PAGE 2 of 2)

PROJECT/SITE/BUILDING DESCRIPTION

JOB Address : 11762 STUART DR
 Suite : 2
 PERMIT NO. : 45651
 Permit Type : BUILDING
 Type : B21
 MISCELLANEOUS
 Owner : JAMBOREE HOUSING CORP
 Applicant : OWNER
 Appl Address : 11762 STUART DR

Phone :
 Insp Dist : Q13
 Date : 12/09/98
 Parcel No : 10050302

Value : 200
 Floor area : 0

PROPOSED WORK:

OPEN UP BATHROOM CEILING TO INSPECT FOR LEAK AND REINSTALL

FEES

111 32410 Permit	1	40.80
111 32401 ISSUANCE	1	35.00
942 22130 General Plan	1	2.50
080 32550 Cultural Arts	1	1.25
TOTAL		79.55

INSPECTION RECORD

APPROVAL	DATE	INSPECTOR
Pre Inspect		
Foundation		
Concrete Floor		
Reinforcing		
Masonry		
Roof Shtg		
Rough Frame		
Insul / Energy		
Drywall		
Lath		
Plas. Brown Ct.		
Landscaping		
Pre Gunite		
Pre Deck		
Pre Plaster		
Planning Final		
Bldg Final	2/22/99	[Signature]
Utility Notified		

AUTHORIZATION

Issued By: janetw Date

DECLARATION

I certify that I have read this application/permit and state that the information on all pages of this document is correct. I agree to comply with all City and County ordinances and State laws relating to building construction, and hereby authorize representatives of this City and County to enter upon the above mentioned property for inspection purposes.

Applicant's Signature [Signature]
 Print Name [Signature] Date 12/9/98

***** VALIDATION *****
 PAID ON 09 Dec 1998 AT 15:45
 RECEIVED BY LARAINEM 0/2 TRANS# 136
 CASH PAID = \$100.00 CASH RETURNED = \$20.45
 TOTAL PAID = \$79.55



General Information: 714-741-5307

CITY OF GARDEN GROVE - DEVELOPMENT SERVICES DEPARTMENT

Inspection Requests: 714-741-5332

PERMIT (PAGE 2 of 2)

PROJECT/SITE/BUILDING DESCRIPTION

JOB Address : 11762 STUART DR
 Suite : 1-10
 PERMIT NO. : 46130
 Permit Type :
 Type : P

Owner : JAMBOREE HOUSING CORP
 Applicant : RPM PROPERTY SERVICES INC.
 Appl Address : 6141 ORANGE AVE, #1
 CYPRESS, CA 90630
 Phone : 995-7330

Insp Dist : SSB
 Date : 01/21/99
 Parcel No : 10050302

PROPOSED WORK:

ADD STRAPPING TO WATER HEATERS/ T&P
OUTSIDE/DRAIN PIPE/SHOWER/FAUCETS

FEES

942 22130 GENERAL PLAN	1	2.00
080 32550 CULTURAL ARTS	1	1.00
111 32401 Issuance	1	35.00
111 32415 Water Heater	5	42.50
111 32415 PLBG FIXTURE NOT LIS	10	85.00
TOTAL		165.50

APPROVAL DATE INSPECTOR INSPECTION RECORD

Soil Piping _____
 Ground Plumbing _____
 Rough Plumbing _____
 Gas Piping _____
 Gas Vent _____
 Sewer _____
 Main Drain _____
 Vacuum Lines _____
 Water Heater _____
 Backwash _____
 Water Lateral _____

EXPIRED

2-11-03

FINAL _____

Utility Notified _____

AUTHORIZATION

Issued By: janetw Date _____

DECLARATION

I certify that I have read this application/permit and state that the information on all pages of this document is correct. I agree to comply with all City and County ordinances and State laws relating to building construction, and hereby authorize representatives of this City and County to enter upon the above mentioned property for inspection purposes.

Applicant's Signature *Phil Dunford*

Print Name Phil Dunford Date 1/21/99

***** VALIDATION *****

PAID ON 21 Jan 1999 AT 14:25
RECEIVED BY LARAINEM 198.245.206.215/2 TRANS# 10
AMOUNT PAID \$304.80 BY CHECK#2657
TOTAL PAID = \$304.80



General Information: 714-741-5307

CITY OF GARDEN GROVE - DEVELOPMENT SERVICES DEPARTMENT

Inspection Requests: 714-741-5332

PERMIT (PAGE 2 of 2)

PROJECT/SITE/BUILDING DESCRIPTION

JOB Address : 11762 STUART DR
 Suite : 1-10
 PERMIT NO. : 46128
 Permit Type :
 Type : E

Owner : JAMBOREE HOUSING CORP
 Applicant : RPM PROPERTY SERVICES INC.
 Appl Address : 6141 ORANGE AVE, #1
 CYPRESS, CA 90630
 Phone : 995-7330

Insp Dist : SSB
 Date : 01/21/99
 Parcel No : 10050302

PROPOSED WORK:

50 SWITCHES, 72 RECEPTACLES, 10 VENT HOODS, 10 CEILING FANS/10 DEDICATED CIRCUITS

FEEES

942 22130 GENERAL PLAN	1	2.00
080 32550 CULTURAL ARTS	1	1.00
111 32401 Issuance	1	35.00
111 32412 outlets/fixtures 1-1	10	9.00
111 32412 outlets/fixtures eac	142	92.30
TOTAL		139.30

APPROVAL _____ DATE _____ INSPECTOR _____
INSPECTION RECORD

Underground _____
 Conduit _____
 Wiring - Rough _____
 Heater _____
 Fixtures & Trim _____
 Motors _____
 Ufer _____
 Service _____

EXPIRED
2-11-03

FINAL _____
 Utility Notified _____

AUTHORIZATION

Issued By: janetw Date _____

DECLARATION

I certify that I have read this application/permit and state that the information on all pages of this document is correct. I agree to comply with all City and County ordinances and State laws relating to building construction, and hereby authorize representatives of this City and County to enter upon the above mentioned property for inspection purposes.

Applicant's Signature *Phil Dwyer*
 Print Name Phil Dwyer Date 1/21/99

***** VALIDATION *****
 PAID ON 21 Jan 1999 AT 14:25
 RECEIVED BY LARAINEM 198.245.206.215/2 TRANS# 10
 AMOUNT PAID \$304.80 BY CHECK#2657
 TOTAL PAID = \$304.80

PLOT PLAN

Department of Building
E. C. Ash, Jr.
Director

CITY OF
GARDEN GROVE

Job
Address 11762 Stuart Drive

Permit Number
3222

DIMENSION PLOT PLAN COMPLETELY SHOWING
ALL BLDGS. ON THE LOT AND THEIR USE

Lot 13 Tract 1891 Blk.

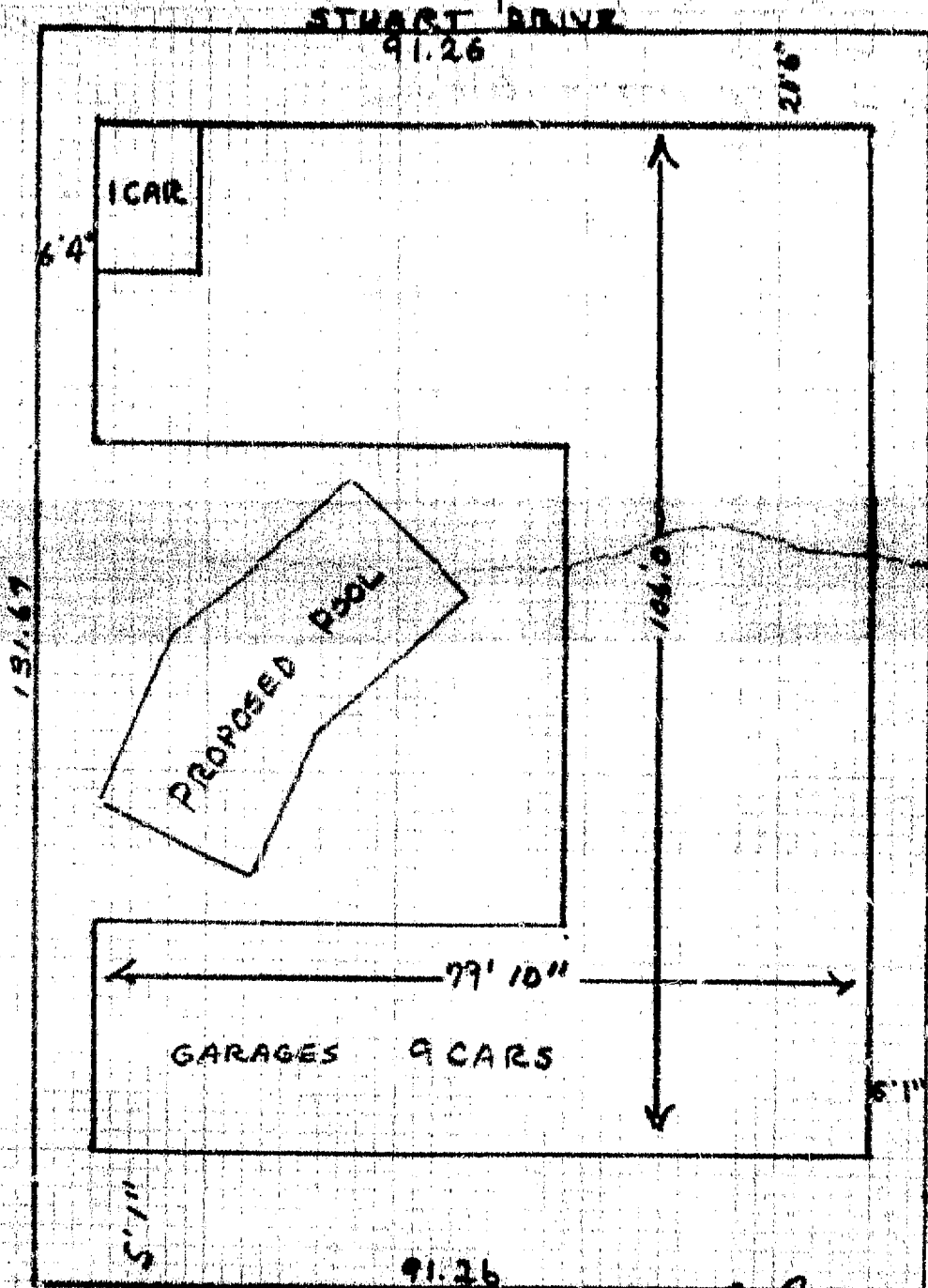

I certify the information furnished hereon is complete and correct. By *F. D. [Signature]*

Routing: #1 Building Inspector #2 Office File #3 Owner

BUILDING PERMIT

Department of Building
E. C. Adams
Director

CITY OF
GARDEN GROVE

ZONING AND BUILDING

Map No.	APO	Var. No.
Use Zone <i>R-3</i>	Main Use	Acc. Use <input checked="" type="checkbox"/>
St. Set Back - <i>PL 9' from side</i>	PL	PL
Side Yard Rt <i>10' 0"</i>	Projection	
Side Yard Lt <i>11'</i>	Projection	
Rear Yard <i>10' 0"</i>	No Parking Sp. Req'd.	
Zoning Approved By <i>[Signature]</i>	Date <i>12/1/53</i>	
Group <i>1</i>	Type <i>F</i>	Plan. Ck. <i>[Signature]</i>

Remarks:

INSPECTION RECORD

APPROVAL	DATE	INSPECTOR
Foundation and Location		
Reinforcing	<i>12-3-53</i>	<i>[Signature]</i>
Roof Shtg.		
Rough Frame		
Lath or Drywall		
Plas. Brown Ct.		
Final	<i>12-10-53</i>	<i>[Signature]</i>
Utility Release		

Remarks:

Fees

Building Permit	\$ <i>12</i>	Rec'd By
Plan Check	\$ <i>6</i>	Rec'd By

Remarks:

Permit Authorized By *[Signature]* Date *12/1/53*

Routing: \$1 Bldg. Inspector \$2 Office File \$3 Statistics \$4 Owner

For Applicant to Fill in (See Inset)

Job *11762 Street Rd.* Permit No. *4667*
Address
Lot No. *7* Tract No. *189* / Blk. No.

Please Attach Maps & Bounds (2 Copies)

Owner *Atlantic Pacific Bldg Corp*
Owner's Address *9101 - Beachmont*

Description of Work New Add'n Remodel Relocate

Use of Building *Swimming pool*

Area of Building *15 x 35* Valuation \$ *3500*

Arch. or Engr. *Macintosh* Address *306 S. Vermont*

Contractor *Anthony B...* Phone
Address *5871 Fruitvale South Gate*

I hereby acknowledge that I have read this application and state that the above is correct and agree to comply with all ordinances and State laws relating building construction.

I hereby certify that I am properly registered with and/or licensed as required by the City of Garden Grove and/or State of California, or that I am the legal owner of the above described property, and I certify that in the performance of the work for which this permit is issued I shall not employ any person in violation of the workmen's compensation laws of the State of California.

Signature of Permittee *[Signature]* Date *Dec 1, 1953*

Address *5871 Fruitvale* Lic. No.

PUBLIC WORKS

Street imp.
Address By Date

RELOCATION

PRESENT BUDG. ADDRESS REC'D -1-53 REC'D -1-53

MOVING CONTRACTOR ADDRESS REC'D 11-057 REC'D 11-058

INSPECTION FEE RECEIPT NUMBER REC'D BY 11-057 M REC'D BY 11-058 M

SURETY DATE REC'D REC'D BY 11-057 M REC'D BY 11-058 M

CASH DEP. DATE REC'D REC'D BY 11-057 M REC'D BY 11-058 M

RELOCATION AUTHORIZED BY DATE 11-057 M REC'D 11-058 M

REC'D -1-53
REC'D 11-057 M
REC'D 11-058 M
REC'D 11-057 M
REC'D 11-058 M
REC'D 11-057 M
REC'D 11-058 M

PLOT PLAN

Department of Building
S. C. Adams
Director

CITY OF
GARDEN GEOV2

Job 11767 *Stuart*
Address

Permit Number
7667

DIMENSION PLOT PLAN COMPLETELY SHOWING
ALL BLDGS. ON THE LOT AND THEIR USE

Lot 9 Tract 1891

Blk.

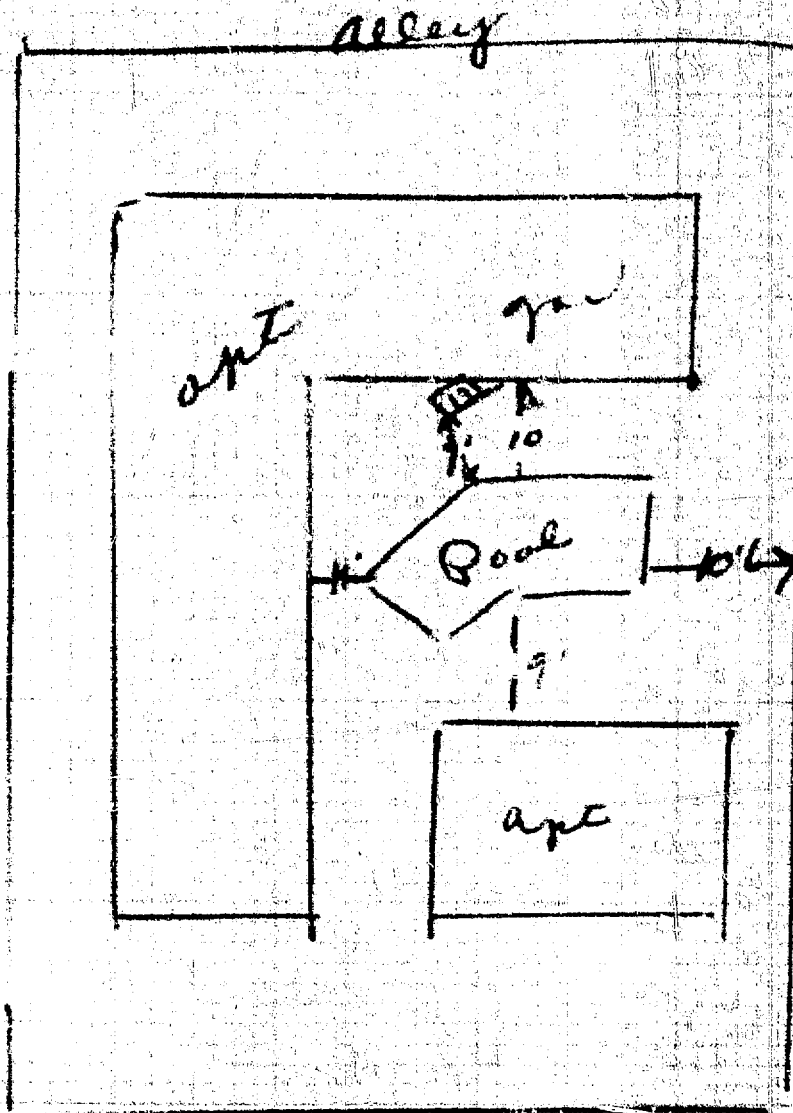

Stuart St.

I certify the information furnished hereon is complete and correct. By *Bernice Carson Dec 1, 1958*

Routing: #1 Building Inspector #2 Office File #3 Owner

INSPECTION RECORD

For Applicant to Fill in

P.C. # _____

OCU-PANCY #	TYPE <i>VA</i>	OCU. LOAD	FIRE SPRINK.		
USE ZONE <i>R-3</i>	FRONT	LEFT	RIGHT	REAR	
FIRE ZONE <i>3</i>	Eav Proj.	<i>N/A</i>			
PLANNING ACTION	Satbacks	<i>now</i>			
LAND USE APPROVED BY	<i>8-22-79</i>				
REMARKS:					
G.G. SANT. DIS. FEE REQ'D.	O.C. SANT. DIS. FEE REQ'D.	DATE	INITIAL		
PARCEL MAP	REQ'D	PROVIDED			
R/W DEDICATION					
FEES AND BONDS					
	REV. CODE	AMOUNT			
ST. BOND					
WATER BOND					
WATER ASSMT. FEE (ACRG.)					
WATER ASSMT. FEE (FT.)					
PARKWAY TREE FEE					
PARK & REC. FEE (DIST.)					
DRAIN ASSMT. FEE (DIST.)					
PLAN RETENTION FEE					
BLDG. PLAN CHECK					
BLDG. PERMIT FEE	<i>226</i>	<i>2250</i>			
ISSUANCE	<i>535</i>	<i>6</i>			
VALIDATION	TOTAL FEES	<i>2850</i>			
AUTHORIZED BY	DATE				

APPROVAL	DATE	INSPECTOR
FOUNDATION & LOCATION		
CONCRETE FLOOR		
REINFORCING		
ROOF SHTG		
ROUGH FRAME		
INSULATION, ENERGY		
LATH OR DRYWALL		
PLAS. BROWN CT.		
SOUND INSULATION		
SMOKE DETECTOR		
PARKING		
LANDSCAPING		
LAND USE FINAL		
FINAL		
UTILITY RELEASE		
IDENTIFICATION CODE		

APPROVED TO CONFORM TO CODE

9/17/79

WORKER'S COMPENSATION REQUIREMENTS

State Compensation Insurance Policy No. *168491* Expiration Date *5/13/80*

I certify that in the performance of the work for which this permit is issued, I shall not employ any person in any manner so as to become subject to the Worker's Compensation laws of California.

NOTE: If, after making such certificate, the applicant for the permit should become subject to the Worker's Compensation provisions of this code, he shall forthwith comply with the provisions of Section 3700 or his permit shall be deemed revoked.

I certify that I have read this application and state that the above information is correct. I agree to comply with all City ordinances and State laws relating to pending construction. I further agree to hold the City of Garden Grove free and harmless from any liability arising out of injury or bodily damage resulting from work performed pursuant to this permit.

PERMIT APPLICANT SIGNATURE: *[Signature]* DATE: *8/22/79*

BUSINESS TAX CERTIFICATE INFORMATION

I certify that the following Contractor's License No. *223621* and Classification *C-37* is in full force and effect.

(PRINT) CONTRACTOR _____ (SIGNATURE) CONTRACTOR OR AUTHORIZED AGENT _____ DATE _____

BUSINESS TAX CERTIFICATE NO. _____ EXPIRATION DATE _____

I certify that I am exempt from Section 7031.6 of the Business and Professional Code, Division 3, Chapter 9, Contractors' License Law, under the following Section:

Owner: Section 7044 Minor work under \$100: Section 7048 Employee working for wages only: Section 7063

Other: _____

(PRINT) PROPERTY OWNER (SIGNATURE) PROPERTY OWNER OR AUTHORIZED AGENT _____ DATE _____

ADDRESS *11762 STUART DR*

F.L. BROWN, G.C.

LOT NO. *13* BLK. NO. *1891* TRACT NO. *638-6661*

OWNER *D.L. BROWN* NO. *6384360*

MAILING ADDRESS *11762 STUART C.G. 92643* CITY *92643* ZIP

ARCH ENGR.

TEL. NO. _____ STATE LIC. NO. & TYPE _____

VALIDATION *8/22/79 019 m 2250 020 m 600*

CONTRACTOR *Bridgeport Roofing*

MAILING ADDRESS *12912 Magnolia C.G. 92641* CITY *92641* ZIP

TEL. NO. *636 7127* STATE LIC. NO. *293621*

PRESENT BLDG. USE *apt.* PROPOSED BLDG. USE *apt*

DESCRIBE WORK TO BE DONE *Re Roof.*

NEW ADD'N ALTER REPAIR DEMOLISH

FLOOR AREA (SQ. FT.) *600* NO. OF STORIES *2* NO. OF DWELLING UNITS _____

If work is not started within 120 days from date of issue or if abandoned for more than 120 days, this permit will be null and void.

A FEE MAY BE CHARGED FOR RE-INSPECTION DUE TO NEGLIGENCE, INCOMPLETE WORK, OR FAILURE TO MAKE CORRECTIONS.

RELOCATION

PRESENT BLDG. ADDRESS _____

MOVING CONTRACTOR _____

ADDRESS _____

8-22-79

