

**GENERAL NOTES**

- ALL WORK, MATERIAL AND EQUIPMENT SHALL CONFORM TO THE REQUIREMENTS OF THE STATE OF CALIF., DEPT. OF TRANSPORTATION STANDARD PLANS AND STANDARD SPECIFICATIONS, DATED MAY 2006 AND THE SPECIAL PROVISIONS FOR THE PROJECT.
- UTILITIES SHOWN ON THESE PLANS ARE CORRECT AND ACCURATE TO THE EXTENT OF AVAILABLE RECORDS AND KNOWLEDGE. THE CONTRACTOR, HOWEVER, IS REQUIRED TO ASCERTAIN THE EXACT LOCATION OF UNDERGROUND FACILITIES PRIOR TO DOING WORK THAT MAY DAMAGE SUCH FACILITIES OR INTERFERE WITH THEIR SERVICE.
- THE CONTRACTOR SHALL OBTAIN ALL NECESSARY PERMITS AND NOTIFY ALL UTILITY COMPANIES A MINIMUM OF 48 HOURS PRIOR TO START OF CONSTRUCTION. IT SHALL BE THE RESPONSIBILITY OF THE CONTRACTOR TO COORDINATE ALL PHASES OF CONSTRUCTION WITH THE VARIOUS UTILITY COMPANIES INVOLVED.
- FLASHING INDICATION SHALL FLASH RED ON ALL PHASES.
- THE CONTRACTOR SHALL CONTACT THE CITY TRAFFIC ENGINEER AT (714) 741-5185, A MINIMUM OF 48 HOURS BEFORE COMMENCING WORK.
- ALL NEW VEHICLE HEADS SHALL HAVE 12" SECTIONS. ALL LEFT TURN INDICATIONS SHALL BE ARROWS. ALL RED, GREEN, AND YELLOW INDICATIONS INCLUDING ARROWS SHALL BE I.T.E. APPROVED L.E.D.
- ALL EXISTING EQUIPMENT TO BE PROTECTED IN PLACE UNLESS OTHERWISE NOTED.
- ALL NEW POLE LOCATIONS SHALL BE APPROVED BY THE ENGINEER.
- ANTI-SEIZE COMPOUND SHALL BE APPLIED TO ALL PUSH BUTTONS AND TERMINAL COMPARTMENT SCREWS.
- NORMAL OPERATION OF THE TRAFFIC SIGNAL SHALL BE MAINTAINED AT ALL TIMES. PROVIDE TEMPORARY SIGNAL POLES AND OVERHEAD WIRING AS REQUIRED. TEMPORARY SHUTDOWN FOR REWIRING WILL BE REQUESTED 24 HOURS IN ADVANCE.

POLE DATA STANDARD					HPSV LUMINAIRE	I.S.N.S. LEGEND	SIGNAL MOUNTING		PED. PUSH BUTTON		REMARKS	
No.	TYPE	HEIGHT	SIG. M.A.	LUM. M.A.			VEHICLE	PED.	POLE QUAD	PHASE		
1	26-3-100	30'	45'	12'	200W	Hope →	MAS/MAS	SV-1-T	SP-1-T	S,W	6,8	ARROW TO BE REVERSED ON OTHER SIDE
2	17-2-100	30'	15'	12'	200W	Westminster	MAS	SV-1-T	SP-1-T	N	6	
3	1-A	10'	-	-	-	-	-	TV-1-T	SP-1-T	E	4	
4	17-3-100	17'	45'	-	-	Dawson →	MAS/MAS	SV-1-T	SP-1-T	N,E	2,4	ARROW TO BE REVERSED ON OTHER SIDE
5	17-3-100	30'	15'	12'	200W	Westminster	MAS/MAS	SV-1-T	SP-1-T	S	2	POLE SHALL HAVE STRAIGHT LUMINAIRE ARM
6	1-A	10'	-	-	-	-	-	TV-1-T	SP-1-T	W	8	

NOTE: ALL EQUIPMENT SHALL BE NEW.  
I.I.S.N.S. MUST BE DOUBLE-FACED WITH WHITE LETTERING ON BLUE BACKGROUND.

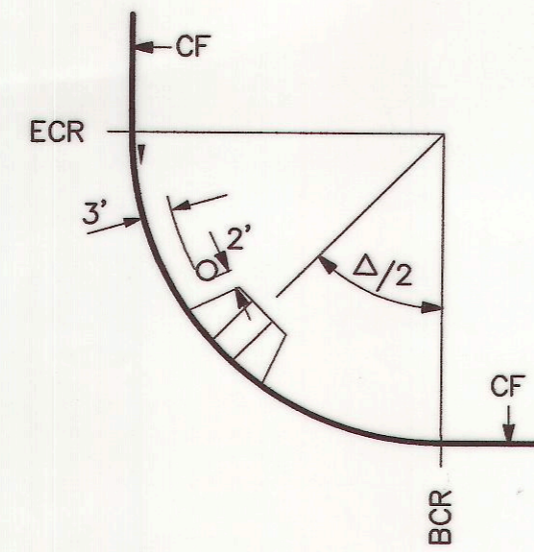

**POLE LOCATION DETAIL**  
(No Scale)

AWG	POLE	RUN No.					
		1	2	3	4	5	6
12c	1-#1/06/06P/08P/6/8	1	1	1	1	1	1
	2-#6/06P/8	-	1	1	-	-	1
	3-#4/07/08P/6	-	-	1	-	-	1
	4-#2/04/07/04P/06P/4/6	-	-	-	1	1	1
	5-#2/02P/4	-	-	-	-	1	1
	6-#3/08/04P/2	-	-	-	-	-	1
	TOTAL	1	1	1	3	1	2
#12	I.I.S.N.S.	2	2	2	2	2	2
#10	LUMINAIRE	2	2	2	2	2	2
	Ø1	-	-	1	-	-	1
	Ø2	-	-	-	-	-	2
	Ø3	-	-	-	-	-	5
	Ø4	-	-	-	-	-	2
	Ø5	-	-	-	-	1	1
	Ø6	-	-	5	-	-	5
	Ø7	-	-	-	-	-	-
	Ø8	2	-	2	-	-	2
	TOTAL (DLC)	2	-	8	-	6	16
	EVP CABLES	-	-	-	1	1	2
	CONDUIT SIZE	3"	3"	3"	3"	3"	2-4"

ALL NEW CABLES/CONDUCTORS AND CONDUITS

**CONSTRUCTION NOTES**

- FURNISH AND INSTALL NEW ECONOLITE ASC/3-2100 CONTROLLER IN NEW TYPE TSH TYPE I CABINET WITH ANTI-GRAFFITI PAINT ON CABINET ON NEW FOUNDATION (ENGINEER TO LOCATE IN FIELD). INSTALL ALL APPURTANCES NECESSARY TO PROVIDE THE INTENDED OPERATION. INSTALL NEW TYPE II SERVICE ON SIDE OF CABINET. WIRE CONTROLLER FOR 6-PHASE OPERATION AND SERVICE POINT TO BE POWER POLE No. 1469020E.
- INSTALL 12-STRAND F.O.C. FROM NEW No. 6 PULLBOX TO EX No. 6 PULLBOX AT WESTMINSTER/BOWEN APPROX. 1,000'.
- INSTALL 3" BTW NEW No. 6 COMM. PULLBOX AT WESTMINSTER/DAWSON AND EX. No. 6 PULLBOX AT WESTMINSTER/BOWEN APPROX. 1000'.
- INSTALL SERVICE PULLBOX (SEE SPECIAL PROVISIONS) AND 3" C. (CONDUCTORS BY SCE).
- PROTECT IN PLACE EXISTING WHEELCHAIR RAMP. & INSTALL RAISED TRUNCATED DOMES PER CALTRANS STD PLAN No. AB8A.
- INSTALL 24 NEW TYPE "E" CIRCULAR LOOPS.
- INSTALL 2 NEW 6' x 50' TYPE "C" QUADRAPOLE LOOPS.
- INSTALL EVP SYSTEM AS STATED IN THE SPECIAL PROVISIONS.
- ALL PEDESTRIAN SIGNALS SHALL BE ITC APPROVED L.E.D. WITH SOLID FILLED INTERNATIONAL SYMBOL AND SHALL BE PEDESTRIAN COUNTDOWN SIGNAL PER SPECIAL PROVISIONS. THE PEDESTRIAN COUNT-DOWN SIGNAL SHALL BE 16"x18" INCANDESCENT LOOK.
- ALL PEDESTRIAN PUSH BUTTONS SHALL BE CAMPBELL COMPANY-TM SOLID STATE PUSH BUTTON-700P.
- ALL NEW PULL BOXES SHALL BE No. 6 UNLESS OTHERWISE NOTED.
- ALL NEW CONDUIT RUNS SHALL BE 3" RIGID METAL UNLESS OTHERWISE NOTED.
- STREET LIGHT POLE TO BE REMOVED BY OTHERS.
- STREET LIGHT ON P.P. No. 1469022E TO BE REMOVED BY OTHERS.
- CABLE TV PULLBOX TO BE RELOCATED BY OTHERS.
- SPLICE 12-STRAND F.O.C. IN CONTROLLER CABINET FURNISH & INSTALL HARDENED ETHERNET SWITCH (ETHERWAN MODEL No. EX73240-A08) AND FIBER PATCH PANEL WITH CABLES, CONNECTORS AND AUXILIARY EQUIPMENT FOR THE INTENDED COMMUNICATION INSIDE PROPOSED TRAFFIC SIGNAL CONTROLLER CABINET. FOR DETAILS SEE THE SPECIAL PROVISIONS. FURNISH AND INSTALL 1-DUPLEX OUTLET (GROUND FAULT INTERRUPTION, GFI) IN EXISTING/NEW TRAFFIC SIGNAL CABINET. FOR DETAILS SEE SPECIAL PROVISIONS. SPLICE FIBERS AND INSTALL CONNECTORS TO TERMINATE INTO FIBER PATCH PANELS.

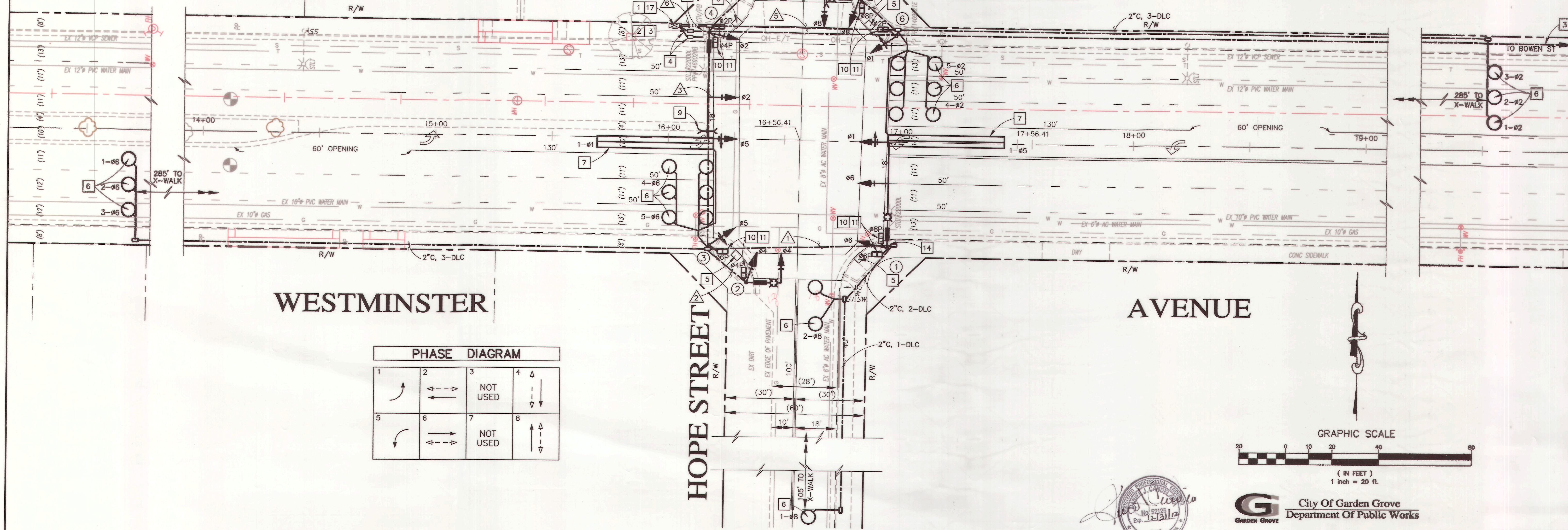

PHASE DIAGRAM			
1	2	3	4
5	6	7	8

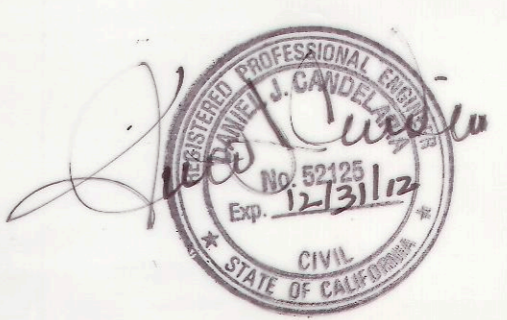
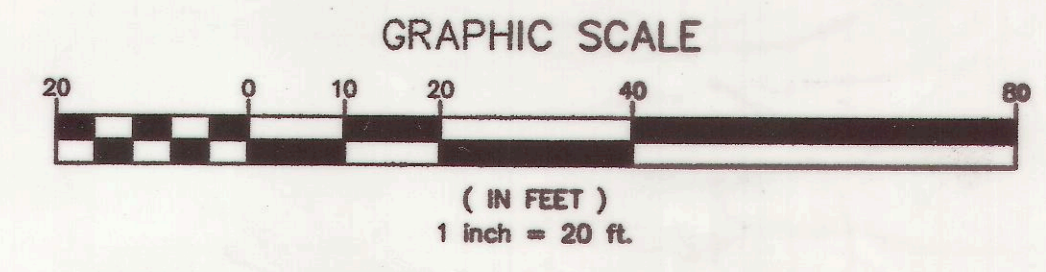

City of Garden Grove  
Department Of Public Works

DRAWING NUMBER  
**T-899**  
SHEET 4 OF 7