

CITY OF GARDEN GROVE, CALIFORNIA

Development Services Department

11391 ACACIA PARKWAY, P.O. BOX 3070, GARDEN GROVE, CALIFORNIA 92642

Address : 10802 KATELLA AVE
Parcel No: 08901050 Type: B20

Suite: PERMIT NO.: 17932
Date : 04/26/93 Insp Dist : ZB

Owner : GORDON COOK
Address: _____
Phone: _____

Applicant: HEMC ENVIRONMENTAL
Address : 32B MAUCHLY BLVD
IRVINE CA 92718
Phone: ~~530-7312~~ ^{Phone 727-1217}
~~727-4778~~

Architect: _____
Address : _____

Engineer: _____
Address : _____

LIC: _____ EXP: _____ PH: _____

LIC: _____ EXP: _____ PH: _____

WORKER'S COMPENSATION REQUIREMENTS

State Compensation Insurance Policy No. 1300375-93 Expiration Date 4-1-93

I certify that in the performance of the work for which this permit is issued, I shall not employ any person in any manner so as to become subject to the Worker's Compensation laws of California.

NOTE: If, after making such certificate, the applicant for the permit should become subject to the Worker's Compensation provisions of this code, he shall forthwith comply with the provisions of Section 3700 or his permit shall be deemed revoked.

I certify that I have read this application and state that the above information is correct. I agree to comply with all City ordinances and State laws relating to pending construction. I further agree to hold the City of Garden Grove free and harmless from any liability arising out of injury or bodily damage resulting from work performed relevant to this permit.

X J Hammsrey 4-26-93
PERMIT APPLICANT SIGNATURE DATE

BUSINESS TAX CERTIFICATE INFORMATION

I certify that the following Contractor's License No. 625490 and Classification A is in full force and effect.

X HEMC ENVIRONMENTAL Hammsrey 4-26-93
(PRINT) CONTRACTOR (SIGNATURE) CONTRACTOR OR AUTHORIZED AGENT DATE

BUSINESS TAX CERTIFICATE NO. _____ EXPIRATION DATE _____

I certify that I am exempt from Section 7031.5 of the Business and Professional Code, Division 3, Chapter 9, Contractors' License Law, under the following Section; Owner: Section 7044 Minor work under \$200; Section 7048 Employee working for wages only; Section 7053 Other: _____

(PRINT) PROPERTY OWNER (SIGNATURE) PROPERTY OWNER OR AUTHORIZED AGENT DATE

Proposed Work: GRADING PERMIT FOR REMOVING 4 UNDERGROUN D STORAGE TANKS

Value : 0
Floor Area: 726

PLAN CHECK	1	250.00
PERMIT	1	260.00
Issuance	1	15.00
Cultural Arts	1	9.32
General Plan	1	18.93

B PER 260.00
B CHEK 250.00
MISC. 18.93
MISC. 9.32
ISS 15.00

OW7692A 4-26'93 CHECK 553.25

INSPECTION RECORD

APPROVAL	DATE	INSPECTOR
Pre Inspect	_____	_____
Foundation	_____	_____
Concrete Floor	_____	_____
Reinforcing	_____	_____
Masonry	_____	_____
Roof Shtg	_____	_____
Rough Frame	_____	_____
Insul / Energy	_____	_____
Drywall	_____	_____
Lath	_____	_____
Plas. Brown Ct.	_____	_____
Landscaping	_____	_____
Pre Gunite	_____	_____
Pre Deck	_____	_____
Pre Plaster	_____	_____
Planning Final	_____	_____
Bldg Final	<u>1/2/93</u>	<i>[Signature]</i>
Utility Notified	_____	_____

3200	510.00
3223 PERMITS/GENE	18.93
3224 PERMITS/CULT	9.32
3517 ISSUANCE FEE	15.00

Authorized by: *X Mk* TOTAL FEES 553.25

Inspection Requests

General Information

741-5307

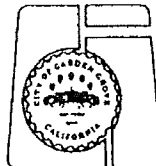

If work is not started within 180 days from date of issue or if abandoned for more than 180 days, this permit will be null and void.

A FEE MAY BE CHARGED FOR RE-INSPECTION DUE TO NEGLIGENCE, INCOMPLETE WORK, OR FAILURE TO MAKE CORRECTIONS.

PLANNING ACTION	USE ZONE	LOT SIZE	JOB ADDRESS 10802 Katella Ave., Garden Grove, 92646		PERMIT NO. 17931
LAND USE APPROVED BY	DATE	LOT COVERAGE	ASSESSOR'S PARCEL NO. 00901050	LOT	BLOCK
REMARKS:	TYPE	% INCREASE	(PLEASE CHECK ONE OR MORE)		
	FIRE SPRINK.	DATE	<input type="checkbox"/> NEW	<input type="checkbox"/> ADDITION	<input type="checkbox"/> ALTERATION
			<input type="checkbox"/> REPAIR	<input type="checkbox"/> MOVE	<input type="checkbox"/> DEMOLISH
			JOB DESCRIPTION Underground tanks removal		PERMIT VALUE

SHOW NORTH ARROW, PROPERTY LINES AND ADJACENT STREETS

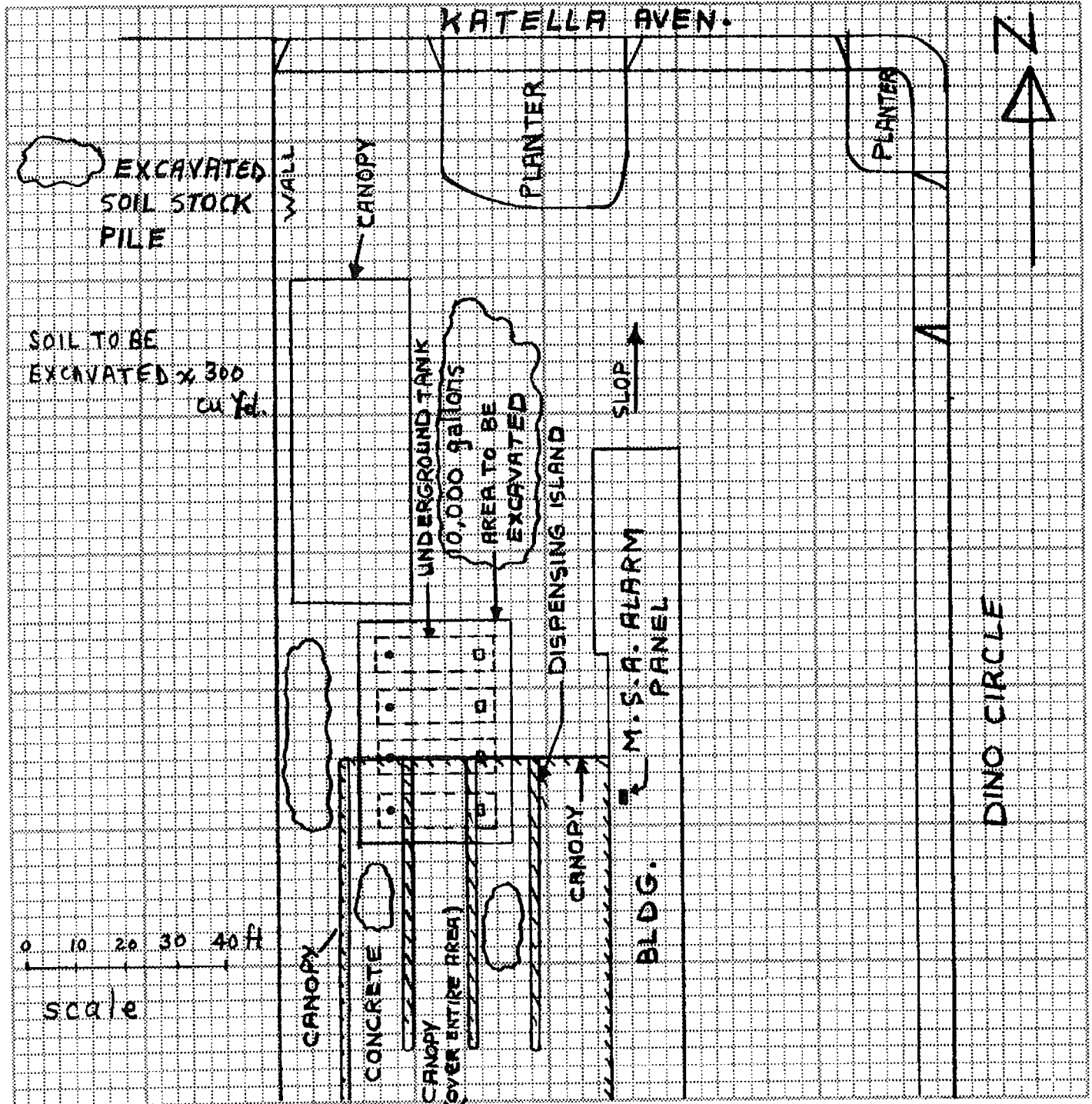

<input type="checkbox"/> ARCH		
<input type="checkbox"/> ENGR.		
MAILING ADDRESS	CITY	ZIP
TEL. NO.	STATE LIC. NO. & TYPE	

White: Building Insp. / Yellow: Assessor / Pink: Permittee
I certify the information hereon is complete and correct

(PRINT) PROPERTY OWNER

(SIGNATURE) PROPERTY OWNER
OR AUTHORIZED AGENT

DATE

CITY OF GARDEN GROVE, CALIFORNIA

Development Services Department

11391 ACACIA PARKWAY, P.O. BOX 3070, GARDEN GROVE, CALIFORNIA 92642



Address : 10802 KATELLA AVE
 Parcel No: 08901050 Type: B15

Owner : GORDON COOK
 Address: _____
 Phone: _____

Architect: _____
 Address : _____

LIC: _____ EXP: _____ PH: _____

Suite: _____ PERMIT NO.: 17473
 Date : 03/25/93 Insp Dist : ZB

Applicant: HEMC ENVIRONMENTAL
 Address : 32B MAUCHLY BLVD
 IRVINE CA 92718
 Phone: 530-7312

Engineer: _____
 Address : _____

LIC: _____ EXP: _____ PH: _____

WORKER'S COMPENSATION REQUIREMENTS

State Compensation Insurance Policy No. 00637592 Expiration Date 4-1-94
 I certify that in the performance of the work for which this permit is issued, I shall not employ any person in any manner so as to become subject to the Worker's Compensation laws of California.
 NOTE: If, after making such certificate, the applicant for the permit should become subject to the Worker's Compensation provisions of this code, he shall forthwith comply with the provisions of Section 3700 or his permit shall be deemed revoked.
 I certify that I have read this application and state that the above information is correct. I agree to comply with all City ordinances and State laws relating to pending construction. I further agree to hold the City of Garden Grove free and harmless from any liability arising out of injury or bodily damage resulting from work performed relevant to this permit.
Stephen L. Asher 3-25-93
PERMIT APPLICANT SIGNATURE DATE

BUSINESS TAX CERTIFICATE INFORMATION

I certify that the following Contractor's License No. 625488 and Classification A is in full force and effect.
STEPHEN L. ASHER Stephen L. Asher 3-25-93
(PRINT) CONTRACTOR (SIGNATURE) CONTRACTOR OR AUTHORIZED AGENT DATE

BUSINESS TAX CERTIFICATE NO. EXPIRATION DATE

I certify that I am exempt from Section 7031.5 of the Business and Professional Code, Division 3, Chapter 9, Contractors' License Law, under the following Section: Owner: Section 7044 Minor work under \$200; Section 7048 Employee working for wages only: Section 7053 Other: _____
(PRINT) PROPERTY OWNER (SIGNATURE) PROPERTY OWNER OR AUTHORIZED AGENT DATE

Proposed Work: DEMO LATTUS CANOPY, BRICK COLU MNS

Value : 500
 Floor Area: 0

Plan Check	1	
Permit	1	15.58
Issuance	1	15.00
Cultural Arts	1	1.25
General Plan	1	2.50

3223 PERMITS/GENE	2.50
3224 PERMITS/CULT	1.25
3226 BLDG PERM &	15.58
3517 ISSUANCE FEE	15.00
3527 BLDG P C FEE	0.00

Authorized by: X ML **TOTAL FEES** 34.33

Inspection Requests

741-5332
 General Information
 741-5307

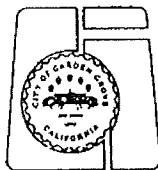

If work is not started within 180 days from date of issue or if abandoned for more than 180 days, this permit will be null and void.
 A FEE MAY BE CHARGED FOR RE-INSPECTION DUE TO NEGLIGENCE, INCOMPLETE WORK, OR FAILURE TO MAKE CORRECTIONS.

INSPECTION RECORD

APPROVAL	DATE	INSPECTOR
Pre Inspect	_____	_____
Foundation	_____	_____
Concrete Floor	_____	_____
Reinforcing	_____	_____
Masonry	_____	_____
Roof Shtg	_____	_____
Rough Frame	_____	_____
Insul / Energy	_____	_____
Drywall	_____	_____
Lath	_____	_____
Plas. Brown Ct.	_____	_____
Landscaping	_____	_____
Pre Gunite	_____	_____
Pre Deck	_____	_____
Pre Plaster	_____	_____
Planning Final	_____	_____
Bldg Final	<u>2/2/93</u>	<u>[Signature]</u>
Utility Notified	_____	_____

CERTIFICATE OF OCCUPANCY

2

DEPARTMENT OF BUILDING

B. C. ADAMS, Director

CITY OF GARDIN GROVE

11301 ACACIA

JOB ADDRESS 11301 Acacia PERMIT NO. 20544

USE OF BUILDING OFF. BLDG. GROUP P-1 TYPE IV

USE ZONE P-1 APPROVED BY H. E. MILLER DATE 8-4-55

ZONING REMARKS

Floor load sign installed per Section 2308 Yes No

Room capacity sign installed per section 3301 (1) Yes No

The above described building has been inspected and found to comply with the provisions of the Uniform Building Code.

ISSUED TO W. E. Anderson ADDRESS 1740 E. Florida, L.A.

Authorized By _____ DATE August 4, 1955

Notice: Post in a conspicuous place on the premises

PLUMBING PERMIT

Department of Building
E. G. Adams
Director

CITY OF
GARDEN GROVE

For Applicant to Fill in (Use Ink)

00224214

Job No. 10802

Permit No.

Address KATELLA

Lot No.

Tract No.

Blk. No.

Owner RAA GROUP ONE WASH DC

Owner's Address 10800 KATELLA GROVE

Plumbing Contractor BAILEY THE PLUMBER INC

Contractor's Address 1960 E. STORANCE

Phone 461-46 City Lic. No.

Use of Bldg. LAUNDRY

New Bldg. Old Bldg.

Validation MAY 28-65 11 003 26.00

I hereby acknowledge that I have read this application and state that the above is correct and agree to comply with all ordinances and State laws regulating plumbing.
I hereby certify that I am properly registered with and/or licensed as required by the City of Garden Grove and/or State of California, or that I am the legal owner of the above described property, and I certify that in the performance of the work for which this permit is issued I shall not employ any person in violation of the workman's compensation laws of the State of California.

Signature of Applicant *Ray Bailey* Date

Address 1960 E. STORANCE LOS ANGELES

SOIL PIPING

GROUND PLUMBING 6-1-65 P1990

ROUGH PLUMBING 6-17-65 1990

GAS PIPING

GAS VENT

ROUGH FURNACE

SEPTIC TANK or Cesspool

SEWER

GAS TEST 7-27-65 P1990

MAIN DRAIN AND VACUUM LINES

WATER HEATER

QUANTITY	DESCRIPTION OF WORK OR ITEM	FEE
5	Water Closet (Toilet)	5.00
	Bath Tub	
	Shower	
5	Lavatory (Wash Basin)	5.00
	Kitchen Sink or Garb. Disposal	1.00
	Laundry Tub or Tray	1.00
2	Water Heater	3.00
	Trap Sink	
3	Floor Sink	3.00
	Floor Drain	5.00
	Dish Washer	
	Drinking Fountain	
	Urinal	
2	Gas System and Outlets	1.00
	House Sewer	
	Lawn Sprinklers	
	Swimming Pool	
	Sand Traps	
	Automatic Washing Mach.	
	Water Softeners	
	Furnace	
	Water Heater Test	
	Miscellaneous	
1	Clearance	1.00

Issuance of Permit 1.00

TOTAL FEE \$ 26.00

Permit Authorized By *R. J. Adams* Date 5-28-65

FINAL WORK 7-30-65 P1990

UTILITY CO. NOTIFIED 7-7-65 (CA)

Routing: #1 Plumbing Inspector #2 Office File #3 Owner *R. J. Adams* Bldg. F. rmit #

BUILDING PERMIT

Department of Building CITY OF
 HARRY R. TERCE Director GARDEN GROVE

13013 ZONING AND BUILDING

Use Zone C-1 Main Use X Acc. Use Var. No.

St. Set Back - 9' PL PL

Side Yard R - 73' Projection

Side Yard L - 92' Projection

Rear Yard - Stories 1 Parking Req'd. 25'

Zoning Approved By [Signature] Date 4-13-65

Group F-1 Type IV Plan Ck ELM

Remarks: PLANS

For Applicant to Fill in (USE INK) 1

Job Address 10802 KATELLA AVE Permit No.

Lot No. Tract No. Blk No. 00759
 Please Attach Maps & Bounds (2 Copies)

Owner KINGSBURY & ASSOC.

Owner's Address 17606 FLORENCE L.A.

Description of Work New Add'n Remodel Relocate

Use of Building AUTO LAUNDRY

Area of Building 7300 Valuation 11050

Validation APR 13-65 11 071 M #2 # 166.00

Arch. or Engr. R.V. CRAIG Address HOT N PARK

Contractor RHEEM ETAL Phone LU 36671

Address 3883 E GAGEAN - HOT N PARK

I hereby acknowledge that I have read this application and state that the above is correct and agree to comply with all ordinances and State laws regulating building construction.

I hereby certify that I am properly registered with and/or licensed as required by the City of Garden Grove and/or State of California, or that I am the legal owner of the above described property, and I certify that in the performance of the work for which this permit is issued I shall not employ any person in violation of the workman's compensation laws of the State of California.

Signature Permitted [Signature] Date Lic. No.

Address 17606 FLORENCE L.A. 197126
 RELOCATION

PRESENT BLDG. ADDRESS

MOVING CONTRACTOR ADDRESS

PUBLIC WORKS

Street Address By J.L.B.

	REQUIRED	PROVIDED
Record of Survey	yes	yes
R/W Dedication	yes	yes
Bonds	yes	yes
Encroachment Permit	yes	yes

Remarks

INSPECTION RECORD

APPROVAL	DATE	INSPECTOR
Foundation and Location	5-6-65	[Signature]
Reinforcing	[Signature]	[Signature]
Roof Shtg.	[Signature]	[Signature]
Rough Frame		
Lath or Drywall		
Plas. Brown Ct.		
Other		
Land Use		
Final	[Signature]	[Signature]
Utility Release	8-2-65	[Signature]

FEES

Plan Check \$ 83.00 Building Permit \$ 166.00

Bond \$ 100.00 Expiration Date

Permit Authorized By ELM Date 4-13-65

Routing: #1 Bldg. Inspector #2 Office File #3 Statistics #4 Owner

For Applicant to Fill in

INSPECTION RECORD

OCCUPANCY USE ZONE C-22 FIRE ZONE PLANNING ACTION LAND USE APPROVED BY REMARKS:		OCC. LOAD FRONT LEFT RIGHT REAR DATE		FIRE SPRINK. RIGHT REAR DATE	
TYPE Env Proj. Setback /		APPROVAL FOUNDATION & LOCATION CONCRETE FLOOR REINFORCING ROOF SHTG ROUGH FRAME INSULATION, ENERGY LATH OR DRYWALL PLAS. BROWN CT. SOUND-INSULATION SMOKE DETECTOR PARKING LANDSCAPING		DATE 9/29/82 9/29/82	
G.G. SANT. DIS. FEE REQ'D. O.C. SANT. DIS. FEE REQ'D. PARCEL MAP R/W DEDICATION		DATE PROVIDED INITIAL		INSPECTOR DATE	
ST. BOND WATER BOND WATER ASSMT. FEE (ACRG.) WATER ASSMT. FEE (FT.) PARKWAY TREE FEE PARK & REC. FEE (DIST.) DRAIN ASSMT. FEE (DIST.)		REV. CODE AMOUNT 3226 3517 00 1650 3517		IDENTIFICATION CODE WORKER'S COMPENSATION REQUIREMENTS 1-83 State Compensation Insurance Policy No. 247-196 I certify that in the performance of the work for which this permit is issued, I shall not employ any person in any manner so as to become subject to the Workers' Compensation laws of California. NOTE: If, after making such certificate, the applicant for the permit should become subject to the Worker's Compensation provisions of this code, he shall forthwith comply with the provisions of Section 7700 or his permit shall be deemed revoked. I certify that I have read this application and state that the above information is correct. I agree to comply with all City ordinance and State laws relating to pending construction. I further agree to hold the City of Garden Grove free and harmless from any liability arising out of injury or bodily damage resulting from work performed relevant to this permit.	
PLAN RETENTION FEE BLDG. PLAN CHECK BLDG. PERMIT FEE ISSUANCE VALUATION 1070		DATE 9-29-82		BUSINESS TAX CERTIFICATE INFORMATION I certify that the following Contractor's License No. and Classification is in full force and effect. (PRINT) CONTRACTOR (SIGNATURE) (PRINT) CONTRACTOR (SIGNATURE) (PRINT) PROPERTY OWNER (SIGNATURE) (PRINT) PROPERTY OWNER (SIGNATURE) (PRINT) PROPERTY OWNER (SIGNATURE) (PRINT) PROPERTY OWNER (SIGNATURE)	
TOTAL FEES 1750		DATE 9-29-82		BUSINESS TAX CERTIFICATE NO. EXPIRATION DATE I certify that I am exempt from Section 7031.5 of the Business and Professional Code, Division 3, Chapter 9, Contractors' License Law, under the following Section: Owner: Section 7044 Employee working for wages only: Section 7053 Minor work under \$100: Section 7048 Other:	

ADDRESS 10802 KATELLA ANAHEIM 92204 LOT BLOCK TRACT NO. PERMIT NO.		OWNER 089-010-50 1247801 204 ORNELIS 62202K MARTINEANO 744 530-2312 MAILING ADDRESS CITY ZIP	
SAME <input type="checkbox"/> ARCH <input type="checkbox"/> ENGR. MAILING ADDRESS CITY ZIP		STATE LIC. NO. & TYPE 23P	
VALIDATION 1-0-0-0 500-0-0 1000-0-0 CHECK		CONTRACTOR MAILING ADDRESS CITY ZIP SAME AS ABOVE 214 530-7312 STATE LIC. NO.	
PROPOSED BLDG. USE BLDG. USE DESCRIBE WORK TO BE DONE HOT DRY STANO DEMOLISH STRUCTURE		NEW <input type="checkbox"/> ADDN <input type="checkbox"/> ALTER <input checked="" type="checkbox"/> REPAIR <input type="checkbox"/> DEMOLISH <input type="checkbox"/> FLOOR AREA (SQ. FT.) NO. OF STORIES NO. OF DWELLING UNITS 1 If work is not started within 120 days from date of issue or if abandoned for more than 120 days, this permit will be null and void.	
PRESENT BLDG. ADDRESS MOVING CONTRACTOR ADDRESS		RELOCATION	

AUTHORIZED BY

 DATE
 9-29-82

OWNER FRANK MATHER AND WIFE CONNOR	JOB ADDRESS 10802 Katella	PERMIT NO. 124769A
NAME OF CONSTRUCTION LENDER & BRANCH	ASSESSOR'S PARCEL NO. 089-010-50	LOT BLOCK TRACT
	PLEASE CHECK ONE OR MORE	
	<input type="checkbox"/> New	<input type="checkbox"/> Addition
	<input type="checkbox"/> Alteration	<input type="checkbox"/> Repair
	<input type="checkbox"/> Move	<input checked="" type="checkbox"/> Demolish
ADDRESS 12802 Katella	DATE 3-29-82	PERMIT VALUE 1,000 ⁰⁰
CITY ANNHON 10802	JOB DESCRIPTION DEMOLISH HOT DOG STAND	

SHOW NORTH ARROW, PROPERTY LINES AND ADJACENCY STREETS.

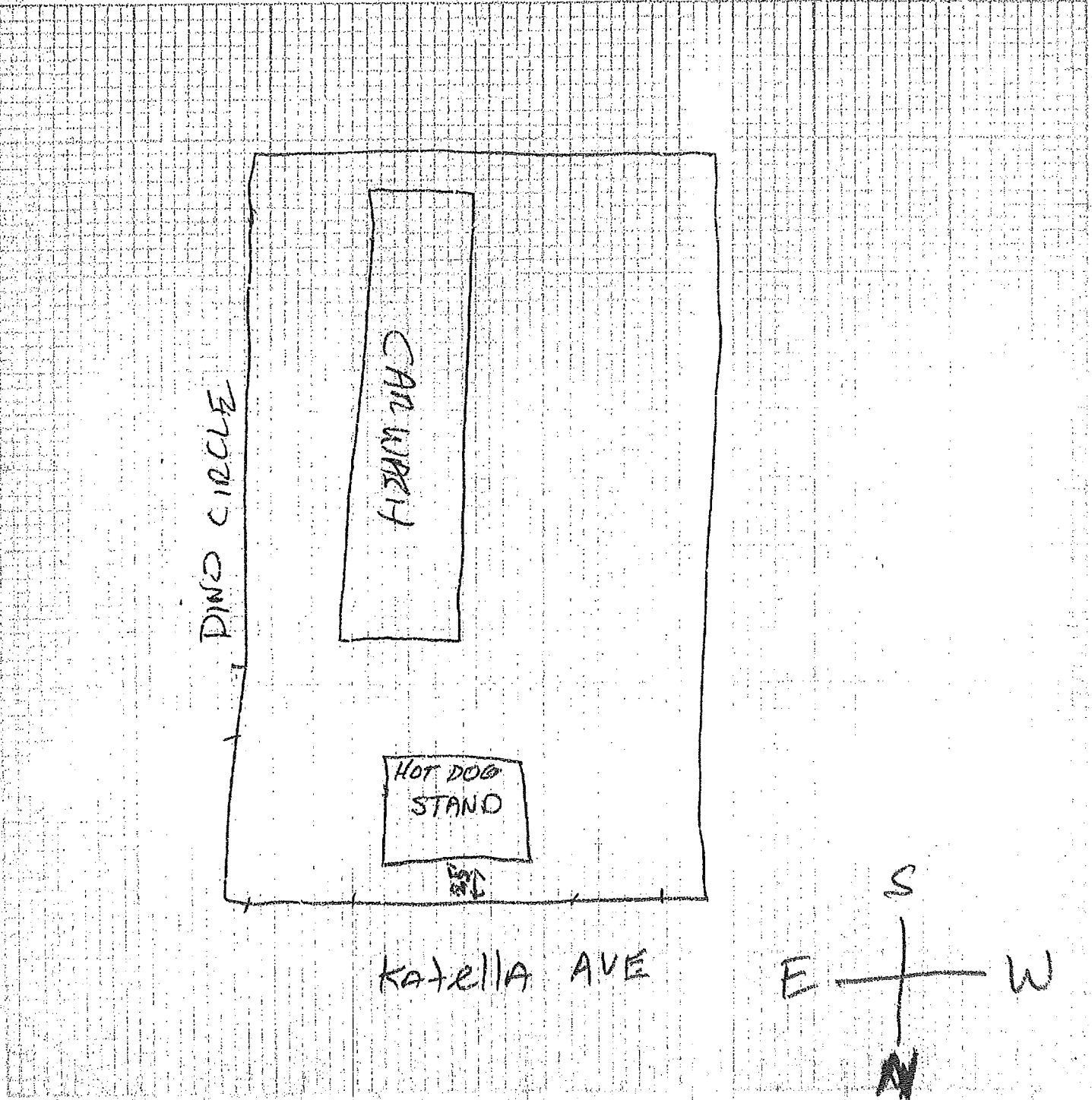

#1 Building Insp./#2 Assessor/#3 Permittee/#4 File
I certify the information herein is complete and correct.

By _____

PLOT PLAN APPROVED BY _____

INSPECTION RECORD

For Applicant to Fill in BLDG 1

PC #	CCU. PANC. USE	TYPE	IN	OCC. LOAD	FIRE SPRINK.	RIGHT	REAR
	B1	C2					
	FIRE ZONE	Eav Proj.	SIDE	PLAT	PLANNING ACTION	DATE	
					NONE	5/3/82	
	LAND USE APPROVED BY	REMARKS: Per the approved Plans & Construction Permits					
		G.G. SANT. DIS. FEE REQ. No. 5/3/82					
	PARCEL MAP	REV. CODE AMOUNT					
	RTW DEDICATION	FEE CODE AMOUNT					
	ST. BOND	336.97					
	WATER BOND	0.00					
	WATER ASSMT. FEE (ACRG.)	352.79					
	WATER ASSMT. FEE (FT.)	322.60					
	PARKWAY TREE FEE	351.76					
	PARK & REC. FEE (DIST.)	TOTAL FEES 110.73					
	DRAIN ASSMT. FEE (DIST. A)	ISSUANCE 6.00					
	PLAN RETENTION FEE	VALUATION 10800.00					
	BLDG. PLAN CHECK	AUTHORIZED BY JPD					
	BLDG. PERMIT FEE	DATE 5-3-82					
	ISSUANCE	DATE					
		DATE					

ADDRESS	10802 KATELLA AV.
LOT NO. BLDG NO. TRACT NO. PERMIT NO.	
OWNER	FRANK MARDIAN
MAILING ADDRESS	125111 530-7311
ARCH ENGR. N. SOMMEGA	
MAILING ADDRESS	10802 KATELLA AV. GARDEN GROVE 926
CITY	GLENDALE 91201
STATE LIC. NO. & TYPE	2682 KENNINGTON
TEL. NO.	213-246-2388
VALIDATION	1795 STEEL
CONTRACTOR	LPL INDUSTRIES (BESTEEL DIV)
MAILING ADDRESS	18233 E. RAILROAD ST., INDUSTRY 91704
CITY	
STATE LIC. NO.	279435
PRESENT BLDG. USE	CAR WASH
PROPOSED BLDG. USE	SAME
DESCRIBE WORK TO BE DONE	INSTALL ONE (1) NEW STEEL CANOPY, 18'-4" x 16'
NEW <input type="checkbox"/> ADD <input checked="" type="checkbox"/> ALTER <input type="checkbox"/> REPAIR <input type="checkbox"/> DEMOLISH <input type="checkbox"/>	
FLOOR AREA (SQ. FT.)	1080
NO. OF STORIES	1
NO. OF DWELLING UNITS	
If work is not started within 120 days from date of issue or if abandoned for more than 120 days, this permit will be null and void.	
A FEE MAY BE CHARGED FOR REINSPECTION DUE TO NEGLIGENCE, INCOMPLETE WORK, OR FAILURE TO MAKE CORRECTIONS.	
PRESENT BLDG. ADDRESS	RELOCATION
MOVING CONTRACTOR	
ADDRESS	

APPROVAL	DATE	INSPECTOR
FOUNDATION & LOCATION	5/5/82	
CONCRETE FLOOR REINFORCING		
ROUGH FRAME		
INSULATION ENERGY		
LATH OR DRYWALL		
PLAS. BROWN ST.		
SOUND INSULATION		
SMOKE DETECTOR		
PARKING		
LANDSCAPING		
LAND USE FINAL		
FINAL	9/2/82	
UTILITY RELEASE		
IDENTIFICATION CODE		
WORKER'S COMPENSATION REQUIREMENTS		
State Compensation Insurance Policy No. 1720228 Expiration Date 4-1-83		
I certify that in the performance of the work for which this permit is issued, I shall not employ any person in any manner so as to become subject to the Worker's Compensation Laws of California.		
NOTE: If, after making such certificate, the applicant for the permit should become subject to the Worker's Compensation provisions of this code, he shall forthwith comply with the provisions of Section 3700 of his permit shall be deemed revoked.		
I certify that I have read this application and state that the above information is correct. I agree to comply with all City ordinances and State laws relating to pending construction. I further agree to hold the City of Garden Grove free and harmless from any liability arising out of injury or bodily damage resulting from work performed relevant to this permit.		
Signature: [Signature] Date: 4-5-82		
BUSINESS TAX CERTIFICATE INFORMATION		
I certify that the following Contractor's License No. 274435 and Classification: [Classification] is in full force and effect.		
LPL IND. (BESTEEL) [Signature] Date: 4-5-82		
(PRINT) CONTRACTOR OR AUTHORIZED AGENT		
BUSINESS TAX CERTIFICATE NO. [Number] EXPIRATION DATE [Date]		
I certify that I am exempt from Section 7031.5 of the Business and Professional Code, Division 3, Chapter 9, Contractor's License Law, under the following Section: [Section]		
Owner: Section 7044 [] Minor work under \$100: Section 7048 []		
Employee working for wages only: Section 7053 []		
Other: []		
(PRINT) PROPERTY OWNER (SIGNATURE) PROPERTY OWNER DATE		
OR AUTHORIZED AGENT		

For Applicant to Fill in **BLDG 2**

INSPECTION-RECORD

<p>APPROVAL</p> <p>FOUNDATION & LOCATION</p> <p>CONCRETE FLOOR REINFORCING</p> <p>ROUGH FRAME</p> <p>INSULATION, ENERGY BATHOR-DRYWALL</p> <p>PLAS. BROWN CT.</p> <p>SOUND INSULATION</p> <p>SMOKE DETECTOR</p> <p>PARKING</p> <p>LANDSCAPING</p> <p>LAND USE FINAL</p> <p>FINAL</p> <p>UTILITY RELEASE</p>	<p>DATE</p> <p>5/15/82</p>	<p>INSPECTOR</p> <p><i>[Signature]</i></p>												
<p>WORKER'S COMPENSATION REQUIREMENTS</p> <p>State Compensation Insurance Policy No. 172220. Expiration Date 4-1-83</p> <p><input type="checkbox"/> I certify that in the performance of the work for which this permit is issued, I shall not employ any person in any manner so as to become subject to the Worker's Compensation laws of California.</p> <p>NOTE: If, after making such certificate, the applicant for the permit should become subject to the Worker's Compensation provisions of this code, he shall forthwith comply with the provisions of Section 3700 or his permit shall be deemed revoked.</p> <p><input checked="" type="checkbox"/> I certify that I have read this application and state that the above information is correct, I agree to comply with all City ordinances and State laws relating to pending construction. I further agree to hold the City of Garden Grove free and harmless from any liability arising out of injury or bodily damage resulting from work performed relevant to this permit.</p> <p><i>W. Follmer, est</i></p>														
<p>BUSINESS TAX CERTIFICATE INFORMATION</p> <p>PERMIT APPLICANT SIGNATURE: <i>[Signature]</i> DATE: 5-3-82</p> <p>I certify that the following Contractor's License No. and Classification is in full force and effect.</p> <p>(PRINT) CONTRACTOR: _____ DATE: _____ (SIGNATURE) CONTRACTOR OR AUTHORIZED AGENT: _____</p> <p>BUSINESS TAX CERTIFICATE NO. _____ EXPIRATION DATE: _____</p> <p>I certify that I am exempt from Section 7031.5 of the Business and Professional Code, Division 3, Chapter 9, Contractors' License Law, under the following Section: _____ Minor work under §700; Section 7048; Employee working for wages only; Section 7053; Other: _____</p>														
<p>REMARKS: New one window plan As indicated on plans</p>														
<p>G.G. SANT. DIS. FEE REQ'D. No G.C. SANT. DIS. FEE REQ'D. No DATE: 5/15/82</p>														
<p>FEE SCHEDULE</p> <table border="1"> <thead> <tr> <th>REV. CODE</th> <th>AMOUNT</th> </tr> </thead> <tbody> <tr> <td>3522</td> <td>2815</td> </tr> <tr> <td>3527</td> <td>16133</td> </tr> <tr> <td>3226</td> <td>24175</td> </tr> <tr> <td>3517</td> <td>600</td> </tr> <tr> <td>TOTAL FEES</td> <td>43723</td> </tr> </tbody> </table>			REV. CODE	AMOUNT	3522	2815	3527	16133	3226	24175	3517	600	TOTAL FEES	43723
REV. CODE	AMOUNT													
3522	2815													
3527	16133													
3226	24175													
3517	600													
TOTAL FEES	43723													
<p>VALUATION: \$64900.00</p> <p>DATE: 5-3-82</p>														
<p>AUTHORIZED BY: <i>[Signature]</i></p>														

ADDRESS	10802 KATELLA AVE
LOT NO. / BLDG. NO.	10802 / 2
OWNER	FRANK MARTORANO
MATCHING ADDRESS	10802 KATELLA GARDEN GROVE
CITY	GARDEN GROVE
ARCH ENGR. / N. SANNIENGA	
MAILING ADDRESS	10802 KATELLA GARDEN GROVE
CITY	GARDEN GROVE
STATE LIC. NO. 91206	
STATE LIC. NO. 5-7192	
VALIDATION	246-2388 1295 (STREET)
CONTRACTOR	L.P.L. IND. BEETEL DV.
CITY	91744
MAILING ADDRESS	18233 E. RAILROAD INDUSTRY
STATE LIC. NO.	279435
PRESENT BLDG. USE	CAR WASH
PROPOSED BLDG. USE	SAME
DESCRIBE WORK TO BE DONE	59' x 110' WOOD TRELLIS
NEW <input type="checkbox"/> ALTER <input type="checkbox"/> REPAIR <input type="checkbox"/> DEMOLISH <input type="checkbox"/>	
FLOOR AREA	NO. OF STORIES
NO. OF DWELLING UNITS	
If work is not started within 120 days from date of issue or if abandoned for more than 120 days, this permit will be null and void.	
A FEE MAY BE CHARGED FOR REINSPECTION DUE TO NEGLIGENCE, INCOMPLETE WORK, OR FAILURE TO MAKE CORRECTIONS.	
PRESENT BLDG. ADDRESS	RELOCATION
MOVING CONTRACTOR	
ADDRESS	

For Applicant to Fill in BLDG 3

ADDRESS: 10802 KARSELLA AVE
 LOT NO.: 1211211
 OWNER: FRANK MARCOLANO
 MAILING ADDRESS: 10802 KARSELLA GROVE GARDEN GROVE 92804
 ARCH: [] ENGR. N. SPINNEGA
 MAILING ADDRESS: 2682 KENNINGTON GLENDALE 91204
 TEL. NO.: 240-2388
 STATE LIC. NO. & TYPE: 1795 (STREET)
 VALIDATION: []
 CONTRACTOR: LPL IND BESTEEL DIV.
 MAILING ADDRESS: 18233 E. RAILROAD INDUSTRY
 TEL. NO.: 283 8251
 STATE LIC. NO.: 279435
 PRC USED: SAME
 BLDG. USE: SAME
 DESCRIBE WORK: ADD NEW ATTICUM & OFFICE TO EXISTING BUILDING.
 NEW ADD ALTER REPAIR DEMOLISH
 FLOOR AREA: [] NO. OF STORIES: 1 NO. OF DWELLING UNITS: []
 IF WORK IS NOT STARTED WITHIN 120 DAYS FROM DATE OF ISSUE OR IF ABANDONED FOR MORE THAN 120 DAYS, THIS PERMIT WILL BE NULL AND VOID.
 A FEE MAY BE CHARGED FOR RE-INSPECTION DUE TO NEGLIGENCE, INCOMPLETE WORK, OR FAILURE TO MAKE CORRECTIONS.
 PRESENT BLDG. ADDRESS: []
 MOVING CONTRACTOR: []
 ADDRESS: []

INSPECTION RECORD

APPROVAL	DATE	INSPECTOR
FOUNDATION & LOCATION		
CONCRETE FLOOR		
REINFORCING		
ROOF SHTG		
ROUGH FRAME		
INSULATION, ENERGY		
LATH OR DRYWALL		
PLAS. BROWN CT.		
SOUND INSULATION		
SMOKE DETECTOR		
PARKING		
LANDSCAPING		
LAND USE FINAL		
FINAL	9/27/82	
UTILITY RELEASE		
IDENTIFICATION CODE		

WORKER'S COMPENSATION REQUIREMENTS
 State Compensation Insurance Policy No. 170228 Expiration Date 4-1-83
 I certify that in the performance of the work for which this permit is issued, I shall not employ any person in any manner so as to become subject to the Worker's Compensation laws of California.
 NOTE: If, after making such certificate, the applicant for the permit should become subject to the Worker's Compensation provisions of this code, he shall forthwith comply with the provisions of Section 3700 or his permit shall be deemed revoked.
 I certify that I have read this application and state that the above information is correct. I agree to comply with all City ordinances and State laws relating to pending construction. I further agree to hold the City of Garden Grove free and harmless from any liability arising out of injury or bodily damage resulting from work performed relevant to this permit.
 W. K. Adams, INC. (PRINT) APPLICANT SIGNATURE DATE 5-3-82
 BUSINESS TAX CERTIFICATE INFORMATION
 I certify that the following Contractor's License No. and Classification is in full force and effect.
 (PRINT) CONTRACTOR SIGNATURE OR AUTHORIZED AGENT DATE
 BUSINESS TAX CERTIFICATE NO. EXPIRATION DATE
 I certify that I am exempt from Section 7031.5 of the Business and Professional Code, Division 3, Chapter 9, Contractors' License Law, under the following Section: Minor work under \$100; Section 7048
 Other: []
 (PRINT) PROPERTY OWNER SIGNATURE PROPERTY OWNER DATE
 OR AUTHORIZED AGENT

INSPECTION RECORD

APPROVAL	DATE	INSPECTOR
FOUNDATION & LOCATION		
CONCRETE FLOOR		
REINFORCING		
ROOF SHTG		
ROUGH FRAME		
INSULATION, ENERGY		
LATH OR DRYWALL		
PLAS. BROWN CT.		
SOUND INSULATION		
SMOKE DETECTOR		
PARKING		
LANDSCAPING		
LAND USE FINAL		
FINAL	9/27/82	
UTILITY RELEASE		
IDENTIFICATION CODE		

WORKER'S COMPENSATION REQUIREMENTS
 State Compensation Insurance Policy No. 170228 Expiration Date 4-1-83
 I certify that in the performance of the work for which this permit is issued, I shall not employ any person in any manner so as to become subject to the Worker's Compensation laws of California.
 NOTE: If, after making such certificate, the applicant for the permit should become subject to the Worker's Compensation provisions of this code, he shall forthwith comply with the provisions of Section 3700 or his permit shall be deemed revoked.
 I certify that I have read this application and state that the above information is correct. I agree to comply with all City ordinances and State laws relating to pending construction. I further agree to hold the City of Garden Grove free and harmless from any liability arising out of injury or bodily damage resulting from work performed relevant to this permit.
 W. K. Adams, INC. (PRINT) APPLICANT SIGNATURE DATE 5-3-82
 BUSINESS TAX CERTIFICATE INFORMATION
 I certify that the following Contractor's License No. and Classification is in full force and effect.
 (PRINT) CONTRACTOR SIGNATURE OR AUTHORIZED AGENT DATE
 BUSINESS TAX CERTIFICATE NO. EXPIRATION DATE
 I certify that I am exempt from Section 7031.5 of the Business and Professional Code, Division 3, Chapter 9, Contractors' License Law, under the following Section: Minor work under \$100; Section 7048
 Other: []
 (PRINT) PROPERTY OWNER SIGNATURE PROPERTY OWNER DATE
 OR AUTHORIZED AGENT

INSPECTION RECORD

APPROVAL	DATE	INSPECTOR
FOUNDATION & LOCATION		
CONCRETE FLOOR		
REINFORCING		
ROOF SHTG		
ROUGH FRAME		
INSULATION, ENERGY		
LATH OR DRYWALL		
PLAS. BROWN CT.		
SOUND INSULATION		
SMOKE DETECTOR		
PARKING		
LANDSCAPING		
LAND USE FINAL		
FINAL	9/27/82	
UTILITY RELEASE		
IDENTIFICATION CODE		

WORKER'S COMPENSATION REQUIREMENTS
 State Compensation Insurance Policy No. 170228 Expiration Date 4-1-83
 I certify that in the performance of the work for which this permit is issued, I shall not employ any person in any manner so as to become subject to the Worker's Compensation laws of California.
 NOTE: If, after making such certificate, the applicant for the permit should become subject to the Worker's Compensation provisions of this code, he shall forthwith comply with the provisions of Section 3700 or his permit shall be deemed revoked.
 I certify that I have read this application and state that the above information is correct. I agree to comply with all City ordinances and State laws relating to pending construction. I further agree to hold the City of Garden Grove free and harmless from any liability arising out of injury or bodily damage resulting from work performed relevant to this permit.
 W. K. Adams, INC. (PRINT) APPLICANT SIGNATURE DATE 5-3-82
 BUSINESS TAX CERTIFICATE INFORMATION
 I certify that the following Contractor's License No. and Classification is in full force and effect.
 (PRINT) CONTRACTOR SIGNATURE OR AUTHORIZED AGENT DATE
 BUSINESS TAX CERTIFICATE NO. EXPIRATION DATE
 I certify that I am exempt from Section 7031.5 of the Business and Professional Code, Division 3, Chapter 9, Contractors' License Law, under the following Section: Minor work under \$100; Section 7048
 Other: []
 (PRINT) PROPERTY OWNER SIGNATURE PROPERTY OWNER DATE
 OR AUTHORIZED AGENT

INSPECTION RECORD

APPROVAL	DATE	INSPECTOR
FOUNDATION & LOCATION		
CONCRETE FLOOR		
REINFORCING		
ROOF SHTG		
ROUGH FRAME		
INSULATION, ENERGY		
LATH OR DRYWALL		
PLAS. BROWN CT.		
SOUND INSULATION		
SMOKE DETECTOR		
PARKING		
LANDSCAPING		
LAND USE FINAL		
FINAL	9/27/82	
UTILITY RELEASE		
IDENTIFICATION CODE		

WORKER'S COMPENSATION REQUIREMENTS
 State Compensation Insurance Policy No. 170228 Expiration Date 4-1-83
 I certify that in the performance of the work for which this permit is issued, I shall not employ any person in any manner so as to become subject to the Worker's Compensation laws of California.
 NOTE: If, after making such certificate, the applicant for the permit should become subject to the Worker's Compensation provisions of this code, he shall forthwith comply with the provisions of Section 3700 or his permit shall be deemed revoked.
 I certify that I have read this application and state that the above information is correct. I agree to comply with all City ordinances and State laws relating to pending construction. I further agree to hold the City of Garden Grove free and harmless from any liability arising out of injury or bodily damage resulting from work performed relevant to this permit.
 W. K. Adams, INC. (PRINT) APPLICANT SIGNATURE DATE 5-3-82
 BUSINESS TAX CERTIFICATE INFORMATION
 I certify that the following Contractor's License No. and Classification is in full force and effect.
 (PRINT) CONTRACTOR SIGNATURE OR AUTHORIZED AGENT DATE
 BUSINESS TAX CERTIFICATE NO. EXPIRATION DATE
 I certify that I am exempt from Section 7031.5 of the Business and Professional Code, Division 3, Chapter 9, Contractors' License Law, under the following Section: Minor work under \$100; Section 7048
 Other: []
 (PRINT) PROPERTY OWNER SIGNATURE PROPERTY OWNER DATE
 OR AUTHORIZED AGENT

INSPECTION RECORD

APPROVAL	DATE	INSPECTOR
FOUNDATION & LOCATION		
CONCRETE FLOOR		
REINFORCING		
ROOF SHTG		
ROUGH FRAME		
INSULATION, ENERGY		
LATH OR DRYWALL		
PLAS. BROWN CT.		
SOUND INSULATION		
SMOKE DETECTOR		
PARKING		
LANDSCAPING		
LAND USE FINAL		
FINAL	9/27/82	
UTILITY RELEASE		
IDENTIFICATION CODE		

WORKER'S COMPENSATION REQUIREMENTS
 State Compensation Insurance Policy No. 170228 Expiration Date 4-1-83
 I certify that in the performance of the work for which this permit is issued, I shall not employ any person in any manner so as to become subject to the Worker's Compensation laws of California.
 NOTE: If, after making such certificate, the applicant for the permit should become subject to the Worker's Compensation provisions of this code, he shall forthwith comply with the provisions of Section 3700 or his permit shall be deemed revoked.
 I certify that I have read this application and state that the above information is correct. I agree to comply with all City ordinances and State laws relating to pending construction. I further agree to hold the City of Garden Grove free and harmless from any liability arising out of injury or bodily damage resulting from work performed relevant to this permit.
 W. K. Adams, INC. (PRINT) APPLICANT SIGNATURE DATE 5-3-82
 BUSINESS TAX CERTIFICATE INFORMATION
 I certify that the following Contractor's License No. and Classification is in full force and effect.
 (PRINT) CONTRACTOR SIGNATURE OR AUTHORIZED AGENT DATE
 BUSINESS TAX CERTIFICATE NO. EXPIRATION DATE
 I certify that I am exempt from Section 7031.5 of the Business and Professional Code, Division 3, Chapter 9, Contractors' License Law, under the following Section: Minor work under \$100; Section 7048
 Other: []
 (PRINT) PROPERTY OWNER SIGNATURE PROPERTY OWNER DATE
 OR AUTHORIZED AGENT

CITY OF GARDEN GROVE

PLOT PLAN

PUBLIC WORKS & DEVELOPMENT

OWNER FRANK MARTORANO	JOB ADDRESS 10802 KATELLA AV.	PERMIT NO. BELOW
NAME OF CONSTRUCTION LEADER & BRANCH	ASSESSOR'S PARCEL NO. 89-010-50	LOT 1
	BLOCK	TRACT
	PLEASE CHECK ONE OR MORE	
	<input checked="" type="checkbox"/> New	<input checked="" type="checkbox"/> Addition
	<input type="checkbox"/> Alteration	<input type="checkbox"/> Repair
	<input type="checkbox"/> Move	<input type="checkbox"/> Demolish
ADDRESS	DATE 4-5-82	PERMIT VALUE BELOW
CITY	JOB DESCRIPTION INSTALL ONE (1) NEW STEEL CANOPY, 22' X 60'	

SHOW NORTH ARROW, PROPERTY LINES AND ADJACENT STREETS

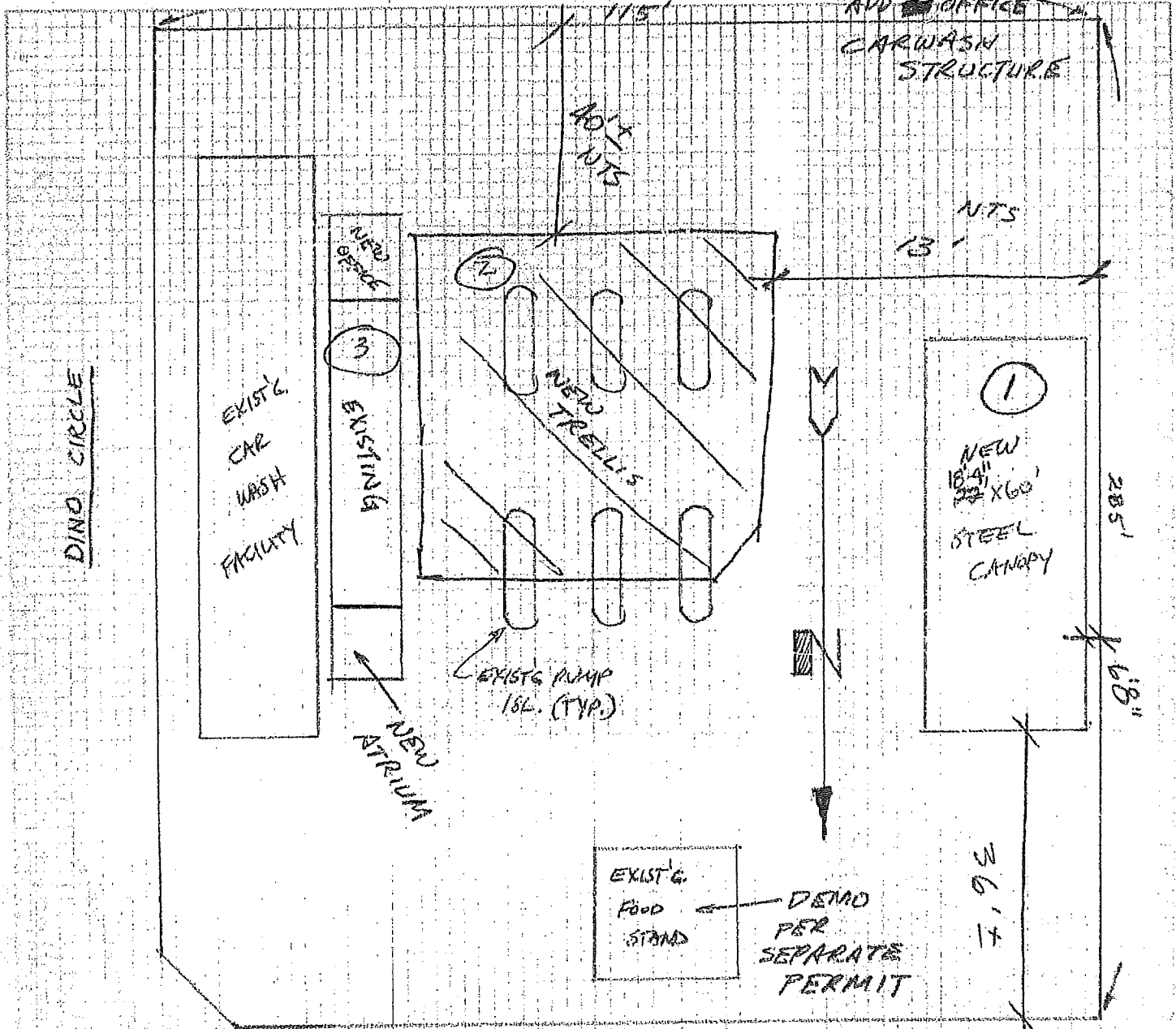

BLDG
1
2

VAL
10800.00
64900.00
12200.00

BP #
125122A
125124A
125123A

KATELLA AV.

#1 Building Insp./#2 Assessor/#3 Permittee/#4 File
I certify the information herein is complete and correct.

By _____

PLOT PLAN APPROVED BY _____

0 5-0000 - 3/79

PLUMBING PERMIT

Inspection Requests
638-6771

General Information
638-6961

For Applicant to Fill in

INSPECTION RECORD

APPROVALS	DATE	INSPECTOR	TYPE OF FIXTURE OR ITEM	NO.	EACH	\$ FEE
Soil Piping			Water Closet (toilet)	2		6
Ground Plumbing			Bath Tub			
			Shower			
Rough Plumbing	5-4-82	LM	Lavatory (Wash Basin)	2		6
Gas Piping			Kitchen Sink			
Gas Vent			Garbage Disposal			
			Laundry Tub or Tray			
Sewer			Water Heater			
			Floor Sink			
Mam Drain and Vacuum Lines			Floor Drain	1		3
Water Heater			Dish Washer			
Backwash			Drinking Fountain			
			Urinal			
Water Lateral			Gas System - Outlets	1		3
			Building Sewer (First 100 ft.)			
			Building Sewer (Add'l 100 ft.)			
			Building Sewer (ea. add'l drain)			
			Rainwater Drain			
			Swimming Pool/Piping			
			Sand Traps/Receptors			
			Automatic Washing Machine			
			Water Softeners			
			Backwash - Trap			
			Water Lateral			
			Backflow Protective Devices			
			Water Piping (ea. 100 ft.)			
			Lawn Sprinklers (S.F.D. Only)			
			Lawn Sprinklers (other)			
FINAL	11-23-82	LM				
UTILITY CO. NOTIFIED						
IDENTIFICATION CODE						
BUILDING PERMIT NO.	ELECTRICAL PERMIT NO.		DATE			
			5/3/82			

TOTAL FEES 37

DATE 5/3/82

AUTHORIZED BY [Signature]

LAND USE [Blank]

BUILDING [Blank]

DATE 5/3/82

ADDRESS: 125130A

LOT NO. 125130A

TRACT NO. 125130A

OWNER: FRANK HARTERANO

ADDRESS: 2122 KENNEDY AVENUE, GLENDALE

STATE L.L. NO. & TYPE: 116287

ADDRESS: 804 FIELDVIEW AVE, DUNN

PHONE: 213

PLUMBING CONTRACTOR: CONNIE PEARMAN, 116287

STATE L.L. NO. & TYPE: 252181

EXPIRATION DATE: 3-23

WORKER'S COMPENSATION REQUIREMENTS

State Compensation Insurance Policy No. 440818

NOTE: I certify that in the performance of the work for which this permit is issued, I shall not employ any person in any manner so as to become subject to the Worker's Compensation laws of California.

NOTE: If, after making such certificate, the applicant for the permit should become subject to the Worker's Compensation provisions of this code, he shall forthwith comply with the provisions of Section 3700 or his permit shall be deemed revoked.

I certify that I have read this application and state that the above information is correct. I agree to comply with all City ordinances and State laws relating to pending construction. I further agree to hold the City of Garden Grove harmless and harmless from any liability arising out of injury or bodily damage resulting from work performed relevant to this permit.

BUSINESS TAX CERTIFICATE INFORMATION

I certify that the following Contractor's License No. 252181 and Classification 2-30 is in full force and effect.

(PRINT) CONTRACTOR: FRANK HARTERANO

(SIGNATURE) CONTRACTOR: [Signature]

DATE: 5-3-82

(PRINT) PROPERTY OWNER: FRANK HARTERANO

(SIGNATURE) PROPERTY OWNER: [Signature]

DATE: [Blank]

BUSINESS TAX CERTIFICATE NO. [Blank]

EXPIRATION DATE: [Blank]

I certify that I am exempt from Section 7031.5 of the Business and Professional Code, Division 3, Chapter 9, Contractors' License Law, under the following Section: [Blank]

Owner: Section 7044 [Blank] Minor work under \$300: Section 7048 [Blank]

Employee working for wages only: Section 7053 [Blank]

Other: [Blank]

A FEE MAY BE CHARGED FOR REINSPECTION DUE TO NEGLIGENCE, INCOMPLETE WORK, OR FAILURE TO MAKE CORRECTIONS.