

TRAFFIC ENGINEERING STAFF REPORT

Agenda Item 4.b. Red Curb – Magnolia Street at Trask Avenue March 2, 2010

OBJECTIVE

To consider staff's proposal to paint red curb on Magnolia Street at Trask Avenue to facilitate a City intersection improvement project.

BACKGROUND/DISCUSSION

The City of Garden Grove has received OCTA Combined Transportation Funding Programs (CTFP) funding of \$557,565.63 to construct street improvements at the intersection of Magnolia and Trask.

Staff received this funding by identifying a traffic operational deficiency at the intersection. Existing northbound traffic on Magnolia is frequently congested at Trask. Contributing to this problem is the close proximity of freeway ramps to the intersection, as well as inadequate storage for left and right turning traffic. The proposed street improvement plan calls for widening Magnolia to address these problems. This widening allows for the addition of a third northbound through lane.

The proposed striping plan transitions the three northbound through lanes on Magnolia down to two lanes just north of the intersection. In this transition area, there is no room for cars to park and, therefore, red curb is required. The three affected parcels (13428, 13402 and 13392 Magnolia) contain multi-family residential properties that do provide off-street parking.

RECOMMENDATION

It is recommended that the Traffic Commission receive public input and approve staff's recommendation to paint red curb on Magnolia Street at Trask Avenue to facilitate a City intersection improvement project.



Dan Candelaria, P.E., T.E.
Executive Secretary

Attachments: Vicinity Map
Striping Plan
Street Improvement Plan

LOCATION MAP

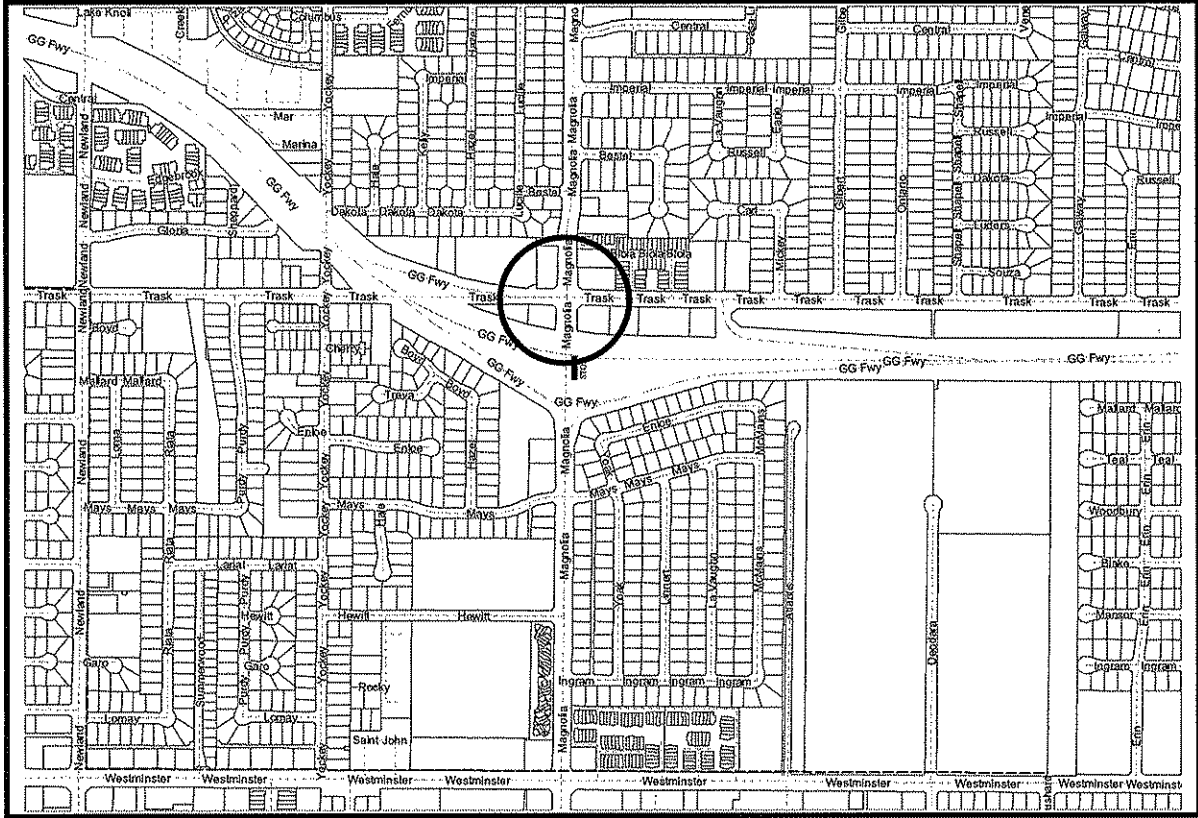

Agenda Item 4.b

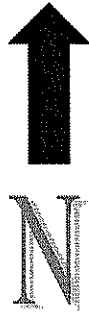

SIGNING & STRIPING PLAN

Magnolia Street & Trask Avenue

LEGEND

- ▷ INSTALL SIGN AS NOTED ON NEW POST, UNLESS OTHERWISE NOTED ON PLAN
- DELINEATOR - SPACED AT 50' UNLESS OTHERWISE NOTED
- I BARRICADE - TYPE II OR TYPE III
- ⚑ FLAG MAN
- ⚡ FLASHING ARROW SIGN
- ↔ DIRECTION OF TRAFFIC FLOW
- ➔ INSTALL PAVEMENT ARROW

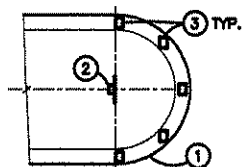

① RAISED MEDIAN MARKING DETAIL N.T.S.

NOTES :

- ① PAINT MEDIAN NOSE, CURB FACE AND TOP, WITH HIGHLY REFLECTIVE PREMIUM WHITE TRAFFIC PAINT WITH GLASS BEADS.
- ② INSTALL FLEXIBLE VERTICAL TYPE K MARKER, R7, R10, OR TYPE N-1 ON TELESPAR POST AS INDICATED ON PLAN.
- ③ INSTALL YELLOW REFLECTIVE PAVEMENT MARKERS ON TOP SURFACE OF MEDIAN CURB NOSE AT 2' C.C. SPACING (MINIMUM 5 MARKERS). PLACE REFLECTIVE SURFACE OF MARKERS PARALLEL TO CENTER LINE OF ROADWAY.

NOTES :

1. ALL EXISTING STRIPING SHALL BE REMOVED BY WET SAND BLASTING. EXISTING RAISED PAVEMENT MARKERS SHALL ALSO BE REMOVED.
2. ALL STRIPING AS SHOWN SHALL BE THERMOPLASTIC PER THE SPECIFICATIONS.

SIGNING & STRIPING NOTES :

- ① INSTALL 4" SKIP WHITE LANE LINE & MARKERS, PER CALTRAN'S STD. PLAN No. A20A, DETAIL 9.
- ② INSTALL 4" SOLID WHITE LINE & MARKERS PER CITY STD. PLAN No. B-303 WITH MARKER SPACING AT 12' O.C.
- ③ INSTALL 8" SOLID WHITE LANE LINE & MARKERS, PER CALTRAN'S STD. PLAN No. A20D, DETAIL 38.
- ④ INSTALL 10' CROSSWALK (12" SOLID WHITE LINES).
- ⑤ INSTALL PAVEMENT LEGENDS AS SHOWN PER CALTRAN'S STD. PLANS No. A24A-A24E
- ⑥ PROTECT IN PLACE.
- ⑦ INSTALL 8" SOLID WHITE LANE LINE WITHOUT MARKERS.
- ⑧ INSTALL 4" SKIP WHITE LINE PER CALTRAN'S STD PLAN DETAIL No. 40.
- ⑨ INSTALL YELLOW PAVEMENT MARKERS PER CALTRAN'S STD PLAN No. A20B, DETAIL 28.
- ⑩ INSTALL TRUNCATED DOME PAD 3"x4".
- ⑪ INSTALL R10 AND/OR TYPE K SIGN, PER M.U.T.C.D. PER PLAN (SEE DETAIL).
- ⑫ INSTALL 12" SOLID WHITE LINE.
- ⑬ INSTALL RED CURB.
- ⑭ INSTALL 4-INCH WIDE DOUBLE YELLOW CENTERLINES AND MARKERS PER CALTRAN'S STD PLAN No. A20A, DETAIL No. 22.
- ⑮ INSTALL W8-1 SIGN AND POST AS SHOWN.
- ⑯ INSTALL W4-2 SIGN AND POST AS SHOWN.
- ⑰ INSTALL R28A(S) SIGN AND POST AS SHOWN.
- ⑱ INSTALL R3-7 SIGN AND POST AS SHOWN.
- ⑲ REMOVE EXISTING MARKERS & SANDBLAST CONFLICTING STRIPING COMPLETELY.
- ⑳ REMOVE SIGN AND RETURN TO CITY YARD.

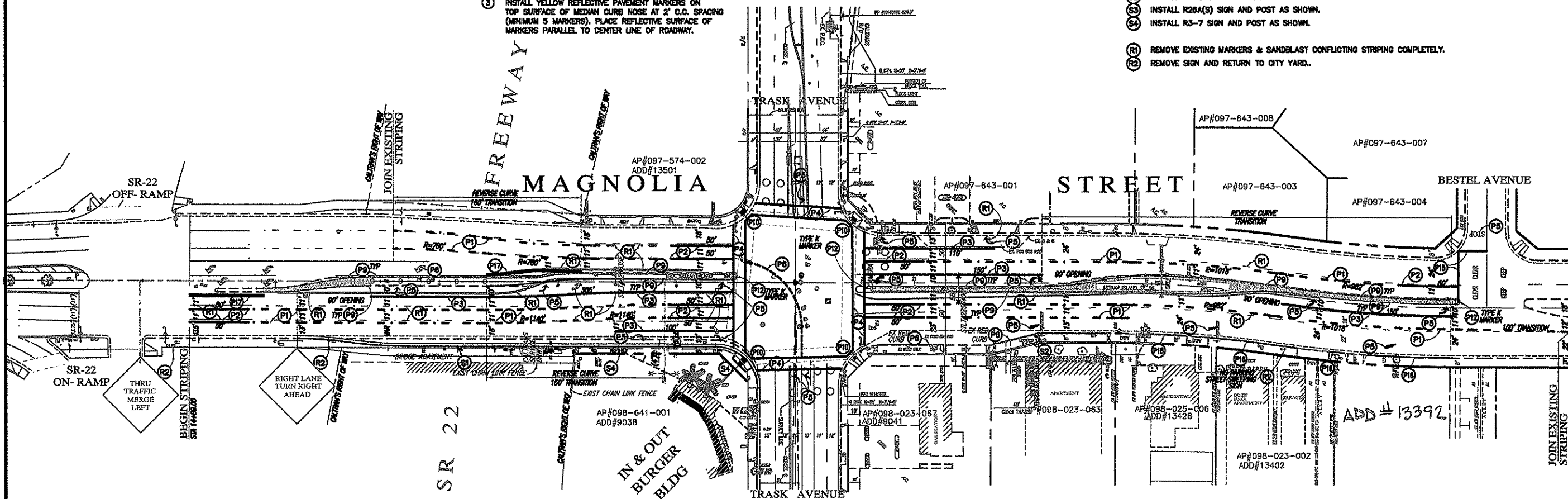

NO WORK SHALL BE DONE ON THIS SITE UNTIL BELOW AGENCY IS NOTIFIED OF INTENTION TO GRADE OR EXCAVATE.

Underground Service Alert
Call: TOLL FREE
1-800-422-4133
TWO WORKING DAYS BEFORE YOU DIG

City of Garden Grove
Department Of Public Works

**INTERSECTION IMPROVEMENT PLANS FOR
MAGNOLIA/TRASK
SIGNING & STRIPING PLAN**

REV. 00 00/00/00

DRAWING NUMBER

S-182

SHEET 1 OF 1

Garden Grove File: G:\P0-BIG\DATA\MAGNOLIA-TRASK\Survey\ALT A.dwg 4:34 PM 02/12/10

NO WORK SHALL BE DONE ON THIS SITE UNTIL BELOW AGENCY IS NOTIFIED OF INTENTION TO GRADE OR EXCAVATE.

Underground Service Alert
Call TOLL FREE
1-800-422-4133
TWO WORKING DAYS BEFORE YOU DIG

MAGNOLIA

AP#97-574-02
ADD#13501
STREET

TRASK AVENUE

SR-22
OFF-RAMP

FREWAY

- CONSTRUCTION NOTES**
- PROTECT EXISTING IMPROVEMENTS IN PLACE.
 - RELOCATE EXISTING IMPROVEMENTS.
 - RELOCATE EXISTING FIRE HYDRANT PER CITY'S STD PLAN No. B-702.
 - REMOVE EXISTING IMPROVEMENTS BUT NOT LIMITED TO CURBS, AC OR PCC, PCC WITH RE-BARS, FENCE, WALL, DIRT, LANDSCAPING, IRRIGATION, ETC.
 - RELOCATE BY UTILITY OWNER.
 - ADJUST TO GRADE BY UTILITY OWNER.
 - CONSTRUCT TYPE "D-3" CURB AND GUTTER PER CITY'S STD PLAN No. B-113.
 - CONSTRUCT INTERIOR SIDEWALK PER CITY'S STD PLAN No. B-106.
 - CONSTRUCT INTERIOR STREET DRIVEWAY PER CITY'S STD PLAN No. B-120.
 - CONSTRUCT WHEELCHAIR RAMP PER CALTRANS STD PLAN No. A06, A OR B.
 - CONSTRUCT 6" AC OVER 10" CLASS II AB (UPPER 2" AC WITH 2X RUBBER LATEX).
 - CONSTRUCT TYPE "A-5" CURB PER CITY'S STD PLAN No. B-112.
 - CONSTRUCT 4" TEXTURED COLOR CONCRETE OVER IMPORTED MATERIAL (BROCK RED COLOR AND COBBLSTONE PATTERN).
 - ADJUST TO FINISHED GRADE.
 - REMOVE EXISTING & CONSTRUCT NEW 6" CHAIN LINK FENCE PER CITY'S STD PLAN No. B-125.
 - INSTALL NEW STREET LIGHT CONDUIT (2" PVC) WITH 1/4" YELLOW PULL ROPE FROM PULL BOX TO PULL BOX PER SIZE REQUIREMENTS. SEE DETAIL ON THIS SHEET. CONTRACTOR TO REMOVE EXISTING STREET LIGHT FOUNDATION COMPLETELY & BACKFILL WITH MINE SOIL. (STREET LIGHT WILL BE RELOCATED BY SIZE).
 - CONSTRUCT PAV. DEPTH AC.
 - RE-CONSTRUCT WALKER SERVICE AND METER PER CITY'S STD PLAN No. B-721.
 - CONSTRUCT 18" RCP, D-2000 CONNECT TO EXISTING SPOON DOWN WITH CONCRETE COLLAR.
 - RESET SURVEY MONUMENT.
 - CONSTRUCT CHAIN DRINK PER CITY'S STD PLAN No. B-201.
 - RECONSTRUCT ALL EXISTING CURB DRAIN.
 - GRIND EXISTING AC 2" DEEP.
 - INSTALL PAVEMENT FABRIC.
 - CONSTRUCT 2" THICK AC OP WITH 2X RUBBER LATEX.

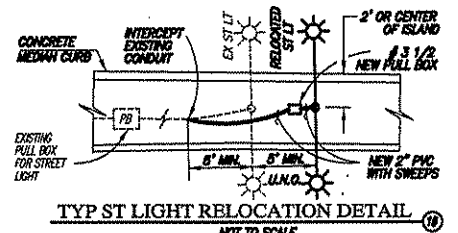

STREET CURVE DATA

No	DELTA	RADIUS	LENGTH	TANGENT
A	180°00'00"	2.00'	6.28'	-
B	11°02'25.44"	238.00'	45.28'	22.71'
C	06°31'16.66"	1007.00'	114.61'	87.36'
D	08°06'35.28"	993.00'	140.55'	70.39'
E	07°43'11.84"	335.00'	45.13'	22.60'
F	02°54'57.96"	993.00'	50.63'	25.27'
G	06°41'54.96"	300.00'	45.64'	22.61'
H	08°06'35.28"	997.00'	141.11'	70.67'
I	09°05'13.56"	285.00'	45.20'	22.64'
J	90°00'00"	35.00'	54.97'	35.00'
K	06°59'13.20"	370.00'	45.12'	22.58'
L	12°05'02"	218.00'	45.34'	22.75'

TRASK AVENUE

AP#98-641-01
ADD#9038
IN & OUT BURGER

AP#97-643-03

AP#97-643-04

BESTEL AVENUE

STA 20+00.00

STA 20+00.00

MATCHLINE

END OF CONSTRUCTION

TRASK AVENUE

MAGNOLIA STREET

MAGNOLIA STREET

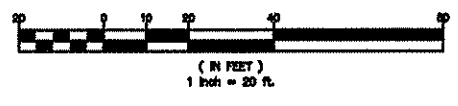
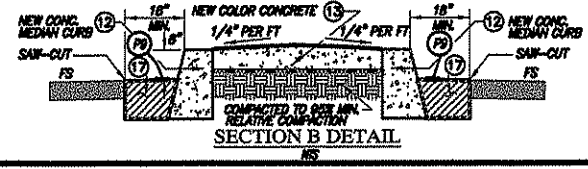
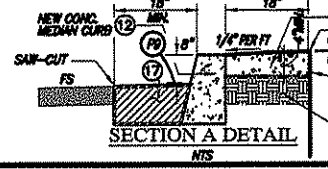

City of Garden Grove
Department Of Public Works

INTERSECTION IMPROVEMENT PLANS FOR
MAGNOLIA/TRASK
PLAN & PROFILE

REV. 00 00/00/00
DRAWING NUMBER
A-1806
SHEET 2 OF 2

Garden Grove File: G:\00-ENV\DATA\MAGNOLIA-TRASK\ALT A BRT-20100 4:34 PM 02/12/10